

## **Attachment C**

**Indoor Air Sampling Locations, Data Table,  
and Laboratory Report – 26 April 2007**

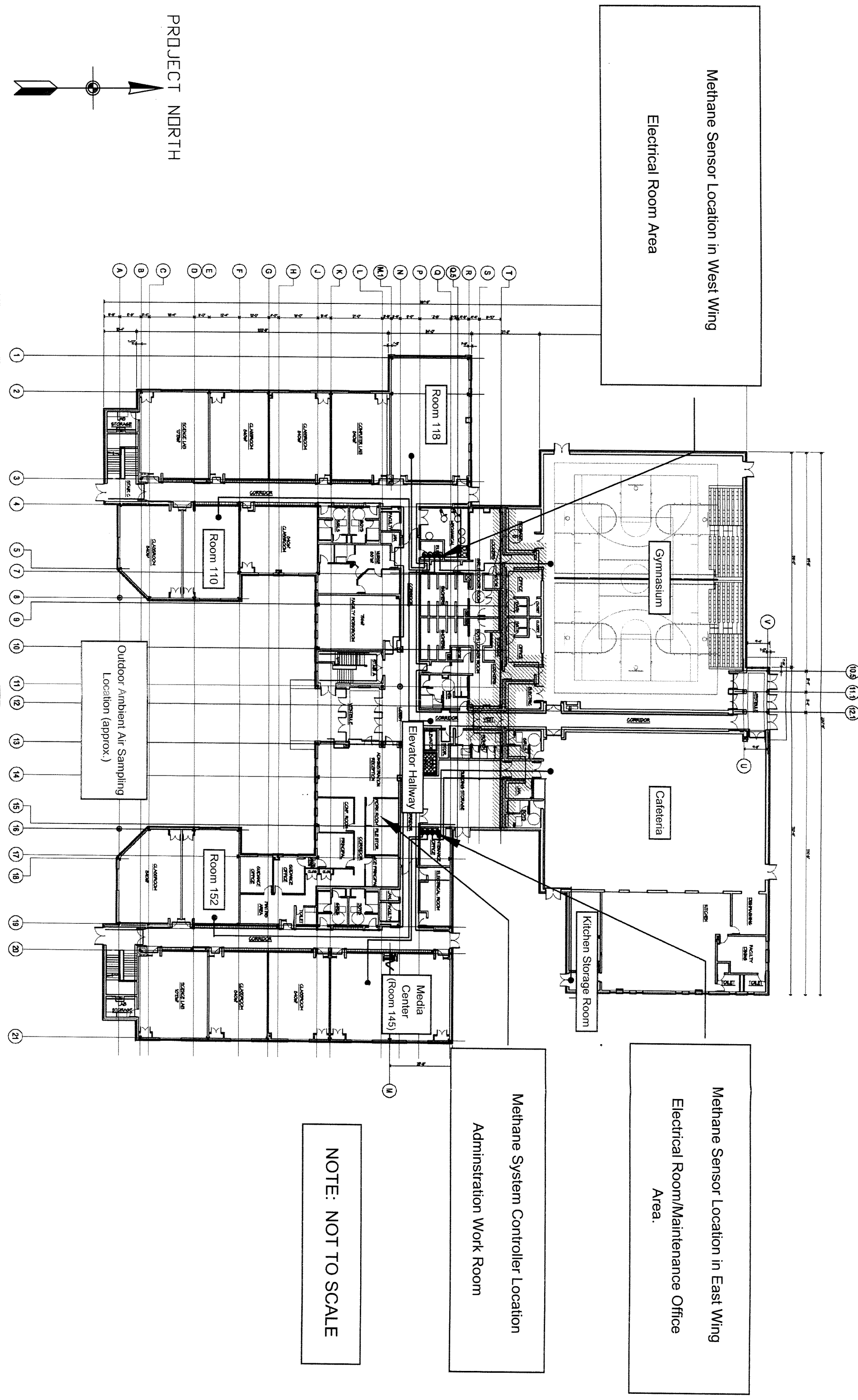

Methane Sensor Location in East Wing  
Electrical Room/Maintenance Office  
Area.

Methane System Controller Location  
Administration Work Room

NOTE: NOT TO SCALE

PROJECT NORTH

DESIGNED BY PMG	DRAWN BY PMG	DATE 4-13-07	PROJECT NO. 61965.01	FILE NAME Gorham Layout
CHECKED BY PMG	PROJECT MGR. PMG	SCALE NTS	DRAWING NO. -	FIGURE N/A

AIR SAMPLING AND METHANE MONITORING  
SYSTEM DIAGRAM - GORHAM HIGH SCHOOL  
PROVIDENCE, RHODE ISLAND

LETTER ATTACHMENT  
FIGURE



**Summary of Indoor Air Sampling Data - Adelaide Avenue School Project - Volatile Organic Compounds**  
**Sampling Event - April 26, 2007**

Volatile Organic Compounds via TO-15	CT Draft Proposed		CT Existing Indoor		NYSDOH		Kitchen Storage Room	Cafeteria	Gymnasium	Elevator Hallway <sup>A</sup>	Room 118	Room 110	Media Center (Rm 145)	Room 152	Ambient Outdoor
	Indoor Residential Target	Air Concentrations *	Residential Target	Air Concentrations **	Air Guideline	Units									
Carbon tetrachloride <sup>1</sup>	0.5		1		None	µg/m <sup>3</sup>	0.73	0.684	0.696	0.785	0.734	0.768	0.724	0.717	0.705
Methylene Chloride <sup>2</sup>	3		45		60	µg/m <sup>3</sup>	2.78	2.78	2.78	2.78	2.78	2.78	2.78	2.78	5.1
1,2-Dichloroethane <sup>3</sup>	0.07 (0.08)*		0.0936		None	µg/m <sup>3</sup>	0.10	0.08	0.08	0.10	0.10	0.096	0.119	0.108	0.08
1,3,5-Trimethylbenzene <sup>3</sup>	9.3		None		None	µg/m <sup>3</sup>	3.83	4.99	1.52	5.61	8.26	0.342	14	4.28	0.10
1,2,4-Trimethylbenzene <sup>4</sup>	9.3		None		None	µg/m <sup>3</sup>	6.58	10.6	3.08	11.6	15.3	0.715	22.2	7.26	0.10

\* State of Connecticut Draft Proposed Indoor Residential Target Air Concentrations [Proposed Revisions to Connecticut's Remediation Standard Regulations Volatilization Criteria, CTDEP, March 2003]. These concentrations have been established as Action Levels for indoor air in the RIDEM Order of Approval [June 2006, Amended February 2007] with the exception of several compounds (1,2-Dichloroethane, Bromodichloromethane, 1,2-Dibromoethane, 1,1,1,2-Tetrachloroethane, and 1,1,1,2,2-Tetrachloroethane) where laboratory reporting limits can not achieve these concentrations.

\*\* State of Connecticut Existing Indoor Residential Target Air Concentrations [Remediation Standard Regulations, CTDEP, 1996]. Please note, these concentrations are provided for comparative purposes only and are not Action Levels for the Adelaide Avenue School project. "None" indicates that no target air concentration has been established for this compound by CTDEP.

\*\*\* New York State Department of Health (NYSDOH) air guideline concentrations [Final Guidance for Evaluating Soil Vapor Intrusion in the State of New York, NYSDOH, October 2006]. Please note, these concentrations are provided for comparative purposes only and are not Action Levels for the Adelaide Avenue School project. "None" indicates that no air guideline has been established for this compound by NYSDOH.

U: designation indicates that the compound was not detected by the laboratory. Reporting limit shown in the data column.  
: gray shading indicates that the sample concentration for this compound exceeds the applicable Indoor Air Action Level.

- 1: Carbon Tetrachloride is a manufactured chemical used in aerosols, cleaning fluids, fire extinguishers, and degreasing agents. This compound was measured at 0.705 µg/m<sup>3</sup> in ambient outdoor air and was not detected in soil vapor at the site in 2005 at a reporting limit of 3.1 µg/m<sup>3</sup>.
  - 2: Methylene Chloride is found in solvents, paint strippers, and carpeting products. Methylene Chloride was found in soil vapor at the site at a maximum concentration of 8.8 µg/m<sup>3</sup> in 2005 and in ambient outdoor air during this sampling event at 5.1 µg/m<sup>3</sup>.  
 Indoor air quality studies conducted at residential homes in MA indicate the presence of Methylene Chloride at mean concentration of 6.4 µg/m<sup>3</sup>.
  - 3: 1,2-Dichloroethane and 1,3,5-Trimethylbenzene are found in plastic, vinyl products, PVC pipes, building materials, and furnishings. Neither of these two compounds were detected in soil vapor at the site in 2005 and neither were detected in ambient outdoor air during this sampling event.
  - 4: 1,2,4-Trimethylbenzene is found in paints, paint thinners, vinyl flooring, rubber floor and wall coverings, wood furniture, and building insulation products. 1,2,4-Trimethylbenzene was found in one soil vapor sample at the site in 2005 at a concentration of 4.3 µg/m<sup>3</sup>, but was not found in ambient outdoor air during this sampling event.
- A: Paint odor noted in elevator hallway area. Some touch-up painting within bathrooms in this hallway ongoing during this sampling event.

ANALYTICAL REPORT

Lab Number:	L0706026
Client:	EA Engineering, Science and Tech 2350 Post Road Warwick, RI 02886
ATTN:	Peter Grivers
Project Name:	ADELAIDE AVE-GORHAM
Project Number:	6196501
Report Date:	05/08/07

Certifications & Approvals: MA (M-MA086), NY NELAC (11148), CT (PH-0574), NH (200305), NJ (MA935), RI (LAO00065), ME (2006012), PA (Registration #68-03671), USDA (Permit #S-72578), US Army Corps of Engineers, Naval FESC.

Eight Walkup Drive, Westborough, MA 01581-1019  
508-898-9220 (Fax) 508-898-9193 800-624-9220 - [www.alphalab.com](http://www.alphalab.com)

**Project Name:** ADELAIDE AVE-GORHAM  
**Project Number:** 6196501

**Lab Number:** L0706026  
**Report Date:** 05/08/07

<b>Alpha Sample ID</b>	<b>Client ID</b>	<b>Sample Location</b>
L0706026-01	GYM	PROVIDENCE, RI
L0706026-02	CAFE	PROVIDENCE, RI
L0706026-03	KITCH	PROVIDENCE, RI
L0706026-04	ELEV	PROVIDENCE, RI
L0706026-05	RM 118	PROVIDENCE, RI
L0706026-06	RM 110	PROVIDENCE, RI
L0706026-07	RM 145	PROVIDENCE, RI
L0706026-08	RM 152	PROVIDENCE, RI

**Project Name:** ADELAIDE AVE-GORHAM

**Lab Number:** L0706026

**Project Number:** 6196501

**Report Date:** 05/08/07

**Case Narrative**

The samples were received in accordance with the chain of custody and no significant deviations were encountered during preparation or analysis unless otherwise noted below.

**Report Submission**

This report replaces the report issued on May 07, 2007. The RDL for Methylene Chloride was lowered from 3.47 ug/m3 to 2.78 ug/m3.

This is a final report to replace the previously issued preliminary report. This report includes data for all requested analytes.

TO15

The WG278471-4 LCS recovery for Trichlorofluoromethane is below method acceptance criteria.

TO15-SIM

The results for Toluene and p/m Xylenes on L0706026-02 are being reported as greater than values from SIM analysis due to calibration exceedence. The results will be obtained from TO15 analysis.

The results for Toluene on L0706026-08 are being reported as greater than values from SIM analysis due to calibration exceedence. The results will be obtained from TO15 analysis.

I, the undersigned, attest under the pains and penalties of perjury that, to the best of my knowledge and belief and based upon my personal inquiry of those responsible for providing the information contained in this analytical report, such information is accurate and complete. This certificate of analysis is not complete unless this page accompanies any and all pages of this report.

Authorized Signature:



Title: Technical Director

Date: 05/08/07

**AIR**

**Project Name:** ADELAIDE AVE-GORHAM  
**Project Number:** 6196501

**Lab Number:** L0706026  
**Report Date:** 05/08/07

**SAMPLE RESULTS**

**Lab ID:** L0706026-01  
**Client ID:** GYM  
**Sample Location:** PROVIDENCE, RI  
**Matrix:** Air  
**Analytical Method:** 48.TO-15  
**Analytical Date:** 04/29/07 23:55  
**Analyst:** HM

**Date Collected:** 04/26/07 11:40  
**Date Received:** 04/26/07  
**Field Prep:** Not Specified

Parameter	ppbv		ug/m <sup>3</sup>		Qualifier	Dilution Factor
	Results	RDL	Results	RDL		
1,1,1-Trichloroethane	ND	0.500	ND	2.72		1
1,1,2,2-Tetrachloroethane	ND	0.500	ND	3.43		1
1,1,2-Trichloroethane	ND	0.500	ND	2.72		1
1,1-Dichloroethane	ND	0.500	ND	2.02		1
1,1-Dichloroethene	ND	0.500	ND	1.98		1
1,2,4-Trimethylbenzene	0.800	0.500	3.93	2.46		1
1,2-Dibromoethane	ND	0.500	ND	3.84		1
1,2-Dichlorobenzene	ND	0.500	ND	3.00		1
1,2-Dichloroethane	ND	0.500	ND	2.02		1
1,2-Dichloropropane	ND	0.500	ND	2.31		1
1,3,5-Trimethylbenzene	ND	0.500	ND	2.46		1
1,3-Dichlorobenzene	ND	0.500	ND	3.00		1
1,4-Dichlorobenzene	ND	0.500	ND	3.00		1
2-Butanone	ND	0.500	ND	1.47		1
Acetone	3.43	2.00	8.14	4.75		1
Benzene	ND	0.500	ND	1.60		1
Bromodichloromethane	ND	0.500	ND	3.35		1
Bromoform	ND	0.500	ND	5.16		1
Carbon tetrachloride	ND	0.500	ND	3.14		1
Chlorobenzene	ND	0.500	ND	2.30		1
Chloroethane	ND	0.500	ND	1.32		1
Chloroform	ND	0.500	ND	2.44		1
Chloromethane	ND	0.500	ND	1.03		1
cis-1,2-Dichloroethene	ND	0.500	ND	1.98		1
cis-1,3-Dichloropropene	ND	0.500	ND	2.27		1



**Project Name:** ADELAIDE AVE-GORHAM  
**Project Number:** 6196501

**Lab Number:** L0706026  
**Report Date:** 05/08/07

### SAMPLE RESULTS

**Lab ID:** L0706026-01  
**Client ID:** GYM  
**Sample Location:** PROVIDENCE, RI

**Date Collected:** 04/26/07 11:40  
**Date Received:** 04/26/07  
**Field Prep:** Not Specified

Parameter	ppbv		ug/m <sup>3</sup>		Qualifier	Dilution Factor
	Results	RDL	Results	RDL		
<b>Volatile Organic Compounds in Air</b>						
Dibromochloromethane	ND	0.500	ND	4.26		1
Dichlorodifluoromethane	ND	1.00	ND	4.94		1
Ethylbenzene	0.750	0.500	3.25	2.17		1
Methylene chloride	ND	0.800	ND	2.78		1
4-Methyl-2-pentanone	ND	0.500	ND	2.05		1
Methyl tert butyl ether	ND	0.500	ND	1.80		1
p/m-Xylene	2.10	1.00	9.11	4.34		1
o-Xylene	0.620	0.500	2.69	2.17		1
Styrene	ND	0.500	ND	2.13		1
Tetrachloroethene	ND	0.500	ND	3.39		1
Toluene	3.65	0.500	13.7	1.88		1
trans-1,2-Dichloroethene	ND	0.500	ND	1.98		1
trans-1,3-Dichloropropene	ND	0.500	ND	2.27		1
Trichloroethene	ND	0.500	ND	2.68		1
Trichlorofluoromethane	ND	0.500	ND	2.81		1
Vinyl chloride	ND	0.500	ND	1.28		1
Acrylonitrile	ND	0.500	ND	1.08		1
1,1,1,2-Tetrachloroethane	ND	0.500	ND	3.43		1
Isopropylbenzene	ND	0.500	ND	2.46		1
n-Butylbenzene	ND	0.500	ND	2.74		1
sec-Butylbenzene	ND	0.500	ND	2.74		1
p-Isopropyltoluene	ND	0.500	ND	2.74		1

**Project Name:** ADELAIDE AVE-GORHAM  
**Project Number:** 6196501

**Lab Number:** L0706026  
**Report Date:** 05/08/07

**SAMPLE RESULTS**

**Lab ID:** L0706026-01  
**Client ID:** GYM  
**Sample Location:** PROVIDENCE, RI  
**Matrix:** Air  
**Analytical Method:** 48, TO-15-SIM  
**Analytical Date:** 05/06/07 19:17  
**Analyst:** HM

**Date Collected:** 04/26/07 11:40  
**Date Received:** 04/26/07  
**Field Prep:** Not Specified

Parameter	ppbv		ug/m <sup>3</sup>		Qualifier	Dilution Factor
	Results	RDL	Results	RDL		
<b>Volatile Organic Compounds in Air by SIM</b>						
1,1,1-Trichloroethane	0.035	0.020	0.190	0.109		1
1,1,1,2-Tetrachloroethane	ND	0.020	ND	0.137		1
1,1,2,2-Tetrachloroethane	ND	0.020	ND	0.137		1
1,1,2-Trichloroethane	ND	0.020	ND	0.109		1
1,1-Dichloroethane	ND	0.020	ND	0.081		1
1,1-Dichloroethane	ND	0.020	ND	0.079		1
1,2,4-Trimethylbenzene	0.628	0.020	3.08	0.098		1
1,2-Dibromoethane	ND	0.020	ND	0.154		1
1,2-Dichlorobenzene	ND	0.020	ND	0.120		1
1,2-Dichloroethane	ND	0.020	ND	0.081		1
1,2-Dichloropropane	ND	0.020	ND	0.092		1
1,3,5-Trimethylbenzene	0.310	0.020	1.52	0.098		1
1,3-Dichlorobenzene	ND	0.020	ND	0.120		1
1,4-Dichlorobenzene	ND	0.020	ND	0.120		1
Benzene	0.116	0.020	0.370	0.064		1
Bromodichloromethane	ND	0.020	ND	0.134		1
Bromoform	ND	0.020	ND	0.206		1
Carbon tetrachloride	0.111	0.020	0.696	0.126		1
Chlorobenzene	ND	0.020	ND	0.092		1
Chloroethane	ND	0.020	ND	0.053		1
Chloroform	0.028	0.020	0.136	0.098		1
cis-1,2-Dichloroethane	ND	0.020	ND	0.079		1
cis-1,3-Dichloropropene	ND	0.020	ND	0.091		1
Dibromochloromethane	ND	0.020	ND	0.096		1
Dichlorodifluoromethane	0.613	0.050	3.03	0.250		1

**Project Name:** ADELAIDE AVE-GORHAM  
**Project Number:** 6196501

**Lab Number:** L0706026  
**Report Date:** 05/08/07

### SAMPLE RESULTS

**Lab ID:** L0706026-01  
**Client ID:** GYM  
**Sample Location:** PROVIDENCE, RI

**Date Collected:** 04/26/07 11:40  
**Date Received:** 04/26/07  
**Field Prep:** Not Specified

Parameter	ppbv		ug/m <sup>3</sup>		Qualifier	Dilution Factor
	Results	RDL	Results	RDL		
<b>Volatile Organic Compounds in Air by SIM</b>						
Ethylbenzene	0.753	0.020	3.27	0.087		1
Methyl tert butyl ether	ND	0.020	ND	0.072		1
p/m-Xylene	2.30	0.040	9.96	0.174		1
o-Xylene	0.550	0.020	2.38	0.087		1
Styrene	0.023	0.020	0.098	0.085		1
Tetrachloroethene	0.114	0.020	0.774	0.136		1
Toluene	3.28	0.020	12.3	0.075		1
trans-1,2-Dichloroethene	ND	0.020	ND	0.079		1
trans-1,3-Dichloropropene	ND	0.020	ND	0.091		1
Trichloroethene	0.066	0.020	0.353	0.107		1
Trichlorofluoromethane	0.332	0.050	1.86	0.280		1
Vinyl chloride	ND	0.020	ND	0.051		1

**Project Name:** ADELAIDE AVE-GORHAM  
**Project Number:** 6196501

**Lab Number:** L0706026  
**Report Date:** 05/08/07

### SAMPLE RESULTS

**Lab ID:** L0706026-02  
**Client ID:** CAFE  
**Sample Location:** PROVIDENCE, RI  
**Matrix:** Air  
**Analytical Method:** 48, TO-15  
**Analytical Date:** 04/30/07 00:34  
**Analyst:** HM

**Date Collected:** 04/26/07 11:45  
**Date Received:** 04/26/07  
**Field Prep:** Not Specified

Parameter	ppbv		ug/m <sup>3</sup>		Qualifier	Dilution Factor
	Results	RDL	Results	RDL		
1,1,1-Trichloroethane	ND	0.500	ND	2.72		1
1,1,2,2-Tetrachloroethane	ND	0.500	ND	3.43		1
1,1,2-Trichloroethane	ND	0.500	ND	2.72		1
1,1-Dichloroethane	ND	0.500	ND	2.02		1
1,1-Dichloroethene	ND	0.500	ND	1.98		1
1,2,4-Trimethylbenzene	2.03	0.500	9.97	2.46		1
1,2-Dibromoethane	ND	0.500	ND	3.84		1
1,2-Dichlorobenzene	ND	0.500	ND	3.00		1
1,2-Dichloroethane	ND	0.500	ND	2.02		1
1,2-Dichloropropane	ND	0.500	ND	2.31		1
1,3,5-Trimethylbenzene	0.830	0.500	4.08	2.46		1
1,3-Dichlorobenzene	ND	0.500	ND	3.00		1
1,4-Dichlorobenzene	ND	0.500	ND	3.00		1
2-Butanone	6.49	0.500	19.1	1.47		1
Acetone	4.67	2.00	11.1	4.75		1
Benzene	ND	0.500	ND	1.60		1
Bromodichloromethane	ND	0.500	ND	3.35		1
Bromoform	ND	0.500	ND	5.16		1
Carbon tetrachloride	ND	0.500	ND	3.14		1
Chlorobenzene	ND	0.500	ND	2.30		1
Chloroethane	ND	0.500	ND	1.32		1
Chloroform	ND	0.500	ND	2.44		1
Chloromethane	ND	0.500	ND	1.03		1
cis-1,2-Dichloroethene	ND	0.500	ND	1.98		1
cis-1,3-Dichloropropene	ND	0.500	ND	2.27		1

**Project Name:** ADELAIDE AVE-GORHAM  
**Project Number:** 6196501

**Lab Number:** L0706026  
**Report Date:** 05/08/07

**SAMPLE RESULTS**

**Lab ID:** L0706026-02  
**Client ID:** CAFE  
**Sample Location:** PROVIDENCE, RI

**Date Collected:** 04/26/07 11:45  
**Date Received:** 04/26/07  
**Field Prep:** Not Specified

Parameter	ppbv		ug/m <sup>3</sup>		Qualifier	Dilution Factor
	Results	RDL	Results	RDL		
<b>Volatile Organic Compounds in Air</b>						
Dibromochloromethane	ND	0.500	ND	4.26		1
Dichlorodifluoromethane	ND	1.00	ND	4.94		1
Ethylbenzene	2.12	0.500	9.20	2.17		1
Methylene chloride	ND	0.800	ND	2.78		1
4-Methyl-2-pentanone	ND	0.500	ND	2.05		1
Methyl tert butyl ether	ND	0.500	ND	1.80		1
p/m-Xylene	6.51	1.00	28.2	4.34		1
o-Xylene	1.61	0.500	6.98	2.17		1
Styrene	ND	0.500	ND	2.13		1
Tetrachloroethene	ND	0.500	ND	3.39		1
Toluene	5.16	0.500	19.4	1.88		1
trans-1,2-Dichloroethene	ND	0.500	ND	1.98		1
trans-1,3-Dichloropropene	ND	0.500	ND	2.27		1
Trichloroethene	ND	0.500	ND	2.68		1
Trichlorofluoromethane	ND	0.500	ND	2.81		1
Vinyl chloride	ND	0.500	ND	1.28		1
Acrylonitrile	ND	0.500	ND	1.08		1
1,1,1,2-Tetrachloroethane	ND	0.500	ND	3.43		1
Isopropylbenzene	ND	0.500	ND	2.46		1
n-Butylbenzene	ND	0.500	ND	2.74		1
sec-Butylbenzene	ND	0.500	ND	2.74		1
p-Isopropyltoluene	ND	0.500	ND	2.74		1

**Project Name:** ADELAIDE AVE-GORHAM  
**Project Number:** 6196501

**Lab Number:** L0706026  
**Report Date:** 05/08/07

**SAMPLE RESULTS**

**Lab ID:** L0706026-02  
**Client ID:** CAFE  
**Sample Location:** PROVIDENCE, RI  
**Matrix:** Air  
**Analytical Method:** 48, TO-15-SIM  
**Analytical Date:** 05/06/07 19:54  
**Analyst:** HM

**Date Collected:** 04/26/07 11:45  
**Date Received:** 04/26/07  
**Field Prep:** Not Specified

Parameter	ppbv		ug/m <sup>3</sup>		Qualifier	Dilution Factor
	Results	RDL	Results	RDL		
1,1,1-Trichloroethane	0.022	0.020	0.118	0.109		1
1,1,1,2-Tetrachloroethane	ND	0.020	ND	0.137		1
1,1,2,2-Tetrachloroethane	ND	0.020	ND	0.137		1
1,1,2-Trichloroethane	ND	0.020	ND	0.109		1
1,1-Dichloroethane	ND	0.020	ND	0.081		1
1,1-Dichloroethane	ND	0.020	ND	0.079		1
1,2,4-Trimethylbenzene	2.17	0.020	10.6	0.098		1
1,2-Dibromoethane	ND	0.020	ND	0.154		1
1,2-Dichlorobenzene	ND	0.020	ND	0.120		1
1,2-Dichloroethane	ND	0.020	ND	0.081		1
1,2-Dichloropropane	ND	0.020	ND	0.092		1
1,3,5-Trimethylbenzene	1.02	0.020	4.99	0.098		1
1,3-Dichlorobenzene	ND	0.020	ND	0.120		1
1,4-Dichlorobenzene	ND	0.020	ND	0.120		1
Benzene	0.162	0.020	0.517	0.064		1
Bromodichloromethane	ND	0.020	ND	0.134		1
Bromoform	ND	0.020	ND	0.206		1
Carbon tetrachloride	0.109	0.020	0.684	0.126		1
Chlorobenzene	ND	0.020	ND	0.092		1
Chloroethane	ND	0.020	ND	0.053		1
Chloroform	0.031	0.020	0.151	0.098		1
cis-1,2-Dichloroethene	ND	0.020	ND	0.079		1
cis-1,3-Dichloropropene	ND	0.020	ND	0.091		1
Dibromochloromethane	ND	0.020	ND	0.096		1
Dichlorodifluoromethane	0.614	0.050	3.04	0.250		1

**Project Name:** ADELAIDE AVE-GORHAM  
**Project Number:** 6196501

**Lab Number:** L0706026  
**Report Date:** 05/08/07

### SAMPLE RESULTS

**Lab ID:** L0706026-02  
**Client ID:** CAFE  
**Sample Location:** PROVIDENCE, RI

**Date Collected:** 04/26/07 11:45  
**Date Received:** 04/26/07  
**Field Prep:** Not Specified

Parameter	ppbv		ug/m <sup>3</sup>		Dilution Factor
	Results	RDL	Results	RDL	
<b>Volatle Organic Compounds in Air by SIM</b>					
Ethylbenzene	3.44	0.020	14.9	0.087	1
Methyl tert butyl ether	ND	0.020	ND	0.072	1
p/m-Xylene	>10	.04	>43	.174	1
o-Xylene	2.42	0.020	10.5	0.087	1
Styrene	0.045	0.020	0.189	0.085	1
Tetrachloroethene	0.044	0.020	0.299	0.136	1
Toluene	>5	.02	>18.8	.0753	1
trans-1,2-Dichloroethene	ND	0.020	ND	0.079	1
trans-1,3-Dichloropropene	ND	0.020	ND	0.091	1
Trichloroethene	0.045	0.020	0.244	0.107	1
Trichlorofluoromethane	0.324	0.050	1.82	0.280	1
Vinyl chloride	ND	0.020	ND	0.051	1

**Project Name:** ADELAIDE AVE-GORHAM  
**Project Number:** 6196501

**Lab Number:** L0706026  
**Report Date:** 05/08/07

### SAMPLE RESULTS

Lab ID:	L0706026-03	Date Collected:	04/26/07 12:00
Client ID:	KITCH	Date Received:	04/26/07
Sample Location:	PROVIDENCE, RI	Field Prep:	Not Specified
Matrix:	Air		
Analytical Method:	48, TO-15		
Analytical Date:	04/30/07 01:09		
Analyst:	HM		

Parameter	ppbv		ug/m <sup>3</sup>		Qualifier	Dilution Factor
	Results	RDL	Results	RDL		
1,1,1-Trichloroethane	ND	0.500	ND	2.72		1
1,1,2,2-Tetrachloroethane	ND	0.500	ND	3.43		1
1,1,2-Trichloroethane	ND	0.500	ND	2.72		1
1,1-Dichloroethane	ND	0.500	ND	2.02		1
1,1-Dichloroethane	ND	0.500	ND	1.98		1
1,2,4-Trimethylbenzene	1.11	0.500	5.45	2.46		1
1,2-Dibromoethane	ND	0.500	ND	3.84		1
1,2-Dichlorobenzene	ND	0.500	ND	3.00		1
1,2-Dichloroethane	ND	0.500	ND	2.02		1
1,2-Dichloropropane	ND	0.500	ND	2.31		1
1,3,5-Trimethylbenzene	0.560	0.500	2.75	2.46		1
1,3-Dichlorobenzene	ND	0.500	ND	3.00		1
1,4-Dichlorobenzene	ND	0.500	ND	3.00		1
2-Butanone	6.69	0.500	19.7	1.47		1
Acetone	6.05	2.00	14.4	4.75		1
Benzene	ND	0.500	ND	1.60		1
Bromodichloromethane	ND	0.500	ND	3.35		1
Bromoform	ND	0.500	ND	5.16		1
Carbon tetrachloride	ND	0.500	ND	3.14		1
Chlorobenzene	ND	0.500	ND	2.30		1
Chloroethane	ND	0.500	ND	1.32		1
Chloroform	ND	0.500	ND	2.44		1
Chloromethane	ND	0.500	ND	1.03		1
cis-1,2-Dichloroethene	ND	0.500	ND	1.98		1
cis-1,3-Dichloropropene	ND	0.500	ND	2.27		1



**Project Name:** ADELAIDE AVE-GORHAM  
**Project Number:** 6196501

**Lab Number:** L0706026  
**Report Date:** 05/08/07

### SAMPLE RESULTS

**Lab ID:** L0706026-03  
**Client ID:** KITCH  
**Sample Location:** PROVIDENCE, RI

**Date Collected:** 04/26/07 12:00  
**Date Received:** 04/26/07  
**Field Prep:** Not Specified

Parameter	ppbv		ug/m <sup>3</sup>		Qualifier	Dilution Factor
	Results	RDL	Results	RDL		
<b>Volatile Organic Compounds in Air</b>						
Dibromochloromethane	ND	0.500	ND	4.26		1
Dichlorodifluoromethane	ND	1.00	ND	4.94		1
Ethylbenzene	0.790	0.500	3.43	2.17		1
Methylene chloride	ND	0.800	ND	2.78		1
4-Methyl-2-pentanone	ND	0.500	ND	2.05		1
Methyl tert butyl ether	ND	0.500	ND	1.80		1
p/m-Xylene	2.42	1.00	10.5	4.34		1
o-Xylene	0.610	0.500	2.65	2.17		1
Styrene	ND	0.500	ND	2.13		1
Tetrachloroethene	ND	0.500	ND	3.39		1
Toluene	1.94	0.500	7.30	1.88		1
trans-1,2-Dichloroethene	ND	0.500	ND	1.98		1
trans-1,3-Dichloropropene	ND	0.500	ND	2.27		1
Trichloroethene	ND	0.500	ND	2.68		1
Trichlorofluoromethane	ND	0.500	ND	2.81		1
Vinyl chloride	ND	0.500	ND	1.28		1
Acrylonitrile	ND	0.500	ND	1.08		1
1,1,1,2-Tetrachloroethane	ND	0.500	ND	3.43		1
Isopropylbenzene	ND	0.500	ND	2.46		1
n-Butylbenzene	ND	0.500	ND	2.74		1
sec-Butylbenzene	ND	0.500	ND	2.74		1
p-Isopropyltoluene	ND	0.500	ND	2.74		1

**Project Name:** ADELAIDE AVE-GORHAM  
**Project Number:** 6196501

**Lab Number:** L0706026  
**Report Date:** 05/08/07

**SAMPLE RESULTS**

**Lab ID:** L0706026-03  
**Client ID:** KITCH  
**Sample Location:** PROVIDENCE, RI  
**Matrix:** Air  
**Analytical Method:** 48, TO-15-SIM  
**Analytical Date:** 05/06/07 20:31  
**Analyst:** HM

**Date Collected:** 04/26/07 12:00  
**Date Received:** 04/26/07  
**Field Prep:** Not Specified

Parameter	ppbv		ug/m <sup>3</sup>		Qualifier	Dilution Factor
	Results	RDL	Results	RDL		
1,1,1-Trichloroethane	0.022	0.020	0.119	0.109		1
1,1,1,2-Tetrachloroethane	ND	0.020	ND	0.137		1
1,1,2,2-Tetrachloroethane	ND	0.020	ND	0.137		1
1,1,2-Trichloroethane	ND	0.020	ND	0.109		1
1,1-Dichloroethane	ND	0.020	ND	0.081		1
1,1-Dichloroethane	ND	0.020	ND	0.079		1
1,2,4-Trimethylbenzene	1.34	0.020	6.58	0.098		1
1,2-Dibromoethane	ND	0.020	ND	0.154		1
1,2-Dichloroethane	0.025	0.020	0.10	0.081		1
1,2-Dichloropropane	ND	0.020	ND	0.092		1
1,3,5-Trimethylbenzene	0.779	0.020	3.83	0.098		1
1,3-Dichlorobenzene	ND	0.020	ND	0.120		1
1,4-Dichlorobenzene	ND	0.020	ND	0.120		1
Benzene	0.215	0.020	0.688	0.064		1
Bromodichloromethane	ND	0.020	ND	0.134		1
Bromoform	ND	0.020	ND	0.206		1
Carbon tetrachloride	0.115	0.020	0.725	0.126		1
Chlorobenzene	ND	0.020	ND	0.092		1
Chloroethane	ND	0.020	ND	0.053		1
Chloroform	0.030	0.020	0.144	0.098		1
cis-1,2-Dichloroethane	ND	0.020	ND	0.079		1
cis-1,3-Dichloropropene	ND	0.020	ND	0.091		1
Dibromochloromethane	ND	0.020	ND	0.096		1
Dichlorodifluoromethane	0.614	0.050	3.03	0.250		1

**Project Name:** ADELAIDE AVE-GORHAM  
**Project Number:** 6196501

**Lab Number:** L0706026  
**Report Date:** 05/08/07

### SAMPLE RESULTS

**Lab ID:** L0706026-03  
**Client ID:** KITCH  
**Sample Location:** PROVIDENCE, RI

**Date Collected:** 04/26/07 12:00  
**Date Received:** 04/26/07  
**Field Prep:** Not Specified

Parameter	ppbv		ug/m <sup>3</sup>		Qualifier	Dilution Factor
	Results	RDL	Results	RDL		
<b>Volatile Organic Compounds In Air by SIM</b>						
Ethylbenzene	1.43	0.020	6.21	0.087		1
Methyl tert butyl ether	ND	0.020	ND	0.072		1
p/m-Xylene	4.68	0.040	20.3	0.174		1
o-Xylene	1.04	0.020	4.51	0.087		1
Styrene	0.347	0.020	1.48	0.085		1
Tetrachloroethene	0.038	0.020	0.256	0.136		1
Toluene	2.55	0.020	9.59	0.075		1
trans-1,2-Dichloroethene	ND	0.020	ND	0.079		1
trans-1,3-Dichloropropene	ND	0.020	ND	0.091		1
Trichloroethene	0.026	0.020	0.142	0.107		1
Trichlorofluoromethane	0.314	0.050	1.76	0.280		1
Vinyl chloride	ND	0.020	ND	0.051		1

**Project Name:** ADELAIDE AVE-GORHAM  
**Project Number:** 6196501

**Lab Number:** L0706026  
**Report Date:** 05/08/07

### SAMPLE RESULTS

**Lab ID:** L0706026-04  
**Client ID:** ELEV  
**Sample Location:** PROVIDENCE, RI  
**Matrix:** Air  
**Analytical Method:** 48, TO-15  
**Analytical Date:** 04/30/07 01:44  
**Analyst:** HM

**Date Collected:** 04/26/07 13:45  
**Date Received:** 04/26/07  
**Field Prep:** Not Specified

Parameter	ppbv		ug/m <sup>3</sup>		Qualifier	Dilution Factor
	Results	RDL	Results	RDL		
1,1,1-Trichloroethane	ND	0.500	ND	2.72		1
1,1,2,2-Tetrachloroethane	ND	0.500	ND	3.43		1
1,1,2-Trichloroethane	ND	0.500	ND	2.72		1
1,1-Dichloroethane	ND	0.500	ND	2.02		1
1,1-Dichloroethane	ND	0.500	ND	1.98		1
1,2,4-Trimethylbenzene	2.20	0.500	10.8	2.46		1
1,2-Dibromoethane	ND	0.500	ND	3.84		1
1,2-Dichlorobenzene	ND	0.500	ND	3.00		1
1,2-Dichloroethane	ND	0.500	ND	2.02		1
1,2-Dichloropropane	ND	0.500	ND	2.31		1
1,3,5-Trimethylbenzene	0.970	0.500	4.76	2.46		1
1,3-Dichlorobenzene	ND	0.500	ND	3.00		1
1,4-Dichlorobenzene	ND	0.500	ND	3.00		1
2-Butanone	3.14	0.500	9.25	1.47		1
Acetone	5.11	2.00	12.1	4.75		1
Benzene	ND	0.500	ND	1.60		1
Bromodichloromethane	ND	0.500	ND	3.35		1
Bromoform	ND	0.500	ND	5.16		1
Carbon tetrachloride	ND	0.500	ND	3.14		1
Chlorobenzene	ND	0.500	ND	2.30		1
Chloroethane	ND	0.500	ND	1.32		1
Chloroform	ND	0.500	ND	2.44		1
Chloromethane	ND	0.500	ND	1.03		1
cis-1,2-Dichloroethene	ND	0.500	ND	1.98		1
cis-1,3-Dichloropropene	ND	0.500	ND	2.27		1

**Project Name:** ADELAIDE AVE-GORHAM  
**Project Number:** 6196501

**Lab Number:** L0706026  
**Report Date:** 05/08/07

### SAMPLE RESULTS

**Lab ID:** L0706026-04  
**Client ID:** ELEV  
**Sample Location:** PROVIDENCE, RI

**Date Collected:** 04/26/07 13:45  
**Date Received:** 04/26/07  
**Field Prep:** Not Specified

Parameter	ppbv		ug/m <sup>3</sup>		Qualifier	Dilution Factor
	Results	RDL	Results	RDL		
<b>Volatile Organic Compounds in Air</b>						
Dibromochloromethane	ND	0.500	ND	4.26		1
Dichlorodifluoromethane	ND	1.00	ND	4.94		1
Ethylbenzene	0.610	0.500	2.65	2.17		1
Methylene chloride	ND	0.800	ND	2.78		1
4-Methyl-2-pentanone	ND	0.500	ND	2.05		1
Methyl tert butyl ether	ND	0.500	ND	1.80		1
p/m-Xylene	1.92	1.00	8.33	4.34		1
o-Xylene	0.580	0.500	2.52	2.17		1
Styrene	ND	0.500	ND	2.13		1
Tetrachloroethene	ND	0.500	ND	3.39		1
Toluene	3.83	0.500	14.4	1.88		1
trans-1,2-Dichloroethene	ND	0.500	ND	1.98		1
trans-1,3-Dichloropropene	ND	0.500	ND	2.27		1
Trichloroethene	ND	0.500	ND	2.68		1
Trichlorofluoromethane	ND	0.500	ND	2.81		1
Vinyl chloride	ND	0.500	ND	1.28		1
Acrylonitrile	ND	0.500	ND	1.08		1
1,1,1,2-Tetrachloroethane	ND	0.500	ND	3.43		1
Isopropylbenzene	ND	0.500	ND	2.46		1
n-Butylbenzene	ND	0.500	ND	2.74		1
sec-Butylbenzene	ND	0.500	ND	2.74		1
p-Isopropyltoluene	ND	0.500	ND	2.74		1

**Project Name:** ADELAIDE AVE-GORHAM  
**Project Number:** 6196501

**Lab Number:** L0706026  
**Report Date:** 05/08/07

**SAMPLE RESULTS**

**Lab ID:** L0706026-04  
**Client ID:** ELEV  
**Sample Location:** PROVIDENCE, RI  
**Matrix:** Air  
**Analytical Method:** 48, TO-15-SIM  
**Analytical Date:** 05/06/07 21:07  
**Analyst:** HM

**Date Collected:** 04/26/07 13:45  
**Date Received:** 04/26/07  
**Field Prep:** Not Specified

Parameter	ppbv		ug/m <sup>3</sup>		Qualifier	Dilution Factor
	Results	RDL	Results	RDL		
<b>Volatile Organic Compounds in Air by SIM</b>						
1,1,1-Trichloroethane	0.023	0.020	0.125	0.109		1
1,1,1,2-Tetrachloroethane	ND	0.020	ND	0.137		1
1,1,2,2-Tetrachloroethane	ND	0.020	ND	0.137		1
1,1,2-Trichloroethane	ND	0.020	ND	0.109		1
1,1-Dichloroethane	ND	0.020	ND	0.081		1
1,1-Dichloroethane	ND	0.020	ND	0.079		1
1,2,4-Trimethylbenzene	2.36	0.020	11.6	0.098		1
1,2-Dibromoethane	ND	0.020	ND	0.154		1
1,2-Dichlorobenzene	ND	0.020	ND	0.120		1
1,2-Dichloroethane	0.025	0.020	0.101	0.081		1
1,2-Dichloropropane	ND	0.020	ND	0.092		1
1,3,5-Trimethylbenzene	1.14	0.020	5.61	0.098		1
1,3-Dichlorobenzene	ND	0.020	ND	0.120		1
1,4-Dichlorobenzene	ND	0.020	ND	0.120		1
Benzene	0.158	0.020	0.504	0.064		1
Bromodichloromethane	ND	0.020	ND	0.134		1
Bromoforn	ND	0.020	ND	0.206		1
Carbon tetrachloride	0.125	0.020	0.785	0.126		1
Chlorobenzene	ND	0.020	ND	0.092		1
Chloroethane	ND	0.020	ND	0.053		1
Chloroforn	0.030	0.020	0.145	0.098		1
cis-1,2-Dichloroethene	ND	0.020	ND	0.079		1
cis-1,3-Dichloropropene	ND	0.020	ND	0.091		1
Dibromochloromethane	ND	0.020	ND	0.096		1
Dichlorodifluoromethane	0.641	0.050	3.17	0.250		1

**Project Name:** ADELIADE AVE-GORHAM  
**Project Number:** 6196501

**Lab Number:** L0706026  
**Report Date:** 05/08/07

**SAMPLE RESULTS**

**Lab ID:** L0706026-04  
**Client ID:** ELEV  
**Sample Location:** PROVIDENCE, RI

**Date Collected:** 04/26/07 13:45  
**Date Received:** 04/26/07  
**Field Prep:** Not Specified

Parameter	ppbv		ug/m <sup>3</sup>		Qualifier	Dilution Factor
	Results	RDL	Results	RDL		
<b>Volatile Organic Compounds In Air by SIM</b>						
Ethylbenzene	0.938	0.020	4.07	0.087		1
Methyl tert butyl ether	ND	0.020	ND	0.072		1
p/m-Xylene	2.99	0.040	13.0	0.174		1
o-Xylene	0.796	0.020	3.46	0.087		1
Styrene	0.033	0.020	0.140	0.085		1
Tetrachloroethene	0.036	0.020	0.245	0.136		1
Toluene	4.51	0.020	17.0	0.075		1
trans-1,2-Dichloroethene	ND	0.020	ND	0.079		1
trans-1,3-Dichloropropene	ND	0.020	ND	0.091		1
Trichloroethene	0.026	0.020	0.140	0.107		1
Trichlorofluoromethane	0.332	0.050	1.86	0.280		1
Vinyl chloride	ND	0.020	ND	0.051		1

**Project Name:** ADELAIDE AVE-GORHAM  
**Project Number:** 6196501

**Lab Number:** L0706026  
**Report Date:** 05/08/07

**SAMPLE RESULTS**

**Lab ID:** L0706026-05  
**Client ID:** RM 118  
**Sample Location:** PROVIDENCE, RI  
**Matrix:** Air  
**Analytical Method:** 48.TO-15  
**Analytical Date:** 04/30/07 02:19  
**Analyst:** HM

**Date Collected:** 04/26/07 13:05  
**Date Received:** 04/26/07  
**Field Prep:** Not Specified

Parameter	ppbv		ug/m3		Qualifier	Dilution Factor
	Results	RDL	Results	RDL		
<b>Volatile Organic Compounds in Air</b>						
1,1,1-Trichloroethane	ND	0.500	ND	2.72		1
1,1,2,2-Tetrachloroethane	ND	0.500	ND	3.43		1
1,1,2-Trichloroethane	ND	0.500	ND	2.72		1
1,1-Dichloroethane	ND	0.500	ND	2.02		1
1,1-Dichloroethene	ND	0.500	ND	1.98		1
1,2,4-Trimethylbenzene	2.77	0.500	13.6	2.46		1
1,2-Dibromoethane	ND	0.500	ND	3.84		1
1,2-Dichlorobenzene	ND	0.500	ND	3.00		1
1,2-Dichloropropane	ND	0.500	ND	2.02		1
1,3,5-Trimethylbenzene	1.31	0.500	6.43	2.46		1
1,3-Dichlorobenzene	ND	0.500	ND	3.00		1
1,4-Dichlorobenzene	ND	0.500	ND	3.00		1
2-Butanone	ND	0.500	ND	1.47		1
Acetone	6.71	2.00	15.9	4.75		1
Benzene	ND	0.500	ND	1.60		1
Bromodichloromethane	ND	0.500	ND	3.35		1
Bromoform	ND	0.500	ND	5.16		1
Carbon tetrachloride	ND	0.500	ND	3.14		1
Chlorobenzene	ND	0.500	ND	2.30		1
Chloroethane	ND	0.500	ND	1.32		1
Chloroform	ND	0.500	ND	2.44		1
Chloromethane	ND	0.500	ND	1.03		1
cis-1,2-Dichloroethene	ND	0.500	ND	1.98		1
cis-1,3-Dichloropropene	ND	0.500	ND	2.27		1



**Project Name:** ADELAIDE AVE-GORHAM  
**Project Number:** 6196501

**Lab Number:** L0706026  
**Report Date:** 05/08/07

### SAMPLE RESULTS

**Lab ID:** L0706026-05  
**Client ID:** RM 118  
**Sample Location:** PROVIDENCE, RI

**Date Collected:** 04/26/07 13:05  
**Date Received:** 04/26/07  
**Field Prep:** Not Specified

Parameter	ppbv		ug/m <sup>3</sup>		Qualifier	Dilution Factor
	Results	RDL	Results	RDL		
<b>Volatile Organic Compounds in Air</b>						
Dibromochloromethane	ND	0.500	ND	4.26		1
Dichlorodifluoromethane	ND	1.00	ND	4.94		1
Ethylbenzene	0.530	0.500	2.30	2.17		1
Methylene chloride	ND	0.800	ND	2.78		1
4-Methyl-2-pentanone	ND	0.500	ND	2.05		1
Methyl tert butyl ether	ND	0.500	ND	1.80		1
p/m- Xylene	1.96	1.00	8.50	4.34		1
o-Xylene	0.570	0.500	2.47	2.17		1
Styrene	ND	0.500	ND	2.13		1
Tetrachloroethene	ND	0.500	ND	3.39		1
Toluene	3.48	0.500	13.1	1.88		1
trans-1,2-Dichloroethene	ND	0.500	ND	1.98		1
trans-1,3-Dichloropropene	ND	0.500	ND	2.27		1
Trichloroethene	ND	0.500	ND	2.68		1
Trichlorofluoromethane	ND	0.500	ND	2.81		1
Vinyl chloride	ND	0.500	ND	1.28		1
Acrylonitrile	ND	0.500	ND	1.08		1
1,1,1,2-Tetrachloroethane	ND	0.500	ND	3.43		1
Isopropylbenzene	ND	0.500	ND	2.46		1
n-Butylbenzene	ND	0.500	ND	2.74		1
sec-Butylbenzene	ND	0.500	ND	2.74		1
p-Isopropyltoluene	ND	0.500	ND	2.74		1

**Project Name:** ADELAIDE AVE-GORHAM  
**Project Number:** 6196501

**Lab Number:** L0706026  
**Report Date:** 05/08/07

**SAMPLE RESULTS**

**Lab ID:** L0706026-05  
**Client ID:** RM 118  
**Sample Location:** PROVIDENCE, RI  
**Matrix:** Air  
**Analytical Method:** 48.TO-15-SIM  
**Analytical Date:** 05/06/07 21:44  
**Analyst:** HM

**Date Collected:** 04/26/07 13:05  
**Date Received:** 04/26/07  
**Field Prep:** Not Specified

Parameter	ppbv		ug/m <sup>3</sup>		Qualifier	Dilution Factor
	Results	RDL	Results	RDL		
1,1,1-Trichloroethane	0.026	0.020	0.140	0.109		1
1,1,1,2-Tetrachloroethane	ND	0.020	ND	0.137		1
1,1,2,2-Tetrachloroethane	ND	0.020	ND	0.137		1
1,1,2-Trichloroethane	ND	0.020	ND	0.109		1
1,1-Dichloroethane	ND	0.020	ND	0.081		1
1,1-Dichloroethane	ND	0.020	ND	0.079		1
1,2,4-Trimethylbenzene	3.12	0.020	15.3	0.098		1
1,2-Dibromoethane	ND	0.020	ND	0.154		1
1,2-Dichlorobenzene	ND	0.020	ND	0.120		1
1,2-Dichloroethane	0.025	0.020	0.10	0.081		1
1,2-Dichloropropane	ND	0.020	ND	0.092		1
1,3,5-Trimethylbenzene	1.68	0.020	8.26	0.098		1
1,3-Dichlorobenzene	ND	0.020	ND	0.120		1
1,4-Dichlorobenzene	ND	0.020	ND	0.120		1
Benzene	0.257	0.020	0.821	0.064		1
Bromodichloromethane	ND	0.020	ND	0.134		1
Bromoform	ND	0.020	ND	0.206		1
Carbon tetrachloride	0.117	0.020	0.734	0.126		1
Chlorobenzene	ND	0.020	ND	0.092		1
Chloroethane	ND	0.020	ND	0.053		1
Chloroform	0.032	0.020	0.157	0.098		1
cis-1,2-Dichloroethene	ND	0.020	ND	0.079		1
cis-1,3-Dichloropropene	ND	0.020	ND	0.091		1
Dibromochloromethane	ND	0.020	ND	0.096		1
Dichlorodifluoromethane	0.612	0.050	3.02	0.250		1

**Project Name:** ADELAIDE AVE-GORHAM  
**Project Number:** 6196501

**Lab Number:** L0706026  
**Report Date:** 05/08/07

### SAMPLE RESULTS

**Lab ID:** L0706026-05  
**Client ID:** RM 118  
**Sample Location:** PROVIDENCE, RI

**Date Collected:** 04/26/07 13:05  
**Date Received:** 04/26/07  
**Field Prep:** Not Specified

Parameter	ppbv		ug/m <sup>3</sup>		Qualifier	Dilution Factor
	Results	RDL	Results	RDL		
<b>Volatile Organic Compounds in Air by SIM</b>						
Ethylbenzene	0.888	0.020	3.85	0.087		1
Methyl tert butyl ether	0.034	0.020	0.121	0.072		1
p/m-Xylene	3.24	0.040	14.0	0.174		1
o-Xylene	0.828	0.020	3.59	0.087		1
Styrene	0.089	0.020	0.380	0.085		1
Tetrachloroethene	0.049	0.020	0.331	0.136		1
Toluene	4.28	0.020	16.1	0.075		1
trans-1,2-Dichloroethene	ND	0.020	ND	0.079		1
trans-1,3-Dichloropropene	ND	0.020	ND	0.091		1
Trichloroethene	0.039	0.020	0.208	0.107		1
Trichlorofluoromethane	0.340	0.050	1.91	0.280		1
Vinyl chloride	ND	0.020	ND	0.051		1

**Project Name:** ADELAIDE AVE-GORHAM  
**Project Number:** 6196501

**Lab Number:** L0706026  
**Report Date:** 05/08/07

### SAMPLE RESULTS

**Lab ID:** L0706026-06  
**Client ID:** RM 110  
**Sample Location:** PROVIDENCE, RI  
**Matrix:** Air  
**Analytical Method:** 48.TO-15  
**Analytical Date:** 04/30/07 02:53  
**Analyst:** HM

**Date Collected:** 04/26/07 13:12  
**Date Received:** 04/26/07  
**Field Prep:** Not Specified

Parameter	ppbv		ug/m3		Qualifier	Dilution Factor
	Results	RDL	Results	RDL		
<b>Volatile Organic Compounds in Air</b>						
1,1,1-Trichloroethane	ND	0.500	ND	2.72		1
1,1,2,2-Tetrachloroethane	ND	0.500	ND	3.43		1
1,1,2-Trichloroethane	ND	0.500	ND	2.72		1
1,1-Dichloroethane	ND	0.500	ND	2.02		1
1,1-Dichloroethene	ND	0.500	ND	1.98		1
1,2,4-Trimethylbenzene	ND	0.500	ND	2.46		1
1,2-Dibromoethane	ND	0.500	ND	3.84		1
1,2-Dichlorobenzene	ND	0.500	ND	3.00		1
1,2-Dichloroethane	ND	0.500	ND	2.02		1
1,2-Dichloropropane	ND	0.500	ND	2.31		1
1,3,5-Trimethylbenzene	ND	0.500	ND	2.46		1
1,3-Dichlorobenzene	ND	0.500	ND	3.00		1
1,4-Dichlorobenzene	ND	0.500	ND	3.00		1
2-Butanone	ND	0.500	ND	1.47		1
Acetone	3.60	2.00	8.54	4.75		1
Benzene	ND	0.500	ND	1.60		1
Bromodichloromethane	ND	0.500	ND	3.35		1
Bromoform	ND	0.500	ND	5.16		1
Carbon tetrachloride	ND	0.500	ND	3.14		1
Chlorobenzene	ND	0.500	ND	2.30		1
Chloroethane	ND	0.500	ND	1.32		1
Chloroform	ND	0.500	ND	2.44		1
Chloromethane	ND	0.500	ND	1.03		1
cis-1,2-Dichloroethene	ND	0.500	ND	1.98		1
cis-1,3-Dichloropropene	ND	0.500	ND	2.27		1

**Project Name:** ADELAIDE AVE-GORHAM  
**Project Number:** 6196501

**Lab Number:** L0706026  
**Report Date:** 05/08/07

### SAMPLE RESULTS

**Lab ID:** L0706026-06  
**Client ID:** RM 110  
**Sample Location:** PROVIDENCE, RI

**Date Collected:** 04/26/07 13:12  
**Date Received:** 04/26/07  
**Field Prep:** Not Specified

Parameter	ppbv		ug/m <sup>3</sup>		Qualifier	Dilution Factor
	Results	RDL	Results	RDL		
<b>Volatile Organic Compounds in Air</b>						
Dibromochloromethane	ND	0.500	ND	4.26		1
Dichlorodifluoromethane	ND	1.00	ND	4.94		1
Ethylbenzene	ND	0.500	ND	2.17		1
Methylene chloride	ND	0.800	ND	2.78		1
4-Methyl-2-pentanone	ND	0.500	ND	2.05		1
Methyl tert butyl ether	ND	0.500	ND	1.80		1
p/m-Xylene	ND	1.00	ND	4.34		1
o-Xylene	ND	0.500	ND	2.17		1
Styrene	ND	0.500	ND	2.13		1
Tetrachloroethene	ND	0.500	ND	3.39		1
Toluene	ND	0.500	ND	1.88		1
trans-1,2-Dichloroethene	ND	0.500	ND	1.98		1
trans-1,3-Dichloropropene	ND	0.500	ND	2.27		1
Trichloroethene	ND	0.500	ND	2.68		1
Trichlorofluoromethane	ND	0.500	ND	2.81		1
Vinyl chloride	ND	0.500	ND	1.28		1
Acrylonitrile	ND	0.500	ND	1.08		1
1,1,1,2-Tetrachloroethane	ND	0.500	ND	3.43		1
Isopropylbenzene	ND	0.500	ND	2.46		1
n-Butylbenzene	ND	0.500	ND	2.74		1
sec-Butylbenzene	ND	0.500	ND	2.74		1
p-Isopropyltoluene	ND	0.500	ND	2.74		1

**Project Name:** ADELAIDE AVE-GORHAM  
**Project Number:** 6196501

**Lab Number:** L0706026  
**Report Date:** 05/08/07

### SAMPLE RESULTS

**Lab ID:** L0706026-06  
**Client ID:** RM 110  
**Sample Location:** PROVIDENCE, RI  
**Matrix:** Air  
**Analytical Method:** 48, TO-15-SIM  
**Analytical Date:** 05/06/07 22:21  
**Analyst:** HM

**Date Collected:** 04/26/07 13:12  
**Date Received:** 04/26/07  
**Field Prep:** Not Specified

Parameter	ppbv		ug/m <sup>3</sup>		Qualifier	Dilution Factor
	Results	RDL	Results	RDL		
1,1,1-Trichloroethane	0.022	0.020	0.118	0.109		1
1,1,1,2-Tetrachloroethane	ND	0.020	ND	0.137		1
1,1,2,2-Tetrachloroethane	ND	0.020	ND	0.137		1
1,1,2-Trichloroethane	ND	0.020	ND	0.109		1
1,1-Dichloroethane	ND	0.020	ND	0.081		1
1,1-Dichloroethane	ND	0.020	ND	0.079		1
1,2,4-Trimethylbenzene	0.146	0.020	0.715	0.098		1
1,2-Dibromoethane	ND	0.020	ND	0.154		1
1,2-Dichloroethane	ND	0.020	ND	0.120		1
1,2-Dichloropropane	0.024	0.020	0.096	0.081		1
1,2-Dichloroethane	ND	0.020	ND	0.092		1
1,3,5-Trimethylbenzene	0.070	0.020	0.342	0.098		1
1,3-Dichlorobenzene	ND	0.020	ND	0.120		1
1,4-Dichlorobenzene	ND	0.020	ND	0.120		1
Benzene	0.138	0.020	0.440	0.064		1
Bromodichloromethane	ND	0.020	ND	0.134		1
Bromoform	ND	0.020	ND	0.206		1
Carbon tetrachloride	0.122	0.020	0.768	0.126		1
Chlorobenzene	ND	0.020	ND	0.092		1
Chloroethane	ND	0.020	ND	0.053		1
Chloroform	0.028	0.020	0.138	0.098		1
cis-1,2-Dichloroethane	ND	0.020	ND	0.079		1
cis-1,3-Dichloropropene	ND	0.020	ND	0.091		1
Dibromochloromethane	ND	0.020	ND	0.096		1
Dichlorodifluoromethane	0.684	0.050	3.38	0.250		1

**Project Name:** ADELDAIDE AVE-GORHAM  
**Project Number:** 6196501

**Lab Number:** L0706026  
**Report Date:** 05/08/07

**SAMPLE RESULTS**

**Lab ID:** L0706026-06  
**Client ID:** RM 110  
**Sample Location:** PROVIDENCE, RI

**Date Collected:** 04/26/07 13:12  
**Date Received:** 04/26/07  
**Field Prep:** Not Specified

Parameter	ppbv		ug/m <sup>3</sup>		Qualifier	Dilution Factor
	Results	RDL	Results	RDL		
<b>Volatile Organic Compounds in Air by SIM</b>						
Ethylbenzene	0.091	0.020	0.395	0.087		1
Methyl tert butyl ether	ND	0.020	ND	0.072		1
p,m-Xylene	0.283	0.040	1.23	0.174		1
o-Xylene	0.077	0.020	0.334	0.087		1
Styrene	0.022	0.020	0.094	0.085		1
Tetrachloroethene	0.038	0.020	0.260	0.136		1
Toluene	0.641	0.020	2.41	0.075		1
trans-1,2-Dichloroethene	ND	0.020	ND	0.079		1
trans-1,3-Dichloropropene	ND	0.020	ND	0.091		1
Trichloroethene	0.023	0.020	0.122	0.107		1
Trichlorofluoromethane	0.356	0.050	2.00	0.280		1
Vinyl chloride	ND	0.020	ND	0.051		1

**Project Name:** ADELAIDE AVE-GORHAM  
**Project Number:** 6196501

**Lab Number:** L0706026  
**Report Date:** 05/08/07

**SAMPLE RESULTS**

**Lab ID:** L0706026-07  
**Client ID:** RM 145  
**Sample Location:** PROVIDENCE, RI  
**Matrix:** Air  
**Analytical Method:** 48, TO-15  
**Analytical Date:** 04/30/07 03:28  
**Analyst:** HM

**Date Collected:** 04/26/07 13:28  
**Date Received:** 04/26/07  
**Field Prep:** Not Specified

Parameter	ppbv		ug/m <sup>3</sup>		Qualifier	Dilution Factor
	Results	RDL	Results	RDL		
1,1,1-Trichloroethane	ND	0.500	ND	2.72		1
1,1,2,2-Tetrachloroethane	ND	0.500	ND	3.43		1
1,1,2-Trichloroethane	ND	0.500	ND	2.72		1
1,1-Dichloroethane	ND	0.500	ND	2.02		1
1,1-Dichloroethene	ND	0.500	ND	1.98		1
1,2,4-Trimethylbenzene	3.78	0.500	18.6	2.46		1
1,2-Dibromoethane	ND	0.500	ND	3.84		1
1,2-Dichlorobenzene	ND	0.500	ND	3.00		1
1,2-Dichloroethane	ND	0.500	ND	2.02		1
1,2-Dichloropropane	ND	0.500	ND	2.31		1
1,3,5-Trimethylbenzene	2.08	0.500	10.2	2.46		1
1,3-Dichlorobenzene	ND	0.500	ND	3.00		1
1,4-Dichlorobenzene	ND	0.500	ND	3.00		1
2-Butanone	ND	0.500	ND	1.47		1
Acetone	7.82	2.00	18.6	4.75		1
Benzene	ND	0.500	ND	1.60		1
Bromodichloromethane	ND	0.500	ND	3.35		1
Bromoform	ND	0.500	ND	5.16		1
Carbon tetrachloride	ND	0.500	ND	3.14		1
Chlorobenzene	ND	0.500	ND	2.30		1
Chloroethane	ND	0.500	ND	1.32		1
Chloroform	ND	0.500	ND	2.44		1
Chloromethane	ND	0.500	ND	1.03		1
cis-1,2-Dichloroethene	ND	0.500	ND	1.98		1
cis-1,3-Dichloropropene	ND	0.500	ND	2.27		1



**Project Name:** ADELAIDE AVE-GORHAM  
**Project Number:** 6196501

**Lab Number:** L0706026  
**Report Date:** 05/08/07

### SAMPLE RESULTS

**Lab ID:** L0706026-07  
**Client ID:** RM 145  
**Sample Location:** PROVIDENCE, RI

**Date Collected:** 04/26/07 13:28  
**Date Received:** 04/26/07  
**Field Prep:** Not Specified

Parameter	ppbv		ug/m <sup>3</sup>		Qualifier	Dilution Factor
	Results	RDL	Results	RDL		
<b>Volatile Organic Compounds in Air</b>						
Dibromochloromethane	ND	0.500	ND	4.26		1
Dichlorodifluoromethane	ND	1.00	ND	4.94		1
Ethylbenzene	ND	0.500	ND	2.17		1
Methylene chloride	ND	0.800	ND	2.78		1
4-Methyl-2-pentanone	ND	0.500	ND	2.05		1
Methyl tert butyl ether	ND	0.500	ND	1.80		1
p/m-Xylene	1.47	1.00	6.38	4.34		1
o-Xylene	0.530	0.500	2.30	2.17		1
Styrene	ND	0.500	ND	2.13		1
Tetrachloroethene	ND	0.500	ND	3.39		1
Toluene	3.84	0.500	14.4	1.88		1
trans-1,2-Dichloroethene	ND	0.500	ND	1.98		1
trans-1,3-Dichloropropene	ND	0.500	ND	2.27		1
Trichloroethene	ND	0.500	ND	2.68		1
Trichlorofluoromethane	ND	0.500	ND	2.81		1
Vinyl chloride	ND	0.500	ND	1.28		1
Acrylonitrile	ND	0.500	ND	1.08		1
1,1,1,2-Tetrachloroethane	ND	0.500	ND	3.43		1
Isopropylbenzene	ND	0.500	ND	2.46		1
n-Butylbenzene	ND	0.500	ND	2.74		1
sec-Butylbenzene	ND	0.500	ND	2.74		1
p-Isopropyltoluene	ND	0.500	ND	2.74		1

**Project Name:** ADELDAIDE AVE-GORHAM  
**Project Number:** 6196501

**Lab Number:** L0706026  
**Report Date:** 05/08/07

**SAMPLE RESULTS**

**Lab ID:** L0706026-07  
**Client ID:** RM 145  
**Sample Location:** PROVIDENCE, RI  
**Matrix:** Air  
**Analytical Method:** 48, TO-15-SIM  
**Analytical Date:** 05/06/07 22:57  
**Analyst:** HM

**Date Collected:** 04/26/07 13:28  
**Date Received:** 04/26/07  
**Field Prep:** Not Specified

Parameter	ppbv		ug/m <sup>3</sup>		Qualifier	Dilution Factor
	Results	RDL	Results	RDL		
1,1,1-Trichloroethane	0.022	0.020	0.118	0.109		1
1,1,1,2-Tetrachloroethane	ND	0.020	ND	0.137		1
1,1,2,2-Tetrachloroethane	ND	0.020	ND	0.137		1
1,1,2-Trichloroethane	ND	0.020	ND	0.109		1
1,1-Dichloroethane	ND	0.020	ND	0.081		1
1,1-Dichloroethane	ND	0.020	ND	0.079		1
1,2,4-Trimethylbenzene	4.51	0.020	22.2	0.098		1
1,2-Dibromoethane	ND	0.020	ND	0.154		1
1,2-Dichlorobenzene	ND	0.020	ND	0.120		1
1,2-Dichloroethane	0.029	0.020	0.119	0.081		1
1,2-Dichloropropane	ND	0.020	ND	0.092		1
1,3,5-Trimethylbenzene	2.85	0.020	14.0	0.098		1
1,3-Dichlorobenzene	ND	0.020	ND	0.120		1
1,4-Dichlorobenzene	ND	0.020	ND	0.120		1
Benzene	0.225	0.020	0.718	0.064		1
Bromodichloromethane	ND	0.020	ND	0.134		1
Bromoform	ND	0.020	ND	0.206		1
Carbon tetrachloride	0.117	0.020	0.734	0.126		1
Chlorobenzene	ND	0.020	ND	0.092		1
Chloroethane	ND	0.020	ND	0.053		1
Chloroform	0.033	0.020	0.161	0.098		1
cis-1,2-Dichloroethane	ND	0.020	ND	0.079		1
cis-1,3-Dichloropropene	ND	0.020	ND	0.091		1
Dibromochloromethane	ND	0.020	ND	0.096		1
Dichlorodifluoromethane	0.603	0.050	2.98	0.250		1

**Project Name:** ADELAIDE AVE-GORHAM  
**Project Number:** 6196501

**Lab Number:** L0706026  
**Report Date:** 05/08/07

**SAMPLE RESULTS**

**Lab ID:** L0706026-07  
**Client ID:** RM 145  
**Sample Location:** PROVIDENCE, RI

**Date Collected:** 04/26/07 13:28  
**Date Received:** 04/26/07  
**Field Prep:** Not Specified

Parameter	ppbv		ug/m <sup>3</sup>		Qualifier	Dilution Factor
	Results	RDL	Results	RDL		
<b>Volatile Organic Compounds in Air by SIM</b>						
Ethylbenzene	0.747	0.020	3.24	0.087		1
Methyl tert butyl ether	ND	0.020	ND	0.072		1
p/m-Xylene	2.49	0.040	10.8	0.174		1
o-Xylene	0.832	0.020	3.61	0.087		1
Styrene	0.124	0.020	0.528	0.085		1
Tetrachloroethene	0.056	0.020	0.377	0.136		1
Toluene	4.79	0.020	18.0	0.075		1
trans-1,2-Dichloroethene	ND	0.020	ND	0.079		1
trans-1,3-Dichloropropene	ND	0.020	ND	0.091		1
Trichloroethene	0.037	0.020	0.200	0.107		1
Trichlorofluoromethane	0.328	0.050	1.84	0.280		1
Vinyl chloride	ND	0.020	ND	0.051		1

**Project Name:** ADELAIDE AVE-GORHAM  
**Project Number:** 6196501

**Lab Number:** L0706026  
**Report Date:** 05/08/07

### SAMPLE RESULTS

**Lab ID:** L0706026-08  
**Client ID:** RM 152  
**Sample Location:** PROVIDENCE, RI  
**Matrix:** Air  
**Analytical Method:** 48, TO-15  
**Analytical Date:** 04/30/07 04:03  
**Analyst:** HM

**Date Collected:** 04/26/07 13:30  
**Date Received:** 04/26/07  
**Field Prep:** Not Specified

Parameter	ppbv		ug/m <sup>3</sup>		Qualifier	Dilution Factor
	Results	RDL	Results	RDL		
<b>Volatile Organic Compounds in Air</b>						
1,1,1-Trichloroethane	ND	0.500	ND	2.72		1
1,1,2,2-Tetrachloroethane	ND	0.500	ND	3.43		1
1,1,2-Trichloroethane	ND	0.500	ND	2.72		1
1,1-Dichloroethane	ND	0.500	ND	2.02		1
1,1-Dichloroethene	ND	0.500	ND	1.98		1
1,2,4-Trimethylbenzene	1.22	0.500	5.99	2.46		1
1,2-Dibromoethane	ND	0.500	ND	3.84		1
1,2-Dichlorobenzene	ND	0.500	ND	3.00		1
1,2-Dichloroethane	ND	0.500	ND	2.02		1
1,2-Dichloropropane	ND	0.500	ND	2.31		1
1,3,5-Trimethylbenzene	0.610	0.500	3.00	2.46		1
1,3-Dichlorobenzene	ND	0.500	ND	3.00		1
1,4-Dichlorobenzene	ND	0.500	ND	3.00		1
2-Butanone	2.03	0.500	5.98	1.47		1
Acetone	8.10	2.00	19.2	4.75		1
Benzene	ND	0.500	ND	1.60		1
Bromodichloromethane	ND	0.500	ND	3.35		1
Bromoform	ND	0.500	ND	5.16		1
Carbon tetrachloride	ND	0.500	ND	3.14		1
Chlorobenzene	ND	0.500	ND	2.30		1
Chloroethane	ND	0.500	ND	1.32		1
Chloroform	ND	0.500	ND	2.44		1
Chloromethane	ND	0.500	ND	1.03		1
cis-1,2-Dichloroethane	ND	0.500	ND	1.98		1
cis-1,3-Dichloropropene	ND	0.500	ND	2.27		1

**Project Name:** ADELAIDE AVE-GORHAM  
**Project Number:** 6196501

**Lab Number:** L0706026  
**Report Date:** 05/08/07

### SAMPLE RESULTS

**Lab ID:** L0706026-08  
**Client ID:** RM 152  
**Sample Location:** PROVIDENCE, RI

**Date Collected:** 04/26/07 13:30  
**Date Received:** 04/26/07  
**Field Prep:** Not Specified

Parameter	ppbv		ug/m <sup>3</sup>		Qualifier	Dilution Factor
	Results	RDL	Results	RDL		
Dibromochloromethane	ND	0.500	ND	4.26		1
Dichlorodifluoromethane	ND	1.00	ND	4.94		1
Ethylbenzene	ND	0.500	ND	2.17		1
Methylene chloride	ND	0.800	ND	2.78		1
4-Methyl-2-pentanone	1.19	0.500	4.87	2.05		1
Methyl tert butyl ether	ND	0.500	ND	1.80		1
p/m-Xylene	1.50	1.00	6.51	4.34		1
o-Xylene	ND	0.500	ND	2.17		1
Styrene	ND	0.500	ND	2.13		1
Tetrachloroethene	ND	0.500	ND	3.39		1
Toluene	4.15	0.500	15.6	1.88		1
trans-1,2-Dichloroethene	ND	0.500	ND	1.98		1
trans-1,3-Dichloropropene	ND	0.500	ND	2.27		1
Trichloroethene	ND	0.500	ND	2.68		1
Trichlorofluoromethane	ND	0.500	ND	2.81		1
Vinyl chloride	ND	0.500	ND	1.28		1
Acrylonitrile	ND	0.500	ND	1.08		1
1,1,1,2-Tetrachloroethane	ND	0.500	ND	3.43		1
Isopropylbenzene	ND	0.500	ND	2.46		1
n-Butylbenzene	ND	0.500	ND	2.74		1
sec-Butylbenzene	ND	0.500	ND	2.74		1
p-Isopropyltoluene	ND	0.500	ND	2.74		1

**Project Name:** ADELAIDE AVE-GORHAM  
**Project Number:** 6196501

**Lab Number:** L0706026  
**Report Date:** 05/08/07

### SAMPLE RESULTS

**Lab ID:** L0706026-08  
**Client ID:** RM 152  
**Sample Location:** PROVIDENCE, RI  
**Matrix:** Air  
**Analytical Method:** 48, TO-15-SIM  
**Analytical Date:** 05/06/07 23:36  
**Analyst:** HM

**Date Collected:** 04/26/07 13:30  
**Date Received:** 04/26/07  
**Field Prep:** Not Specified

Parameter	ppbv		ug/m <sup>3</sup>		Qualifier	Dilution Factor
	Results	RDL	Results	RDL		
1,1,1-Trichloroethane	0.021	0.020	0.114	0.109		1
1,1,1,2-Tetrachloroethane	ND	0.020	ND	0.137		1
1,1,2,2-Tetrachloroethane	ND	0.020	ND	0.137		1
1,1,2-Trichloroethane	ND	0.020	ND	0.109		1
1,1-Dichloroethane	ND	0.020	ND	0.081		1
1,1-Dichloroethane	ND	0.020	ND	0.079		1
1,2,4-Trimethylbenzene	1.48	0.020	7.26	0.098		1
1,2-Dibromoethane	ND	0.020	ND	0.154		1
1,2-Dichlorobenzene	ND	0.020	ND	0.120		1
1,2-Dichloroethane	0.027	0.020	0.108	0.081		1
1,2-Dichloropropane	ND	0.020	ND	0.092		1
1,3,5-Trimethylbenzene	0.872	0.020	4.28	0.098		1
1,3-Dichlorobenzene	ND	0.020	ND	0.120		1
1,4-Dichlorobenzene	ND	0.020	ND	0.120		1
Benzene	0.262	0.020	0.835	0.064		1
Bromodichloromethane	ND	0.020	ND	0.134		1
Bromoform	ND	0.020	ND	0.206		1
Carbon tetrachloride	0.114	0.020	0.717	0.126		1
Chlorobenzene	ND	0.020	ND	0.092		1
Chloroethane	ND	0.020	ND	0.053		1
Chloroform	0.032	0.020	0.155	0.098		1
cis-1,2-Dichloroethene	ND	0.020	ND	0.079		1
cis-1,3-Dichloropropene	ND	0.020	ND	0.091		1
Dibromochloromethane	ND	0.020	ND	0.096		1
Dichlorodifluoromethane	0.619	0.050	3.06	0.250		1

**Project Name:** ADELAIDE AVE-GORHAM  
**Project Number:** 6196501

**Lab Number:** L0706026  
**Report Date:** 05/08/07

### SAMPLE RESULTS

**Lab ID:** L0706026-08  
**Client ID:** RM 152  
**Sample Location:** PROVIDENCE, RI

**Date Collected:** 04/26/07 13:30  
**Date Received:** 04/26/07  
**Field Prep:** Not Specified

Parameter	ppbv		ug/m <sup>3</sup>		Qualifier	Dilution Factor
	Results	RDL	Results	RDL		
<b>Volatile Organic Compounds in Air by SIM</b>						
Ethylbenzene	0.801	0.020	3.47	0.087		1
Methyl tert butyl ether	ND	0.020	ND	0.072		1
p/m-Xylene	2.70	0.040	11.7	0.174		1
o-Xylene	0.622	0.020	2.70	0.087		1
Styrene	0.093	0.020	0.394	0.085		1
Tetrachloroethene	0.047	0.020	0.320	0.136		1
Toluene	>5	.02	>18.8	.0753		1
trans-1,2-Dichloroethene	ND	0.020	ND	0.079		1
trans-1,3-Dichloropropene	ND	0.020	ND	0.091		1
Trichloroethene	0.082	0.020	0.441	0.107		1
Trichlorofluoromethane	0.332	0.050	1.86	0.280		1
Vinyl chloride	ND	0.020	ND	0.051		1

**Project Name:** ADELAIDE AVE-GORHAM  
**Project Number:** 6196501

**Lab Number:** L0706026  
**Report Date:** 05/08/07

**Method Blank Analysis**  
**Batch Quality Control**

**Analytical Method:** 48.TO-15  
**Analytical Date:** 04/29/07 17:33

Parameter	ppbv		ug/m <sup>3</sup>		Qualifier	Dilution Factor
	Results	RDL	Results	RDL		
<b>Volatile Organic Compounds in Air for sample(s): 01-08 Batch: WG278471-5</b>						
1,1,1-Trichloroethane	ND	0.500	ND	2.72		1
1,1,2,2-Tetrachloroethane	ND	0.500	ND	3.43		1
1,1,2-Trichloroethane	ND	0.500	ND	2.72		1
1,1-Dichloroethane	ND	0.500	ND	2.02		1
1,1-Dichloroethene	ND	0.500	ND	1.98		1
1,2,4-Trimethylbenzene	ND	0.500	ND	2.46		1
1,2-Dibromoethane	ND	0.500	ND	3.84		1
1,2-Dichlorobenzene	ND	0.500	ND	3.00		1
1,2-Dichloroethane	ND	0.500	ND	2.02		1
1,2-Dichloropropane	ND	0.500	ND	2.31		1
1,3,5-Trimethylbenzene	ND	0.500	ND	2.46		1
1,3-Dichlorobenzene	ND	0.500	ND	3.00		1
1,4-Dichlorobenzene	ND	0.500	ND	3.00		1
2-Butanone	ND	0.500	ND	1.47		1
Acetone	ND	2.00	ND	4.75		1
Benzene	ND	0.500	ND	1.60		1
Bromodichloromethane	ND	0.500	ND	3.35		1
Bromoform	ND	0.500	ND	5.16		1
Carbon tetrachloride	ND	0.500	ND	3.14		1
Chlorobenzene	ND	0.500	ND	2.30		1
Chloroethane	ND	0.500	ND	1.32		1
Chloroform	ND	0.500	ND	2.44		1
Chloromethane	ND	0.500	ND	1.03		1
cis-1,2-Dichloroethene	ND	0.500	ND	1.98		1
cis-1,3-Dichloropropene	ND	0.500	ND	2.27		1



**Project Name:** ADELAIDE AVE-GORHAM  
**Project Number:** 6196501

**Lab Number:** L0706026  
**Report Date:** 05/08/07

**Method Blank Analysis  
Batch Quality Control**

**Analytical Method:** 48.TO-15  
**Analytical Date:** 04/29/07 17:33

Parameter	ppbv		ug/m <sup>3</sup>		Dilution Factor
	Results	RDL	Results	RDL	
<b>Volatile Organic Compounds in Air for sample(s): 01-08 Batch: WG278471-5</b>					
Dibromochloromethane	ND	0.500	ND	4.26	1
Dichlorodifluoromethane	ND	1.00	ND	4.94	1
Ethylbenzene	ND	0.500	ND	2.17	1
Methylene chloride	ND	0.800	ND	2.78	1
4-Methyl-2-pentanone	ND	0.500	ND	2.05	1
Methyl tert butyl ether	ND	0.500	ND	1.80	1
p/m-Xylene	ND	1.00	ND	4.34	1
o-Xylene	ND	0.500	ND	2.17	1
Styrene	ND	0.500	ND	2.13	1
Tetrachloroethene	ND	0.500	ND	3.39	1
Toluene	ND	0.500	ND	1.88	1
trans-1,2-Dichloroethene	ND	0.500	ND	1.98	1
trans-1,3-Dichloropropene	ND	0.500	ND	2.27	1
Trichloroethene	ND	0.500	ND	2.68	1
Trichlorofluoromethane	ND	0.500	ND	2.81	1
Vinyl chloride	ND	0.500	ND	1.28	1
Acrylonitrile	ND	0.500	ND	1.08	1
1,1,1,2-Tetrachloroethane	ND	0.500	ND	3.43	1
Isopropylbenzene	ND	0.500	ND	2.46	1
n-Butylbenzene	ND	0.500	ND	2.74	1
sec-Butylbenzene	ND	0.500	ND	2.74	1
p-Isopropyltoluene	ND	0.500	ND	2.74	1

**Project Name:** ADELAIDE AVE-GORHAM  
**Project Number:** 6196501

**Lab Number:** L0706026  
**Report Date:** 05/08/07

**Method Blank Analysis  
Batch Quality Control**

**Analytical Method:** 48, TO-15-SIM  
**Analytical Date:** 05/06/07 18:04

Parameter	ppbv		ug/m <sup>3</sup>		Qualifier	Dilution Factor
	Results	RDL	Results	RDL		
<b>Volatile Organic Compounds in Air by SIM for sample(s): 01-08 Batch: WG279328-2</b>						
1,1,1-Trichloroethane	ND	0.020	ND	0.109		1
1,1,1,2-Tetrachloroethane	ND	0.020	ND	0.137		1
1,1,2,2-Tetrachloroethane	ND	0.020	ND	0.137		1
1,1,2-Trichloroethane	ND	0.020	ND	0.109		1
1,1-Dichloroethane	ND	0.020	ND	0.081		1
1,1-Dichloroethene	ND	0.020	ND	0.079		1
1,2,4-Trimethylbenzene	ND	0.020	ND	0.098		1
1,2-Dibromoethane	ND	0.020	ND	0.154		1
1,2-Dichlorobenzene	ND	0.020	ND	0.120		1
1,2-Dichloroethane	ND	0.020	ND	0.081		1
1,2-Dichloropropane	ND	0.020	ND	0.092		1
1,3,5-Trimethylbenzene	ND	0.020	ND	0.098		1
1,3-Dichlorobenzene	ND	0.020	ND	0.120		1
1,4-Dichlorobenzene	ND	0.020	ND	0.120		1
Benzene	ND	0.020	ND	0.064		1
Bromodichloromethane	ND	0.020	ND	0.134		1
Bromoform	ND	0.020	ND	0.206		1
Carbon tetrachloride	ND	0.020	ND	0.126		1
Chlorobenzene	ND	0.020	ND	0.092		1
Chloroethane	ND	0.020	ND	0.053		1
Chloroform	ND	0.020	ND	0.098		1
cis-1,2-Dichloroethene	ND	0.020	ND	0.079		1
cis-1,3-Dichloropropene	ND	0.020	ND	0.091		1
Dibromochloromethane	ND	0.020	ND	0.096		1
Dichlorodifluoromethane	ND	0.050	ND	0.250		1

**Project Name:** ADELAIDE AVE-GORHAM  
**Project Number:** 6196501

**Lab Number:** L0706026  
**Report Date:** 05/08/07

**Method Blank Analysis**  
**Batch Quality Control**

**Analytical Method:** 48.TO-15-SIM  
**Analytical Date:** 05/06/07 18:04

Parameter	ppbv		ug/m <sup>3</sup>		Qualifier	Dilution Factor
	Results	RDL	Results	RDL		
<b>Volatile Organic Compounds in Air by SIM for sample(s): 01-08 Batch: WG279328-2</b>						
Ethylbenzene	ND	0.020	ND	0.087		1
Methyl tert butyl ether	ND	0.020	ND	0.072		1
p/m-Xylene	ND	0.040	ND	0.174		1
o-Xylene	ND	0.020	ND	0.087		1
Styrene	ND	0.020	ND	0.085		1
Tetrachloroethene	ND	0.020	ND	0.136		1
Toluene	ND	0.020	ND	0.075		1
trans-1,2-Dichloroethene	ND	0.020	ND	0.079		1
trans-1,3-Dichloropropene	ND	0.020	ND	0.091		1
Trichloroethene	ND	0.020	ND	0.107		1
Trichlorofluoromethane	ND	0.050	ND	0.280		1
Vinyl chloride	ND	0.020	ND	0.051		1

### Lab Control Sample Analysis

Batch Quality Control

Project Name: ADELAIDE AVE-GORHAM  
 Project Number: 6196501

Lab Number: L0706026  
 Report Date: 05/08/07

Parameter	LCS %Recovery	LCSD %Recovery	%Recovery Limits	RPD	RPD Limits
Volatile Organic Compounds in Air Associated sample(s): 01-08 Batch: WG278471-4					
1,1,1-Trichloroethane	77	-	70-130	-	-
1,1,2,2-Tetrachloroethane	117	-	70-130	-	-
1,1,2-Trichloroethane	112	-	70-130	-	-
1,1-Dichloroethane	110	-	70-130	-	-
1,1-Dichloroethene	97	-	70-130	-	-
1,2,4-Trichlorobenzene	138	-	70-130	-	-
1,2,4-Trimethylbenzene	120	-	70-130	-	-
1,2-Dibromoethane	96	-	70-130	-	-
1,2-Dichlorobenzene	105	-	70-130	-	-
1,2-Dichloroethane	80	-	70-130	-	-
1,2-Dichloropropane	128	-	70-130	-	-
1,3,5-Trimethylbenzene	100	-	70-130	-	-
1,3-Butadiene	112	-	70-130	-	-
1,3-Dichlorobenzene	101	-	70-130	-	-
1,4-Dichlorobenzene	103	-	70-130	-	-
1,4-Dioxane	100	-	70-130	-	-
2,2,4-Trimethylpentane	129	-	70-130	-	-
2-Butanone	106	-	70-130	-	-
2-Hexanone	61	-	70-130	-	-
3-Chloropropene	105	-	70-130	-	-
4-Ethyltoluene	99	-	70-130	-	-

### Lab Control Sample Analysis

Batch Quality Control

**Project Name:** ADELAIDE AVE-GORHAM  
**Project Number:** 6196501

**Lab Number:** L0706026  
**Report Date:** 05/08/07

Parameter	LCS %Recovery	LCSD %Recovery	%Recovery Limits	RPD	RPD Limits
Volatile Organic Compounds in Air Associated sample(s): 01-08 Batch: WG278471-4					
Acetone	98	-	70-130	-	-
Benzene	104	-	70-130	-	-
Benzyl chloride	75	-	70-130	-	-
Bromodichloromethane	92	-	70-130	-	-
Bromoform	102	-	70-130	-	-
Bromomethane	70	-	70-130	-	-
Carbon disulfide	116	-	70-130	-	-
Carbon tetrachloride	78	-	70-130	-	-
Chlorobenzene	99	-	70-130	-	-
Chloroethane	108	-	70-130	-	-
Chloroform	91	-	70-130	-	-
Chloromethane	127	-	70-130	-	-
cis-1,2-Dichloroethane	110	-	70-130	-	-
cis-1,3-Dichloropropene	103	-	70-130	-	-
Cyclohexane	110	-	70-130	-	-
Dibromochloromethane	87	-	70-130	-	-
Dichlorodifluoromethane	86	-	70-130	-	-
Ethyl Alcohol	108	-	70-130	-	-
Ethyl Acetate	94	-	70-130	-	-
Ethylbenzene	99	-	70-130	-	-
1,1,2-Trichloro-1,2,2-Trifluoroethane	96	-	70-130	-	-

### Lab Control Sample Analysis

Batch Quality Control

**Project Name:** ADELAIDE AVE-GORHAM  
**Project Number:** 6196501

**Lab Number:** L0706026  
**Report Date:** 05/08/07

Parameter	LCS %Recovery	LCSD %Recovery	%Recovery Limits	RPD	RPD Limits
Volatile Organic Compounds in Air Associated sample(s): 01-08 Batch: WG278471-4					
1,2-Dichloro-1,1,2,2-tetrafluoroethane	94	-	70-130	-	
Hexachlorobutadiene	100	-	70-130	-	
isc-Propyl Alcohol	86	-	70-130	-	
Methylene chloride	125	-	70-130	-	
4-Methyl-2-pentanone	105	-	70-130	-	
Methyl tert butyl ether	95	-	70-130	-	
p/m-Xylene	94	-	70-130	-	
o-Xylene	101	-	70-130	-	
n-Heptane	130	-	70-130	-	
n-Hexane	129	-	70-130	-	
Propylene	127	-	70-130	-	
Styrene	87	-	70-130	-	
Tetrachloroethane	90	-	70-130	-	
Tetrahydrofuran	130	-	70-130	-	
Toluene	99	-	70-130	-	
trans-1,2-Dichloroethane	106	-	70-130	-	
trans-1,3-Dichloropropene	72	-	70-130	-	
Trichloroethene	103	-	70-130	-	
Trichlorofluoromethane	67	-	70-130	-	
Vinyl acetate	93	-	70-130	-	
Vinyl bromide	98	-	70-130	-	

### Lab Control Sample Analysis

Batch Quality Control

**Project Name:** ADELAIDE AVE-GORHAM  
**Project Number:** 6196501

**Lab Number:** L0706026  
**Report Date:** 05/08/07

Parameter	LCS %Recovery	LCSD %Recovery	%Recovery Limits	RPD	RPD Limits
Volatile Organic Compounds in Air Associated sample(s): 01-08 Batch: W6278471-4					
Vinyl chloride	112	-	70-130	-	-
Naphthalene	131	-	70-130	-	-
Propane	137	-	70-130	-	-
Acrylonitrile	106	-	70-130	-	-
Acrolein	84	-	70-130	-	-
1,1,1,2-Tetrachloroethane	81	-	70-130	-	-
Isopropylbenzene	89	-	70-130	-	-
1,2,3-Trichloropropane	89	-	70-130	-	-
Acetonitrile	118	-	70-130	-	-
Bromobenzene	85	-	70-130	-	-
Chlorodifluoromethane	116	-	70-130	-	-
Dichlorofluoromethane	91	-	70-130	-	-
Dibromomethane	96	-	70-130	-	-
Pentane	122	-	70-130	-	-
Octane	100	-	70-130	-	-
Tertiary-Amyl Methyl Ether	74	-	70-130	-	-
o-Chlorotoluene	86	-	70-130	-	-
p-Chlorotoluene	77	-	70-130	-	-
2,2-Dichloropropane	84	-	70-130	-	-
1,1-Dichloropropane	93	-	70-130	-	-
Isopropyl Ether	122	-	70-130	-	-

### Lab Control Sample Analysis

Batch Quality Control

**Project Name:** ADELAIDE AVE-GORHAM  
**Project Number:** 6196501

**Lab Number:** L0706026  
**Report Date:** 05/08/07

Parameter	LCS %Recovery	LCSD %Recovery	%Recovery Limits	RPD	RPD Limits
<b>Volatile Organic Compounds in Air Associated sample(s): 01-08 Batch: WG278471-4</b>					
Ethyl-Tert-Butyl-Ether	85	-	70-130	-	-
1,2,3-Trichlorobenzene	54	-	70-130	-	-
Ethyl ether	113	-	70-130	-	-
n-Butylbenzene	95	-	70-130	-	-
sec-Butylbenzene	85	-	70-130	-	-
tert-Butylbenzene	80	-	70-130	-	-
1,2-Dibromo-3-chloropropane	58	-	70-130	-	-
p-Isopropyltoluene	80	-	70-130	-	-
n-Propylbenzene	87	-	70-130	-	-
1,3-Dichloropropane	90	-	70-130	-	-
Methanol	93	-	70-130	-	-
Butane	93	-	70-130	-	-
Nonane (C9)	104	-	70-130	-	-
Decane (C10)	132	-	70-130	-	-
Undecane	147	-	70-130	-	-
Dodecane (C12)	88	-	70-130	-	-





### Lab Control Sample Analysis Batch Quality Control

**Project Name:** ADELAIDE AVE-GORHAM  
**Project Number:** 6196501

**Lab Number:** L0706026  
**Report Date:** 05/08/07

Parameter	LCS %Recovery	LCS D %Recovery	%Recovery Limits	RPD	RPD Limits
Volatile Organic Compounds in Air by SIM Associated sample(s): 01-08 Batch: WG279328-1					
cis-1,2-Dichloroethane	92	-	70-130	-	-
cis-1,3-Dichloropropene	90	-	70-130	-	-
Dibromochloromethane	87	-	70-130	-	-
Dichlorodifluoromethane	105	-	70-130	-	-
Ethylbenzene	77	-	70-130	-	-
Methyl tert butyl ether	95	-	70-130	-	-
p/m-Xylene	81	-	70-130	-	-
o-Xylene	77	-	70-130	-	-
Styrene	72	-	70-130	-	-
Tetrachloroethane	80	-	70-130	-	-
Toluene	74	-	70-130	-	-
trans-1,2-Dichloroethane	88	-	70-130	-	-
trans-1,3-Dichloropropene	88	-	70-130	-	-
Trichloroethane	84	-	70-130	-	-
Trichlorofluoromethane	104	-	70-130	-	-
Vinyl chloride	114	-	70-130	-	-

### Lab Duplicate Analysis Batch Quality Control

**Project Name:** ADELAIDE AVE-GORHAM  
**Project Number:** 6196501

**Lab Number:** L0706026  
**Report Date:** 05/08/07

Parameter	Native Sample	Duplicate Sample	Units	RPD	RPD Limits
<b>Volatile Organic Compounds in Air - Associated sample(s): 01-08 QC Batch ID: WG278471-3 QC Sample: L0705818-07 Client ID: DUP Sample</b>					
1,1,1-Trichloroethane	ND	ND	ppbv	NC	25
1,1,2,2-Tetrachloroethane	ND	ND	ppbv	NC	25
1,1,2-Trichloroethane	ND	ND	ppbv	NC	25
1,1-Dichloroethane	ND	ND	ppbv	NC	25
1,1-Dichloroethene	ND	ND	ppbv	NC	25
1,2,4-Trimethylbenzene	ND	ND	ppbv	NC	25
1,2-Dibromoethane	ND	ND	ppbv	NC	25
1,2-Dichlorobenzene	ND	ND	ppbv	NC	25
1,2-Dichloroethane	ND	ND	ppbv	NC	25
1,2-Dichloropropane	ND	ND	ppbv	NC	25
1,3,5-Trimethylbenzene	ND	ND	ppbv	NC	25
1,3-Dichlorobenzene	ND	ND	ppbv	NC	25
1,4-Dichlorobenzene	ND	ND	ppbv	NC	25
2-Butanone	ND	ND	ppbv	NC	25
Acetone	40.8	41.7	ppbv	2	25
Benzene	ND	ND	ppbv	NC	25
Bromodichloromethane	ND	ND	ppbv	NC	25
Bromoform	ND	ND	ppbv	NC	25
Carbon tetrachloride	ND	ND	ppbv	NC	25

### Lab Duplicate Analysis Batch Quality Control

**Project Name:** ADELAIDE AVE-GORHAM  
**Project Number:** 6196501

**Lab Number:** L0706026  
**Report Date:** 05/08/07

Parameter	Native Sample	Duplicate Sample	Units	RPD	RPD Limits
Volatile Organic Compounds in Air Associated sample(s): 01-08 QC Batch ID: WGZ78471-3 QC Sample: L0705818-07 Client ID: DUP Sample					
Chlorobenzene	ND	ND	ppbv	NC	25
Chloroethane	ND	ND	ppbv	NC	25
Chloroform	ND	ND	ppbv	NC	25
Chloromethane	ND	ND	ppbv	NC	25
cis-1,2-Dichloroethene	ND	ND	ppbv	NC	25
cis-1,3-Dichloropropene	ND	ND	ppbv	NC	25
Dibromochloromethane	ND	ND	ppbv	NC	25
Dichlorodifluoromethane	ND	ND	ppbv	NC	25
Ethylbenzene	ND	ND	ppbv	NC	25
Methylene chloride	ND	ND	ppbv	NC	25
4-Methyl-2-pentanone	ND	ND	ppbv	NC	25
Methyl tert butyl ether	ND	ND	ppbv	NC	25
p/m-Xylene	ND	ND	ppbv	NC	25
o-Xylene	ND	ND	ppbv	NC	25
Styrene	ND	ND	ppbv	NC	25
Tetrachloroethene	31.4	32.7	ppbv	4	25
Toluene	0.940	0.990	ppbv	5	25
trans-1,2-Dichloroethene	ND	ND	ppbv	NC	25
trans-1,3-Dichloropropene	ND	ND	ppbv	NC	25

### Lab Duplicate Analysis Batch Quality Control

**Project Name:** ADELAIDE AVE-GORHAM  
**Project Number:** 6196501

**Lab Number:** L0706026  
**Report Date:** 05/08/07

Parameter	Native Sample	Duplicate Sample	Units	RPD	RPD Limits
Volatile Organic Compounds in Air Associated sample(s): 01-08 QC Batch ID: WG278471-3 QC Sample: L0705818-07 Client ID: DUP Sample					
Trichloroethene	ND	ND	ppbv	NC	25
Trichlorofluoromethane	ND	ND	ppbv	NC	25
Vinyl chloride	ND	ND	ppbv	NC	25
Acrylonitrile	ND	ND	ppbv	NC	25
1,1,1,2-Tetrachloroethane	ND	ND	ppbv	NC	25
Isopropylbenzene	ND	ND	ppbv	NC	25
n-Butylbenzene	ND	ND	ppbv	NC	25
sec-Butylbenzene	ND	ND	ppbv	NC	25
p-Isopropyltoluene	ND	ND	ppbv	NC	25

### Lab Duplicate Analysis

Batch Quality Control

**Project Name:** ADELAIDE AVE-GORHAM  
**Project Number:** 6196501

**Lab Number:** L0706026  
**Report Date:** 05/08/07

Parameter	Native Sample	Duplicate Sample	Units	RPD	RPD Limits
Volatile Organic Compounds in Air by SIM Associated sample(s): 01-08 QC Batch ID: WG279328-3 QC Sample: L0706026-05 Client ID: RM 118					
1,1,1-Trichloroethane	0.026	0.031	ppbV	18	25
1,1,1,2-Tetrachloroethane	ND	ND	ppbV	NC	25
1,1,2,2-Tetrachloroethane	ND	ND	ppbV	NC	25
1,1,2-Trichloroethane	ND	ND	ppbV	NC	25
1,1-Dichloroethane	ND	ND	ppbV	NC	25
1,1-Dichloroethane	ND	ND	ppbV	NC	25
1,2,4-Trimethylbenzene	3.12	3.26	ppbV	4	25
1,2-Dibromoethane	ND	ND	ppbV	NC	25
1,2-Dichlorobenzene	ND	ND	ppbV	NC	25
1,2-Dichloroethane	0.025	0.026	ppbV	7	25
1,2-Dichloropropane	ND	ND	ppbV	NC	25
1,3,5-Trimethylbenzene	1.68	1.78	ppbV	6	25
1,3-Dichlorobenzene	ND	ND	ppbV	NC	25
1,4-Dichlorobenzene	ND	ND	ppbV	NC	25
Benzene	0.257	0.302	ppbV	16	25
Bromodichloromethane	ND	ND	ppbV	NC	25
Bromoforn	ND	ND	ppbV	NC	25
Carbon tetrachloride	0.117	0.138	ppbV	16	25
Chlorobenzene	ND	ND	ppbV	NC	25

### Lab Duplicate Analysis

Batch Quality Control

**Project Name:** ADELAIDE AVE-GORHAM  
**Project Number:** 6196501

**Lab Number:** L0706026  
**Report Date:** 05/08/07

Parameter	Native Sample	Duplicate Sample	Units	RPD	RPD Limits
<b>Volatile Organic Compounds in Air by SIM Associated sample(s): 01-08 QC Batch ID: WG279328-3 QC Sample: L0706026-05 Client ID: RM 118</b>					
Chloroethane	ND	ND	ppbv	NC	25
Chloroform	0.032	0.034	ppbv	6	25
cis-1,2-Dichloroethene	ND	ND	ppbv	NC	25
cis-1,3-Dichloropropene	ND	ND	ppbv	NC	25
Dibromochloromethane	ND	ND	ppbv	NC	25
Dichlorodifluoromethane	0.612	0.663	ppbv	8	25
Ethylbenzene	0.888	0.951	ppbv	7	25
Methyl tert butyl ether	0.034	0.041	ppbv	19	25
p/m-Xylene	3.24	3.44	ppbv	6	25
o-Xylene	0.828	0.883	ppbv	6	25
Styrene	0.089	0.095	ppbv	7	25
Tetrachloroethene	0.049	0.052	ppbv	6	25
Toluene	4.28	4.52	ppbv	5	25
trans-1,2-Dichloroethene	ND	ND	ppbv	NC	25
trans-1,3-Dichloropropene	ND	ND	ppbv	NC	25
Trichloroethene	0.039	0.042	ppbv	9	25
Trichlorofluoromethane	0.340	0.364	ppbv	7	25
Vinyl chloride	ND	ND	ppbv	NC	25

Project Name: ADELAIDE AVE-GORHAM

Lab Number: L0706026

Project Number: 6196501

Report Date: 05/08/07

## Sample Receipt and Container Information

Were project specific reporting limits specified? YES

## Cooler Information

Cooler Custody Seal

NA Absent

## Container Information

Container ID	Container Type	Cooler	pH	Temp	Pres	Seal	Analysis
L0706026-01A	Canister - 2.7 Liter	NA	NA	NA	NA	Absent	TO-15, TO15-SIM
L0706026-02A	Canister - 2.7 Liter	NA	NA	NA	NA	Absent	TO-15, TO15-SIM
L0706026-03A	Canister - 2.7 Liter	NA	NA	NA	NA	Absent	TO-15, TO15-SIM
L0706026-04A	Canister - 2.7 Liter	NA	NA	NA	NA	Absent	TO-15, TO15-SIM
L0706026-05A	Canister - 2.7 Liter	NA	NA	NA	NA	Absent	TO-15, TO15-SIM
L0706026-06A	Canister - 2.7 Liter	NA	NA	NA	NA	Absent	TO-15, TO15-SIM
L0706026-07A	Canister - 2.7 Liter	NA	NA	NA	NA	Absent	TO-15, TO15-SIM
L0706026-08A	Canister - 2.7 Liter	NA	NA	NA	NA	Absent	TO-15, TO15-SIM



Project Name: ADELAIDE AVE-GORHAM  
Project Number: 6196501

Lab Number: L0706026  
Report Date: 05/08/07

## GLOSSARY

### Acronyms

- EPA - Environmental Protection Agency.  
LCS - Laboratory Control Sample: A sample matrix, free from the analytes of interest, spiked with verified known amounts of analytes or a material containing known and verified amounts of analytes.  
LCSD - Laboratory Control Sample Duplicate: Refer to LCS.  
MS - Matrix Spike Sample: A sample prepared by adding a known mass of target analyte to a specified amount of matrix sample for which an independent estimate of target analyte concentration is available.  
MSD - Matrix Spike Sample Duplicate: Refer to MS.  
NA - Not Applicable.  
NC - Not Calculated: Term is utilized when one or more of the results utilized in the calculation are non-detect at the parameter's reporting unit.  
NID - Not detected at the reported detection limit for the sample.  
RDL - Reported Detection Limit: The value at which an instrument can accurately measure an analyte at a specific concentration. The RDL includes any adjustments from dilutions, concentrations or moisture content, where applicable.  
- Relative Percent Difference: The results from matrix and/or matrix spike duplicates are primarily designed to assess the precision of analytical results in a given matrix and are expressed as relative percent difference (RPD). Values which are less than five times the reporting limit for any individual parameter are evaluated by utilizing the absolute difference between the values; although the RPD value will be provided in the report.

### Terms

Analytical Method: Both the document from which the method originates and the analytical reference method. (Example: EPA 8260B is shown as 1,8260B.) The codes for the reference method documents are provided in the References section of the Addendum.

### Data Qualifiers

The following data qualifiers have been identified for use under the CT DEP Reasonable Confidence Protocols.

- A - Spectra identified as "Aldol Condensation Product".  
B - The analyte was detected above the reporting limit in the associated method blank. Flag only applies to associated field samples that have detectable concentrations of the analyte.  
E - Concentration of analyte exceeds the range of the calibration curve and/or linear range of the instrument.  
J - Estimated value. The analyte was tentatively identified; the quantitation is an estimation. (Tentatively identified compounds only.)

**Project Name:** ADELAIDE AVE-GORHAM  
**Project Number:** 6196501

**Lab Number:** L0706026  
**Report Date:** 05/08/07

#### REFERENCES

- 48 Compendium of Methods for the Determination of Toxic Organic Compounds in Ambient Air.  
Second Edition. EPA/625/R-96/010b, January 1999.

#### LIMITATION OF LIABILITIES

Alpha Woods Hole Labs performs services with reasonable care and diligence normal to the analytical testing laboratory industry. In the event of an error, the sole and exclusive responsibility of Alpha Woods Hole Labs shall be to re-perform the work at it's own expense. In no event shall Alpha Woods Hole Labs be held liable for any incidental, consequential or special damages, including but not limited to, damages in any way connected with the use of, interpretation of, information or analysis provided by Alpha Woods Hole Labs.

We strongly urge our clients to comply with EPA protocol regarding sample volume, preservation, cooling, containers, sampling procedures, holding time and splitting of samples in the field.



**AIR ANALYSIS**

PAGE 1 OF 1

Eight Walkup Drive Westborough, MA 01581  
 TEL: 508-898-9220 FAX: 508-898-9193

**Project Information**  
 Project Name: Abilade Ave - Gotham  
 Project Location: Prov, RI  
 Project #: 6196501  
 Project Manager: Peter Grivers  
 ALPHA Quote #: 401-736-3440  
 Turn-Around Time: Standard  
 Standard  
 RUSH (only confirmed if pre-approved!)

**Client Information**  
 Client: Engineering, Sci+Tech  
 Address: 2350 Post Rd  
Northwick, RI 02886  
 Phone: 401-736-3440  
 Fax: 401-736-3423  
 Email: pggrivers@east.com

Other Project Specific Requirements/Comments:

**Report Information - Data Deliverables**  
 Date Rec'd in Lab: 4/26/07  
 ALPHA Job #: L0706026  
 Billing Information:  Same as Client info PO #:  
 Report to: (if different than Project Manager)  
 Criteria Checker: Custom  
 Other Formats:  EMAIL (standard pdf report)  
 Additional Deliverables:  
 Regulatory Requirements/Report Limits  
 State/Fed Program Criteria  
 Draft Report (as indicated)  
Target Air Compounds

**ANALYSIS**

- TO-13: 10 DAYS
- TO-15 SIM
- APH
- DISSOLVED GASES
- FIXED GASES
- TO-13A
- TO-15 SULFOGEN/ACRYLAMS
- DISS GASES CO2 ONLY
- TO-4/TO-10

Sample Comments (i.e. PID)

ALPHA Lab ID (Lab Use Only)	Sample ID	Date	Collection	Start Time	End Time	Sample Matrix	Sampler's Initials	ID	ID-Flow	Container Type
6026-01	Gym	4-26-07	11:00	11:40	11:45	A	494	487	0037	X
-02	CAFÉ		11:15	11:45	11:50	A	494	0219		
-03	KITCH		11:30	12:00	12:00		130	0147		
-04	ELEV.		13:15	13:45	13:50		158	0158		
-05	RM. 118		12:35	13:05	13:10		152	0157		
-06	DM. 110		12:42	13:12	13:15		196	0160		
-07	RM. 145		12:55	13:25	13:30		199	0156		
-08	RM. 152		13:05	13:35	13:40		203	0155		

PID = 0.12ppm  
 = 0.056  
 = 0.027  
 = 0.047  
 = 0.081  
 = 0.099  
 = 0.085  
 = 0.076

**Shaded Gray Areas For Lab Use Only**

Relinquished By: \_\_\_\_\_ Date/Time: \_\_\_\_\_  
 Received By: \_\_\_\_\_ Date/Time: \_\_\_\_\_  
 4/26/07  
 4/26/07  
 12:16:10