

QUARTERLY MONITORING REPORT
Springfield Street School Complex
Providence, Rhode Island

Project No. 081-12152-01
March 2005 Monitoring Round

Prepared for
Providence School Department
797 Westminster Street
Providence, RI 02903

Prepared by
LFR Levine·Fricke
250 Centerville Road
Building E., Suite 12
Warwick, RI 02886



April 20, 2005

081-12152-01

Mr. Jeffrey Crawford
Rhode Island Department of Environmental Management
Office of Waste Management
235 Promenade Street
Providence, RI 02908-5767

Subject: Quarterly Monitoring for Springfield Street School Complex, 50 Springfield Street, Providence, RI – March 2005 Monitoring Round

Dear Mr. Crawford:

Quarterly monitoring was conducted between March 29 and April 6, 2005 at the above referenced site. The monitoring was performed in accordance with the *Long-Term Operation and Maintenance Plan and Site Contingency Plan* (O&M Plan) contained in the *Remedial Action Work Plan* prepared by ATC dated April 2, 1999, revised May 3, 1999 and May 9, 1999. The *Remedial Action Work Plan* (RAWP) was approved by the Rhode Island Department of Environmental Management (RIDEM) in a letter dated June 4, 1999.

Results of monitoring are provided in the following sections and in the attachments.

SOIL COVER MONITORING

LFR conducted a visual survey of the site for evidence of significant soil cover erosion, or for any areas where the orange snow fencing indicator barrier was visible. LFR did not observe any areas where the orange indicator barrier was visible during this monitoring event. We observed some areas where standing water was present as a result of rain events during and preceding the monitoring.

However, as noted in previous communication with RIDEM, we noted an area where holes had developed due to settling near the transformer behind the Middle school (see attached figure). These holes were repaired on April 14, 2005. Photographs of the holes before and after repair are provided in Attachment 5.

SUB-SLAB VENTILATION SYSTEM

The sub-slab ventilation system was inspected by LFR during the quarterly monitoring on March 31, 2005. The system was operating upon arrival for the monitoring events.

Influent and effluent air from the two blowers at the elementary school and the two blowers at the middle school was monitored. Samples of influent and effluent gas were collected at

each location and screened for methane, carbon dioxide, carbon monoxide, hydrogen sulfide, and volatile organic compounds (VOC). Results are provided in Table 1.

Methane, carbon monoxide, and hydrogen sulfide concentrations in the subslab ventilation system samples were below the Action Levels during this monitoring event. Carbon dioxide concentrations were measured at 0.1% (1,000 ppm) at each location. PID readings ranged from 3.2 to 6.0 ppm. A notification that the 5 ppm Action Limit was exceeded has already been made. The PID readings rose slowly then stabilized as air was extracted from a Tedlar bag, and the maximum reading was recorded. The slow rise was similar to the reaction the PID sometimes has to moisture in a sample. No odors or unusual conditions were observed.

PID readings above the Action Level were detected during the December 2004 monitoring event. In response, samples were collected in Tedlar bags and submitted to the laboratory for analysis by EPA method TO14, and arrangements were made to change the carbon in the carbon vessels. Service Tech, Inc. was contracted by the Providence School Department to remove and replace all of the activated carbon in the subslab ventilation systems. This work was completed in February 2005. Subslab ventilation system monitoring conducted in January 2005 and February 2005 (after carbon replacement), found PID readings below the Action Limits (see Table 2).

Air samples were collected on December 13, 2004. Results of analysis detected only low levels of compounds similar to those detected in soil gas samples. These results were submitted to RIDEM previously, and a table summarizing the results is attached as Table 3.

The PID is a non-specific instrument that responds to many different compounds. Compounds which can be detected by the PID include aromatics, ketones, aldehydes, amines, amides, chlorinated hydrocarbons, sulfur compounds, unsaturated hydrocarbons, alcohols, saturated hydrocarbons, ammonia, hydrogen sulfide, nitric oxide, bromine, and iodine. Under some circumstances elevated readings can also be caused by water vapor. Many of these compounds have very low odor thresholds, which would be noticed during the monitoring if they were present.

In response to the exceedance of the Action Level, we will perform PID monitoring of the subslab ventilation systems on a monthly basis during the next quarter.

INDOOR AIR MONITORING

Indoor air monitoring was conducted on using a Landtec Gem 2000 landfill gas monitor, a VRAE multigas meter, and a Mini Rae photoionization detector (PID). Results of monitoring are provided in the Table 4. No parameters were detected at concentrations above the action levels specified in the Remedial Action Work Plan during this round of monitoring.

The methane monitors at the middle school were being calibrated by Diamond Calibration personnel on March 31, 2005 when the monitoring was being performed. All of the sensors were functioning at the time of our inspection.

GROUNDWATER MONITORING

Five groundwater monitoring wells were sampled by LFR on April 6, 2005. Prior to sampling, the depth to water was gauged, and a volume of water equivalent to approximately three well volumes was removed from each well. Temperature, specific conductance, dissolved oxygen, and pH were measured in the field prior to sampling. Depth to groundwater ranged between 10.02 and 15.86 feet below the ground surface. Groundwater samples were collected in laboratory prepared sample jars and delivered under chain-of-custody protocol to Contest Laboratory in East Longmeadow, Massachusetts for analysis for volatile organic compounds by EPA method 8260. Groundwater sampling logs are provided as Attachment 1, and the laboratory report is provided as Attachment 2. Results of analysis of groundwater samples are summarized in Table 5.

No target analytes were detected in samples from wells ATC-2, ATC-3, ATC-4 or ATC-5. Trichloroethylene was detected in the groundwater sample from monitoring well ATC-1. The concentration of trichloroethylene detected, 1.1 $\mu\text{g/L}$, was well below the RIDEM GB objective of 540 $\mu\text{g/L}$.

SOIL GAS MONITORING

Soil gas monitoring was conducted at 29 locations on March 29, 2005. The sampling was conducted by placing an air sampling gripper cap on each well and attaching a piece of tubing. A volume of air equivalent to approximately 3 well volumes was removed from each well using an SKC Airchek Sampling pump. Soil gas was then screened using a Landtec Gem 2000 Landfill Gas Analyzer, a VRAE Multigas Monitor, and a MiniRae Photoionization Detector.

Air samples were also collected in new laboratory supplied Tedlar bags using the SKC Airchek Pump from wells WB-2 and MPL-2. The Tedlar bags were submitted to Con-test Analytical Laboratory for analysis for VOC via EPA method TO-14.

Soil Gas Field Monitoring Results

Soil gas samples were screened for methane, carbon monoxide, hydrogen sulfide, carbon dioxide, oxygen, and total VOCs. Soil gas survey results are provided in Table 6.

Methane readings were 0 or 0.1 % methane at all locations during the monitoring event. All locations were below the Action Level of 0.5%.

All PID readings for total VOCs were zero. All measurements for carbon monoxide and hydrogen sulfide were 0.

Carbon dioxide was detected at 21 locations with detectable concentrations ranging from 0% to 3.1% during the March 29, 2005 monitoring event. The carbon dioxide Action Level is 0.1%, and 15 readings exceeded the action level. The presence of carbon dioxide in soil gas is an indicator of subsurface bacterial activity and does not represent a threat to users of the property. Graphs presenting carbon dioxide, oxygen, and methane concentrations over time for seven representative wells are presented in Attachment 3.

Soil Gas Laboratory Results

In accordance with the O&M Plan, two soil gas samples were collected in Tedlar bags and submitted to Con-Test Analytical Laboratories for analysis by method TO-14. Results of the analysis are summarized in Table 7, and the laboratory report is provided in Attachment 4. Several compounds were detected at low concentrations. The results were typical of the concentrations and compounds which have been detected in previous monitoring events.

The Occupational Safety and Health Administration (OSHA) Permissible Exposure Limits (PELs) are provided in Table 7 for comparison purposes even though they are not applicable to soil gas, because it does not represent exposure point concentrations. The PELs are the average concentrations that OSHA allows to be present in a workplace without any respiratory protection or exposure controls. The concentrations detected in soil gas were well below the OSHA PELs.

CONCLUSIONS

Methane, carbon monoxide, and hydrogen sulfide concentrations did not exceed action levels in any soil gas samples, indoor air or subslab ventilation system samples. Carbon dioxide concentrations in soil gas exceeded the action level at some locations.

Monitoring at the inlet and outlet of the sub-slab ventilation system detected PID readings slightly above the Action Level (maximum of 6.0 compared to Action Level of 5.0 ppm) at the elementary school. No odors or other indicators of the presence of unusual conditions was detected. Elevated PID readings were not detected in the Site buildings or in the soil gas monitoring wells. In response to the PID reading above the Action Level, the subslab ventilation system inlet and outlet air streams will be monitored via the PID on a monthly basis during the next quarter.

The carbon in all six 2,000 pound carbon vessels was replaced with new carbon during this quarter.

MR. JEFFERY CRAWFORD

Rhode Island Department Environmental Management

April 20, 2005

Page 5



If you have any questions or require any additional information, please contact the undersigned at 401-738-3887.

Sincerely,

Jennifer Brown for:

Donna Holden Pallister, P.E.
Senior Engineer

A handwritten signature in black ink, appearing to read "T. Daley", written over a light blue horizontal line.

Thomas L. Daley
Senior Engineer

Cc: A. Sepe, City of Providence
R. Troiano, PPBA
J. Boffa, Providence School Department
S. Tremblay, Providence School Department

TABLES

Table 1
System Monitoring Notes
Springfield Street School Complex
Providence, Rhode Island
March 31, 2005

Monitoring Location	Methane % by volume VRAE / Landtec*	Carbon Dioxide % by volume	Oxygen % by volume	Carbon Monoxide PPM	Hydrogen Sulfide PPM	Organic Vapors PPM
Elementary School inlet 1	0 / 0.1	0.1	20.8	0	0	4.8
Elementary School inlet 2	0 / 0.1	0.1	20.9	0	0	5.6
Elementary School Outlet	0 / 0.1	0.1	20.9	0	0	6.0
Middle school front shed inlet	0 / 0.1	0.0	21.0	0	0	3.7
Middle school front shed after 2 nd carbon	0 / 0.1	0.0	21.1	0	0	4.1
Middle school back shed inlet	0 / 0.1	0.1	21.0	0	0	3.6
Middle school back shed after 2 nd carbon	0 / 0.1	0.1	20.9	0	0	3.2
Remedial Action Work Plan Action Levels	0.5	1,000 ppm (0.1 %)	NA	9 ppm	10 ppm	5 ppm

Measurements made with: Landtec Gem 2000, Mini Rae PID, VRAE Multigas Monitor

* First number is reading from VRAE Multigas Meter for % combustible gases, and second number is reading from Landtec Gem 2000 for % methane.

Sampling date: March 31, 2005

Measured by: Donna Pallister

Table 2
System Monitoring Before and After Carbon Replacement
Springfield Street School Complex
Providence, Rhode Island

Monitoring Date:	January 12, 2005			February 23, 2005		
Monitoring Location	Relative Humidity %	Organic Vapors 1 PPM	Organic Vapors 2 PPM	Relative Humidity %	Organic Vapors 1 PPM	Organic Vapors 2 PPM
Elementary School inlet 1	--	2.2	0.6	35.8	1.5	0.4
Elementary School inlet 2	--	0.8	0.2	21.3	1.0	0.2
Elementary School Outlet	26.7	1.0	ND	24.2	0.9	ND
Middle school front shed inlet	--	1.2	0.2	22.5	1.0	ND
Middle school front shed after 2 nd carbon	38.3	0.9	ND	23.9	ND	ND
Middle school back shed inlet	--	1.6	ND	33.8	1.4	ND
Middle school back shed after 2 nd carbon	77.4	2.1	0.6	34.4	0.4	ND
Remedial Action Work Plan Action Levels		5 ppm	5 ppm		5 ppm	5 ppm

Measurements made with:

Organic Vapors 1 - Mini Rae 2000

Organic Vapors 2 - HNU PID

Table 3
Results of Analysis of Air from Subslab Ventilation Systems
Springfield Street School Complex
Providence, Rhode Island
Samples Collected December 13, 2005

Compound	Results in Parts per Billion by Volume (ppbv)						OSHA PEL's
	Elementary School Blower 1 (inlet)	Elementary School Blower 2 (inlet)	Elementary School Outlet (after carbon)	Middle School Back (inlet)	Middle School Back Outlet (after carbon)	Middle School Front (inlet)	
Dichlorodifluoromethane	<0.5	<0.5	1.5	<0.5	8.2	1.0	1,000,000
Methylene Chloride	<0.5	<0.5	0.6	<0.5	<0.5	<0.5	25,000
Tetrachloroethylene	<0.5	<0.5	<0.5	<0.5	0.6	<0.5	100,000
Toluene	0.8	<0.5	1.3	0.7	1.3	0.7	200,000
Trichloroethylene	<0.5	<0.5	9.0	<0.5	<0.5	1.0	100,000
1,2,4-Trimethylbenzene	<0.5	<0.5	<0.5	0.6	1.1	1.9	*
PID reading (ppm as isobutylene)	43.4	17.6	4475	1453	1342	699	

< - indicates compound not detected above indicated detection limit

* OSHA has not established a PEL for 1,2,4-Trimethylbenzene; NIOSH recommends an exposure limit of 25,000 ppbv.

Table 4
Indoor Air Monitoring Results
Springfield Street School Complex
Providence, Rhode Island
March 31, 2005

Monitoring Location	Methane % by volume VRAE/ Landtec*	Carbon Dioxide % by volume	Oxygen % by volume	Carbon Monoxide PPM	Hydrogen Sulfide PPM	Organic Vapors PPM
E.S. Front office	0 / 0.1	0.0	21.3	0	0	0.7
E.S. Elevator Room	0 / 0.1	0.0	21.2	0	0	0.2
E.S. Electrical closet in Mech. Room	0 / 0.1	0.0	21.3	0	0	0.2
E.S. Gym storage closet	0 / 0.1	0.0	21.2	0	0	0.2
E.S. Elec. Closet 2 nd Floor	0 / 0.1	0.0	21.3	0	0	0.1
E.S. Library	0 / 0.1	0.0	21.2	0	0	0.2
E.S. Second Floor, Handicap Bathroom	0.1	0.0	21.1	0	0	0.1
E.S. Stairway Stair B	0.1	0.0	21.3	0	0	0.1
E.S. Room 106	0 / 0.1	0.0	21.1	0	0	0.1

Table 4
Indoor Air Monitoring Notes
Springfield Street School Complex
March 31, 2005

Monitoring Location	Methane % by volume VRAE/ Landtec*	Carbon Dioxide % by volume	Oxygen % by volume	Carbon Monoxide PPM	Hydrogen Sulfide PPM	Organic Vapors PPM
E.S. Cafeteria	0.1	0.0	21.2	0	0	0.2
M.S. Room 122	0.0	0.0	21.1	0	0	0.1
M.S. Front Office	0.0	0.0	21.1	0	0	0.2
M.S. Custodian Closet Comm. Room	0 / 0.1	0.0	21.1	0	0	0.3
M.S. stairway toward E.S.	0 / 0.1	0.0	21.1	0	0	0.2
M.S. Crack near door to outside near gym	0.0	0.0	21.1	0	0	0.1
M.S. Former Music Room	0.1	0.0	21.0	0	0	0.4
M.S. Closet 1 st Floor	0 / 0.1	0.0	21.0	0	0	0.2
M.S. Aud. Front near sensor	0 / 0.1	0.0	21.0	0	0	0.2
M.S. Room 207	0 / 0.1	0.0	21.1	0	0	0.1

Table 4
Indoor Air Monitoring Notes
Springfield Street School Complex
March 31, 2005

Monitoring Location	Methane % by volume VRAE/Landtec*	Carbon Dioxide % by volume	Oxygen % by volume	Carbon Monoxide PPM	Hydrogen Sulfide PPM	Organic Vapors PPM
M.S. Library	0 / 0.1	0.0	21.1	0	0	0.1
M.S. Janitor office	0 / 0.1	0.0	21.1	0	0	0.1
M.S. Elevator	0.0	0.0	21.1	0	0	0.1
M.S. Elevator Closet	0.0	0.0	21.0	0	0	0.1
Remedial Action Work Plan Action Levels	0.5	1,000 ppm (0.1%)	NA	9 ppm	10 ppm	5 ppm

Notes:

E.S. indicates Elementary School

M.S. indicates Middle School

Measurements made with: Landtec Gem 2000, Mini Rae PID, VRAE Multigas Monitor

* First number is reading from VRAE Multigas Meter for % combustible gases, and second number is reading from Landtec Gem 2000 for % methane.

Table 5
 Summary of Ground Water Sampling Results
 Springfield Street School Complex
 Springfield Street
 Providence, Rhode Island

Monitoring Wells	Compounds	Sampling Dates and Results in µg/L												RIDEM GB Groundwater Objective		
		2/28/2001	7/20/2001	*9- 12/20/2001	8/1/2002	8/28/2002	12/19/2002	3/18/2003	7/17/2003	11/5/2003	1/22/2004	5/21/2004	8/17/2004		12/2/2004	4/6/2005
ATC-1	Benzene	6.1	ND	18.9	0.9	ND	ND	ND	ND	ND	ND	ND	ND	ND	ND	140
	n-butylbenzene	1.7	ND	2.8	ND	ND	ND	ND	ND	ND	ND	ND	ND	ND	ND	NA
	sec-Butylbenzene	1.1	ND	4.1	ND	ND	ND	ND	ND	ND	ND	ND	ND	ND	ND	NA
	Ethylbenzene	4.5	ND	12.6	ND	ND	ND	ND	ND	ND	ND	ND	ND	ND	ND	1600
	Isopropylbenzene	ND	ND	1.8	ND	ND	ND	ND	ND	ND	ND	ND	ND	ND	ND	NA
	n-Propylbenzene	ND	ND	5.0	ND	ND	ND	ND	ND	ND	ND	ND	ND	ND	ND	NA
	MTBE	12.4	7.0	28.6	ND	ND	ND	ND	ND	ND	ND	ND	ND	ND	ND	5000
	Trichloroethylene	ND	ND	ND	ND	ND	ND	1.27	ND	ND	ND	ND	ND	ND	1.10	540
	Toluene	2.5	ND	8.2	ND	ND	ND	ND	ND	ND	ND	ND	ND	ND	ND	1700
	1,2,4-Trimethylbenzene	2.2	ND	8.2	ND	ND	ND	ND	ND	ND	ND	ND	ND	ND	ND	NA
	1,3,5-Trimethylbenzene	3.4	ND	5.2	ND	ND	ND	ND	ND	ND	ND	ND	ND	ND	ND	NA
	Xylenes	14.6	ND	37	ND	ND	ND	ND	ND	ND	ND	ND	ND	ND	ND	NA
	ATC-2	Chloroform	0.9	ND	ND	1.0	ND	ND	ND	ND	NS	1.1	1.0	ND	ND	NA
ATC-3	Toluene	ND	ND	ND	ND	NS	ND	ND	ND	3.03	ND	ND	ND	ND	1700	
ATC-4	Benzene	ND	ND	2.5	0.6	ND	ND	ND	ND	ND	ND	ND	ND	ND	140	
	Chlorobenzene	2.6	ND	57.3	2.7	5.18	ND	ND	ND	ND	ND	ND	0.60	ND	70	
	1,4-dichlorobenzene	4.2	ND	9.2	3.4	3.36	ND	ND	ND	ND	0.80	1.6	2.1	ND	NA	
	MTBE	ND	ND	ND	ND	ND	ND	1.19	9.55	1.06	2.90	0.6	ND	ND	5000	
	1,2,4-Trimethylbenzene	ND	ND	1.7	ND	ND	ND	ND	ND	ND	ND	ND	ND	ND	NA	
ATC-5	MTBE	ND	ND	2.2	NS	ND	ND	ND	NS	ND	ND	ND	ND	ND	5000	
	Chloroform	ND	ND	ND	ND	ND	ND	ND	NS	ND	ND	0.6	ND	ND	NA	
Sampled By:		ATC	ATC	ATC	ATC	LFR	LFR	LFR	LFR	LFR	LFR	LFR	LFR	LFR		

*ATC Monitoring Report for September through December 2001 did not list date samples were collected.
 ND is not detected above method detection limit
 NS is not sampled
 NA= No applicable standard exists
 MTBE is Methyl tert-Butyl Ether
 µg/L = micrograms per liter

Table 6
Soil Gas Survey Results
Springfield Street School Complex
Providence, Rhode Island
March 29, 2005

Monitoring Well	Methane % by volume	Carbon Dioxide % by volume	Oxygen % by volume	Carbon Monoxide PPM	Hydrogen Sulfide PPM	Organic Vapors PPM
WB-1	0.1	1.1	18.5	0	0	0
WB-2	0.0	0.0	20.8	0	0	0
WB-3	0.1	0.0	21.3	0	0	0
WB-4	0.1	0.0	21.5	0	0	0
WB-5	0.0	0.0	21.5	0	0	0
WB-6	0.0	0.0	21.5	0	0	0
WB-7	0.0	0.0	21.4	0	0	0
WB-8	0.0	0.0	21.5	0	0	0
WB-12	0.1	0.3	20.7	0	0	0
WB-13	0.0	0.0	21.3	0	0	0
WB-14	0.0	0.0	21.1	0	0	0
WB-15	0.0	0.3	20.3	0	0	0
EPL-1	0.0	0.1	20.9	0	0	0
EPL-2	0.1	0.2	21.0	0	0	0
EPL-3	0.1	1.3	19.1	0	0	0
EPL-4	0.1	1.1	16.2	0	0	0
EPL-5	0.1	0.8	17.8	0	0	0
ENE-1	0.0	0.3	20.0	0	0	0
MG1	0.0	2.0	18.2	0	0	0
MG2	0.0	0.8	20.2	0	0	0
MG3	0.0	0.0	21.4	0	0	0
MG4	0.0	0.1	21.0	0	0	0
MG5	0.0	1.1	19.9	0	0	0
MPL2	0.0	0.0	21.2	0	0	0
MPL3	0.0	1.9	18.3	0	0	0

Monitoring Well	Methane % by volume	Carbon Dioxide % by volume	Oxygen % by volume	Carbon Monoxide PPM	Hydrogen Sulfide PPM	Organic Vapors PPM
MPL5	0.0	3.1	16.6	0	0	0
MPL6	0.1	0.4	10.1	0	0	0
MPL7	0.0	2.2	15.0	0	0	0
MPL8	0.0	0.1	21.1	0	0	0
Remedial Action Work Plan Action Levels	0.5%	1,000 PPM (0.1%)	NA	9 PPM	10 PPM	5 PPM

Notes:

Sampled by: A. Cote

Weather Conditions: cloudy, rain showers / 45-50° F

Sampling Equipment: GEM 2000 Gas Analyzer & Extraction Monitor, VRAE Multi Gas Monitor, and MiniRae PID Meter

PPM = parts per million

Table 7
Soil Gas Laboratory Analysis Results
Springfield Street School Complex
March 29, 2005

Parameter	OSHA PELs (PPBv)	Results of Analysis in parts per billion by volume (PPBv)	
		MPL-2	WB-2
1,2,4-Trimethylbenzene	25,000*	1.2	1.0
1,3,5-Trimethylbenzene	25,000*	0.8	0.7
Ethyl benzene	100,000	<0.5	0.7
Toluene	200,000	3.1	3.2
O -Xylene	100,000	0.9	0.8
M/p-Xylene	100,000	0.9	<0.5

Table lists only detected compounds. See laboratory report for full list of analytes.

Occupational Safety and Health Administration (OSHA) PELs = Permissible Exposure Limits
from NIOSH Pocket Guide to Chemical Hazards

*No OSHA PEL established for this chemical; number given is NIOSH standard.

FIGURE

NOTES:

THE FOLLOWING MAP IS REFERENCED: ELEMENTARY & MIDDLE SCHOOLS, PROVIDENCE RHODE ISLAND, ISSUED FOR, CITY OF PROVIDENCE, GRADING AND SAMPLING LOCATION PLAN, PREPARED BY NORTHEAST ENGINEERS & CONSULTANTS, INC., DATED MAY 19, 1999, SCALE: 1"=50'.

THIS MAP HAS BEEN DIGITIZED FROM THE ABOVE REFERENCED MAP, AND SCALE IS APPROXIMATE. FOR USE WITH LFR REPORT ONLY.

LEGEND:

- PROPERTY LINE
- FENCELINE
- STORM DRAIN LINE
- SANITARY SEWER LINE
- CONTOUR
- EPL5 SOIL GAS MONITORING WELL
- ATC-4 ATC GROUNDWATER MONITORING WELL
- HVAC UNIT
- TRANSFORMER
- CB CATCH BASIN
- SVE SHED (LOCATION APPROXIMATE)
- AREAS OF SETTLING OR ERROSION (APPROXIMATE)

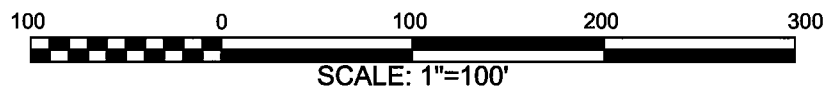
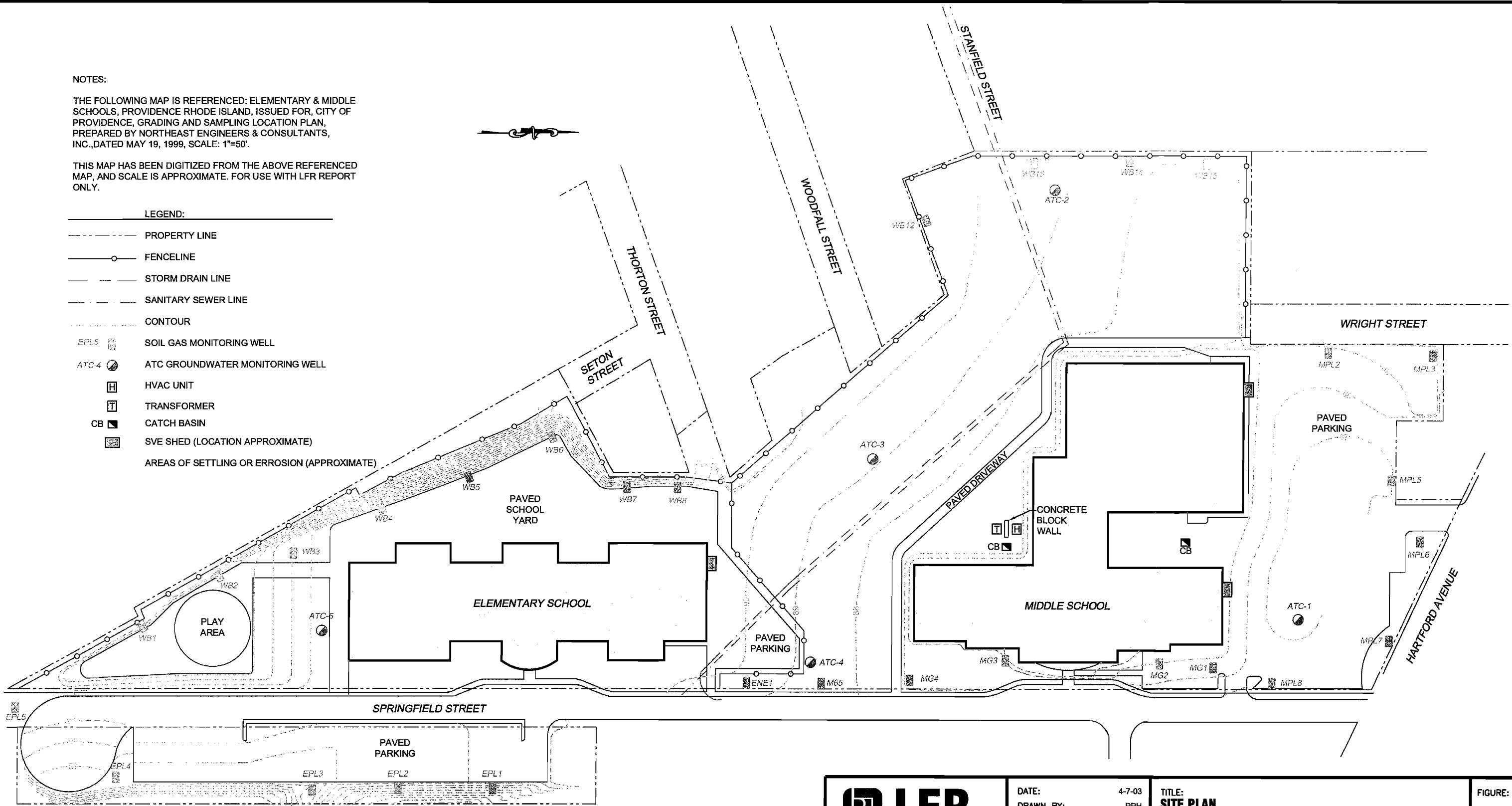

250 Centerville Road
Building E, Suite 12
Warwick, Rhode Island 02886
Phone: (401) 738-3887
Fax: (401) 732-1686

DATE: 4-7-03
DRAWN BY: PPH
REVIEWED BY: DP
APPROVED BY: DP
SCALE: AS NOTED
FILE NO: 081-12027-00
JOB NO: 081-12027-00

TITLE:
SITE PLAN

LOCATION:
**SPRINGFIELD STREET SCHOOL COMPLEX
SPRINGFIELD STREET
PROVIDENCE, RHODE ISLAND**

FIGURE:

1

Attachment 1

Groundwater Monitoring Logs



Well Number: ATC-1

Site Name: Springfield Street School

GROUNDWATER SAMPLING LOG

Project Number: 081-12152-01

Site Address: Springfield Street
Providence, RI

Sampled By: A. Cote	Date: 4/6/05
Weather: partly cloudy ~ 60°F	Purging Equipment: dedicated polyethylene bailer
Sampling Equipment: dedicated polyethylene bailer	Decontamination method:
Measuring Point (top of PVC/ top of casing): PVC	Depth to water: 11.57 (feet)
Casing diameter: 2 inch (inches)	Flush mount or riser:
Depth to Product: ND (feet)	Product thickness: NA (feet)
Depth to bottom: 20.78 (feet)	Length of Water Column (depth to bottom – depth to water): 9.21 (feet)
Well measuring point elevation: (feet)	Water table elevation: (feet)
Well volume: 5.7 (liters)	Three well volumes: (1.85 x length of water column for 2 inch well): 17 (liters)

FIELD MEASUREMENT DATA

Volume Removed (liters)	Temperature (°C)	Specific Conductance (uS/cm)	Dissolved Oxygen (mg/L)	pH (standard units)
14	14.5	0.0	0.62	5.33
15	13.1	2.1	0.96	5.32
16	13.4	5.0	0.95	5.30

Total volume Removed: 17

OBSERVATIONS:

Color of groundwater: Clear Odors: Yes Did well go dry: No



Well Number: ATC-2

Site Name: Springfield Street School

GROUNDWATER SAMPLING LOG

Project Number: 081-12152-01

Site Address: Springfield Street
Providence, RI

Sampled By: A. Cote	Date: 4/6/05
Weather: partly cloudy ~ 60°F	Purging Equipment: dedicated polyethylene bailer
Sampling Equipment: dedicated polyethylene bailer	Decontamination method:
Measuring Point (top of PVC/ top of casing): PVC	Depth to water: 10.02 (feet)
Casing diameter: 2 inch (inches)	Flush mount or riser: flush
Depth to Product: ND (feet)	Product thickness: NA (feet)
Depth to bottom: 18.65 (feet)	Length of Water Column (depth to bottom - depth to water): 8.63 (feet)
Well measuring point elevation: (feet)	Water table elevation: (feet)
Well volume: 5.3 (liters)	Three well volumes: (1.85 x length of water column for 2 inch well): 16.0 (liters)

FIELD MEASUREMENT DATA

Volume Removed (liters)	Temperature (°C)	Specific Conductance (uS/cm)	Dissolved Oxygen (mg/L)	pH (standard units)
13	16.4	1.2	1.41	5.29
14	14.6	1.5	1.43	5.28
15	13.0	375	1.53	5.28

Total volume Removed: 16

OBSERVATIONS:

Color of groundwater: Clear Odors: No Did well go dry: No



Well Number: ATC-3

Site Name: Springfield Street School

GROUNDWATER SAMPLING LOG

Project Number: 081-12152-01

Site Address: Springfield Street
Providence, RI

Sampled By: A. Cote	Date: 4/6/05
Weather: partly cloudy ~ 60°F	Purging Equipment: dedicated polyethylene bailer
Sampling Equipment: dedicated polyethylene bailer	Decontamination method:
Measuring Point (top of PVC/ top of casing): PVC	Depth to water: 10.75 (feet)
Casing diameter: 2 inch (inches)	Flush mount or riser: flush
Depth to Product: ND (feet)	Product thickness: NA (feet)
Depth to bottom: 15.98 (feet)	Length of Water Column (depth to bottom - depth to water): 5.23 (feet)
Well measuring point elevation: (feet)	Water table elevation: (feet)
Well volume: 3.2 (liters)	Three well volumes: (1.85 x length of water column for 2 inch well): 9.7 (liters)

FIELD MEASUREMENT DATA

Volume Removed (liters)	Temperature (°C)	Specific Conductance (uS/cm)	Dissolved Oxygen (mg/L)	pH (standard units)
7	9.9	3.1	0.80	5.33
8	10.3	2.0	1.03	5.31
9	10.5	1.4	1.38	5.28

Total volume Removed: 10

OBSERVATIONS:

Color of groundwater: Clear Odors: No Did well go dry: No



Well Number: ATC-4

Site Name: Springfield Street School

GROUNDWATER SAMPLING LOG

Project Number: 081-12152-01

Site Address: Springfield Street
Providence, RI

Sampled By: A. Cote	Date: 4/6/05
Weather: partly cloudy ~ 60°F	Purging Equipment: dedicated polyethylene bailer
Sampling Equipment: dedicated polyethylene bailer	Decontamination method:
Measuring Point (top of PVC/ top of casing): PVC	Depth to water: 11.56 (feet)
Casing diameter: 2 inch (inches)	Flush mount or riser: flush
Depth to Product: ND (feet)	Product thickness: NA (feet)
Depth to bottom: 23.70 (feet)	Length of Water Column (depth to bottom - depth to water): 12.14 (feet)
Well measuring point elevation: (feet)	Water table elevation: (feet)
Well volume: 7.5 (liters)	Three well volumes: (1.85 x length of water column for 2 inch well): 22 (liters)

FIELD MEASUREMENT DATA

Volume Removed (liters)	Temperature (°C)	Specific Conductance (uS/cm)	Dissolved Oxygen (mg/L)	pH (standard units)
19	15.4	336.1	0.64	5.31
20	14.4	50.6	0.85	5.30
21	13.8	207.6	1.17	5.30

Total volume Removed: 22

OBSERVATIONS:

Color of groundwater: cloudy Odors: No Did well go dry: No



Well Number: ATC-5

Site Name: Springfield Street School

GROUNDWATER SAMPLING LOG

Project Number: 081-12152-01

Site Address: Springfield Street
Providence, RI

Sampled By: A. Cote	Date: 4/6/05
Weather: partly cloudy ~ 60°F	Purging Equipment: dedicated polyethylene bailer
Sampling Equipment: dedicated polyethylene bailer	Decontamination method:
Measuring Point (top of PVC/ top of casing): PVC	Depth to water: 15.86 (feet)
Casing diameter: 2 inch (inches)	Flush mount or riser: flush
Depth to Product: ND (feet)	Product thickness: NA (feet)
Depth to bottom: 20.54 (feet)	Length of Water Column (depth to bottom - depth to water): 4.7 (feet)
Well measuring point elevation: (feet)	Water table elevation: (feet)
Well volume: 2.9 (liters)	Three well volumes: (1.85 x length of water column for 2 inch well): 8.7 (liters)

FIELD MEASUREMENT DATA

Volume Removed (liters)	Temperature (°C)	Specific Conductance (uS/cm)	Dissolved Oxygen (mg/L)	pH (standard units)
5	Well going dry - collected sample			

Total volume Removed: 2

OBSERVATIONS:

Color of groundwater: Clear Odors: No Did well go dry: Yes

Attachment 2

Laboratory Report for Groundwater



39 Spruce Street ° East Longmeadow, MA 01028 ° FAX 413/525-6405 ° TEL. 413/525-2332

REPORT DATE 4/12/2005

LEVINE FRICKE
250 CENTERVILLE RD., BLDG. E, SUITE 12
WARWICK, RI 02886
ATTN: DONNA PALLISTER

CONTRACT NUMBER:
PURCHASE ORDER NUMBER: 5131

PROJECT NUMBER:

ANALYTICAL SUMMARY

LIMS BAT #: LIMS-87387
JOB NUMBER: 081-12152-01

The results of analyses performed on the following samples submitted to the CON-TEST Analytical Laboratory are found in this report.

PROJECT LOCATION: SPRINGFIELD STREET SCHOOL

FIELD SAMPLE #	LAB ID	MATRIX	SAMPLE DESCRIPTION	TEST
ATC-1	05B12108	GRND WATER	NOT SPECIFIED	8260 water
ATC-2	05B12109	GRND WATER	NOT SPECIFIED	8260 water
ATC-3	05B12110	GRND WATER	NOT SPECIFIED	8260 water
ATC-4	05B12111	GRND WATER	NOT SPECIFIED	8260 water
ATC-5	05B12112	GRND WATER	NOT SPECIFIED	8260 water
TRIP BLANK	05B12113	WATER OTHE	NOT SPECIFIED	8260 water

The CON-TEST Environmental Laboratory operates under the following certifications and accreditations :

AIHA 100033	AIHA ELLAP (LEAD) 100033	
MASSACHUSETTS MA0100	NEW HAMPSHIRE NELAP 2516	NEW JERSEY NELAP NJ MA007 (AIR)
CONNECTICUT PH-0567	VERMONT DOH (LEAD) No. LL015036	ARIZONA AZ0648
NEW YORK ELAP/NELAP 10899	RHODE ISLAND (LIC. No. 112)	ARIZONA AZ0654 (AIR)

I certify that the analyses listed above, unless specifically listed as subcontracted, if any, were performed under my direction according to the approved methodologies listed in this document, and that based upon my inquiry of those individuals immediately responsible for obtaining the information, the material contained in this report is, to the best of my knowledge and belief, accurate and complete.

Sandra S. Kocot 04/12/05

Tod Kopyscinski
Director of Operations

Sondra S. Kocot
Quality Control Coordinator

SIGNATURE

DATE

Edward Denson
Technical Director



39 Spruce Street ° East Longmeadow, MA 01028 ° FAX 413/525-6405 ° TEL. 413/525-2332

DONNA PALLISTER
LEVINE FRICKE
250 CENTERVILLE RD., BLDG. E, SUITE 12
WARWICK, RI 02886

Purchase Order No.: 5131

4/12/2005
Page 1 of 19

Project Location: SPRINGFIELD STREET SCHOOL
Date Received: 4/7/2005

LIMS-BAT #: LIMS-87387
Job Number: 081-12152-01

Field Sample #: ATC-1

Sample ID: 05B12108
Sampled: 4/6/2005
NOT SPECIFIED

Sample Matrix: GRND WATER

	Units	Results	RL	Method	Date Analyzed	Analyst
8260 water				SW846 8260		
Acetone	ug/l	ND	10.0		04/11/05	LBD
Acrolein	ug/l	ND	20.0		04/11/05	LBD
Acrylonitrile	ug/l	ND	0.5		04/11/05	LBD
tert-Amylmethyl Ether	ug/l	ND	0.5		04/11/05	LBD
Benzene	ug/l	ND	0.6		04/11/05	LBD
Bromobenzene	ug/l	ND	0.5		04/11/05	LBD
Bromochloromethane	ug/l	ND	0.7		04/11/05	LBD
Bromodichloromethane	ug/l	ND	0.4		04/11/05	LBD
Bromoform	ug/l	ND	1.2		04/11/05	LBD
Bromomethane	ug/l	ND	1.2		04/11/05	LBD
2-Butanone (MEK)	ug/l	ND	10.0		04/11/05	LBD
tert-Butyl Alcohol	ug/l	ND	20.0		04/11/05	LBD
n-Butylbenzene	ug/l	ND	0.7		04/11/05	LBD
sec-Butylbenzene	ug/l	ND	0.6		04/11/05	LBD
tert-Butylbenzene	ug/l	ND	0.8		04/11/05	LBD
tert-Butylethyl Ether	ug/l	ND	0.5		04/11/05	LBD
Carbon Disulfide	ug/l	ND	3.0		04/11/05	LBD
Carbon Tetrachloride	ug/l	ND	0.5		04/11/05	LBD
Chlorobenzene	ug/l	ND	0.6		04/11/05	LBD
Chlorodibromomethane	ug/l	ND	0.5		04/11/05	LBD
Chloroethane	ug/l	ND	0.8		04/11/05	LBD
2-Chloroethylvinylether	ug/l	ND	9.6		04/11/05	LBD
Chloroform	ug/l	ND	0.8		04/11/05	LBD
Chloromethane	ug/l	ND	1.2		04/11/05	LBD
2-Chlorotoluene	ug/l	ND	0.6		04/11/05	LBD
4-Chlorotoluene	ug/l	ND	0.6		04/11/05	LBD
1,2-Dibromo-3-Chloropropane	ug/l	ND	1.6		04/11/05	LBD
1,2-Dibromoethane	ug/l	ND	0.70		04/11/05	LBD
Dibromomethane	ug/l	ND	1.1		04/11/05	LBD
1,2-Dichlorobenzene	ug/l	ND	0.8		04/11/05	LBD
1,3-Dichlorobenzene	ug/l	ND	0.6		04/11/05	LBD
1,4-Dichlorobenzene	ug/l	ND	0.8		04/11/05	LBD
cis-1,4-Dichloro-2-Butene	ug/l	ND	2.4		04/11/05	LBD
trans-1,4-Dichloro-2-Butene	ug/l	ND	2.1		04/11/05	LBD
Dichlorodifluoromethane	ug/l	ND	1.0		04/11/05	LBD
1,1-Dichloroethane	ug/l	ND	0.7		04/11/05	LBD

RL = Reporting Limit

ND = Not Detected

NM = Not Measured

* = See end of report for comments and notes applying to this sample



39 Spruce Street ° East Longmeadow, MA 01028 ° FAX 413/525-6405 ° TEL. 413/525-2332

DONNA PALLISTER
LEVINE FRICKE
250 CENTERVILLE RD., BLDG. E, SUITE 12
WARWICK, RI 02886

Purchase Order No.: 5131

4/12/2005
Page 2 of 19

Project Location: SPRINGFIELD STREET SCHOOL
Date Received: 4/7/2005

LIMS-BAT #: LIMS-87387
Job Number: 081-12152-01

Field Sample #: ATC-1

Sample ID: 05B12108 Sampled: 4/6/2005
NOT SPECIFIED

Sample Matrix: GRND WATER

	Units	Results	RL	Method	Date Analyzed	Analyst
8260 water				SW846 8260		
1,2-Dichloroethane	ug/l	ND	0.9		04/11/05	LBD
1,1-Dichloroethylene	ug/l	ND	0.6		04/11/05	LBD
cis-1,2-Dichloroethylene	ug/l	ND	0.5		04/11/05	LBD
trans-1,2-Dichloroethylene	ug/l	ND	0.8		04/11/05	LBD
1,2-Dichloropropane	ug/l	ND	0.6		04/11/05	LBD
1,3-Dichloropropane	ug/l	ND	0.5		04/11/05	LBD
2,2-Dichloropropane	ug/l	ND	0.9		04/11/05	LBD
1,1-Dichloropropene	ug/l	ND	0.5		04/11/05	LBD
cis-1,3-Dichloropropene	ug/l	ND	0.5		04/11/05	LBD
trans-1,3-Dichloropropene	ug/l	ND	0.4		04/11/05	LBD
Diethyl Ether	ug/l	ND	2.0		04/11/05	LBD
Diisopropyl Ether	ug/l	ND	0.5		04/11/05	LBD
1,4-Dioxane	ug/l	ND	50.0		04/11/05	LBD
Ethyl Benzene	ug/l	ND	0.6		04/11/05	LBD
Ethyl Methacrylate	ug/l	ND	0.8		04/11/05	LBD
Hexachlorobutadiene	ug/l	ND	1.3		04/11/05	LBD
2-Hexanone	ug/l	ND	9.7		04/11/05	LBD
Iodomethane	ug/l	ND	0.8		04/11/05	LBD
Isopropylbenzene	ug/l	ND	0.4		04/11/05	LBD
p-Isopropyltoluene	ug/l	ND	0.7		04/11/05	LBD
MTBE	ug/l	ND	0.8		04/11/05	LBD
Methylene Chloride	ug/l	ND	3.0		04/11/05	LBD
MIBK	ug/l	ND	8.8		04/11/05	LBD
Naphthalene	ug/l	ND	1.0		04/11/05	LBD
n-Propylbenzene	ug/l	ND	0.8		04/11/05	LBD
Styrene	ug/l	ND	0.7		04/11/05	LBD
1,1,1,2-Tetrachloroethane	ug/l	ND	0.5		04/11/05	LBD
1,1,2,2-Tetrachloroethane	ug/l	ND	0.5		04/11/05	LBD
Tetrachloroethylene	ug/l	ND	0.4		04/11/05	LBD
Tetrahydrofuran	ug/l	ND	5.0		04/11/05	LBD
Toluene	ug/l	ND	0.7		04/11/05	LBD
1,2,3-Trichlorobenzene	ug/l	ND	0.7		04/11/05	LBD
1,2,4-Trichlorobenzene	ug/l	ND	0.7		04/11/05	LBD
1,1,1-Trichloroethane	ug/l	ND	0.9		04/11/05	LBD
1,1,2-Trichloroethane	ug/l	ND	0.7		04/11/05	LBD
Trichloroethylene	ug/l	1.1	1.0		04/11/05	LBD

RL = Reporting Limit

ND = Not Detected

NM = Not Measured

* = See end of report for comments and notes applying to this sample



39 Spruce Street ° East Longmeadow, MA 01028 ° FAX 413/525-6405 ° TEL. 413/525-2332

DONNA PALLISTER
LEVINE FRICKE
250 CENTERVILLE RD., BLDG. E, SUITE 12
WARWICK, RI 02886

Purchase Order No.: 5131

4/12/2005
Page 3 of 19

Project Location: SPRINGFIELD STREET SCHOOL
Date Received: 4/7/2005

LIMS-BAT #: LIMS-87387
Job Number: 081-12152-01

Field Sample #: ATC-1

Sample ID : 05B12108 Sampled : 4/6/2005
NOT SPECIFIED

Sample Matrix: GRND WATER

	Units	Results	RL	Method	Date Analyzed	Analyst
8260 water				SW846 8260		
Trichlorofluoromethane	ug/l	ND	0.7		04/11/05	LBD
1,2,3-Trichloropropane	ug/l	ND	1.3		04/11/05	LBD
1,2,4-Trimethylbenzene	ug/l	ND	0.7		04/11/05	LBD
1,3,5-Trimethylbenzene	ug/l	ND	1.0		04/11/05	LBD
Vinyl Acetate	ug/l	ND	16.4		04/11/05	LBD
Vinyl Chloride	ug/l	ND	0.3		04/11/05	LBD
m + p Xylene	ug/l	ND	1.3		04/11/05	LBD
o-Xylene	ug/l	ND	0.5		04/11/05	LBD

RL = Reporting Limit

ND = Not Detected

NM = Not Measured

* = See end of report for comments and notes applying to this sample



39 Spruce Street ° East Longmeadow, MA 01028 ° FAX 413/525-6405 ° TEL. 413/525-2332

DONNA PALLISTER
 LEVINE FRICKE
 250 CENTERVILLE RD., BLDG. E, SUITE 12
 WARWICK, RI 02886

Purchase Order No.: 5131

4/12/2005
 Page 4 of 19

Project Location: SPRINGFIELD STREET SCHOOL
 Date Received: 4/7/2005

LIMS-BAT #: LIMS-87387
 Job Number: 081-12152-01

Field Sample #: ATC-2

Sample ID : 05B12109 Sampled : 4/6/2005
 NOT SPECIFIED

Sample Matrix: GRND WATER

	Units	Results	RL	Method	Date Analyzed	Analyst
8260 water				SW846 8260		
Acetone	ug/l	ND	10.0		04/08/05	LBD
Acrolein	ug/l	ND	20.0		04/08/05	LBD
Acrylonitrile	ug/l	ND	0.5		04/08/05	LBD
tert-Amylmethyl Ether	ug/l	ND	0.5		04/08/05	LBD
Benzene	ug/l	ND	0.6		04/08/05	LBD
Bromobenzene	ug/l	ND	0.5		04/08/05	LBD
Bromochloromethane	ug/l	ND	0.7		04/08/05	LBD
Bromodichloromethane	ug/l	ND	0.4		04/08/05	LBD
Bromoform	ug/l	ND	1.2		04/08/05	LBD
Bromomethane	ug/l	ND	1.2		04/08/05	LBD
2-Butanone (MEK)	ug/l	ND	10.0		04/08/05	LBD
tert-Butyl Alcohol	ug/l	ND	20.0		04/08/05	LBD
n-Butylbenzene	ug/l	ND	0.7		04/08/05	LBD
sec-Butylbenzene	ug/l	ND	0.6		04/08/05	LBD
tert-Butylbenzene	ug/l	ND	0.8		04/08/05	LBD
tert-Butylethyl Ether	ug/l	ND	0.5		04/08/05	LBD
Carbon Disulfide	ug/l	ND	3.0		04/08/05	LBD
Carbon Tetrachloride	ug/l	ND	0.5		04/08/05	LBD
Chlorobenzene	ug/l	ND	0.6		04/08/05	LBD
Chlorodibromomethane	ug/l	ND	0.5		04/08/05	LBD
Chloroethane	ug/l	ND	0.8		04/08/05	LBD
2-Chloroethylvinylether	ug/l	ND	9.6		04/08/05	LBD
Chloroform	ug/l	ND	0.8		04/08/05	LBD
Chloromethane	ug/l	ND	1.2		04/08/05	LBD
2-Chlorotoluene	ug/l	ND	0.6		04/08/05	LBD
4-Chlorotoluene	ug/l	ND	0.6		04/08/05	LBD
1,2-Dibromo-3-Chloropropane	ug/l	ND	1.6		04/08/05	LBD
1,2-Dibromoethane	ug/l	ND	0.70		04/08/05	LBD
Dibromomethane	ug/l	ND	1.1		04/08/05	LBD
1,2-Dichlorobenzene	ug/l	ND	0.8		04/08/05	LBD
1,3-Dichlorobenzene	ug/l	ND	0.6		04/08/05	LBD
1,4-Dichlorobenzene	ug/l	ND	0.8		04/08/05	LBD
cis-1,4-Dichloro-2-Butene	ug/l	ND	2.4		04/08/05	LBD
trans-1,4-Dichloro-2-Butene	ug/l	ND	2.1		04/08/05	LBD
Dichlorodifluoromethane	ug/l	ND	1.0		04/08/05	LBD
1,1-Dichloroethane	ug/l	ND	0.7		04/08/05	LBD

RL = Reporting Limit

ND = Not Detected

NM = Not Measured

* = See end of report for comments and notes applying to this sample



39 Spruce Street ° East Longmeadow, MA 01028 ° FAX 413/525-6405 ° TEL. 413/525-2332

DONNA PALLISTER
 LEVINE FRICKE
 250 CENTERVILLE RD., BLDG. E, SUITE 12
 WARWICK, RI 02886

Purchase Order No.: 5131

4/12/2005
 Page 5 of 19

Project Location: SPRINGFIELD STREET SCHOOL
 Date Received: 4/7/2005

LIMS-BAT #: LIMS-87387
 Job Number: 081-12152-01

Field Sample #: ATC-2

Sample ID: 05B12109 Sampled: 4/6/2005
 NOT SPECIFIED

Sample Matrix: GRND WATER

	Units	Results	RL	Method	Date Analyzed	Analyst
8260 water				SW846 8260		
1,2-Dichloroethane	ug/l	ND	0.9		04/08/05	LBD
1,1-Dichloroethylene	ug/l	ND	0.6		04/08/05	LBD
cis-1,2-Dichloroethylene	ug/l	ND	0.5		04/08/05	LBD
trans-1,2-Dichloroethylene	ug/l	ND	0.8		04/08/05	LBD
1,2-Dichloropropane	ug/l	ND	0.6		04/08/05	LBD
1,3-Dichloropropane	ug/l	ND	0.5		04/08/05	LBD
2,2-Dichloropropane	ug/l	ND	0.9		04/08/05	LBD
1,1-Dichloropropene	ug/l	ND	0.5		04/08/05	LBD
cis-1,3-Dichloropropene	ug/l	ND	0.5		04/08/05	LBD
trans-1,3-Dichloropropene	ug/l	ND	0.4		04/08/05	LBD
Diethyl Ether	ug/l	ND	2.0		04/08/05	LBD
Diisopropyl Ether	ug/l	ND	0.5		04/08/05	LBD
1,4-Dioxane	ug/l	ND	50.0		04/08/05	LBD
Ethyl Benzene	ug/l	ND	0.6		04/08/05	LBD
Ethyl Methacrylate	ug/l	ND	0.8		04/08/05	LBD
Hexachlorobutadiene	ug/l	ND	1.3		04/08/05	LBD
2-Hexanone	ug/l	ND	9.7		04/08/05	LBD
Iodomethane	ug/l	ND	0.8		04/08/05	LBD
Isopropylbenzene	ug/l	ND	0.4		04/08/05	LBD
p-Isopropyltoluene	ug/l	ND	0.7		04/08/05	LBD
MTBE	ug/l	ND	0.8		04/08/05	LBD
Methylene Chloride	ug/l	ND	3.0		04/08/05	LBD
MIBK	ug/l	ND	8.8		04/08/05	LBD
Naphthalene	ug/l	ND	1.0		04/08/05	LBD
n-Propylbenzene	ug/l	ND	0.8		04/08/05	LBD
Styrene	ug/l	ND	0.7		04/08/05	LBD
1,1,1,2-Tetrachloroethane	ug/l	ND	0.5		04/08/05	LBD
1,1,2,2-Tetrachloroethane	ug/l	ND	0.5		04/08/05	LBD
Tetrachloroethylene	ug/l	ND	0.4		04/08/05	LBD
Tetrahydrofuran	ug/l	ND	5.0		04/08/05	LBD
Toluene	ug/l	ND	0.7		04/08/05	LBD
1,2,3-Trichlorobenzene	ug/l	ND	0.7		04/08/05	LBD
1,2,4-Trichlorobenzene	ug/l	ND	0.7		04/08/05	LBD
1,1,1-Trichloroethane	ug/l	ND	0.9		04/08/05	LBD
1,1,2-Trichloroethane	ug/l	ND	0.7		04/08/05	LBD
Trichloroethylene	ug/l	ND	1.0		04/08/05	LBD

RL = Reporting Limit

ND = Not Detected

NM = Not Measured

* = See end of report for comments and notes applying to this sample



39 Spruce Street ° East Longmeadow, MA 01028 ° FAX 413/525-6405 ° TEL. 413/525-2332

DONNA PALLISTER
LEVINE FRICKE
250 CENTERVILLE RD., BLDG. E, SUITE 12
WARWICK, RI 02886

Purchase Order No.: 5131

4/12/2005
Page 6 of 19

Project Location: SPRINGFIELD STREET SCHOOL
Date Received: 4/7/2005

LIMS-BAT #: LIMS-87387
Job Number: 081-12152-01

Field Sample #: ATC-2

Sample ID: 05B12109 Sampled: 4/6/2005
NOT SPECIFIED

Sample Matrix: GRND WATER

	Units	Results	RL	Method	Date Analyzed	Analyst
8260 water				SW846 8260		
Trichlorofluoromethane	ug/l	ND	0.7		04/08/05	LBD
1,2,3-Trichloropropane	ug/l	ND	1.3		04/08/05	LBD
1,2,4-Trimethylbenzene	ug/l	ND	0.7		04/08/05	LBD
1,3,5-Trimethylbenzene	ug/l	ND	1.0		04/08/05	LBD
Vinyl Acetate	ug/l	ND	16.4		04/08/05	LBD
Vinyl Chloride	ug/l	ND	0.3		04/08/05	LBD
m + p Xylene	ug/l	ND	1.3		04/08/05	LBD
o-Xylene	ug/l	ND	0.5		04/08/05	LBD

RL = Reporting Limit

ND = Not Detected

NM = Not Measured

* = See end of report for comments and notes applying to this sample



39 Spruce Street ° East Longmeadow, MA 01028 ° FAX 413/525-6405 ° TEL. 413/525-2332

DONNA PALLISTER
 LEVINE FRICKE
 250 CENTERVILLE RD., BLDG. E, SUITE 12
 WARWICK, RI 02886

Purchase Order No.: 5131

4/12/2005
 Page 7 of 19

Project Location: SPRINGFIELD STREET SCHOOL
 Date Received: 4/7/2005

LIMS-BAT #: LIMS-87387
 Job Number: 081-12152-01

Field Sample #: ATC-3

Sample ID : 05B12110 Sampled : 4/6/2005
 NOT SPECIFIED

Sample Matrix: GRND WATER

	Units	Results	RL	Method	Date Analyzed	Analyst
8260 water				SW846 8260		
Acetone	ug/l	ND	10.0		04/08/05	LBD
Acrolein	ug/l	ND	20.0		04/08/05	LBD
Acrylonitrile	ug/l	ND	0.5		04/08/05	LBD
tert-Amylmethyl Ether	ug/l	ND	0.5		04/08/05	LBD
Benzene	ug/l	ND	0.6		04/08/05	LBD
Bromobenzene	ug/l	ND	0.5		04/08/05	LBD
Bromochloromethane	ug/l	ND	0.7		04/08/05	LBD
Bromodichloromethane	ug/l	ND	0.4		04/08/05	LBD
Bromoform	ug/l	ND	1.2		04/08/05	LBD
Bromomethane	ug/l	ND	1.2		04/08/05	LBD
2-Butanone (MEK)	ug/l	ND	10.0		04/08/05	LBD
tert-Butyl Alcohol	ug/l	ND	20.0		04/08/05	LBD
n-Butylbenzene	ug/l	ND	0.7		04/08/05	LBD
sec-Butylbenzene	ug/l	ND	0.6		04/08/05	LBD
tert-Butylbenzene	ug/l	ND	0.8		04/08/05	LBD
tert-Butylethyl Ether	ug/l	ND	0.5		04/08/05	LBD
Carbon Disulfide	ug/l	ND	3.0		04/08/05	LBD
Carbon Tetrachloride	ug/l	ND	0.5		04/08/05	LBD
Chlorobenzene	ug/l	ND	0.6		04/08/05	LBD
Chlorodibromomethane	ug/l	ND	0.5		04/08/05	LBD
Chloroethane	ug/l	ND	0.8		04/08/05	LBD
2-Chloroethylvinylether	ug/l	ND	9.6		04/08/05	LBD
Chloroform	ug/l	ND	0.8		04/08/05	LBD
Chloromethane	ug/l	ND	1.2		04/08/05	LBD
2-Chlorotoluene	ug/l	ND	0.6		04/08/05	LBD
4-Chlorotoluene	ug/l	ND	0.6		04/08/05	LBD
1,2-Dibromo-3-Chloropropane	ug/l	ND	1.6		04/08/05	LBD
1,2-Dibromoethane	ug/l	ND	0.70		04/08/05	LBD
Dibromomethane	ug/l	ND	1.1		04/08/05	LBD
1,2-Dichlorobenzene	ug/l	ND	0.8		04/08/05	LBD
1,3-Dichlorobenzene	ug/l	ND	0.6		04/08/05	LBD
1,4-Dichlorobenzene	ug/l	ND	0.8		04/08/05	LBD
cis-1,4-Dichloro-2-Butene	ug/l	ND	2.4		04/08/05	LBD
trans-1,4-Dichloro-2-Butene	ug/l	ND	2.1		04/08/05	LBD
Dichlorodifluoromethane	ug/l	ND	1.0		04/08/05	LBD
1,1-Dichloroethane	ug/l	ND	0.7		04/08/05	LBD

RL = Reporting Limit

ND = Not Detected

NM = Not Measured

* = See end of report for comments and notes applying to this sample



39 Spruce Street ° East Longmeadow, MA 01028 ° FAX 413/525-6405 ° TEL. 413/525-2332

DONNA PALLISTER
 LEVINE FRICKE
 250 CENTERVILLE RD., BLDG. E, SUITE 12
 WARWICK, RI 02886

Purchase Order No.: 5131

4/12/2005
 Page 8 of 19

Project Location: SPRINGFIELD STREET SCHOOL
 Date Received: 4/7/2005

LIMS-BAT #: LIMS-87387
 Job Number: 081-12152-01

Field Sample #: ATC-3

Sample ID : 05B12110 Sampled : 4/6/2005
 NOT SPECIFIED

Sample Matrix: GRND WATER

	Units	Results	RL	Method	Date Analyzed	Analyst
8260 water				SW846 8260		
1,2-Dichloroethane	ug/l	ND	0.9		04/08/05	LBD
1,1-Dichloroethylene	ug/l	ND	0.6		04/08/05	LBD
cis-1,2-Dichloroethylene	ug/l	ND	0.5		04/08/05	LBD
trans-1,2-Dichloroethylene	ug/l	ND	0.8		04/08/05	LBD
1,2-Dichloropropane	ug/l	ND	0.6		04/08/05	LBD
1,3-Dichloropropane	ug/l	ND	0.5		04/08/05	LBD
2,2-Dichloropropane	ug/l	ND	0.9		04/08/05	LBD
1,1-Dichloropropene	ug/l	ND	0.5		04/08/05	LBD
cis-1,3-Dichloropropene	ug/l	ND	0.5		04/08/05	LBD
trans-1,3-Dichloropropene	ug/l	ND	0.4		04/08/05	LBD
Diethyl Ether	ug/l	ND	2.0		04/08/05	LBD
Diisopropyl Ether	ug/l	ND	0.5		04/08/05	LBD
1,4-Dioxane	ug/l	ND	50.0		04/08/05	LBD
Ethyl Benzene	ug/l	ND	0.6		04/08/05	LBD
Ethyl Methacrylate	ug/l	ND	0.8		04/08/05	LBD
Hexachlorobutadiene	ug/l	ND	1.3		04/08/05	LBD
2-Hexanone	ug/l	ND	9.7		04/08/05	LBD
Iodomethane	ug/l	ND	0.8		04/08/05	LBD
Isopropylbenzene	ug/l	ND	0.4		04/08/05	LBD
p-Isopropyltoluene	ug/l	ND	0.7		04/08/05	LBD
MTBE	ug/l	ND	0.8		04/08/05	LBD
Methylene Chloride	ug/l	ND	3.0		04/08/05	LBD
MIBK	ug/l	ND	8.8		04/08/05	LBD
Naphthalene	ug/l	ND	1.0		04/08/05	LBD
n-Propylbenzene	ug/l	ND	0.8		04/08/05	LBD
Styrene	ug/l	ND	0.7		04/08/05	LBD
1,1,1,2-Tetrachloroethane	ug/l	ND	0.5		04/08/05	LBD
1,1,2,2-Tetrachloroethane	ug/l	ND	0.5		04/08/05	LBD
Tetrachloroethylene	ug/l	ND	0.4		04/08/05	LBD
Tetrahydrofuran	ug/l	ND	5.0		04/08/05	LBD
Toluene	ug/l	ND	0.7		04/08/05	LBD
1,2,3-Trichlorobenzene	ug/l	ND	0.7		04/08/05	LBD
1,2,4-Trichlorobenzene	ug/l	ND	0.7		04/08/05	LBD
1,1,1-Trichloroethane	ug/l	ND	0.9		04/08/05	LBD
1,1,2-Trichloroethane	ug/l	ND	0.7		04/08/05	LBD
Trichloroethylene	ug/l	ND	1.0		04/08/05	LBD

RL = Reporting Limit

ND = Not Detected

NM = Not Measured

* = See end of report for comments and notes applying to this sample



39 Spruce Street ° East Longmeadow, MA 01028 ° FAX 413/525-6405 ° TEL. 413/525-2332

DONNA PALLISTER
LEVINE FRICKE
250 CENTERVILLE RD., BLDG. E, SUITE 12
WARWICK, RI 02886

Purchase Order No.: 5131

4/12/2005
Page 9 of 19

Project Location: SPRINGFIELD STREET SCHOOL
Date Received: 4/7/2005

LIMS-BAT #: LIMS-87387
Job Number: 081-12152-01

Field Sample #: ATC-3

Sample ID: 05B12110 Sampled: 4/6/2005
NOT SPECIFIED

Sample Matrix: GRND WATER

	Units	Results	RL	Method	Date Analyzed	Analyst
8260 water				SW846 8260		
Trichlorofluoromethane	ug/l	ND	0.7		04/08/05	LBD
1,2,3-Trichloropropane	ug/l	ND	1.3		04/08/05	LBD
1,2,4-Trimethylbenzene	ug/l	ND	0.7		04/08/05	LBD
1,3,5-Trimethylbenzene	ug/l	ND	1.0		04/08/05	LBD
Vinyl Acetate	ug/l	ND	16.4		04/08/05	LBD
Vinyl Chloride	ug/l	ND	0.3		04/08/05	LBD
m + p Xylene	ug/l	ND	1.3		04/08/05	LBD
o-Xylene	ug/l	ND	0.5		04/08/05	LBD

RL = Reporting Limit

ND = Not Detected

NM = Not Measured

* = See end of report for comments and notes applying to this sample



39 Spruce Street ° East Longmeadow, MA 01028 ° FAX 413/525-6405 ° TEL. 413/525-2332

DONNA PALLISTER
 LEVINE FRICKE
 250 CENTERVILLE RD., BLDG. E, SUITE 12
 WARWICK, RI 02886

Purchase Order No.: 5131

4/12/2005
 Page 10 of 19

Project Location: SPRINGFIELD STREET SCHOOL
 Date Received: 4/7/2005

LIMS-BAT #: LIMS-87387
 Job Number: 081-12152-01

Field Sample #: ATC-4

Sample ID : 05B12111 Sampled : 4/6/2005
 NOT SPECIFIED

Sample Matrix: GRND WATER

	Units	Results	RL	Method	Date Analyzed	Analyst
8260 water				SW846 8260		
Acetone	ug/l	ND	10.0		04/08/05	LBD
Acrolein	ug/l	ND	20.0		04/08/05	LBD
Acrylonitrile	ug/l	ND	0.5		04/08/05	LBD
tert-Amylmethyl Ether	ug/l	ND	0.5		04/08/05	LBD
Benzene	ug/l	ND	0.6		04/08/05	LBD
Bromobenzene	ug/l	ND	0.5		04/08/05	LBD
Bromochloromethane	ug/l	ND	0.7		04/08/05	LBD
Bromodichloromethane	ug/l	ND	0.4		04/08/05	LBD
Bromoform	ug/l	ND	1.2		04/08/05	LBD
Bromomethane	ug/l	ND	1.2		04/08/05	LBD
2-Butanone (MEK)	ug/l	ND	10.0		04/08/05	LBD
tert-Butyl Alcohol	ug/l	ND	20.0		04/08/05	LBD
n-Butylbenzene	ug/l	ND	0.7		04/08/05	LBD
sec-Butylbenzene	ug/l	ND	0.6		04/08/05	LBD
tert-Butylbenzene	ug/l	ND	0.8		04/08/05	LBD
tert-Butylethyl Ether	ug/l	ND	0.5		04/08/05	LBD
Carbon Disulfide	ug/l	ND	3.0		04/08/05	LBD
Carbon Tetrachloride	ug/l	ND	0.5		04/08/05	LBD
Chlorobenzene	ug/l	ND	0.6		04/08/05	LBD
Chlorodibromomethane	ug/l	ND	0.5		04/08/05	LBD
Chloroethane	ug/l	ND	0.8		04/08/05	LBD
2-Chloroethylvinylether	ug/l	ND	9.6		04/08/05	LBD
Chloroform	ug/l	ND	0.8		04/08/05	LBD
Chloromethane	ug/l	ND	1.2		04/08/05	LBD
2-Chlorotoluene	ug/l	ND	0.6		04/08/05	LBD
4-Chlorotoluene	ug/l	ND	0.6		04/08/05	LBD
1,2-Dibromo-3-Chloropropane	ug/l	ND	1.6		04/08/05	LBD
1,2-Dibromoethane	ug/l	ND	0.70		04/08/05	LBD
Dibromomethane	ug/l	ND	1.1		04/08/05	LBD
1,2-Dichlorobenzene	ug/l	ND	0.8		04/08/05	LBD
1,3-Dichlorobenzene	ug/l	ND	0.6		04/08/05	LBD
1,4-Dichlorobenzene	ug/l	ND	0.8		04/08/05	LBD
cis-1,4-Dichloro-2-Butene	ug/l	ND	2.4		04/08/05	LBD
trans-1,4-Dichloro-2-Butene	ug/l	ND	2.1		04/08/05	LBD
Dichlorodifluoromethane	ug/l	ND	1.0		04/08/05	LBD
1,1-Dichloroethane	ug/l	ND	0.7		04/08/05	LBD

RL = Reporting Limit

ND = Not Detected

NM = Not Measured

* = See end of report for comments and notes applying to this sample



39 Spruce Street ° East Longmeadow, MA 01028 ° FAX 413/525-6405 ° TEL. 413/525-2332

DONNA PALLISTER
LEVINE FRICKE
250 CENTERVILLE RD., BLDG. E, SUITE 12
WARWICK, RI 02886

Purchase Order No.: 5131

4/12/2005

Page 11 of 19

Project Location: SPRINGFIELD STREET SCHOOL
Date Received: 4/7/2005

LIMS-BAT #: LIMS-87387
Job Number: 081-12152-01

Field Sample #: ATC-4

Sample ID: 05B12111 Sampled: 4/6/2005
NOT SPECIFIED

Sample Matrix: GRND WATER

	Units	Results	RL	Method	Date Analyzed	Analyst
8260 water				SW846 8260		
1,2-Dichloroethane	ug/l	ND	0.9		04/08/05	LBD
1,1-Dichloroethylene	ug/l	ND	0.6		04/08/05	LBD
cis-1,2-Dichloroethylene	ug/l	ND	0.5		04/08/05	LBD
trans-1,2-Dichloroethylene	ug/l	ND	0.8		04/08/05	LBD
1,2-Dichloropropane	ug/l	ND	0.6		04/08/05	LBD
1,3-Dichloropropane	ug/l	ND	0.5		04/08/05	LBD
2,2-Dichloropropane	ug/l	ND	0.9		04/08/05	LBD
1,1-Dichloropropene	ug/l	ND	0.5		04/08/05	LBD
cis-1,3-Dichloropropene	ug/l	ND	0.5		04/08/05	LBD
trans-1,3-Dichloropropene	ug/l	ND	0.4		04/08/05	LBD
Diethyl Ether	ug/l	ND	2.0		04/08/05	LBD
Diisopropyl Ether	ug/l	ND	0.5		04/08/05	LBD
1,4-Dioxane	ug/l	ND	50.0		04/08/05	LBD
Ethyl Benzene	ug/l	ND	0.6		04/08/05	LBD
Ethyl Methacrylate	ug/l	ND	0.8		04/08/05	LBD
Hexachlorobutadiene	ug/l	ND	1.3		04/08/05	LBD
2-Hexanone	ug/l	ND	9.7		04/08/05	LBD
Iodomethane	ug/l	ND	0.8		04/08/05	LBD
Isopropylbenzene	ug/l	ND	0.4		04/08/05	LBD
p-Isopropyltoluene	ug/l	ND	0.7		04/08/05	LBD
MTBE	ug/l	ND	0.8		04/08/05	LBD
Methylene Chloride	ug/l	ND	3.0		04/08/05	LBD
MIBK	ug/l	ND	8.8		04/08/05	LBD
Naphthalene	ug/l	ND	1.0		04/08/05	LBD
n-Propylbenzene	ug/l	ND	0.8		04/08/05	LBD
Styrene	ug/l	ND	0.7		04/08/05	LBD
1,1,1,2-Tetrachloroethane	ug/l	ND	0.5		04/08/05	LBD
1,1,2,2-Tetrachloroethane	ug/l	ND	0.5		04/08/05	LBD
Tetrachloroethylene	ug/l	ND	0.4		04/08/05	LBD
Tetrahydrofuran	ug/l	ND	5.0		04/08/05	LBD
Toluene	ug/l	ND	0.7		04/08/05	LBD
1,2,3-Trichlorobenzene	ug/l	ND	0.7		04/08/05	LBD
1,2,4-Trichlorobenzene	ug/l	ND	0.7		04/08/05	LBD
1,1,1-Trichloroethane	ug/l	ND	0.9		04/08/05	LBD
1,1,2-Trichloroethane	ug/l	ND	0.7		04/08/05	LBD
Trichloroethylene	ug/l	ND	1.0		04/08/05	LBD

RL = Reporting Limit

ND = Not Detected

NM = Not Measured

* = See end of report for comments and notes applying to this sample



39 Spruce Street ° East Longmeadow, MA 01028 ° FAX 413/525-6405 ° TEL. 413/525-2332

DONNA PALLISTER
LEVINE FRICKE
250 CENTERVILLE RD., BLDG. E, SUITE 12
WARWICK, RI 02886

Purchase Order No.: 5131

4/12/2005
Page 12 of 19

Project Location: SPRINGFIELD STREET SCHOOL
Date Received: 4/7/2005

LIMS-BAT #: LIMS-87387
Job Number: 081-12152-01

Field Sample #: ATC-4

Sample ID: 05B12111 Sampled: 4/6/2005
NOT SPECIFIED

Sample Matrix: GRND WATER

	Units	Results	RL	Method	Date Analyzed	Analyst
8260 water				SW846 8260		
Trichlorofluoromethane	ug/l	ND	0.7		04/08/05	LBD
1,2,3-Trichloropropane	ug/l	ND	1.3		04/08/05	LBD
1,2,4-Trimethylbenzene	ug/l	ND	0.7		04/08/05	LBD
1,3,5-Trimethylbenzene	ug/l	ND	1.0		04/08/05	LBD
Vinyl Acetate	ug/l	ND	16.4		04/08/05	LBD
Vinyl Chloride	ug/l	ND	0.3		04/08/05	LBD
m + p Xylene	ug/l	ND	1.3		04/08/05	LBD
o-Xylene	ug/l	ND	0.5		04/08/05	LBD

RL = Reporting Limit

ND = Not Detected

NM = Not Measured

* = See end of report for comments and notes applying to this sample

DONNA PALLISTER
 LEVINE FRICKE
 250 CENTERVILLE RD., BLDG. E, SUITE 12
 WARWICK, RI 02886

Purchase Order No.: 5131

4/12/2005
 Page 13 of 19

Project Location: SPRINGFIELD STREET SCHOOL
 Date Received: 4/7/2005

LIMS-BAT #: LIMS-87387
 Job Number: 081-12152-01

Field Sample # : ATC-5

Sample ID : 05B12112 Sampled : 4/6/2005
 NOT SPECIFIED

Sample Matrix: GRND WATER

	Units	Results	RL	Method	Date Analyzed	Analyst
8260 water				SW846 8260		
Acetone	ug/l	ND	10.0		04/08/05	LBD
Acrolein	ug/l	ND	20.0		04/08/05	LBD
Acrylonitrile	ug/l	ND	0.5		04/08/05	LBD
tert-Amylmethyl Ether	ug/l	ND	0.5		04/08/05	LBD
Benzene	ug/l	ND	0.6		04/08/05	LBD
Bromobenzene	ug/l	ND	0.5		04/08/05	LBD
Bromochloromethane	ug/l	ND	0.7		04/08/05	LBD
Bromodichloromethane	ug/l	ND	0.4		04/08/05	LBD
Bromoform	ug/l	ND	1.2		04/08/05	LBD
Bromomethane	ug/l	ND	1.2		04/08/05	LBD
2-Butanone (MEK)	ug/l	ND	10.0		04/08/05	LBD
tert-Butyl Alcohol	ug/l	ND	20.0		04/08/05	LBD
n-Butylbenzene	ug/l	ND	0.7		04/08/05	LBD
sec-Butylbenzene	ug/l	ND	0.6		04/08/05	LBD
tert-Butylbenzene	ug/l	ND	0.8		04/08/05	LBD
tert-Butylethyl Ether	ug/l	ND	0.5		04/08/05	LBD
Carbon Disulfide	ug/l	ND	3.0		04/08/05	LBD
Carbon Tetrachloride	ug/l	ND	0.5		04/08/05	LBD
Chlorobenzene	ug/l	ND	0.6		04/08/05	LBD
Chlorodibromomethane	ug/l	ND	0.5		04/08/05	LBD
Chloroethane	ug/l	ND	0.8		04/08/05	LBD
2-Chloroethylvinylether	ug/l	ND	9.6		04/08/05	LBD
Chloroform	ug/l	ND	0.8		04/08/05	LBD
Chloromethane	ug/l	ND	1.2		04/08/05	LBD
2-Chlorotoluene	ug/l	ND	0.6		04/08/05	LBD
4-Chlorotoluene	ug/l	ND	0.6		04/08/05	LBD
1,2-Dibromo-3-Chloropropane	ug/l	ND	1.6		04/08/05	LBD
1,2-Dibromoethane	ug/l	ND	0.70		04/08/05	LBD
Dibromomethane	ug/l	ND	1.1		04/08/05	LBD
1,2-Dichlorobenzene	ug/l	ND	0.8		04/08/05	LBD
1,3-Dichlorobenzene	ug/l	ND	0.6		04/08/05	LBD
1,4-Dichlorobenzene	ug/l	ND	0.8		04/08/05	LBD
cis-1,4-Dichloro-2-Butene	ug/l	ND	2.4		04/08/05	LBD
trans-1,4-Dichloro-2-Butene	ug/l	ND	2.1		04/08/05	LBD
Dichlorodifluoromethane	ug/l	ND	1.0		04/08/05	LBD
1,1-Dichloroethane	ug/l	ND	0.7		04/08/05	LBD

RL = Reporting Limit

ND = Not Detected

NM = Not Measured

* = See end of report for comments and notes applying to this sample



39 Spruce Street ° East Longmeadow, MA 01028 ° FAX 413/525-6405 ° TEL. 413/525-2332

DONNA PALLISTER
 LEVINE FRICKE
 250 CENTERVILLE RD., BLDG. E, SUITE 12
 WARWICK, RI 02886

Purchase Order No.: 5131

4/12/2005
 Page 14 of 19

Project Location: SPRINGFIELD STREET SCHOOL
 Date Received: 4/7/2005

LIMS-BAT #: LIMS-87387
 Job Number: 081-12152-01

Field Sample #: ATC-5

Sample ID : 05B12112 Sampled : 4/6/2005
 NOT SPECIFIED

Sample Matrix: GRND WATER

	Units	Results	RL	Method	Date Analyzed	Analyst
8260 water				SW846 8260		
1,2-Dichloroethane	ug/l	ND	0.9		04/08/05	LBD
1,1-Dichloroethylene	ug/l	ND	0.6		04/08/05	LBD
cis-1,2-Dichloroethylene	ug/l	ND	0.5		04/08/05	LBD
trans-1,2-Dichloroethylene	ug/l	ND	0.8		04/08/05	LBD
1,2-Dichloropropane	ug/l	ND	0.6		04/08/05	LBD
1,3-Dichloropropane	ug/l	ND	0.5		04/08/05	LBD
2,2-Dichloropropane	ug/l	ND	0.9		04/08/05	LBD
1,1-Dichloropropene	ug/l	ND	0.5		04/08/05	LBD
cis-1,3-Dichloropropene	ug/l	ND	0.5		04/08/05	LBD
trans-1,3-Dichloropropene	ug/l	ND	0.4		04/08/05	LBD
Diethyl Ether	ug/l	ND	2.0		04/08/05	LBD
Diisopropyl Ether	ug/l	ND	0.5		04/08/05	LBD
1,4-Dioxane	ug/l	ND	50.0		04/08/05	LBD
Ethyl Benzene	ug/l	ND	0.6		04/08/05	LBD
Ethyl Methacrylate	ug/l	ND	0.8		04/08/05	LBD
Hexachlorobutadiene	ug/l	ND	1.3		04/08/05	LBD
2-Hexanone	ug/l	ND	9.7		04/08/05	LBD
Iodomethane	ug/l	ND	0.8		04/08/05	LBD
Isopropylbenzene	ug/l	ND	0.4		04/08/05	LBD
p-Isopropyltoluene	ug/l	ND	0.7		04/08/05	LBD
MTBE	ug/l	ND	0.8		04/08/05	LBD
Methylene Chloride	ug/l	ND	3.0		04/08/05	LBD
MIBK	ug/l	ND	8.8		04/08/05	LBD
Naphthalene	ug/l	ND	1.0		04/08/05	LBD
n-Propylbenzene	ug/l	ND	0.8		04/08/05	LBD
Styrene	ug/l	ND	0.7		04/08/05	LBD
1,1,1,2-Tetrachloroethane	ug/l	ND	0.5		04/08/05	LBD
1,1,2,2-Tetrachloroethane	ug/l	ND	0.5		04/08/05	LBD
Tetrachloroethylene	ug/l	ND	0.4		04/08/05	LBD
Tetrahydrofuran	ug/l	ND	5.0		04/08/05	LBD
Toluene	ug/l	ND	0.7		04/08/05	LBD
1,2,3-Trichlorobenzene	ug/l	ND	0.7		04/08/05	LBD
1,2,4-Trichlorobenzene	ug/l	ND	0.7		04/08/05	LBD
1,1,1-Trichloroethane	ug/l	ND	0.9		04/08/05	LBD
1,1,2-Trichloroethane	ug/l	ND	0.7		04/08/05	LBD
Trichloroethylene	ug/l	ND	1.0		04/08/05	LBD

RL = Reporting Limit

ND = Not Detected

NM = Not Measured

* = See end of report for comments and notes applying to this sample



39 Spruce Street ° East Longmeadow, MA 01028 ° FAX 413/525-6405 ° TEL. 413/525-2332

DONNA PALLISTER
LEVINE FRICKE
250 CENTERVILLE RD., BLDG. E, SUITE 12
WARWICK, RI 02886

Purchase Order No.: 5131

4/12/2005
Page 15 of 19

Project Location: SPRINGFIELD STREET SCHOOL
Date Received: 4/7/2005

LIMS-BAT #: LIMS-87387
Job Number: 081-12152-01

Field Sample #: ATC-5

Sample ID: 05B12112 Sampled: 4/6/2005
NOT SPECIFIED

Sample Matrix: GRND WATER

	Units	Results	RL	Method	Date Analyzed	Analyst
8260 water				SW846 8260		
Trichlorofluoromethane	ug/l	ND	0.7		04/08/05	LBD
1,2,3-Trichloropropane	ug/l	ND	1.3		04/08/05	LBD
1,2,4-Trimethylbenzene	ug/l	ND	0.7		04/08/05	LBD
1,3,5-Trimethylbenzene	ug/l	ND	1.0		04/08/05	LBD
Vinyl Acetate	ug/l	ND	16.4		04/08/05	LBD
Vinyl Chloride	ug/l	ND	0.3		04/08/05	LBD
m + p Xylene	ug/l	ND	1.3		04/08/05	LBD
o-Xylene	ug/l	ND	0.5		04/08/05	LBD

RL = Reporting Limit

ND = Not Detected

NM = Not Measured

* = See end of report for comments and notes applying to this sample



39 Spruce Street ° East Longmeadow, MA 01028 ° FAX 413/525-6405 ° TEL. 413/525-2332

DONNA PALLISTER
 LEVINE FRICKE
 250 CENTERVILLE RD., BLDG. E, SUITE 12
 WARWICK, RI 02886

Purchase Order No.: 5131

4/12/2005
 Page 16 of 19

Project Location: SPRINGFIELD STREET SCHOOL
 Date Received: 4/7/2005

LIMS-BAT #: LIMS-87387
 Job Number: 081-12152-01

Field Sample #: TRIP BLANK

Sample ID : 05B12113 Sampled : 4/6/2005
 NOT SPECIFIED

Sample Matrix: WATER OTHER

	Units	Results	RL	Method	Date Analyzed	Analyst
8260 water				SW846 8260		
Acetone	ug/l	ND	10.0		04/08/05	LBD
Acrolein	ug/l	ND	20.0		04/08/05	LBD
Acrylonitrile	ug/l	ND	0.5		04/08/05	LBD
tert-Amylmethyl Ether	ug/l	ND	0.5		04/08/05	LBD
Benzene	ug/l	ND	0.6		04/08/05	LBD
Bromobenzene	ug/l	ND	0.5		04/08/05	LBD
Bromochloromethane	ug/l	ND	0.7		04/08/05	LBD
Bromodichloromethane	ug/l	ND	0.4		04/08/05	LBD
Bromoform	ug/l	ND	1.2		04/08/05	LBD
Bromomethane	ug/l	ND	1.2		04/08/05	LBD
2-Butanone (MEK)	ug/l	ND	10.0		04/08/05	LBD
tert-Butyl Alcohol	ug/l	ND	20.0		04/08/05	LBD
n-Butylbenzene	ug/l	ND	0.7		04/08/05	LBD
sec-Butylbenzene	ug/l	ND	0.6		04/08/05	LBD
tert-Butylbenzene	ug/l	ND	0.8		04/08/05	LBD
tert-Butylethyl Ether	ug/l	ND	0.5		04/08/05	LBD
Carbon Disulfide	ug/l	ND	3.0		04/08/05	LBD
Carbon Tetrachloride	ug/l	ND	0.5		04/08/05	LBD
Chlorobenzene	ug/l	ND	0.6		04/08/05	LBD
Chlorodibromomethane	ug/l	ND	0.5		04/08/05	LBD
Chloroethane	ug/l	ND	0.8		04/08/05	LBD
2-Chloroethylvinylether	ug/l	ND	9.6		04/08/05	LBD
Chloroform	ug/l	ND	0.8		04/08/05	LBD
Chloromethane	ug/l	ND	1.2		04/08/05	LBD
2-Chlorotoluene	ug/l	ND	0.6		04/08/05	LBD
4-Chlorotoluene	ug/l	ND	0.6		04/08/05	LBD
1,2-Dibromo-3-Chloropropane	ug/l	ND	1.6		04/08/05	LBD
1,2-Dibromoethane	ug/l	ND	0.70		04/08/05	LBD
Dibromomethane	ug/l	ND	1.1		04/08/05	LBD
1,2-Dichlorobenzene	ug/l	ND	0.8		04/08/05	LBD
1,3-Dichlorobenzene	ug/l	ND	0.6		04/08/05	LBD
1,4-Dichlorobenzene	ug/l	ND	0.8		04/08/05	LBD
cis-1,4-Dichloro-2-Butene	ug/l	ND	2.4		04/08/05	LBD
trans-1,4-Dichloro-2-Butene	ug/l	ND	2.1		04/08/05	LBD
Dichlorodifluoromethane	ug/l	ND	1.0		04/08/05	LBD
1,1-Dichloroethane	ug/l	ND	0.7		04/08/05	LBD

RL = Reporting Limit

ND = Not Detected

NM = Not Measured

* = See end of report for comments and notes applying to this sample



39 Spruce Street ° East Longmeadow, MA 01028 ° FAX 413/525-6405 ° TEL. 413/525-2332

DONNA PALLISTER
 LEVINE FRICKE
 250 CENTERVILLE RD., BLDG. E, SUITE 12
 WARWICK, RI 02886

Purchase Order No.: 5131

4/12/2005
 Page 17 of 19

Project Location: SPRINGFIELD STREET SCHOOL
 Date Received: 4/7/2005

LIMS-BAT #: LIMS-87387
 Job Number: 081-12152-01

Field Sample # : TRIP BLANK

Sample ID : 05B12113 Sampled : 4/6/2005
 NOT SPECIFIED

Sample Matrix: WATER OTHER

	Units	Results	RL	Method	Date Analyzed	Analyst
8260 water				SW846 8260		
1,2-Dichloroethane	ug/l	ND	0.9		04/08/05	LBD
1,1-Dichloroethylene	ug/l	ND	0.6		04/08/05	LBD
cis-1,2-Dichloroethylene	ug/l	ND	0.5		04/08/05	LBD
trans-1,2-Dichloroethylene	ug/l	ND	0.8		04/08/05	LBD
1,2-Dichloropropane	ug/l	ND	0.6		04/08/05	LBD
1,3-Dichloropropane	ug/l	ND	0.5		04/08/05	LBD
2,2-Dichloropropane	ug/l	ND	0.9		04/08/05	LBD
1,1-Dichloropropene	ug/l	ND	0.5		04/08/05	LBD
cis-1,3-Dichloropropene	ug/l	ND	0.5		04/08/05	LBD
trans-1,3-Dichloropropene	ug/l	ND	0.4		04/08/05	LBD
Diethyl Ether	ug/l	ND	2.0		04/08/05	LBD
Diisopropyl Ether	ug/l	ND	0.5		04/08/05	LBD
1,4-Dioxane	ug/l	ND	50.0		04/08/05	LBD
Ethyl Benzene	ug/l	ND	0.6		04/08/05	LBD
Ethyl Methacrylate	ug/l	ND	0.8		04/08/05	LBD
Hexachlorobutadiene	ug/l	ND	1.3		04/08/05	LBD
2-Hexanone	ug/l	ND	9.7		04/08/05	LBD
Iodomethane	ug/l	ND	0.8		04/08/05	LBD
Isopropylbenzene	ug/l	ND	0.4		04/08/05	LBD
p-Isopropyltoluene	ug/l	ND	0.7		04/08/05	LBD
MTBE	ug/l	ND	0.8		04/08/05	LBD
Methylene Chloride	ug/l	ND	3.0		04/08/05	LBD
MIBK	ug/l	ND	8.8		04/08/05	LBD
Naphthalene	ug/l	ND	1.0		04/08/05	LBD
n-Propylbenzene	ug/l	ND	0.8		04/08/05	LBD
Styrene	ug/l	ND	0.7		04/08/05	LBD
1,1,1,2-Tetrachloroethane	ug/l	ND	0.5		04/08/05	LBD
1,1,2,2-Tetrachloroethane	ug/l	ND	0.5		04/08/05	LBD
Tetrachloroethylene	ug/l	ND	0.4		04/08/05	LBD
Tetrahydrofuran	ug/l	ND	5.0		04/08/05	LBD
Toluene	ug/l	ND	0.7		04/08/05	LBD
1,2,3-Trichlorobenzene	ug/l	ND	0.7		04/08/05	LBD
1,2,4-Trichlorobenzene	ug/l	ND	0.7		04/08/05	LBD
1,1,1-Trichloroethane	ug/l	ND	0.9		04/08/05	LBD
1,1,2-Trichloroethane	ug/l	ND	0.7		04/08/05	LBD
Trichloroethylene	ug/l	ND	1.0		04/08/05	LBD

RL = Reporting Limit

ND = Not Detected

NM = Not Measured

* = See end of report for comments and notes applying to this sample



39 Spruce Street ° East Longmeadow, MA 01028 ° FAX 413/525-6405 ° TEL. 413/525-2332

DONNA PALLISTER
LEVINE FRICKE
250 CENTERVILLE RD., BLDG. E, SUITE 12
WARWICK, RI 02886

Purchase Order No.: 5131

4/12/2005
Page 18 of 19

Project Location: SPRINGFIELD STREET SCHOOL
Date Received: 4/7/2005

LIMS-BAT #: LIMS-87387
Job Number: 081-12152-01

Field Sample #: TRIP BLANK

Sample ID : 05B12113 Sampled : 4/6/2005
NOT SPECIFIED

Sample Matrix: WATER OTHER

	Units	Results	RL	Method	Date Analyzed	Analyst
8260 water				SW846 8260		
Trichlorofluoromethane	ug/l	ND	0.7		04/08/05	LBD
1,2,3-Trichloropropane	ug/l	ND	1.3		04/08/05	LBD
1,2,4-Trimethylbenzene	ug/l	ND	0.7		04/08/05	LBD
1,3,5-Trimethylbenzene	ug/l	ND	1.0		04/08/05	LBD
Vinyl Acetate	ug/l	ND	16.4		04/08/05	LBD
Vinyl Chloride	ug/l	ND	0.3		04/08/05	LBD
m + p Xylene	ug/l	ND	1.3		04/08/05	LBD
o-Xylene	ug/l	ND	0.5		04/08/05	LBD

RL = Reporting Limit

ND = Not Detected

NM = Not Measured

* = See end of report for comments and notes applying to this sample



39 Spruce Street ° East Longmeadow, MA 01028 ° FAX 413/525-6405 ° TEL. 413/525-2332

DONNA PALLISTER

LEVINE FRICKE

250 CENTERVILLE RD., BLDG. E, SUITE 12

WARWICK, RI 02886

Purchase Order No.: 5131

Project Location: SPRINGFIELD STREET SCHOOL

Date Received: 4/7/2005

4/12/2005

Page 19 of 19

LIMS-BAT #: LIMS-87387

Job Number: 081-12152-01

** END OF REPORT **

RL = Reporting Limit

ND = Not Detected

NM = Not Measured

* = See end of report for comments and notes applying to this sample

QC SUMMARY REPORT

SAMPLE QC: Sample Results with Duplicates

BATCH QC: Lab fortified Blanks and Duplicates

Sample Matrix Spikes and Matrix Spike Duplicates

Standard Reference Materials and Duplicates

Method Blanks

Report Date: 4/12/2005

Lims Bat #: LIMS-87387

Page 1 of 10

QC Batch Number: GCMS/VOL-11800

Sample Id	Analysis	QC Analysis	Values	Units	Limits
05B12108	1,2-Dichloroethane-d4	Surrogate Recovery	101.4	%	70-130
	Toluene-d8	Surrogate Recovery	97.6	%	70-130
	Bromofluorobenzene	Surrogate Recovery	95.8	%	70-130
05B12109	1,2-Dichloroethane-d4	Surrogate Recovery	99.4	%	70-130
	Toluene-d8	Surrogate Recovery	94.4	%	70-130
	Bromofluorobenzene	Surrogate Recovery	94.4	%	70-130
05B12110	1,2-Dichloroethane-d4	Surrogate Recovery	98.3	%	70-130
	Toluene-d8	Surrogate Recovery	94.8	%	70-130
	Bromofluorobenzene	Surrogate Recovery	91.8	%	70-130
05B12111	1,2-Dichloroethane-d4	Surrogate Recovery	103.9	%	70-130
	Toluene-d8	Surrogate Recovery	95.0	%	70-130
	Bromofluorobenzene	Surrogate Recovery	93.6	%	70-130
05B12112	1,2-Dichloroethane-d4	Surrogate Recovery	100.2	%	70-130
	Toluene-d8	Surrogate Recovery	95.9	%	70-130
	Bromofluorobenzene	Surrogate Recovery	94.0	%	70-130
05B12113	1,2-Dichloroethane-d4	Surrogate Recovery	96.6	%	70-130
	Toluene-d8	Surrogate Recovery	94.2	%	70-130
	Bromofluorobenzene	Surrogate Recovery	95.9	%	70-130
BLANK-72067	Acetone	Blank	<10.0	ug/l	
	Benzene	Blank	<0.6	ug/l	
	Carbon Tetrachloride	Blank	<0.5	ug/l	
	Chloroform	Blank	<0.8	ug/l	
	1,2-Dichloroethane	Blank	<0.9	ug/l	
	1,4-Dichlorobenzene	Blank	<0.8	ug/l	
	Ethyl Benzene	Blank	<0.6	ug/l	
	2-Butanone (MEK)	Blank	<10.0	ug/l	
	MIBK	Blank	<8.8	ug/l	
	Naphthalene	Blank	<1.0	ug/l	
	Styrene	Blank	<0.7	ug/l	
	Tetrachloroethylene	Blank	<0.4	ug/l	
	Toluene	Blank	<0.7	ug/l	
	1,1,1-Trichloroethane	Blank	<0.9	ug/l	
	Trichloroethylene	Blank	<1.0	ug/l	
	Trichlorofluoromethane	Blank	<0.7	ug/l	
o-Xylene	Blank	<0.5	ug/l		
m + p Xylene	Blank	<1.3	ug/l		
1,2-Dichlorobenzene	Blank	<0.8	ug/l		



39 Spruce Street ° East Longmeadow, MA 01028 ° FAX 413/525-6405 ° TEL. 413/525-2332

QC SUMMARY REPORT

SAMPLE QC: Sample Results with Duplicates

BATCH QC: Lab fortified Blanks and Duplicates

Sample Matrix Spikes and Matrix Spike Duplicates

Standard Reference Materials and Duplicates

Method Blanks

Report Date: 4/12/2005

Lims Bat #: LIMS-87387

Page 2 of 10

QC Batch Number: GCMS/VOL-11800

Sample Id	Analysis	QC Analysis	Values	Units	Limits
BLANK-72067					
	1,3-Dichlorobenzene	Blank	<0.6	ug/l	
	1,1-Dichloroethane	Blank	<0.7	ug/l	
	1,1-Dichloroethylene	Blank	<0.6	ug/l	
	1,4-Dioxane	Blank	<50.0	ug/l	
	MTBE	Blank	<0.8	ug/l	
	trans-1,2-Dichloroethylene	Blank	<0.8	ug/l	
	Vinyl Chloride	Blank	<0.3	ug/l	
	Methylene Chloride	Blank	<3.0	ug/l	
	Chlorobenzene	Blank	<0.6	ug/l	
	Chloromethane	Blank	<1.2	ug/l	
	Bromomethane	Blank	<1.2	ug/l	
	Chloroethane	Blank	<0.8	ug/l	
	cis-1,3-Dichloropropene	Blank	<0.5	ug/l	
	trans-1,3-Dichloropropene	Blank	<0.4	ug/l	
	Chlorodibromomethane	Blank	<0.5	ug/l	
	1,1,2-Trichloroethane	Blank	<0.7	ug/l	
	2-Chloroethylvinylether	Blank	<9.6	ug/l	
	Bromoform	Blank	<1.2	ug/l	
	1,1,1,2-Tetrachloroethane	Blank	<0.5	ug/l	
	2-Chlorotoluene	Blank	<0.6	ug/l	
	Hexachlorobutadiene	Blank	<1.3	ug/l	
	Isopropylbenzene	Blank	<0.4	ug/l	
	p-Isopropyltoluene	Blank	<0.7	ug/l	
	n-Propylbenzene	Blank	<0.8	ug/l	
	sec-Butylbenzene	Blank	<0.6	ug/l	
	tert-Butylbenzene	Blank	<0.8	ug/l	
	1,2,3-Trichlorobenzene	Blank	<0.7	ug/l	
	1,2,4-Trichlorobenzene	Blank	<0.7	ug/l	
	1,2,4-Trimethylbenzene	Blank	<0.7	ug/l	
	1,3,5-Trimethylbenzene	Blank	<1.0	ug/l	
	Dibromomethane	Blank	<1.1	ug/l	
	cis-1,2-Dichloroethylene	Blank	<0.5	ug/l	
	4-Chlorotoluene	Blank	<0.6	ug/l	
	1,1-Dichloropropene	Blank	<0.5	ug/l	
	1,2-Dichloropropane	Blank	<0.6	ug/l	
	1,3-Dichloropropane	Blank	<0.5	ug/l	
	2,2-Dichloropropane	Blank	<0.9	ug/l	
	1,1,1,2-Tetrachloroethane	Blank	<0.5	ug/l	
	1,2,3-Trichloropropane	Blank	<1.3	ug/l	
	n-Butylbenzene	Blank	<0.7	ug/l	
	Dichlorodifluoromethane	Blank	<1.0	ug/l	
	Bromochloromethane	Blank	<0.7	ug/l	
	Bromobenzene	Blank	<0.5	ug/l	



39 Spruce Street ° East Longmeadow, MA 01028 ° FAX 413/525-6405 ° TEL. 413/525-2332

QC SUMMARY REPORT

SAMPLE QC: Sample Results with Duplicates

BATCH QC: Lab fortified Blanks and Duplicates

Sample Matrix Spikes and Matrix Spike Duplicates

Standard Reference Materials and Duplicates

Method Blanks

Report Date: 4/12/2005

Lims Bat #: LIMS-87387

Page 3 of 10

QC Batch Number: GCMS/VOL-11800

Sample Id	Analysis	QC Analysis	Values	Units	Limits
BLANK-72067					
	Iodomethane	Blank	<0.8	ug/l	
	Acrolein	Blank	<20.0	ug/l	
	Acrylonitrile	Blank	<0.5	ug/l	
	Carbon Disulfide	Blank	<3.0	ug/l	
	Vinyl Acetate	Blank	<16.4	ug/l	
	2-Hexanone	Blank	<9.7	ug/l	
	trans-1,4-Dichloro-2-Butene	Blank	<2.1	ug/l	
	Ethyl Methacrylate	Blank	<0.8	ug/l	
	cis-1,4-Dichloro-2-Butene	Blank	<2.4	ug/l	
	Diethyl Ether	Blank	<2.0	ug/l	
	Bromodichloromethane	Blank	<0.4	ug/l	
	1,2-Dibromo-3-Chloropropane	Blank	<1.6	ug/l	
	1,2-Dibromoethane	Blank	<0.70	ug/l	
	Tetrahydrofuran	Blank	<5.0	ug/l	
	tert-Butyl Alcohol	Blank	<20.0	ug/l	
	Diisopropyl Ether	Blank	<0.5	ug/l	
	tert-Butylethyl Ether	Blank	<0.5	ug/l	
	tert-Amylmethyl Ether	Blank	<0.5	ug/l	
LFBLANK-40594					
Acetone		Lab Fort Blank Amt.	20.0	ug/l	
		Lab Fort Blk. Found	17.5	ug/l	
		Lab Fort Blk. % Rec.	87.6	%	50-155
Benzene		Lab Fort Blank Amt.	20.0	ug/l	
		Lab Fort Blk. Found	19.6	ug/l	
		Lab Fort Blk. % Rec.	97.8	%	70-130
Carbon Tetrachloride		Lab Fort Blank Amt.	20.0	ug/l	
		Lab Fort Blk. Found	15.2	ug/l	
		Lab Fort Blk. % Rec.	75.9	%	70-130
Chloroform		Lab Fort Blank Amt.	20.0	ug/l	
		Lab Fort Blk. Found	19.1	ug/l	
		Lab Fort Blk. % Rec.	95.3	%	70-130
1,2-Dichloroethane		Lab Fort Blank Amt.	20.0	ug/l	
		Lab Fort Blk. Found	18.5	ug/l	
		Lab Fort Blk. % Rec.	92.7	%	70-130
1,4-Dichlorobenzene		Lab Fort Blank Amt.	20.0	ug/l	
		Lab Fort Blk. Found	21.7	ug/l	
		Lab Fort Blk. % Rec.	108.4	%	70-130
Ethyl Benzene		Lab Fort Blank Amt.	20.0	ug/l	
		Lab Fort Blk. Found	21.9	ug/l	
		Lab Fort Blk. % Rec.	109.4	%	70-130
2-Butanone (MEK)		Lab Fort Blank Amt.	20.0	ug/l	
		Lab Fort Blk. Found	16.8	ug/l	
		Lab Fort Blk. % Rec.	84.0	%	50-155



39 Spruce Street ° East Longmeadow, MA 01028 ° FAX 413/525-6405 ° TEL. 413/525-2332

QC SUMMARY REPORT

SAMPLE QC: Sample Results with Duplicates

BATCH QC: Lab fortified Blanks and Duplicates

Sample Matrix Spikes and Matrix Spike Duplicates

Standard Reference Materials and Duplicates

Method Blanks

Report Date: 4/12/2005

Lims Bat # : LIMS-87387

Page 4 of 10

QC Batch Number: GCMS/VOL-11800

Sample Id	Analysis	QC Analysis	Values	Units	Limits
LFBLANK-40594	MIBK	Lab Fort Blank Amt.	20.0	ug/l	
		Lab Fort Blk. Found	18.0	ug/l	
		Lab Fort Blk. % Rec.	90.0	%	50-155
	Naphthalene	Lab Fort Blank Amt.	20.0	ug/l	
		Lab Fort Blk. Found	16.4	ug/l	
		Lab Fort Blk. % Rec.	82.0	%	70-130
	Styrene	Lab Fort Blank Amt.	20.0	ug/l	
		Lab Fort Blk. Found	20.0	ug/l	
		Lab Fort Blk. % Rec.	100.2	%	70-130
	Tetrachloroethylene	Lab Fort Blank Amt.	40.0	ug/l	
		Lab Fort Blk. Found	32.3	ug/l	
		Lab Fort Blk. % Rec.	80.8	%	70-130
	Toluene	Lab Fort Blank Amt.	20.0	ug/l	
		Lab Fort Blk. Found	20.2	ug/l	
		Lab Fort Blk. % Rec.	101.0	%	70-130
1,1,1-Trichloroethane		Lab Fort Blank Amt.	20.0	ug/l	
		Lab Fort Blk. Found	18.9	ug/l	
		Lab Fort Blk. % Rec.	94.7	%	70-130
Trichloroethylene		Lab Fort Blank Amt.	20.0	ug/l	
		Lab Fort Blk. Found	20.2	ug/l	
		Lab Fort Blk. % Rec.	100.8	%	70-130
Trichlorofluoromethane		Lab Fort Blank Amt.	20.0	ug/l	
		Lab Fort Blk. Found	21.1	ug/l	
		Lab Fort Blk. % Rec.	105.6	%	70-130
o-Xylene		Lab Fort Blank Amt.	20.0	ug/l	
		Lab Fort Blk. Found	22.0	ug/l	
		Lab Fort Blk. % Rec.	110.0	%	70-130
m + p Xylene		Lab Fort Blank Amt.	40.0	ug/l	
		Lab Fort Blk. Found	44.4	ug/l	
		Lab Fort Blk. % Rec.	111.0	%	70-130
1,2-Dichlorobenzene		Lab Fort Blank Amt.	20.0	ug/l	
		Lab Fort Blk. Found	22.0	ug/l	
		Lab Fort Blk. % Rec.	110.2	%	70-130
1,3-Dichlorobenzene		Lab Fort Blank Amt.	20.0	ug/l	
		Lab Fort Blk. Found	22.3	ug/l	
		Lab Fort Blk. % Rec.	111.4	%	70-130
1,1-Dichloroethane		Lab Fort Blank Amt.	20.0	ug/l	
		Lab Fort Blk. Found	19.3	ug/l	
		Lab Fort Blk. % Rec.	96.5	%	70-130
1,1-Dichloroethylene		Lab Fort Blank Amt.	20.0	ug/l	
		Lab Fort Blk. Found	19.0	ug/l	
		Lab Fort Blk. % Rec.	94.8	%	70-130
1,4-Dioxane		Lab Fort Blank Amt.	100.0	ug/l	



39 Spruce Street ° East Longmeadow, MA 01028 ° FAX 413/525-6405 ° TEL. 413/525-2332

QC SUMMARY REPORT

SAMPLE QC: Sample Results with Duplicates

BATCH QC: Lab fortified Blanks and Duplicates

Sample Matrix Spikes and Matrix Spike Duplicates

Standard Reference Materials and Duplicates

Method Blanks

Report Date: 4/12/2005

Lims Bat #: LIMS-87387

Page 5 of 10

QC Batch Number: GCMS/VOL-11800

Sample Id	Analysis	QC Analysis	Values	Units	Limits
LFBLANK-40594	1,4-Dioxane	Lab Fort Blk. Found	100.0	ug/l	
		Lab Fort Blk. % Rec.	100.0	%	50-155
	MTBE	Lab Fort Blank Amt.	40.0	ug/l	
		Lab Fort Blk. Found	38.6	ug/l	
	trans-1,2-Dichloroethylene	Lab Fort Blk. % Rec.	96.4	%	70-130
		Lab Fort Blank Amt.	20.0	ug/l	
		Lab Fort Blk. Found	19.8	ug/l	
		Lab Fort Blk. % Rec.	98.8	%	70-130
	Vinyl Chloride	Lab Fort Blank Amt.	20.0	ug/l	
		Lab Fort Blk. Found	20.4	ug/l	
		Lab Fort Blk. % Rec.	102.0	%	70-130
		Lab Fort Blank Amt.	20.0	ug/l	
	Methylene Chloride	Lab Fort Blk. Found	19.3	ug/l	
		Lab Fort Blk. % Rec.	96.4	%	70-130
	Chlorobenzene	Lab Fort Blank Amt.	20.0	ug/l	
		Lab Fort Blk. Found	21.3	ug/l	
		Lab Fort Blk. % Rec.	106.3	%	70-130
		Lab Fort Blank Amt.	20.0	ug/l	
	Chloromethane	Lab Fort Blk. Found	19.0	ug/l	
		Lab Fort Blk. % Rec.	95.0	%	70-130
	Bromomethane	Lab Fort Blank Amt.	20.0	ug/l	
		Lab Fort Blk. Found	17.7	ug/l	
		Lab Fort Blk. % Rec.	88.3	%	70-130
		Lab Fort Blank Amt.	20.0	ug/l	
	Chloroethane	Lab Fort Blk. Found	20.6	ug/l	
		Lab Fort Blk. % Rec.	103.2	%	70-130
	cis-1,3-Dichloropropene	Lab Fort Blank Amt.	20.0	ug/l	
		Lab Fort Blk. Found	17.9	ug/l	
		Lab Fort Blk. % Rec.	89.3	%	70-130
		Lab Fort Blank Amt.	20.0	ug/l	
	trans-1,3-Dichloropropene	Lab Fort Blk. Found	15.2	ug/l	
		Lab Fort Blk. % Rec.	76.1	%	70-130
	Chlorodibromomethane	Lab Fort Blank Amt.	20.0	ug/l	
		Lab Fort Blk. Found	17.7	ug/l	
		Lab Fort Blk. % Rec.	88.4	%	70-130
		Lab Fort Blank Amt.	20.0	ug/l	
	1,1,2-Trichloroethane	Lab Fort Blk. Found	19.2	ug/l	
		Lab Fort Blk. % Rec.	96.0	%	70-130
	2-Chloroethylvinylether	Lab Fort Blk. Found		ug/l	
		Lab Fort Blank Amt.	20.0	ug/l	
	Bromoform	Lab Fort Blk. Found	16.1	ug/l	
		Lab Fort Blk. % Rec.	80.4	%	70-130
	1,1,2,2-Tetrachloroethane	Lab Fort Blank Amt.	20.0	ug/l	



39 Spruce Street ° East Longmeadow, MA 01028 ° FAX 413/525-6405 ° TEL. 413/525-2332

QC SUMMARY REPORT

SAMPLE QC: Sample Results with Duplicates

BATCH QC: Lab fortified Blanks and Duplicates

Sample Matrix Spikes and Matrix Spike Duplicates

Standard Reference Materials and Duplicates

Method Blanks

Report Date: 4/12/2005

Lims Bat #: LIMS-87387

Page 6 of 10

QC Batch Number: GCMS/VOL-11800

Sample Id	Analysis	QC Analysis	Values	Units	Limits
LFBLANK-40594	1,1,2,2-Tetrachloroethane	Lab Fort Blk. Found	19.7	ug/l	
		Lab Fort Blk. % Rec.	98.3	%	70-130
	2-Chlorotoluene	Lab Fort Blank Amt.	20.0	ug/l	
		Lab Fort Blk. Found	21.5	ug/l	
	Hexachlorobutadiene	Lab Fort Blk. % Rec.	107.6	%	70-130
		Lab Fort Blank Amt.	20.0	ug/l	
	Isopropylbenzene	Lab Fort Blk. Found	22.3	ug/l	
		Lab Fort Blk. % Rec.	111.4	%	70-130
	p-Isopropyltoluene	Lab Fort Blank Amt.	20.0	ug/l	
		Lab Fort Blk. Found	22.1	ug/l	
	n-Propylbenzene	Lab Fort Blk. % Rec.	110.5	%	70-130
		Lab Fort Blank Amt.	20.0	ug/l	
	sec-Butylbenzene	Lab Fort Blk. Found	22.4	ug/l	
		Lab Fort Blk. % Rec.	112.2	%	70-130
	tert-Butylbenzene	Lab Fort Blank Amt.	20.0	ug/l	
		Lab Fort Blk. Found	22.1	ug/l	
	1,2,3-Trichlorobenzene	Lab Fort Blk. % Rec.	110.7	%	70-130
		Lab Fort Blank Amt.	20.0	ug/l	
	1,2,4-Trichlorobenzene	Lab Fort Blk. Found	22.9	ug/l	
		Lab Fort Blk. % Rec.	114.4	%	70-130
	1,2,4-Trimethylbenzene	Lab Fort Blank Amt.	20.0	ug/l	
		Lab Fort Blk. Found	22.4	ug/l	
	1,3,5-Trimethylbenzene	Lab Fort Blk. % Rec.	111.8	%	70-130
		Lab Fort Blank Amt.	20.0	ug/l	
	Dibromomethane	Lab Fort Blk. Found	17.7	ug/l	
		Lab Fort Blk. % Rec.	88.7	%	70-130
	cis-1,2-Dichloroethylene	Lab Fort Blank Amt.	20.0	ug/l	
		Lab Fort Blk. Found	18.4	ug/l	
	4-Chlorotoluene	Lab Fort Blk. % Rec.	91.8	%	70-130
		Lab Fort Blank Amt.	20.0	ug/l	
		Lab Fort Blk. Found	22.2	ug/l	
		Lab Fort Blk. % Rec.	111.0	%	70-130
		Lab Fort Blank Amt.	20.0	ug/l	
		Lab Fort Blk. Found	21.2	ug/l	
		Lab Fort Blk. % Rec.	106.0	%	70-130
		Lab Fort Blank Amt.	20.0	ug/l	
		Lab Fort Blk. Found	17.3	ug/l	
		Lab Fort Blk. % Rec.	86.4	%	70-130
		Lab Fort Blank Amt.	20.0	ug/l	
		Lab Fort Blk. Found	19.0	ug/l	
		Lab Fort Blk. % Rec.	95.1	%	70-130
		Lab Fort Blank Amt.	20.0	ug/l	
		Lab Fort Blk. Found	21.7	ug/l	



39 Spruce Street ° East Longmeadow, MA 01028 ° FAX 413/525-6405 ° TEL. 413/525-2332

QC SUMMARY REPORT

SAMPLE QC: Sample Results with Duplicates

BATCH QC: Lab fortified Blanks and Duplicates

Sample Matrix Spikes and Matrix Spike Duplicates

Standard Reference Materials and Duplicates

Method Blanks

Report Date: 4/12/2005

Lims Bat #: LIMS-87387

Page 7 of 10

QC Batch Number: GCMS/VOL-11800

Sample Id	Analysis	QC Analysis	Values	Units	Limits
LFBLANK-40594	4-Chlorotoluene	Lab Fort Blk. % Rec.	108.6	%	70-130
	1,1-Dichloropropene	Lab Fort Blank Amt.	20.0	ug/l	
	1,2-Dichloropropane	Lab Fort Blk. Found	19.8	ug/l	
		Lab Fort Blk. % Rec.	99.0	%	70-130
		Lab Fort Blank Amt.	20.0	ug/l	
	1,3-Dichloropropane	Lab Fort Blk. Found	20.3	ug/l	
		Lab Fort Blk. % Rec.	101.6	%	70-130
		Lab Fort Blank Amt.	20.0	ug/l	
	2,2-Dichloropropane	Lab Fort Blk. Found	19.0	ug/l	
		Lab Fort Blk. % Rec.	94.8	%	70-130
		Lab Fort Blank Amt.	20.0	ug/l	
	1,1,1,2-Tetrachloroethane	Lab Fort Blk. Found	10.8	ug/l	
		Lab Fort Blk. % Rec.	54.0	%	70-130
		Lab Fort Blank Amt.	20.0	ug/l	
	1,2,3-Trichloropropane	Lab Fort Blk. Found	20.3	ug/l	
		Lab Fort Blk. % Rec.	101.4	%	70-130
		Lab Fort Blank Amt.	20.0	ug/l	
	n-Butylbenzene	Lab Fort Blk. Found	19.1	ug/l	
		Lab Fort Blk. % Rec.	95.4	%	70-130
		Lab Fort Blank Amt.	20.0	ug/l	
	Dichlorodifluoromethane	Lab Fort Blk. Found	21.0	ug/l	
		Lab Fort Blk. % Rec.	104.9	%	70-130
		Lab Fort Blank Amt.	20.0	ug/l	
	Bromochloromethane	Lab Fort Blk. Found	19.1	ug/l	
		Lab Fort Blk. % Rec.	95.6	%	70-130
		Lab Fort Blank Amt.	20.0	ug/l	
	Bromobenzene	Lab Fort Blk. Found	18.3	ug/l	
		Lab Fort Blk. % Rec.	91.4	%	70-130
		Lab Fort Blank Amt.	20.0	ug/l	
	Iodomethane	Lab Fort Blk. Found	21.1	ug/l	
		Lab Fort Blk. % Rec.	105.5	%	70-130
		Lab Fort Blank Amt.	20.0	ug/l	
	Acrolein	Lab Fort Blk. Found	24.2	ug/l	
		Lab Fort Blk. % Rec.	120.9	%	
		Lab Fort Blank Amt.	20.0	ug/l	
	Acrylonitrile	Lab Fort Blk. Found	22.0	ug/l	
		Lab Fort Blk. % Rec.	110.1	%	
		Lab Fort Blank Amt.	20.0	ug/l	
	Carbon Disulfide	Lab Fort Blk. Found	25.9	ug/l	
		Lab Fort Blk. % Rec.	129.6	%	70-130
		Lab Fort Blank Amt.	20.0	ug/l	
	Vinyl Acetate	Lab Fort Blk. Found		%	
	2-Hexanone	Lab Fort Blank Amt.	20.0	ug/l	



39 Spruce Street ° East Longmeadow, MA 01028 ° FAX 413/525-6405 ° TEL. 413/525-2332

QC SUMMARY REPORT

SAMPLE QC: Sample Results with Duplicates

BATCH QC: Lab fortified Blanks and Duplicates

Sample Matrix Spikes and Matrix Spike Duplicates

Standard Reference Materials and Duplicates

Method Blanks

Report Date: 4/12/2005

Lims Bat #: LIMS-87387

Page 8 of 10

QC Batch Number: GCMS/VOL-11800

Sample Id	Analysis	QC Analysis	Values	Units	Limits
LFBLANK-40594	2-Hexanone	Lab Fort Blk. Found	15.1	ug/l	
		Lab Fort Blk. % Rec.	75.3	%	50-155
	trans-1,4-Dichloro-2-Butene	Lab Fort Blank Amt.	20.0	ug/l	
		Lab Fort Blk. Found	12.4	ug/l	
		Lab Fort Blk. % Rec.	62.0	%	
	Ethyl Methacrylate	Lab Fort Blank Amt.	20.0	ug/l	
		Lab Fort Blk. Found	19.1	ug/l	
		Lab Fort Blk. % Rec.	95.4	%	
	cis-1,4-Dichloro-2-Butene	Lab Fort Blk. Found		%	
	Diethyl Ether	Lab Fort Blank Amt.	20.0	ug/l	
		Lab Fort Blk. Found	22.1	ug/l	
		Lab Fort Blk. % Rec.	110.4	%	50-155
	Bromodichloromethane	Lab Fort Blank Amt.	20.0	ug/l	
		Lab Fort Blk. Found	18.0	ug/l	
		Lab Fort Blk. % Rec.	90.2	%	70-130
	1,2-Dibromo-3-Chloropropane	Lab Fort Blank Amt.	20.0	ug/l	
		Lab Fort Blk. Found	15.9	ug/l	
		Lab Fort Blk. % Rec.	79.6	%	70-130
	1,2-Dibromoethane	Lab Fort Blank Amt.	20.00	ug/l	
		Lab Fort Blk. Found	19.03	ug/l	
		Lab Fort Blk. % Rec.	95.15	%	70-130
	Tetrahydrofuran	Lab Fort Blank Amt.	20.0	ug/l	
		Lab Fort Blk. Found	16.0	ug/l	
		Lab Fort Blk. % Rec.	80.0	%	50-155
	tert-Butyl Alcohol	Lab Fort Blank Amt.	100.0	ug/l	
		Lab Fort Blk. Found	96.5	ug/l	
		Lab Fort Blk. % Rec.	96.5	%	
	Diisopropyl Ether	Lab Fort Blank Amt.	20.0	ug/l	
		Lab Fort Blk. Found	19.7	ug/l	
		Lab Fort Blk. % Rec.	98.7	%	50-155
	tert-Butylethyl Ether	Lab Fort Blank Amt.	20.0	ug/l	
		Lab Fort Blk. Found	19.4	ug/l	
		Lab Fort Blk. % Rec.	97.0	%	50-155
	tert-Amylmethyl Ether	Lab Fort Blank Amt.	20.0	ug/l	
		Lab Fort Blk. Found	20.3	ug/l	
		Lab Fort Blk. % Rec.	101.4	%	50-155



39 Spruce Street ° East Longmeadow, MA 01028 ° FAX 413/525-6405 ° TEL. 413/525-2332

QC SUMMARY REPORT

SAMPLE QC: Sample Results with Duplicates

BATCH QC: Lab fortified Blanks and Duplicates

Sample Matrix Spikes and Matrix Spike Duplicates

Standard Reference Materials and Duplicates

Method Blanks

Report Date: 4/12/2005

Lims Bat #: LIMS-87387

Page 9 of 10

NOTES:

QC Batch No. : GCMS/VOL-11800
Sample ID : LFBLANK-40594
Analysis : 2,2-Dichloropropane

THIS COMPOUND IS CLASSIFIED AS A "DIFFICULT ANALYTE" IN METHOD SW846 8260
AND CONTROL LIMITS OF 50-155% ARE USED FOR THE LABORATORY FORTIFIED BLANK
RECOVERY.



39 Spruce Street ° East Longmeadow, MA 01028 ° FAX 413/525-6405 ° TEL. 413/525-2332

QC SUMMARY REPORT

SAMPLE QC: Sample Results with Duplicates BATCH QC: Lab fortified Blanks and Duplicates
Sample Matrix Spikes and Matrix Spike Duplicates Standard Reference Materials and Duplicates
Method Blanks

Report Date: 4/12/2005 Lims Bat #: LIMS-87387 Page 10 of 10

QUALITY CONTROL DEFINITIONS AND ABBREVIATIONS

QC BATCH NUMBER This is the number assigned to all samples analyzed together that would be subject to comparison with a particular set of Quality Control Data.

LIMITS Upper and Lower Control Limits for the QC ANALYSIS Reported. All values normally would fall within these statistically determined limits, unless there is an unusual circumstance that would be documented in a NOTE appearing on the last page of the QC SUMMARY REPORT. Not all QC results will have Limits defined.

Sample Amount Amount of analyte found in a sample.

Blank Method Blank that has been taken though all the steps of the analysis.

LFBLANK Laboratory Fortified Blank (a control sample)

STDADD Standard Added (a laboratory control sample)

Matrix Spk Amt Added Amount of analyte spiked into a sample
MS Amt Measured Amount of analyte found including amount that was spiked
Matrix Spike % Rec. % Recovery of spiked amount in sample.

Duplicate Value The result from the Duplicate analysis of the sample.
Duplicate RPD The Relative Percent Difference between two Duplicate Analyses.

Surrogate Recovery The % Recovery for non-environmental compounds (surrogates) spiked into samples to determine the performance of the analytical methods.

Sur. Recovery (ELCD) Surrogate Recovery on the Electrolytic Conductivity Detector.
Sur. Recovery (PID) Surrogate Recovery on the Photoionization Detector.

Standard Measured Amount measured for a laboratory control sample
Standard Amt Added Known value for a laboratory control sample
Standard % Recovery % recovered for a laboratory control sample with a known value.

Lab Fort Blank Amt Laboratory Fortified Blank Amount Added
Lab Fort Blk. Found Laboratory Fortified Blank Amount Found
Lab Fort Blk % Rec Laboratory Fortified Blank % Recovered
Dup Lab Fort Bl Amt Duplicate Laboratory Fortified Blank Amount Added
Dup Lab Fort Bl Fnd Duplicate Laboratory Fortified Blank Amount Found
Dup Lab Fort Bl % Rec Duplicate Laboratory Fortified Blank % Recovery
Lab Fort Blank Range Laboratory Fortified Blank Range (Absolute value of difference between recoveries for Lab Fortified Blank and Lab Fortified Blank Duplicate).

Lab Fort Bl. Av. Rec. Laboratory Fortified Blank Average Recovery

Duplicate Sample Amt Sample Value for Duplicate used with Matrix Spike Duplicate
MSD Amount Added Matrix Spike Duplicate Amount Added (Spiked)
MSD Amt Measured Matrix Spike Duplicate Amount Measured
MSD % Recovery Matrix Spike Duplicate % Recovery
MSD Range Absolute difference between Matrix Spike and Matrix Spike Duplicate Recoveries



Phone: 413-525-2332
 Fax: 413-525-6405
 Email: info@contestlabs.com
 www.contestlabs.com

CHAIN OF CUSTODY RECORD

39 SPRUCE ST, 2ND FLOOR
 EAST LONGMEADOW, MA 01028

Page ___ of ___

Company Name: LER, INC.
 Address: 256 Centerville Rd Bldg, Suite 12
Warwick RI 02888
 Attention: Diana Pallister

Telephone: (401) 738-3887
 Project # 081-12152-01
 Client PO # _____

Project Location: Springfield St. School
 Sampled By: A. Cate

DATA DELIVERY (check one):
 FAX EMAIL WEBSITE CLIENT
 Fax #: _____
 Email: _____
 Format: EXCEL PDF GIS KEY

Proposal Provided? (For Billing purposes) yes no
 State Form Required? yes no

Field ID	Sample Description	Lab #	OSR	Start Date/Time	Stop Date/Time	Comp- osite	Grab	*Matrix Code	# of containers
	ATC-1	12108		4/6/05	1100	X		GW	2
	ATC-2	12109		4/6/05	1350	X		GW	2
	ATC-3	12110		4/6/05	1705	X		GW	2
	ATC-4	12111		4/6/05	1225	X		GW	2
	ATC-5	12112		4/6/05	1150	X		GW	2
	Trip Blank	12113							2

VOCs (8260)

Relinquished by: (signature) [Signature] Date/Time: 4/6/05 1515
 Received by: (signature) [Signature] Date/Time: 4-7-05
 Relinquished by: (signature) [Signature] Date/Time: 4-2-05 1650
 Received by: (signature) [Signature] Date/Time: 4/7/05 18:50

Turnaround **
 *5-Day
 7-Day
 10-Day
 RUSH *
 *24-Hr *48-Hr
 *72-Hr *4-Day
 *Require lab approval

Detection Limit Requirements
 Regulations? Rhode Island
 Data Enhancement Project? Y N
 (MA MCP sites only)
 Special Requirements or DL's: _____

*Matrix Code:
 GW = groundwater
 WW = wastewater
 DW = drinking water
 A = air
 S = soil/solid
 SL = sludge
 O = other

**Preservation Codes:
 I = Iced X = Na hydroxide
 H = HCL T = Na thiosulfate
 M = Methanol
 N = Nitric Acid
 S = Sulfuric Acid
 B = Sodium bisulfate
 O = Other

Comments:

Con-Test Laboratory is the ONLY independent laboratory in all of New England with both prestigious ALPHA and NELAP Certifications and WBE/DBE Certified!

Attachment 3
Soil Gas Graphs

Soil Gas Well EPL1
Fluctuation in Methane, Oxygen, and Carbon Dioxide Percentages over Time
Springfield Street School Complex
Providence, Rhode Island

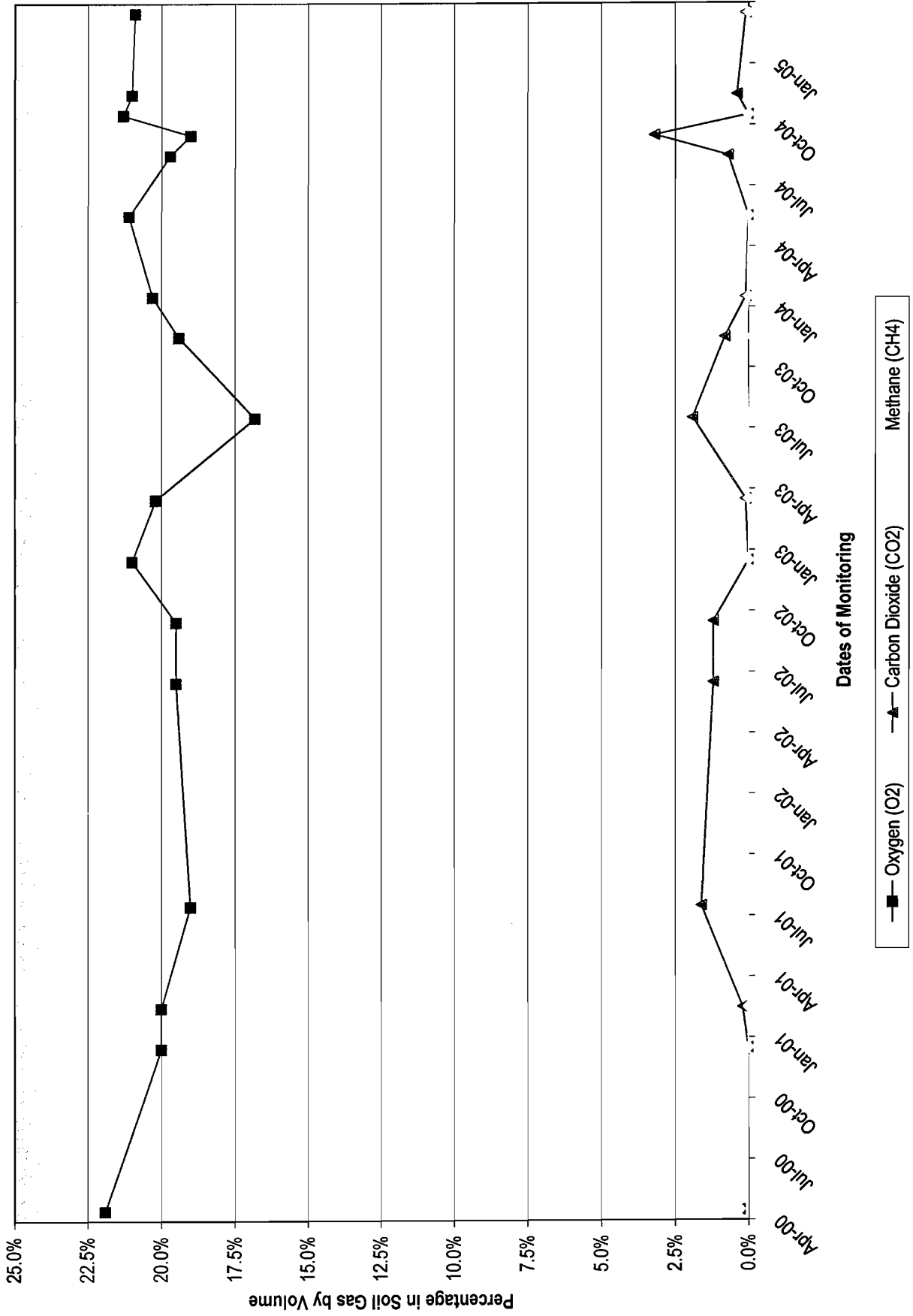

Soil Gas Well EPL4
Fluctuation in Methane, Oxygen, and Carbon Dioxide Percentages over Time
Springfield Street School Complex
Providence, Rhode Island

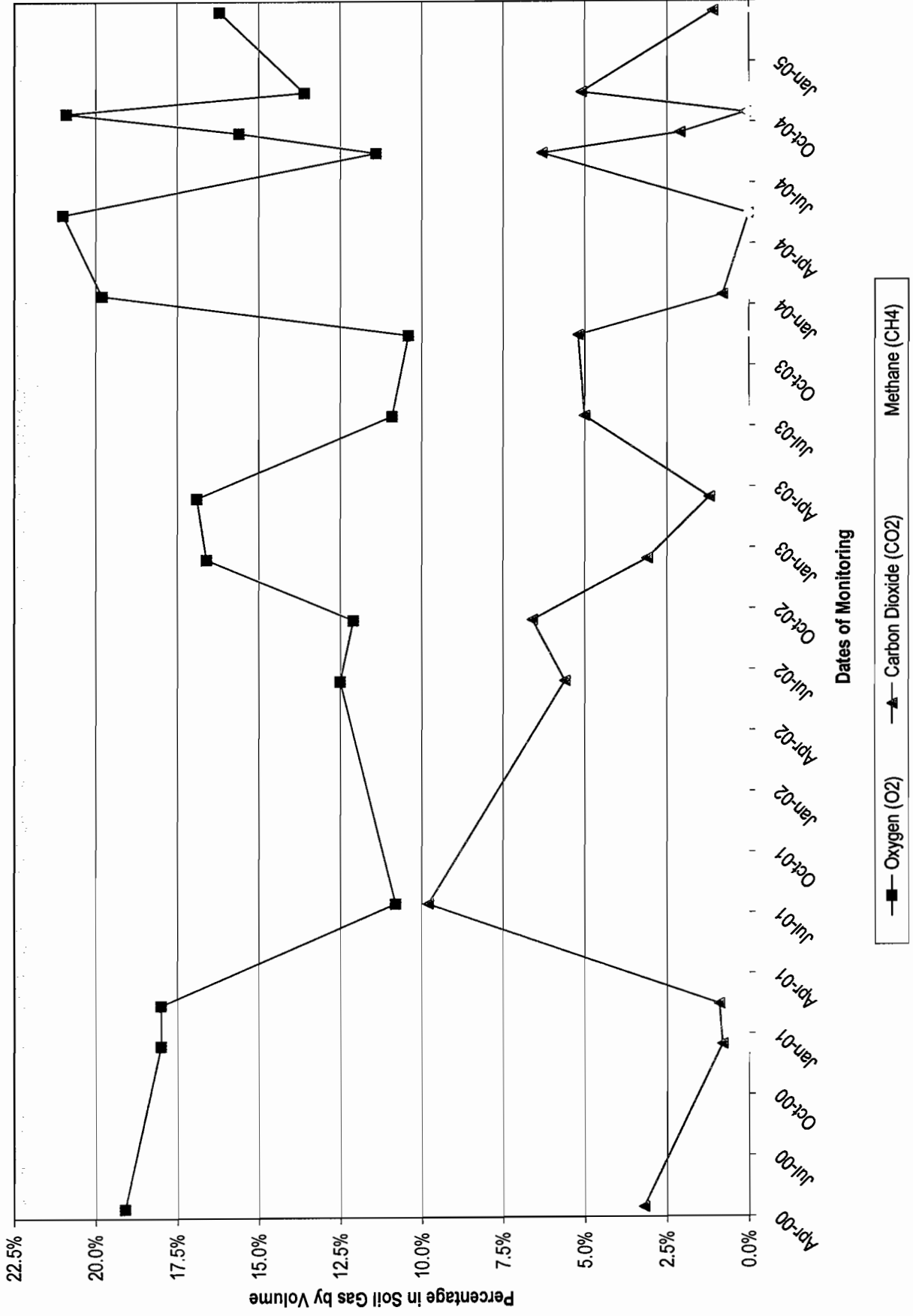

Soil Gas Well MG2
Fluctuation in Methane, Oxygen, and Carbon Dioxide Percentages over Time
Springfield Street School Complex
Providence, Rhode Island

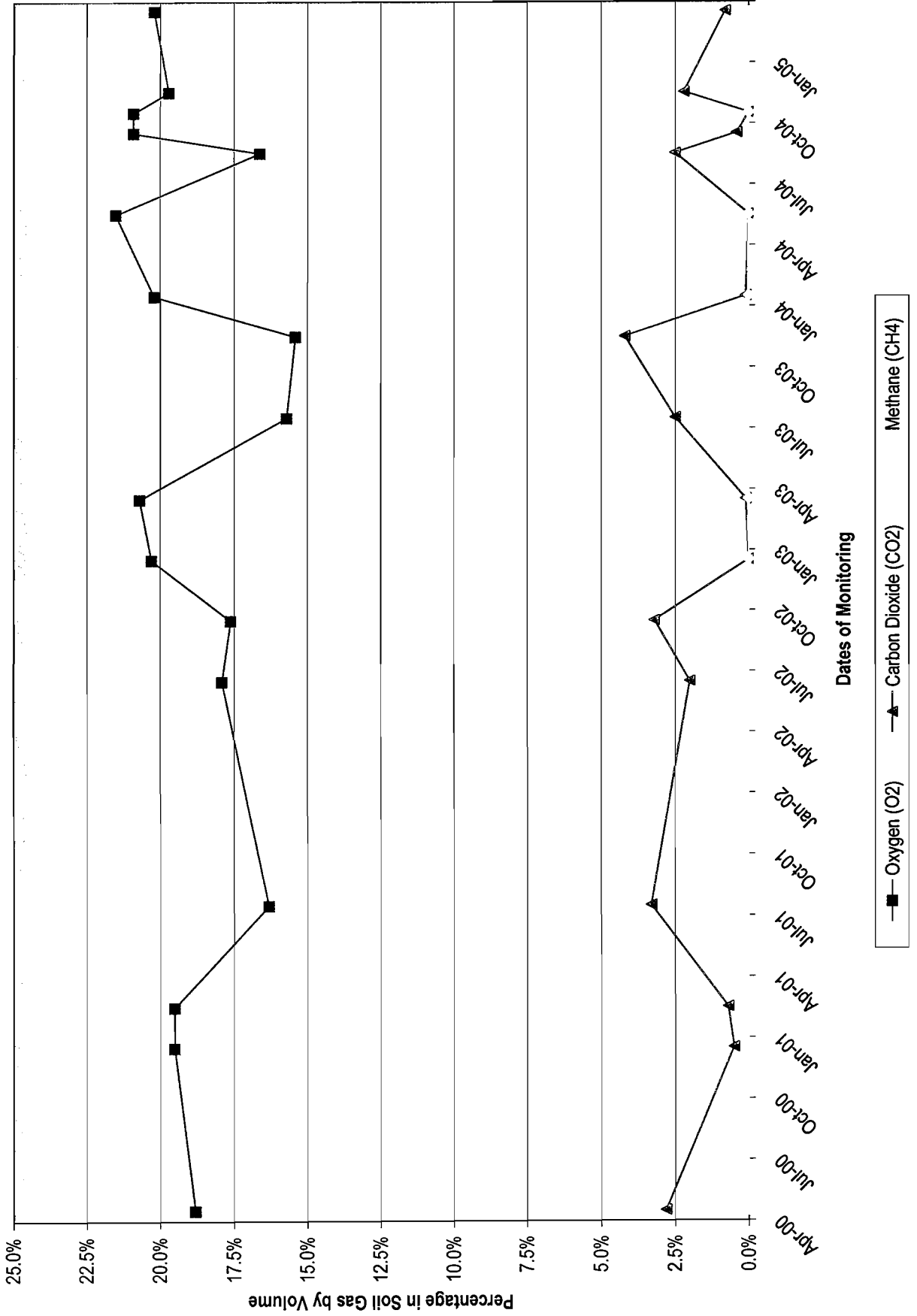

Soil Gas Well MPL5
Fluctuation in Methane, Oxygen, and Carbon Dioxide Percentages over Time
Springfield Street School Complex
Providence, Rhode Island

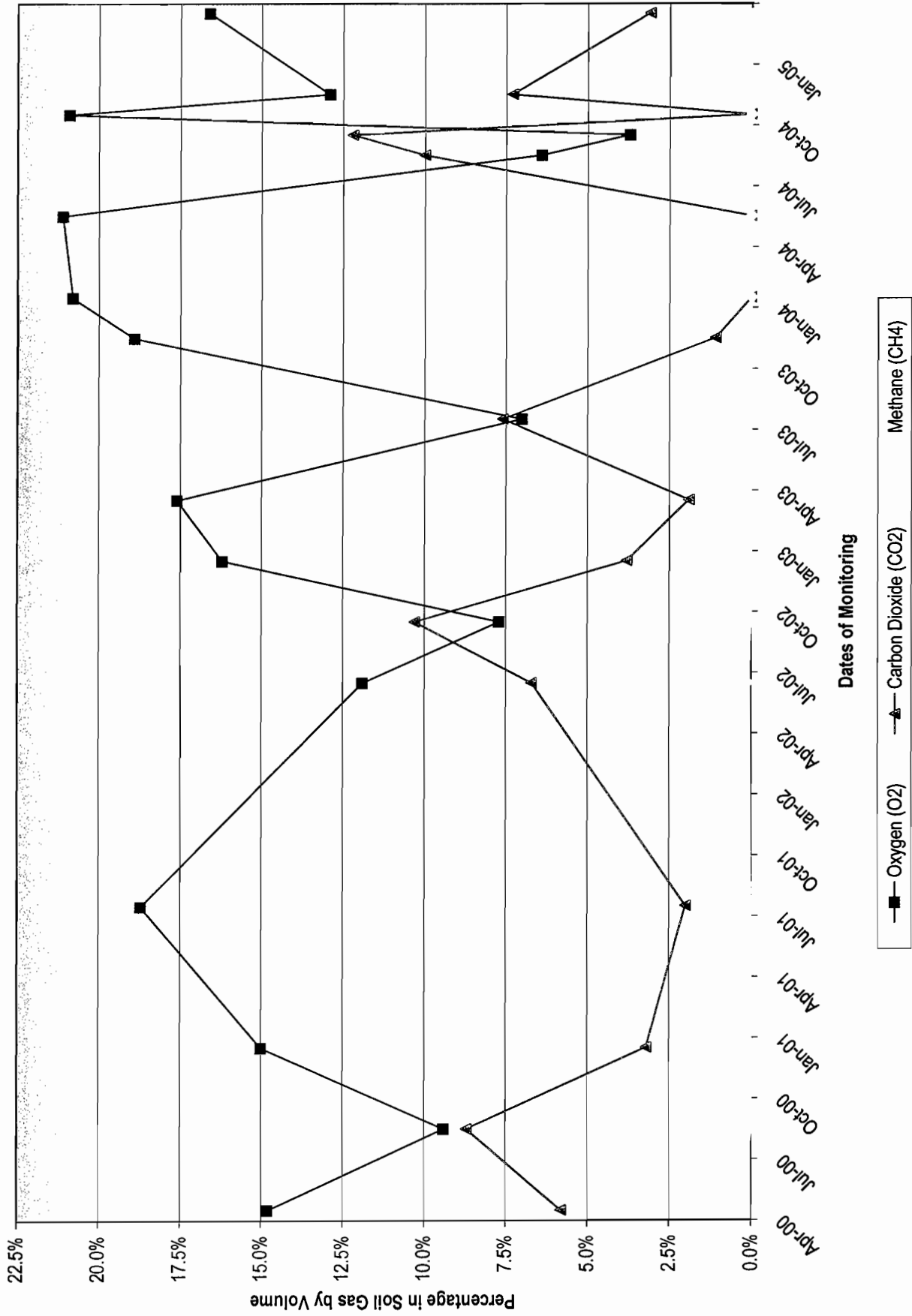

Soil Gas Well WB1
Fluctuation in Methane, Oxygen, and Carbon Dioxide Percentages over Time
Springfield Street School Complex
Providence, Rhode Island

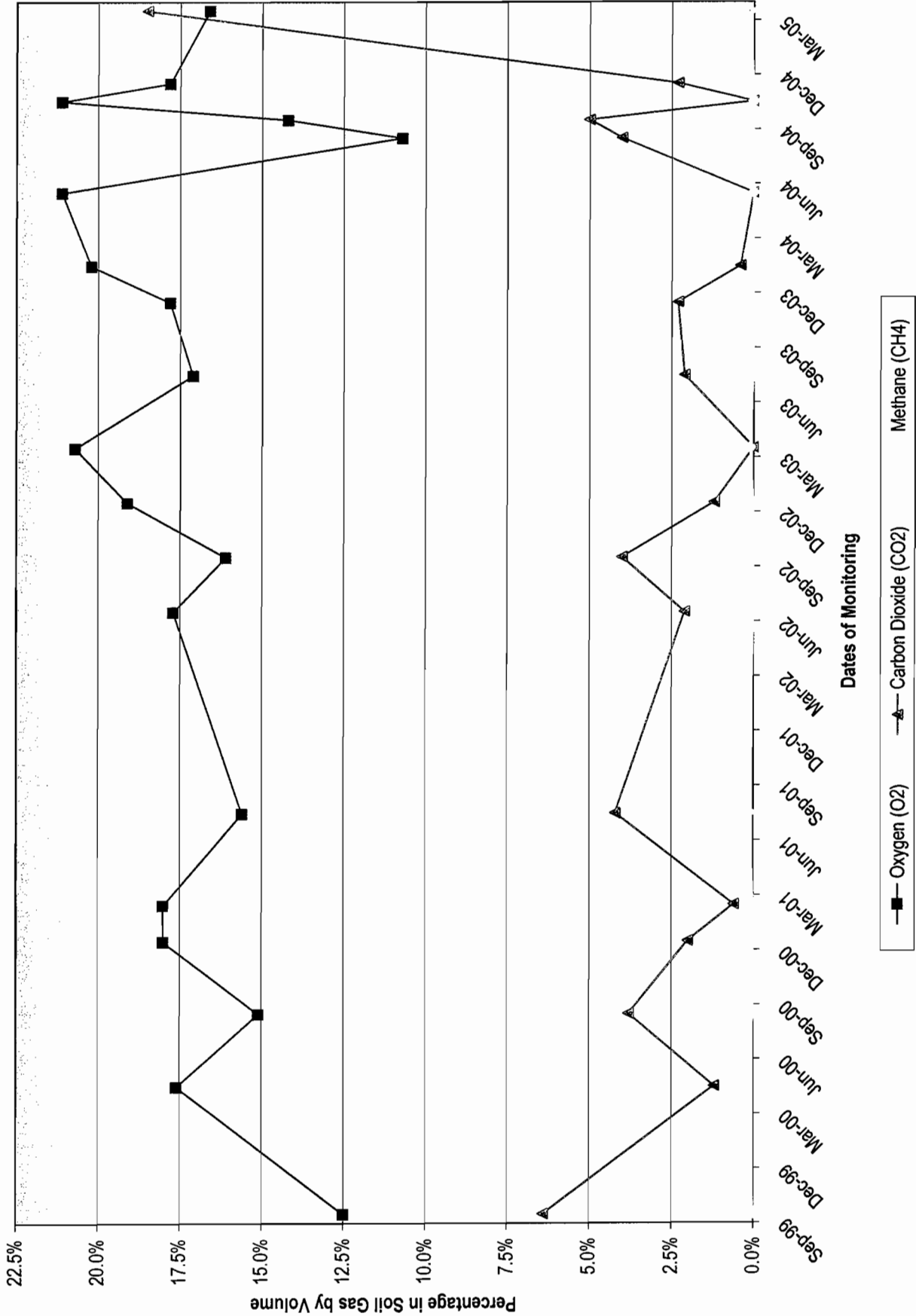

Soil Gas Well WB7
Fluctuation in Methane, Oxygen, and Carbon Dioxide Percentages over Time
 Springfield Street School Complex
 Providence, Rhode Island

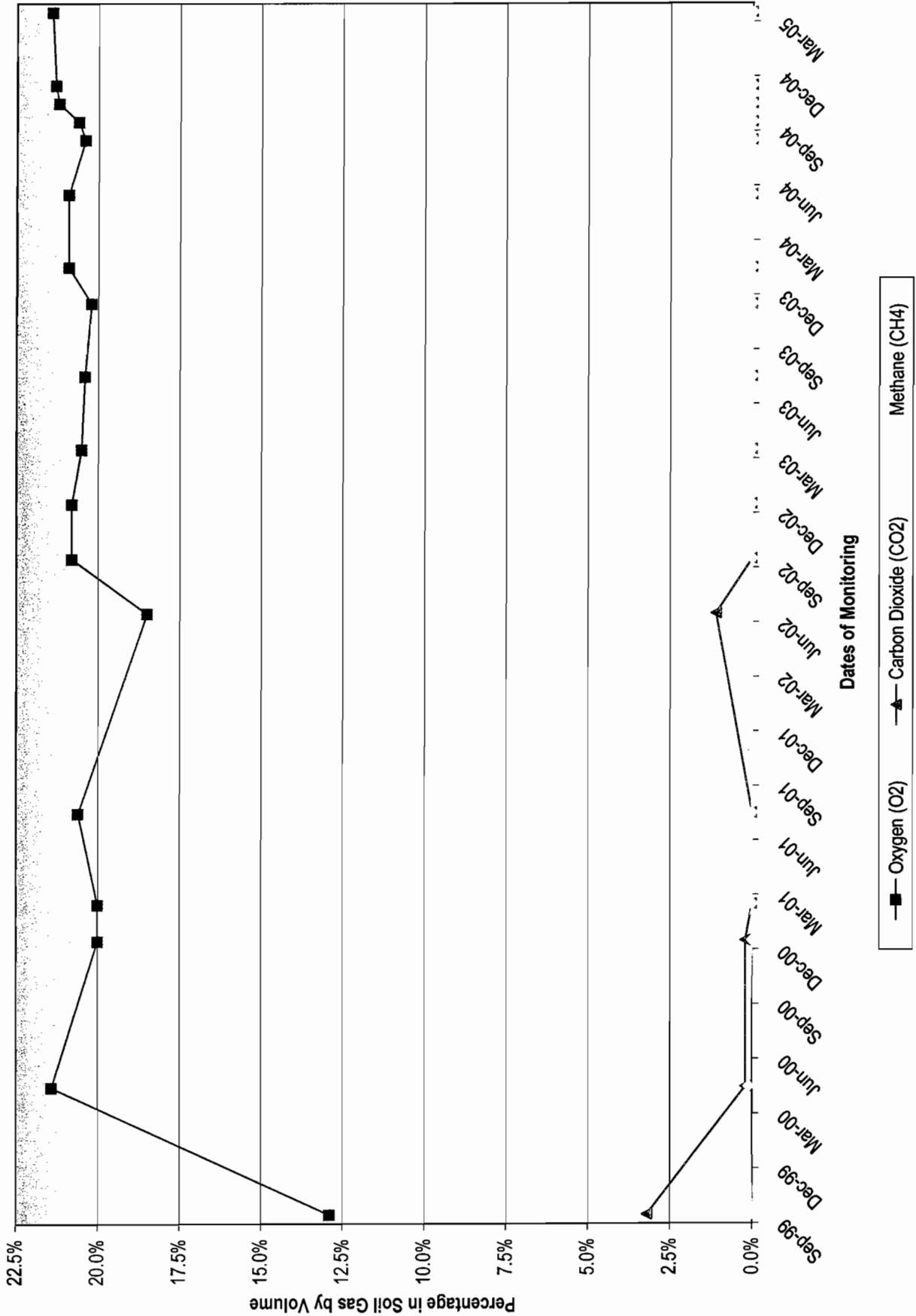

Soil Gas Well WB15
Fluctuation in Methane, Oxygen, and Carbon Dioxide Percentages over Time
Springfield Street School Complex
Providence, Rhode Island

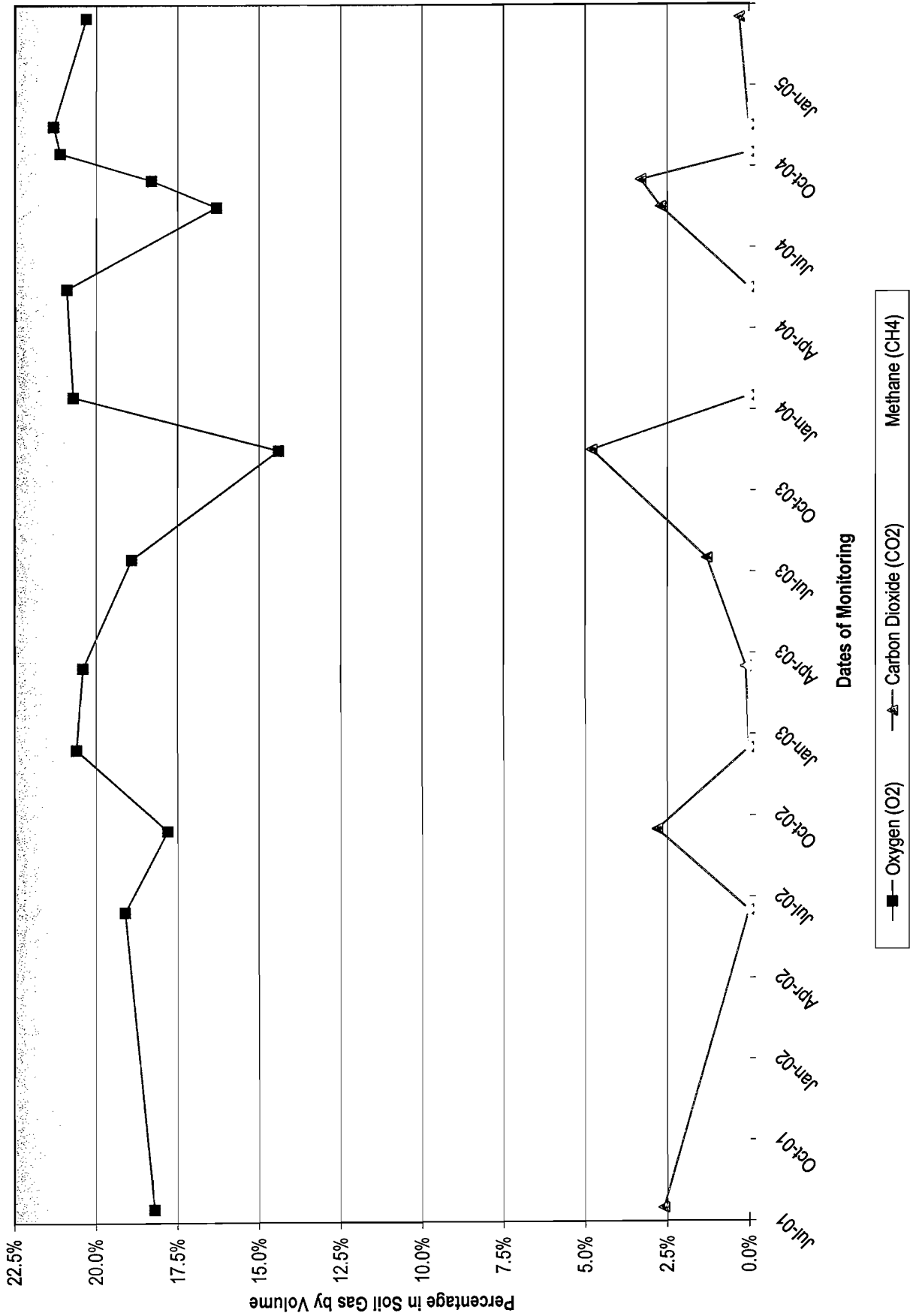

Attachment 4

Laboratory Report for Soil Gas



39 Spruce Street ° East Longmeadow, MA 01028 ° FAX 413/525-6405 ° TEL. 413/525-2332

REPORT DATE 4/1/2005

LEVINE FRICKE
250 CENTERVILLE RD., BLDG. E, SUITE 12
WARWICK, RI 02886
ATTN: DONNA PALLISTER

CONTRACT NUMBER:
PURCHASE ORDER NUMBER: 5131

PROJECT NUMBER:

ANALYTICAL SUMMARY

LIMS BAT #: LIMS-87125
JOB NUMBER: 081-12152-01

The results of analyses performed on the following samples submitted to the CON-TEST Analytical Laboratory are found in this report.

PROJECT LOCATION: SPRINGFIELD ST. SCHOOL, PROVIDENCE, RI.

FIELD SAMPLE #	LAB ID	MATRIX	SAMPLE DESCRIPTION	TEST
MPL-2	05B10961	AIR	NOT SPECIFIED	to-14 ppbv
MPL-2	05B10961	AIR	NOT SPECIFIED	to-14 ug/m3
WB-2	05B10960	AIR	NOT SPECIFIED	to-14 ppbv
WB-2	05B10960	AIR	NOT SPECIFIED	to-14 ug/m3

The CON-TEST Environmental Laboratory operates under the following certifications and accreditations :

AIHA 100033	AIHA ELLAP (LEAD) 100033	
MASSACHUSETTS MA0100	NEW HAMPSHIRE NELAP 2516	NEW JERSEY NELAP NJ MA007 (AIR)
CONNECTICUT PH-0567	VERMONT DOH (LEAD) No. LL015036	ARIZONA AZ0648
NEW YORK ELAP/NELAP 10899	RHODE ISLAND (LIC. No. 112)	ARIZONA AZ0654 (AIR)

I certify that the analyses listed above, unless specifically listed as subcontracted, if any, were performed under my direction according to the approved methodologies listed in this document, and that based upon my inquiry of those individuals immediately responsible for obtaining the information, the material contained in this report is, to the best of my knowledge and belief, accurate and complete.

Edward Denson 4/1/05
SIGNATURE DATE

Tod Kopycinski
Director of Operations

Sondra S. Kocot
Quality Control Coordinator

Edward Denson
Technical Director

DONNA PALLISTER
 LEVINE FRICKE
 250 CENTERVILLE RD., BLDG. E, SUITE 12
 WARWICK, RI 02886

4/1/2005
 Page 1 of 9

Purchase Order No.: 5131

Project Location: SPRINGFIELD ST. SCHOOL, PROVIDENCE, RI.
 Date Received: 3/30/2005

LIMS-BAT #: LIMS-87125
 Job Number: 081-12152-01

Field Sample #: MPL-2

Sample ID : 05B10961

Sampled : 3/29/2005
 NOT SPECIFIED

Sample Matrix: AIR

Sample Medium : TEDLAR BAG

	Units	Results	Date Analyzed	Analyst	RL	SPEC Limit		P / F
						Lo	Hi	
Benzene	PPBv	ND	03/31/05	WSD	0.5			
Bromomethane	PPBv	ND	03/31/05	WSD	0.5			
Carbon Tetrachloride	PPBv	ND	03/31/05	WSD	0.5			
Chlorobenzene	PPBv	ND	03/31/05	WSD	0.5			
Chloroethane	PPBv	ND	03/31/05	WSD	0.5			
Chloroform	PPBv	ND	03/31/05	WSD	0.5			
Chloromethane	PPBv	ND	03/31/05	WSD	0.5			
1,2-Dibromoethane	PPBv	ND	03/31/05	WSD	0.5			
1,2-Dichlorobenzene	PPBv	ND	03/31/05	WSD	0.5			
1,3-Dichlorobenzene	PPBv	ND	03/31/05	WSD	0.5			
1,4-Dichlorobenzene	PPBv	ND	03/31/05	WSD	0.5			
Dichlorodifluoromethane	PPBv	ND	03/31/05	WSD	0.5			
1,1-Dichloroethane	PPBv	ND	03/31/05	WSD	0.5			
1,2-Dichloroethane	PPBv	ND	03/31/05	WSD	0.5			
1,1-Dichloroethylene	PPBv	ND	03/31/05	WSD	0.5			
cis-1,2-Dichloroethylene	PPBv	ND	03/31/05	WSD	0.5			
1,2-Dichloropropane	PPBv	ND	03/31/05	WSD	0.5			
cis-1,3-Dichloropropene	PPBv	ND	03/31/05	WSD	0.5			
trans-1,3-Dichloropropene	PPBv	ND	03/31/05	WSD	0.5			
1,2-Dichlorotetrafluoroethane (114)	PPBv	ND	03/31/05	WSD	0.5			
Ethylbenzene	PPBv	ND	03/31/05	WSD	0.5			
Hexachlorobutadiene	PPBv	ND	03/31/05	WSD	0.5			
Methylene Chloride	PPBv	ND	03/31/05	WSD	0.5			
Styrene	PPBv	ND	03/31/05	WSD	0.5			
1,1,2,2-Tetrachloroethane	PPBv	ND	03/31/05	WSD	0.5			
Tetrachloroethylene	PPBv	ND	03/31/05	WSD	0.5			
Toluene	PPBv	3.1	03/31/05	WSD	0.5			
1,2,4-Trichlorobenzene	PPBv	ND	03/31/05	WSD	0.5			
1,1,1-Trichloroethane	PPBv	ND	03/31/05	WSD	0.5			
1,1,2-Trichloroethane	PPBv	ND	03/31/05	WSD	0.5			

RL = Reporting Limit
 ND = Not Detected
 NM = Not Measured

SPEC LIMIT = a client specified recommended or regulatory level for comparison with data to determine PASS (P) or FAIL (F) condition of results.

* = See end of report for comments and notes applying to this sample

DONNA PALLISTER
 LEVINE FRICKE
 250 CENTERVILLE RD., BLDG. E, SUITE 12
 WARWICK, RI 02886

Purchase Order No.: 5131

4/1/2005
 Page 2 of 9

Project Location: SPRINGFIELD ST. SCHOOL, PROVIDENCE, RI.

LIMS-BAT #: LIMS-87125

Date Received: 3/30/2005

Job Number: 081-12152-01

Field Sample #: MPL-2

Sample ID : 05B10961

Sampled : 3/29/2005

NOT SPECIFIED

Sample Matrix: AIR

Sample Medium : TEDLAR BAG

	Units	Results	Date Analyzed	Analyst	RL	SPEC Limit		P/ F
						Lo	Hi	
Trichloroethylene	PPBv	ND	03/31/05	WSD	0.5			
Trichlorofluoromethane (Freon 11)	PPBv	ND	03/31/05	WSD	0.5			
1,1,2-Trichloro-1,2,2-Trifluoroethane	PPBv	ND	03/31/05	WSD	0.5			
1,2,4-Trimethylbenzene	PPBv	1.2	03/31/05	WSD	0.5			
1,3,5-Trimethylbenzene	PPBv	0.8	03/31/05	WSD	0.5			
Vinyl Chloride	PPBv	ND	03/31/05	WSD	0.5			
m/p-Xylene	PPBv	0.9	03/31/05	WSD	0.5			
o-Xylene	PPBv	0.9	03/31/05	WSD	0.5			

Analytical Method:

EPA TO-14A

SAMPLES ARE TAKEN IN SUMMA CANISTERS AND ANALYZED BY GAS CHROMATOGRAPHY WITH MASS SPECTROMETRY DETECTION. (GC/MS)

RL = Reporting Limit

ND = Not Detected

NM = Not Measured

SPEC LIMIT = a client specified recommended or regulatory level for comparison with data to determine PASS (P) or FAIL (F) condition of results.

* = See end of report for comments and notes applying to this sample

DONNA PALLISTER
 LEVINE FRICKE
 250 CENTERVILLE RD., BLDG. E, SUITE 12
 WARWICK, RI 02886

Purchase Order No.: 5131

4/1/2005
 Page 3 of 9

Project Location: SPRINGFIELD ST. SCHOOL, PROVIDENCE, RI.

LIMS-BAT #: LIMS-87125

Date Received: 3/30/2005

Job Number: 081-12152-01

Field Sample #: WB-2

Sample ID : 05B10960

Sampled : 3/29/2005

NOT SPECIFIED

Sample Matrix: AIR

Sample Medium : TEDLAR BAG

	Units	Results	Date Analyzed	Analyst	RL	SPEC Limit		P/ F
						Lo	Hi	
Benzene	PPBv	ND	03/31/05	WSD	0.5			
Bromomethane	PPBv	ND	03/31/05	WSD	0.5			
Carbon Tetrachloride	PPBv	ND	03/31/05	WSD	0.5			
Chlorobenzene	PPBv	ND	03/31/05	WSD	0.5			
Chloroethane	PPBv	ND	03/31/05	WSD	0.5			
Chloroform	PPBv	ND	03/31/05	WSD	0.5			
Chloromethane	PPBv	ND	03/31/05	WSD	0.5			
1,2-Dibromoethane	PPBv	ND	03/31/05	WSD	0.5			
1,2-Dichlorobenzene	PPBv	ND	03/31/05	WSD	0.5			
1,3-Dichlorobenzene	PPBv	ND	03/31/05	WSD	0.5			
1,4-Dichlorobenzene	PPBv	ND	03/31/05	WSD	0.5			
Dichlorodifluoromethane	PPBv	ND	03/31/05	WSD	0.5			
1,1-Dichloroethane	PPBv	ND	03/31/05	WSD	0.5			
1,2-Dichloroethane	PPBv	ND	03/31/05	WSD	0.5			
1,1-Dichloroethylene	PPBv	ND	03/31/05	WSD	0.5			
cis-1,2-Dichloroethylene	PPBv	ND	03/31/05	WSD	0.5			
1,2-Dichloropropane	PPBv	ND	03/31/05	WSD	0.5			
cis-1,3-Dichloropropene	PPBv	ND	03/31/05	WSD	0.5			
trans-1,3-Dichloropropene	PPBv	ND	03/31/05	WSD	0.5			
1,2-Dichlorotetrafluoroethane (114)	PPBv	ND	03/31/05	WSD	0.5			
Ethylbenzene	PPBv	0.7	03/31/05	WSD	0.5			
Hexachlorobutadiene	PPBv	ND	03/31/05	WSD	0.5			
Methylene Chloride	PPBv	ND	03/31/05	WSD	0.5			
Styrene	PPBv	ND	03/31/05	WSD	0.5			
1,1,2,2-Tetrachloroethane	PPBv	ND	03/31/05	WSD	0.5			
Tetrachloroethylene	PPBv	ND	03/31/05	WSD	0.5			
Toluene	PPBv	3.2	03/31/05	WSD	0.5			
1,2,4-Trichlorobenzene	PPBv	ND	03/31/05	WSD	0.5			
1,1,1-Trichloroethane	PPBv	ND	03/31/05	WSD	0.5			
1,1,2-Trichloroethane	PPBv	ND	03/31/05	WSD	0.5			

RL = Reporting Limit

SPEC LIMIT = a client specified recommended or regulatory level for comparison with data to determine PASS (P) or FAIL (F) condition of results.

ND = Not Detected

NM = Not Measured

* = See end of report for comments and notes applying to this sample

DONNA PALLISTER
 LEVINE FRICKE
 250 CENTERVILLE RD., BLDG. E, SUITE 12
 WARWICK, RI 02886

Purchase Order No.: 5131

4/1/2005
 Page 4 of 9

Project Location: SPRINGFIELD ST. SCHOOL, PROVIDENCE, RI.
 Date Received: 3/30/2005

LIMS-BAT #: LIMS-87125
 Job Number: 081-12152-01

Field Sample #: **WB-2**

Sample ID : **05B10960**

Sampled : 3/29/2005
 NOT SPECIFIED

Sample Matrix: AIR

Sample Medium : TEDLAR BAG

	Units	Results	Date Analyzed	Analyst	RL	SPEC Limit		P/ F
						Lo	Hi	
Trichloroethylene	PPBv	ND	03/31/05	WSD	0.5			
Trichlorofluoromethane (Freon 11)	PPBv	ND	03/31/05	WSD	0.5			
1,1,2-Trichloro-1,2,2-Trifluoroethane	PPBv	ND	03/31/05	WSD	0.5			
1,2,4-Trimethylbenzene	PPBv	1.0	03/31/05	WSD	0.5			
1,3,5-Trimethylbenzene	PPBv	0.7	03/31/05	WSD	0.5			
Vinyl Chloride	PPBv	ND	03/31/05	WSD	0.5			
m/p-Xylene	PPBv	ND	03/31/05	WSD	0.5			
o-Xylene	PPBv	0.8	03/31/05	WSD	0.5			

Analytical Method:
 EPA TO-14A

SAMPLES ARE TAKEN IN SUMMA CANISTERS AND ANALYZED BY GAS CHROMATOGRAPHY WITH MASS SPECTROMETRY DETECTION. (GC/MS)

RL = Reporting Limit

ND = Not Detected

NM = Not Measured

SPEC LIMIT = a client specified recommended or regulatory level for comparison with data to determine PASS (P) or FAIL (F) condition of results.

* = See end of report for comments and notes applying to this sample

DONNA PALLISTER
 LEVINE FRICKE
 250 CENTERVILLE RD., BLDG. E, SUITE 12
 WARWICK, RI 02886

Purchase Order No.: 5131

4/1/2005
 Page 5 of 9

Project Location: SPRINGFIELD ST. SCHOOL, PROVIDENCE, RI.

LIMS-BAT #: LIMS-87125

Date Received: 3/30/2005

Job Number: 081-12152-01

Field Sample #: MPL-2

Sample ID : 05B10961

Sampled : 3/29/2005

NOT SPECIFIED

Sample Matrix: AIR

Sample Medium : TEDLAR BAG

	Units	Results	Date Analyzed	Analyst	RL	SPEC Limit		P/ F
						Lo	Hi	
Benzene	ug/m3	ND	03/31/05	WSD	1.6			
Bromomethane	ug/m3	ND	03/31/05	WSD	1.9			
Carbon Tetrachloride	ug/m3	ND	03/31/05	WSD	3.1			
Chlorobenzene	ug/m3	ND	03/31/05	WSD	2.3			
Chloroethane	ug/m3	ND	03/31/05	WSD	1.3			
Chloroform	ug/m3	ND	03/31/05	WSD	2.4			
Chloromethane	ug/m3	ND	03/31/05	WSD	1.0			
1,2-Dibromoethane	ug/m3	ND	03/31/05	WSD	3.8			
1,2-Dichlorobenzene	ug/m3	ND	03/31/05	WSD	3.0			
1,3-Dichlorobenzene	ug/m3	ND	03/31/05	WSD	3.0			
1,4-Dichlorobenzene	ug/m3	ND	03/31/05	WSD	3.0			
Dichlorodifluoromethane	ug/m3	ND	03/31/05	WSD	2.5			
1,1-Dichloroethane	ug/m3	ND	03/31/05	WSD	2.0			
1,2-Dichloroethane	ug/m3	ND	03/31/05	WSD	2.0			
1,1-Dichloroethylene	ug/m3	ND	03/31/05	WSD	2.0			
cis-1,2-Dichloroethylene	ug/m3	ND	03/31/05	WSD	2.0			
1,2-Dichloropropane	ug/m3	ND	03/31/05	WSD	2.3			
cis-1,3-Dichloropropene	ug/m3	ND	03/31/05	WSD	2.3			
trans-1,3-Dichloropropene	ug/m3	ND	03/31/05	WSD	2.3			
1,2-Dichlorotetrafluoroethane (114)	ug/m3	ND	03/31/05	WSD	3.5			
Ethylbenzene	ug/m3	ND	03/31/05	WSD	2.2			
Hexachlorobutadiene	ug/m3	ND	03/31/05	WSD	5.3			
Methylene Chloride	ug/m3	ND	03/31/05	WSD	1.7			
Styrene	ug/m3	ND	03/31/05	WSD	2.1			
1,1,2,2-Tetrachloroethane	ug/m3	ND	03/31/05	WSD	3.4			
Tetrachloroethylene	ug/m3	ND	03/31/05	WSD	3.4			
Toluene	ug/m3	11.7	03/31/05	WSD	1.9			
1,2,4-Trichlorobenzene	ug/m3	ND	03/31/05	WSD	3.7			
1,1,1-Trichloroethane	ug/m3	ND	03/31/05	WSD	2.7			
1,1,2-Trichloroethane	ug/m3	ND	03/31/05	WSD	2.7			

RL = Reporting Limit

SPEC LIMIT = a client specified recommended or regulatory level for comparison with data to determine PASS (P) or FAIL (F) condition of results.

ND = Not Detected

NM = Not Measured

* = See end of report for comments and notes applying to this sample

DONNA PALLISTER
 LEVINE FRICKE
 250 CENTERVILLE RD., BLDG. E, SUITE 12
 WARWICK, RI 02886

Purchase Order No.: 5131

4/1/2005
 Page 6 of 9

Project Location: SPRINGFIELD ST. SCHOOL, PROVIDENCE, RI.
 Date Received: 3/30/2005

LIMS-BAT #: LIMS-87125
 Job Number: 081-12152-01

Field Sample #: MPL-2

Sample ID : 05B10961

Sampled : 3/29/2005
 NOT SPECIFIED

Sample Matrix: AIR

Sample Medium : TEDLAR BAG

	Units	Results	Date Analyzed	Analyst	RL	SPEC Limit Lo Hi	P/ F
Trichloroethylene	ug/m3	ND	03/31/05	WSD	2.7		
Trichlorofluoromethane	ug/m3	ND	03/31/05	WSD	2.8		
1,1,2-Trichloro-1,2,2-Trifluoroethane	ug/m3	ND	03/31/05	WSD	3.8		
1,2,4-Trimethylbenzene	ug/m3	5.9	03/31/05	WSD	2.5		
1,3,5-Trimethylbenzene	ug/m3	4.0	03/31/05	WSD	2.5		
Vinyl Chloride	ug/m3	ND	03/31/05	WSD	1.3		
m/p-Xylene	ug/m3	3.8	03/31/05	WSD	2.2		
o-Xylene	ug/m3	3.9	03/31/05	WSD	2.2		

Analytical Method:

EPA TO-14A

SAMPLES ARE TAKEN IN SUMMA CANISTERS AND ANALYZED BY GAS CHROMATOGRAPHY WITH MASS SPECTROMETRY DETECTION. (GC/MS)

RL = Reporting Limit

ND = Not Detected

NM = Not Measured

* = See end of report for comments and notes applying to this sample

SPEC LIMIT = a client specified recommended or regulatory level for comparison with data to determine PASS (P) or FAIL (F) condition of results.

DONNA PALLISTER
 LEVINE FRICKE
 250 CENTERVILLE RD., BLDG. E, SUITE 12
 WARWICK, RI 02886

Purchase Order No.: 5131

4/1/2005
 Page 7 of 9

Project Location: SPRINGFIELD ST. SCHOOL, PROVIDENCE, RI.

LIMS-BAT #: LIMS-87125

Date Received: 3/30/2005

Job Number: 081-12152-01

Field Sample #: WB-2

Sample ID : 05B10960

Sampled : 3/29/2005
 NOT SPECIFIED

Sample Matrix: AIR

Sample Medium : TEDLAR BAG

	Units	Results	Date Analyzed	Analyst	RL	SPEC Limit		P/ F
						Lo	Hi	
Benzene	ug/m3	ND	03/31/05	WSD	1.6			
Bromomethane	ug/m3	ND	03/31/05	WSD	1.9			
Carbon Tetrachloride	ug/m3	ND	03/31/05	WSD	3.1			
Chlorobenzene	ug/m3	ND	03/31/05	WSD	2.3			
Chloroethane	ug/m3	ND	03/31/05	WSD	1.3			
Chloroform	ug/m3	ND	03/31/05	WSD	2.4			
Chloromethane	ug/m3	ND	03/31/05	WSD	1.0			
1,2-Dibromoethane	ug/m3	ND	03/31/05	WSD	3.8			
1,2-Dichlorobenzene	ug/m3	ND	03/31/05	WSD	3.0			
1,3-Dichlorobenzene	ug/m3	ND	03/31/05	WSD	3.0			
1,4-Dichlorobenzene	ug/m3	ND	03/31/05	WSD	3.0			
Dichlorodifluoromethane	ug/m3	ND	03/31/05	WSD	2.5			
1,1-Dichloroethane	ug/m3	ND	03/31/05	WSD	2.0			
1,2-Dichloroethane	ug/m3	ND	03/31/05	WSD	2.0			
1,1-Dichloroethylene	ug/m3	ND	03/31/05	WSD	2.0			
cis-1,2-Dichloroethylene	ug/m3	ND	03/31/05	WSD	2.0			
1,2-Dichloropropane	ug/m3	ND	03/31/05	WSD	2.3			
cis-1,3-Dichloropropene	ug/m3	ND	03/31/05	WSD	2.3			
trans-1,3-Dichloropropene	ug/m3	ND	03/31/05	WSD	2.3			
1,2-Dichlorotetrafluoroethane (114)	ug/m3	ND	03/31/05	WSD	3.5			
Ethylbenzene	ug/m3	3.1	03/31/05	WSD	2.2			
Hexachlorobutadiene	ug/m3	ND	03/31/05	WSD	5.3			
Methylene Chloride	ug/m3	ND	03/31/05	WSD	1.7			
Styrene	ug/m3	ND	03/31/05	WSD	2.1			
1,1,2,2-Tetrachloroethane	ug/m3	ND	03/31/05	WSD	3.4			
Tetrachloroethylene	ug/m3	ND	03/31/05	WSD	3.4			
Toluene	ug/m3	11.9	03/31/05	WSD	1.9			
1,2,4-Trichlorobenzene	ug/m3	ND	03/31/05	WSD	3.7			
1,1,1-Trichloroethane	ug/m3	ND	03/31/05	WSD	2.7			
1,1,2-Trichloroethane	ug/m3	ND	03/31/05	WSD	2.7			

RL = Reporting Limit

SPEC LIMIT = a client specified recommended or regulatory level for comparison with data to determine PASS (P) or FAIL (F) condition of results.

ND = Not Detected

NM = Not Measured

* = See end of report for comments and notes applying to this sample

DONNA PALLISTER
 LEVINE FRICKE
 250 CENTERVILLE RD., BLDG. E, SUITE 12
 WARWICK, RI 02886

Purchase Order No.: 5131

4/1/2005
 Page 8 of 9

Project Location: SPRINGFIELD ST. SCHOOL, PROVIDENCE, RI.

LIMS-BAT #: LIMS-87125

Date Received: 3/30/2005

Job Number: 081-12152-01

Field Sample #: WB-2

Sample ID: 05B10960

Sampled: 3/29/2005

NOT SPECIFIED

Sample Matrix: AIR

Sample Medium: TEDLAR BAG

	Units	Results	Date Analyzed	Analyst	RL	SPEC Limit		P/ F
						Lo	Hi	
Trichloroethylene	ug/m3	ND	03/31/05	WSD	2.7			
Trichlorofluoromethane	ug/m3	ND	03/31/05	WSD	2.8			
1,1,2-Trichloro-1,2,2-Trifluoroethane	ug/m3	ND	03/31/05	WSD	3.8			
1,2,4-Trimethylbenzene	ug/m3	4.8	03/31/05	WSD	2.5			
1,3,5-Trimethylbenzene	ug/m3	3.5	03/31/05	WSD	2.5			
Vinyl Chloride	ug/m3	ND	03/31/05	WSD	1.3			
m/p-Xylene	ug/m3	ND	03/31/05	WSD	2.2			
o-Xylene	ug/m3	3.6	03/31/05	WSD	2.2			

Analytical Method:

EPA TO-14A

SAMPLES ARE TAKEN IN SUMMA CANISTERS AND ANALYZED BY GAS CHROMATOGRAPHY WITH MASS SPECTROMETRY DETECTION. (GC/MS)

RL = Reporting Limit

ND = Not Detected

NM = Not Measured

SPEC LIMIT = a client specified recommended or regulatory level for comparison with data to determine PASS (P) or FAIL (F) condition of results.

* = See end of report for comments and notes applying to this sample



39 Spruce Street ° East Longmeadow, MA 01028 ° FAX 413/525-6405 ° TEL. 413/525-2332

DONNA PALLISTER

LEVINE FRICKE

250 CENTERVILLE RD., BLDG. E, SUITE 12

WARWICK, RI 02886

Purchase Order No.: 5131

4/1/2005

Page 9 of 9

Project Location: SPRINGFIELD ST. SCHOOL, PROVIDENCE, RI.

LIMS-BAT #: LIMS-87125

Date Received: 3/30/2005

Job Number: 081-12152-01

** END OF REPORT **

RL = Reporting Limit

ND = Not Detected

NM = Not Measured

SPEC LIMIT = a client specified recommended or regulatory level for comparison with data to determine PASS (P) or FAIL (F) condition of results.

* = See end of report for comments and notes applying to this sample



39 Spruce Street ° East Longmeadow, MA 01028 ° FAX 413/525-6405 ° TEL. 413/525-2332

QC SUMMARY REPORT

SAMPLE QC: Sample Results with Duplicates

BATCH QC: Lab fortified Blanks and Duplicates

Sample Matrix Spikes and Matrix Spike Duplicates

Standard Reference Materials and Duplicates

Method Blanks

Report Date: 4/1/2005

Lims Bat #: LIMS-87125

Page 1 of 2

QC Batch Number: BATCH-8341

Sample Id	Analysis	QC Analysis	Values	Units	Limits
05B10960	4-Bromofluorobenzene	Surrogate Recovery	94.1	%	70-130
05B10961	4-Bromofluorobenzene	Surrogate Recovery	97.2	%	70-130
BLANK-71669	Benzene	Blank	<1.6	ug/m3	
	Carbon Tetrachloride	Blank	<3.1	ug/m3	
	Chloroform	Blank	<2.4	ug/m3	
	1,2-Dichloroethane	Blank	<2.0	ug/m3	
	1,4-Dichlorobenzene	Blank	<3.0	ug/m3	
	Ethylbenzene	Blank	<2.2	ug/m3	
	Styrene	Blank	<2.1	ug/m3	
	Tetrachloroethylene	Blank	<3.4	ug/m3	
	Toluene	Blank	<1.9	ug/m3	
	1,1,1-Trichloroethane	Blank	<2.7	ug/m3	
	Trichloroethylene	Blank	<2.7	ug/m3	
	1,1,2-Trichloro-1,2,2-Trifluoroethane	Blank	<3.8	ug/m3	
	Trichlorofluoromethane	Blank	<2.8	ug/m3	
	o-Xylene	Blank	<2.2	ug/m3	
	m/p-Xylene	Blank	<2.2	ug/m3	
	1,2-Dichlorobenzene	Blank	<3.0	ug/m3	
	1,3-Dichlorobenzene	Blank	<3.0	ug/m3	
	1,1-Dichloroethane	Blank	<2.0	ug/m3	
	1,1-Dichloroethylene	Blank	<2.0	ug/m3	
	Vinyl Chloride	Blank	<1.3	ug/m3	
	Methylene Chloride	Blank	<1.7	ug/m3	
	Chlorobenzene	Blank	<2.3	ug/m3	
	Chloromethane	Blank	<1.0	ug/m3	
	Bromomethane	Blank	<1.9	ug/m3	
	Chloroethane	Blank	<1.3	ug/m3	
	cis-1,3-Dichloropropene	Blank	<2.3	ug/m3	
	trans-1,3-Dichloropropene	Blank	<2.3	ug/m3	
	1,1,2-Trichloroethane	Blank	<2.7	ug/m3	
	1,1,2,2-Tetrachloroethane	Blank	<3.4	ug/m3	
	Hexachlorobutadiene	Blank	<5.3	ug/m3	
	1,2,4-Trichlorobenzene	Blank	<3.7	ug/m3	
	1,2,4-Trimethylbenzene	Blank	<2.5	ug/m3	
	1,3,5-Trimethylbenzene	Blank	<2.5	ug/m3	
	cis-1,2-Dichloroethylene	Blank	<2.0	ug/m3	
	1,2-Dichloropropane	Blank	<2.3	ug/m3	
	Dichlorodifluoromethane	Blank	<2.5	ug/m3	
	1,2-Dibromoethane	Blank	<3.8	ug/m3	
	1,2-Dichlorotetrafluoroethane (114)	Blank	<3.5	ug/m3	



39 Spruce Street ° East Longmeadow, MA 01028 ° FAX 413/525-6405 ° TEL. 413/525-2332

QC SUMMARY REPORT

SAMPLE QC: Sample Results with Duplicates
Sample Matrix Spikes and Matrix Spike Duplicates

BATCH QC: Lab fortified Blanks and Duplicates
Standard Reference Materials and Duplicates
Method Blanks

Report Date: 4/1/2005

Lims Bat #: LIMS-87125

Page 2 of 2

QUALITY CONTROL DEFINITIONS AND ABBREVIATIONS

QC BATCH NUMBER This is the number assigned to all samples analyzed together that would be subject to comparison with a particular set of Quality Control Data.

LIMITS Upper and Lower Control Limits for the QC ANALYSIS Reported. All values normally would fall within these statistically determined limits, unless there is an unusual circumstance that would be documented in a NOTE appearing on the last page of the QC SUMMARY REPORT. Not all QC results will have Limits defined.

Sample Amount Amount of analyte found in a sample.

Blank Method Blank that has been taken though all the steps of the analysis.

LFBLANK Laboratory Fortified Blank (a control sample)

STDADD Standard Added (a laboratory control sample)

Matrix Spk Amt Added Amount of analyte spiked into a sample
MS Amt Measured Amount of analyte found including amount that was spiked
Matrix Spike % Rec. % Recovery of spiked amount in sample.

Duplicate Value The result from the Duplicate analysis of the sample.
Duplicate RPD The Relative Percent Difference between two Duplicate Analyses.

Surrogate Recovery The % Recovery for non-environmental compounds (surrogates) spiked into samples to determine the performance of the analytical methods.

Sur. Recovery (ELCD) Surrogate Recovery on the Electrolytic Conductivity Detector.
Sur. Recovery (PID) Surrogate Recovery on the Photoionization Detector.

Standard Measured Amount measured for a laboratory control sample
Standard Amt Added Known value for a laboratory control sample
Standard % Recovery % recovered for a laboratory control sample with a known value.

Lab Fort Blank Amt Laboratory Fortified Blank Amount Added
Lab Fort Blk. Found Laboratory Fortified Blank Amount Found
Lab Fort Blk % Rec Laboratory Fortified Blank % Recovered
Dup Lab Fort Bl Amt Duplicate Laboratory Fortified Blank Amount Added
Dup Lab Fort Bl Fnd Duplicate Laboratory Fortified Blank Amount Found
Dup Lab Fort Bl % Rec Duplicate Laboratory Fortified Blank % Recovery
Lab Fort Blank Range Laboratory Fortified Blank Range (Absolute value of difference between recoveries for Lab Fortified Blank and Lab Fortified Blank Duplicate).

Lab Fort Bl. Av. Rec. Laboratory Fortified Blank Average Recovery

Duplicate Sample Amt Sample Value for Duplicate used with Matrix Spike Duplicate
MSD Amount Added Matrix Spike Duplicate Amount Added (Spiked)
MSD Amt Measured Matrix Spike Duplicate Amount Measured
MSD % Recovery Matrix Spike Duplicate % Recovery
MSD Range Absolute difference between Matrix Spike and Matrix Spike Duplicate Recoveries

Attachment 5

**Photographs of Areas of Soil Erosion
Before and After Repairs**



1

Erosion on east side of transformer behind middle school

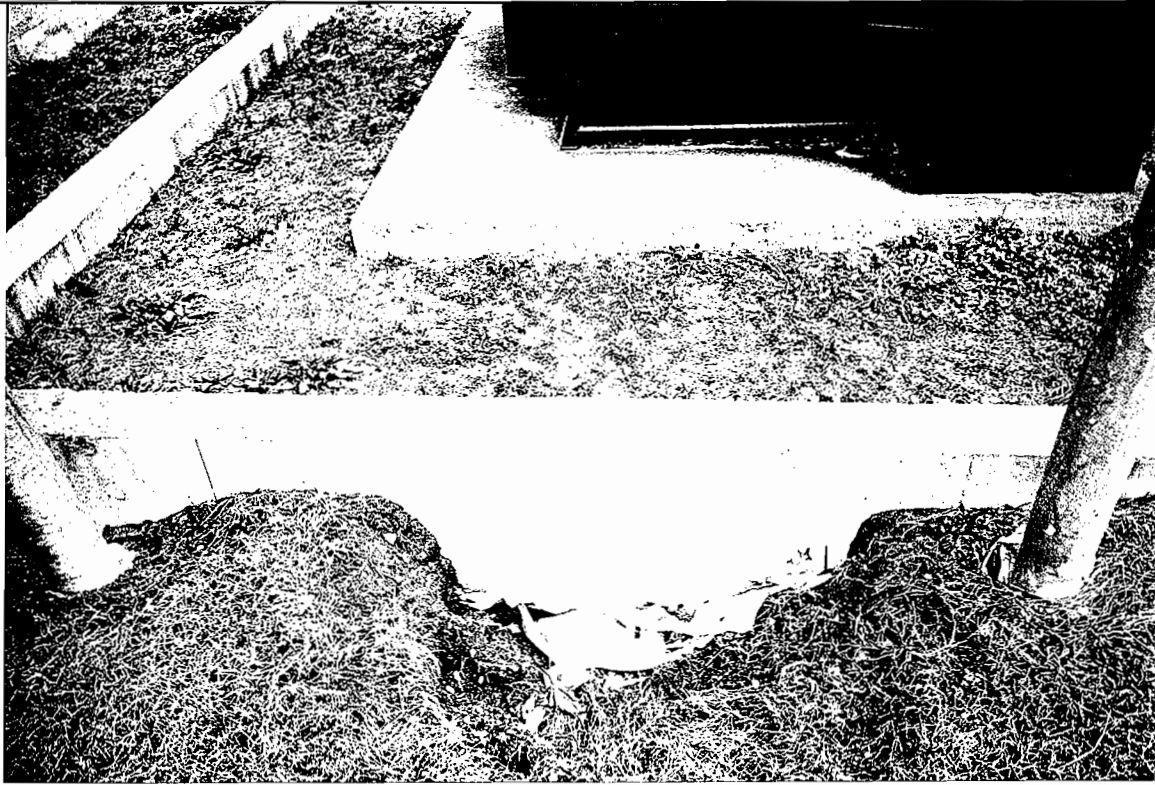

2

Erosion on west side of transformer behind middle school.

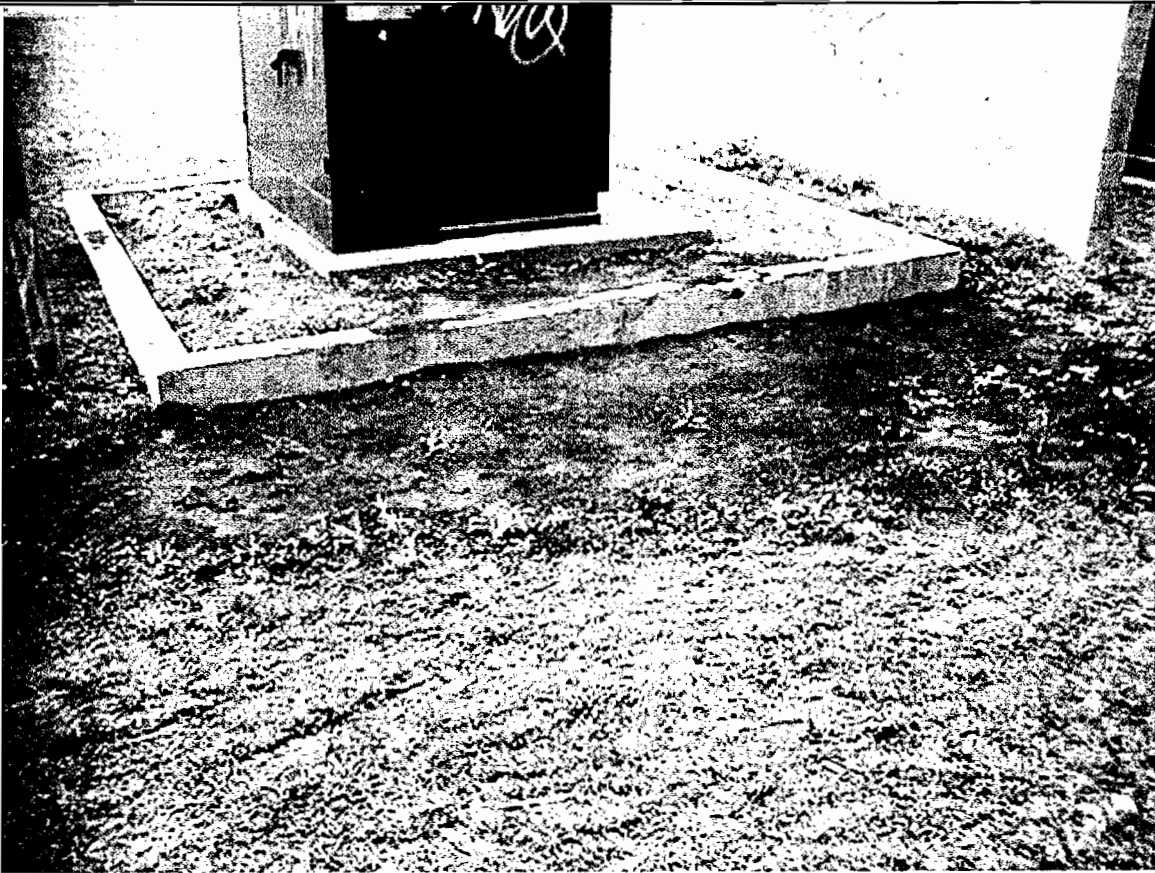

3

East side of transformer after repair of erosion.



4

West side of transformer behind middle school after repairs.



5

Sinkholes in corner near transformer after repair.