

August 10, 2011  
File No. 05.0043654.00-C

Mr. Thomas Medeiros, P.E.  
Coastal Resources Management Council  
4808 Tower Hill Road, Suite 3  
Wakefield, Rhode Island 02879



530 Broadway  
Providence  
Rhode Island  
02909  
401-421-4140  
Fax: 401-751-8613  
<http://www.gza.com>

Re: CRMC Assent Modification Request  
Former Tidewater Manufactured Gas Plant  
Assessor's Plat No. 65B, Lots 647 and 648  
Pawtucket, Rhode Island  
CRMC Assent No. F2009-12-034

Dear Mr. Medeiros:

On behalf of our client, the Narragansett Electric Company d/b/a National Grid (National Grid), this Assent Modification Request is being submitted by GZA GeoEnvironmental Inc. (GZA) pursuant to the requirements of the Coastal Resources Management Council (CRMC). The original Assent, No. F2009-12-034, was issued to National Grid on December 11, 2009 and granted permission for the completion of subsurface explorations, including the performance of test borings, test pits, surficial soil sampling, and the installation of additional groundwater monitoring wells, at the above referenced parcels. This work was completed between May and July 2010. A Modification Request was issued on October 19, 2010 to National Grid and granted permission for the completion of additional subsurface explorations similar to the original Assent granted.

The current Modification Request seeks to expand the project scope to perform additional subsurface investigation activities to fill certain data gaps identified following completion of recent Site investigation activities at the Site. The proposed work will be completed on A.P. 65B Lots 647 and 648, owned by National Grid and the City of Pawtucket, respectively.

Similar to the original Assent F2009-12-034, the proposed work will consist of test borings. No test pits or monitoring wells will be completed or installed. A Site Locus is provided as Figure 1. The approximate locations of the additional explorations are shown on the attached Figure 2. The 200-foot contiguous area associated with the shoreline extends onto a portion of the project site, as shown on Figure 2. As indicated on Figure 2, three (3) soil borings are proposed within the 200-foot contiguous area. The haybales and silt fence installed as part of the May-July 2010 investigation work will be maintained downgradient of the proposed work areas to serve as erosion controls for these additional soil boring activities. These erosion controls will be inspected prior to the start of field work and replaced on an as-needed basis.

Consistent with the work performed under the original Assent, the test borings will be performed utilizing a Geoprobe® rig. Soil boring depths are anticipated to be approximately 25 to 30 feet below ground surface. The drilling tools will be steam-cleaned between each soil boring location, depending on the level of impacts noted at the exploration. A GZA geologist or engineer will be present during drilling to classify soil conditions and prepare boring logs.

Soil cuttings and wash water (i.e., decontamination water) generated during drilling will be field-screened for total volatile organic compounds (VOCs) with a photoionization detector (PID). Soil cuttings and wash water will then be placed in 55-gallon drums for subsequent off-site disposal at an appropriate facility.



Based on the proposed modification, we believe that the work remains consistent with those activities authorized under Assent F2009-12-034, and ask that an Assent Modification be granted. Four copies of the following information are provided for your review:

1. Completed application form;
2. A copy of the CRMC Assent; and,
3. A copy of the proposed modified plans and/or specifications.

Enclosed please find our check in the amount of \$150 to cover the filing fee (EPC of approximately \$4,000 within 200-foot jurisdictional limit).

Should you have any questions or require additional information, please do not hesitate to contact Meg Kilpatrick at (401) 421-4140. Thank you for your attention to this matter.

Very truly yours,

GZA GEOENVIRONMENTAL, INC.

A handwritten signature in blue ink, appearing to read 'Margaret S. Kilpatrick'.

Margaret S. Kilpatrick, P.E.  
Senior Project Manager

A handwritten signature in blue ink, appearing to read 'Igor Runge'.

Igor Runge, Ph.D, P.H.  
Project Consultant/Reviewer

A handwritten signature in blue ink, appearing to read 'James J. Clark'.

James J. Clark, P.E.  
Principal

MSK/JJC:tja

Attachments: Assent F2009-12-034  
CRMC Assent Modification Request Form  
Figures 1 and 2  
Abutters List  
Copy of Check #223817

cc: Michele Leone, National Grid

**ASSENT F2009-12-034**



STATE OF RHODE ISLAND AND PROVIDENCE PLANTATIONS

COASTAL RESOURCES MANAGEMENT COUNCIL

Oliver H. Stedman Government Center  
4808 Tower Hill Road, Suite 3  
Wakefield, R.I. 02879-1900

(401) 783-3370  
FAX: (401) 783-3767

**FINDING OF NO SIGNIFICANT IMPACT**

December 11, 2009

Narragansett Electric Co. d/b/a National Grid  
Att: Amy McKinnon  
40 Sylvan Road, E3716  
Waltham, MA 02451

RE: CRMC Assent No. F2009-12-034  
Site: Taft Street, Pawtucket  
Plat: 54|65B Lot: 826|645,647,648,649

Project Description: Perform test borings, test pits, surficial soil sampling and to install groundwater monitoring wells, at the former Tidewater Facility as show on the plans submitted to CRMC on December 11, 2009.

The Coastal Resources Management Council has reviewed your project proposal and has determined the findings of no significant impact on coastal resources. This project must be completed within three (3) years of the date of this notification. If this project involves excess excavated materials, excess soils, excess construction materials, and debris (including any destructed materials) these materials shall be removed from the site and disposed of at an inland landfill or a suitable and legal upland location. **If the project involves earthwork, appropriate erosion controls shall be utilized.** All applicable policies, prohibitions, and standards of the RICRMP shall be upheld.

**CAUTION:** The limits of authorized work shall be only for that which was approved by the CRMC. Any activities or alterations which deviate from the approved plans will require a separate application and review. If the information provided to the CRMC for this review is inaccurate or did not reveal all necessary information or data, then this permit may be found to be null and void. Plans for any future alteration of the shoreline or construction or alteration within the 200' zone of CRMC jurisdiction or in coastal waters must be submitted for review to the CRMC prior to commencing such activity. Under no circumstances will this permit authorize any work which is considered prohibited under any of the sections of the Rhode Island Coastal Resources Management Program.

Permits, licenses or easements issued by the Council are valid only with the conditions and stipulation under which they are granted and imply no guarantee of renewal. The initial application or an application for renewal may be subject to denial or modification. If an application is granted, said permit, license and easement may be subject to revocation and/or modification for failure to comply with the conditions and stipulations under which the same was issued or for other good cause.

Applicant agrees that as a condition to the granting of this assent, members of the Coastal Resources Management Council or its staff shall have access to applicant's property to make on-site inspections to insure compliance with the assent.

A copy of this authorization to perform construction related activities shall be kept on site and available for inspection. **NOTE:** Failure to have this letter on site or work in excess of your proposal constitutes a violation under this program.

Sincerely,

Thomas A. Medeiros  
CRMC Engineer

Coastal Resources Management Council

/rcm

**State of Rhode Island and Providence Plantations**  
**COASTAL RESOURCES MANAGEMENT COUNCIL**

NOTICE OF

**ASSENT**

CRMC Assent No.: A2009-12-034

Date: December 11, 2009

This certifies that Narragansett Electric Co. d/b/a National Grid  
has permission to Perform test borings, test pits, surficial soil sampling and to install groundwater monitoring wells, at the former Tidewater  
Facility as show on the plans submitted to CRMC on December 11, 2009.

situated at Taft Street  
Plat No. 54|65B

Lot No. 826|645,647,648,649

Said construction operations to be done in accordance with an approved assent on file in the Offices of the Coastal Resources Management Council and subject further to all the provisions of the building ordinances of the :

City/Town of \_\_\_\_\_

Pawtucket

and to all the applicable State, Local and Federal provisions. This assent shall expire three (3) years from date of issuance.

\_\_\_\_\_  
Official Designee  
Coastal Resources Management Council

**THIS CARD MUST BE DISPLAYED IN A CONSPICUOUS PLACE ON THE PREMISES.  
FAILURE TO DISPLAY WILL RESULT IN LEGAL ACTION.**



STATE OF RHODE ISLAND AND PROVIDENCE PLANTATIONS

COASTAL RESOURCES MANAGEMENT COUNCIL

Oliver H. Stedman Government Center  
4808 Tower Hill Road, Suite 3  
Wakefield, R.I. 02879-1900

(401) 783-3370  
FAX: (401) 783-3767

**FINDING OF NO SIGNIFICANT IMPACT**

December 11, 2009

Narragansett Electric Co. d/b/a National Grid  
Att: Amy McKinnon  
40 Sylvan Road, E3716  
Waltham, MA 02451

RE: CRMC Assent No. F2009-12-034  
Site: Taft Street, Pawtucket  
Plat: 54|65B Lot: 826|645,647,648,649

Project Description: Perform test borings, test pits, surficial soil sampling and to install groundwater monitoring wells, at the former Tidewater Facility as show on the plans submitted to CRMC on December 11, 2009.

The Coastal Resources Management Council has reviewed your project proposal and has determined the findings of no significant impact on coastal resources. This project must be completed within three (3) years of the date of this notification. If this project involves excess excavated materials, excess soils, excess construction materials, and debris (including any destructed materials) these materials shall be removed from the site and disposed of at an inland landfill or a suitable and legal upland location. **If the project involves earthwork, appropriate erosion controls shall be utilized.** All applicable policies, prohibitions, and standards of the RICRMP shall be upheld.

**CAUTION:** The limits of authorized work shall be only for that which was approved by the CRMC. Any activities or alterations which deviate from the approved plans will require a separate application and review. If the information provided to the CRMC for this review is inaccurate or did not reveal all necessary information or data, then this permit may be found to be null and void. Plans for any future alteration of the shoreline or construction or alteration within the 200' zone of CRMC jurisdiction or in coastal waters must be submitted for review to the CRMC prior to commencing such activity. Under no circumstances will this permit authorize any work which is considered prohibited under any of the sections of the Rhode Island Coastal Resources Management Program.

Permits, licenses or easements issued by the Council are valid only with the conditions and stipulation under which they are granted and imply no guarantee of renewal. The initial application or an application for renewal may be subject to denial or modification. If an application is granted, said permit, license and easement may be subject to revocation and/or modification for failure to comply with the conditions and stipulations under which the same was issued or for other good cause.

Applicant agrees that as a condition to the granting of this assent, members of the Coastal Resources Management Council or its staff shall have access to applicant's property to make on-site inspections to insure compliance with the assent.

A copy of this authorization to perform construction related activities shall be kept on site and available for inspection. **NOTE:** Failure to have this letter on site or work in excess of your proposal constitutes a violation under this program.

Sincerely,

Thomas A. Medeiros  
CRMC Engineer

Coastal Resources Management Council

## **CRMC APPLICATION**

STATE OF RHODE ISLAND AND PROVIDENCE PLANTATIONS  
Coastal Resources Management Council  
Oliver Stedman Government Center  
4808 Tower Hill Road; Suite 116  
Wakefield, RI 02879  
(401)783-3370

**CRMC ASSENT MODIFICATION REQUEST FORM**

File Number of Assent/Permit: F2009-12-034 Expiration date (including extensions): 12/11/2012

Name which Assent was issued to: the Narragansett Electric Company d/b/a National Grid

Location of Project: Taft Street

City/Town Pawtucket Plat: 65B Lot: 647 and 648

Present Owner: City of Pawtucket

Mailing Address: 175 Main Street, 3rd Floor

State: Pawtucket, RI Zip Code: 02860

Phone No. Bus: \_\_\_\_\_ Home: \_\_\_\_\_ Contact Person: Mr. Ronald Leitao

Phone No.: 401-724-5200

*Norm Lamoureux  
728-0500 x 236*

Abutters: See attached list

I hereby certify that the names and addresses of adjacent property owners whose property adjoins the project site are accurate and current as of the date of application. If said names and addresses are found to be not accurate and/or current, any subsequent Assent may become Null and Void. Signed: \_\_\_\_\_

Describe the proposed modification(s), including the reasons for change: Modification:

Additional subsurface investigations consisting of soil borings

Reason: \_\_\_\_\_  
Address data gaps

What state of construction is project in? \_\_\_\_\_  
Ongoing

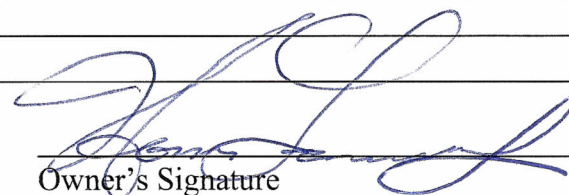
  
Owner's Signature

Note: The applicant acknowledges by evidence of their signature that they have reviewed the Rhode Island Coastal Resources Management Program, and have, where possible adhered to the policies and standards of the program. The applicant also acknowledges by evidence of their signature that to the best of their knowledge the information contained in the application is true and valid. The filing of false information can result in the Coastal Resources Management Council revoking State Assent. Applicant requires that as a condition to the granting of this assent, members of the CRMC or its staff shall be access to the applicant's property to make on-site inspections to insure compliance with the assent. This application is made under oath and subject to penalties of perjury. 5/00



## **FIGURES**

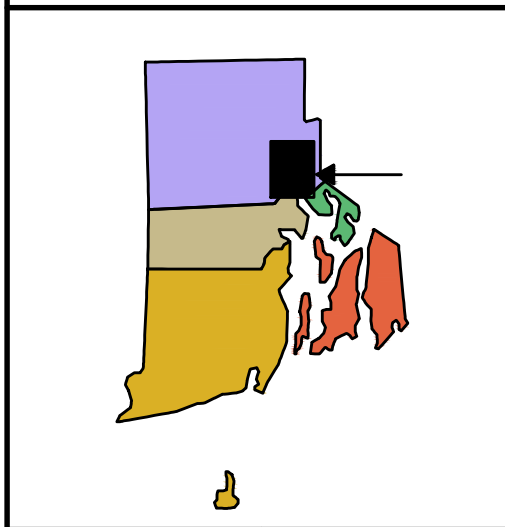
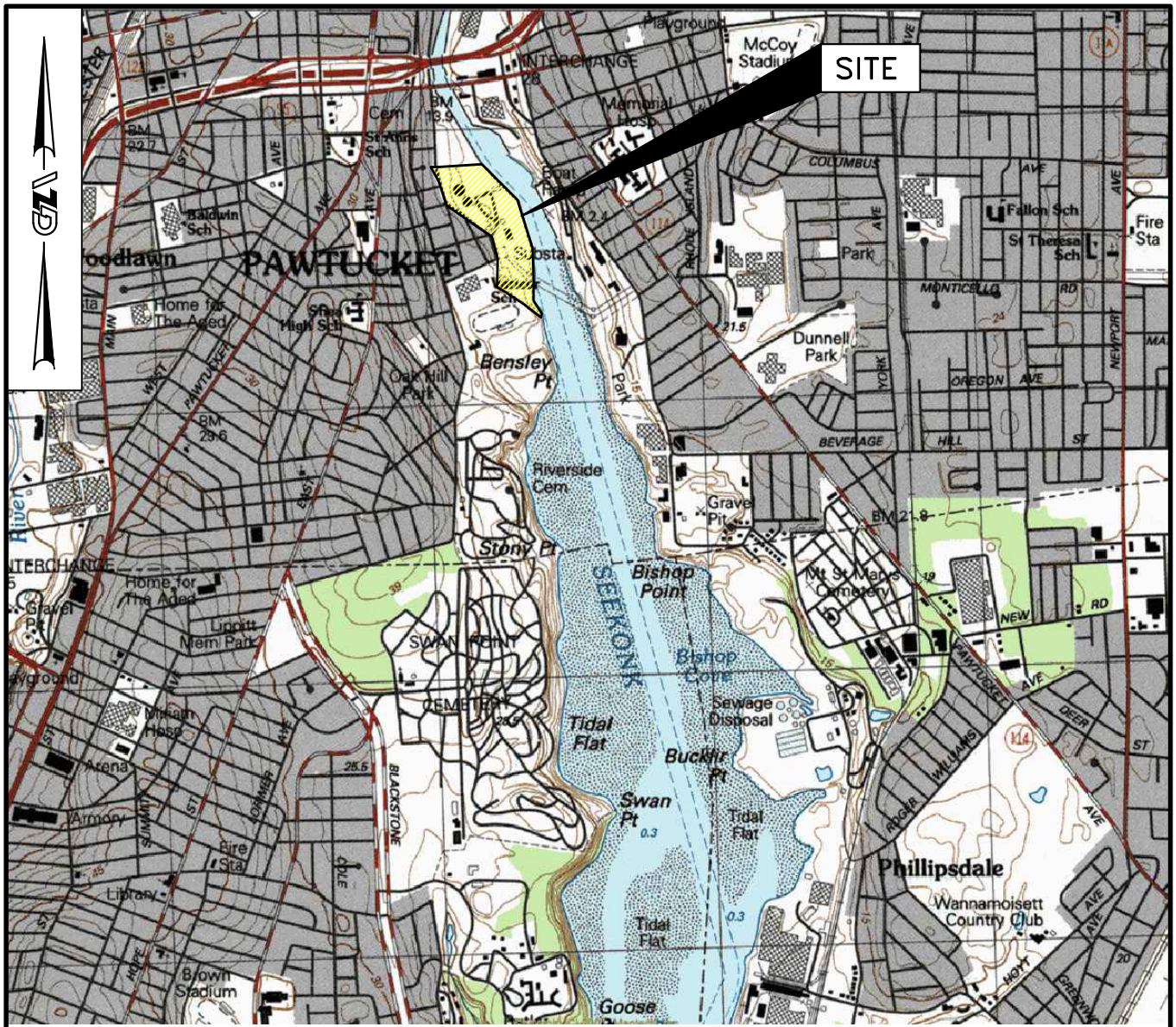

BASE MAP FROM THE FOLLOWING USGS QUADRANGLE MAP:  
PROVIDENCE, RI (2001)

DIGITAL TOPOGRAPHIC MAPS PROVIDED BY MAPTECH. INC.

CONTOUR ELEVATIONS REFERENCE NGVD 29,  
 CONTOURS ARE SHOWN IN METERS ABOVE NGVD AT 3 METER INTERVALS

APPROXIMATE SCALE IN FEET

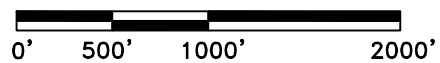

TIDEWATER FACILITY

PAWTUCKET, RHODE ISLAND

LOCUS PLAN

JULY 2011

FIGURE NO. 1

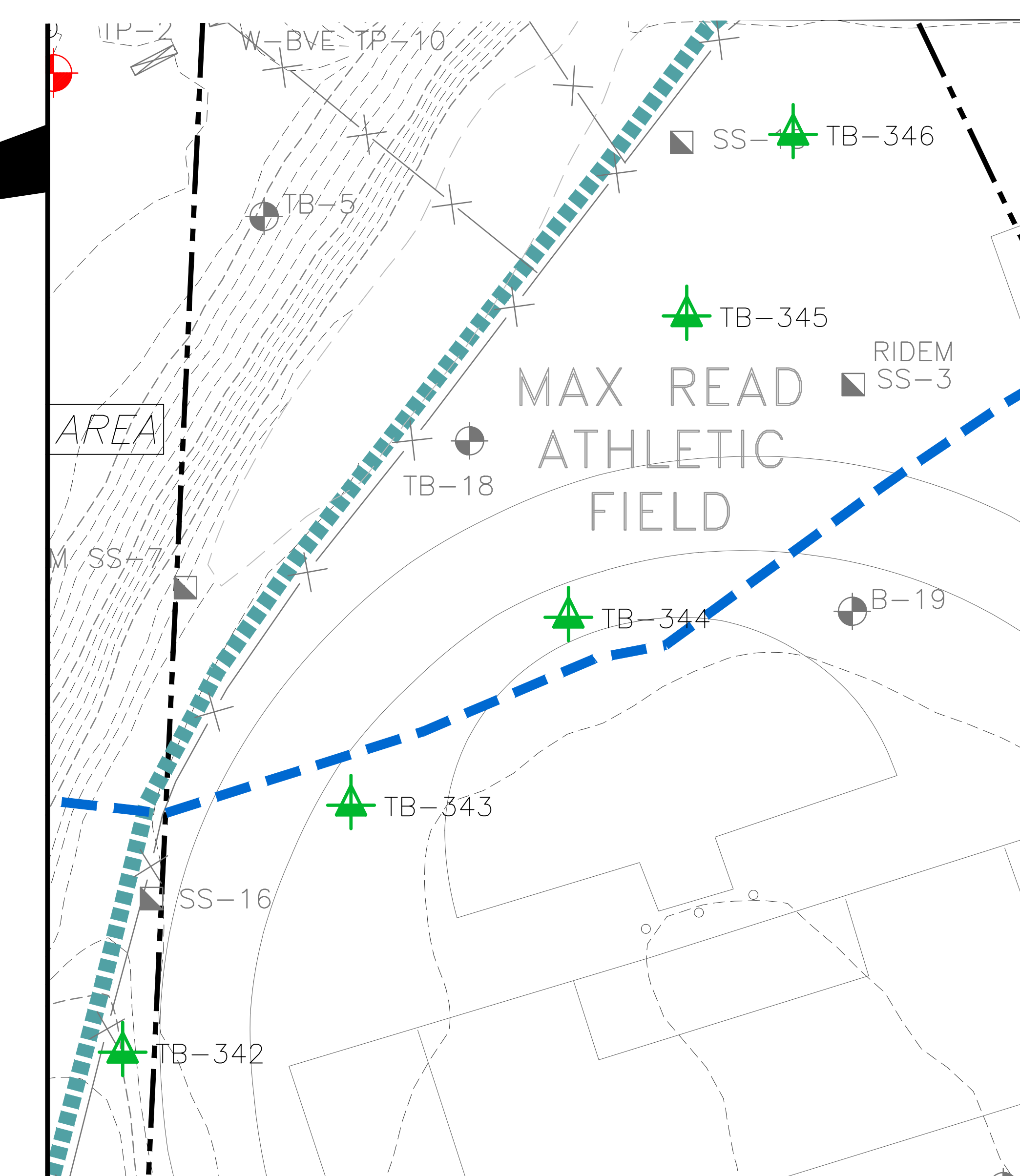
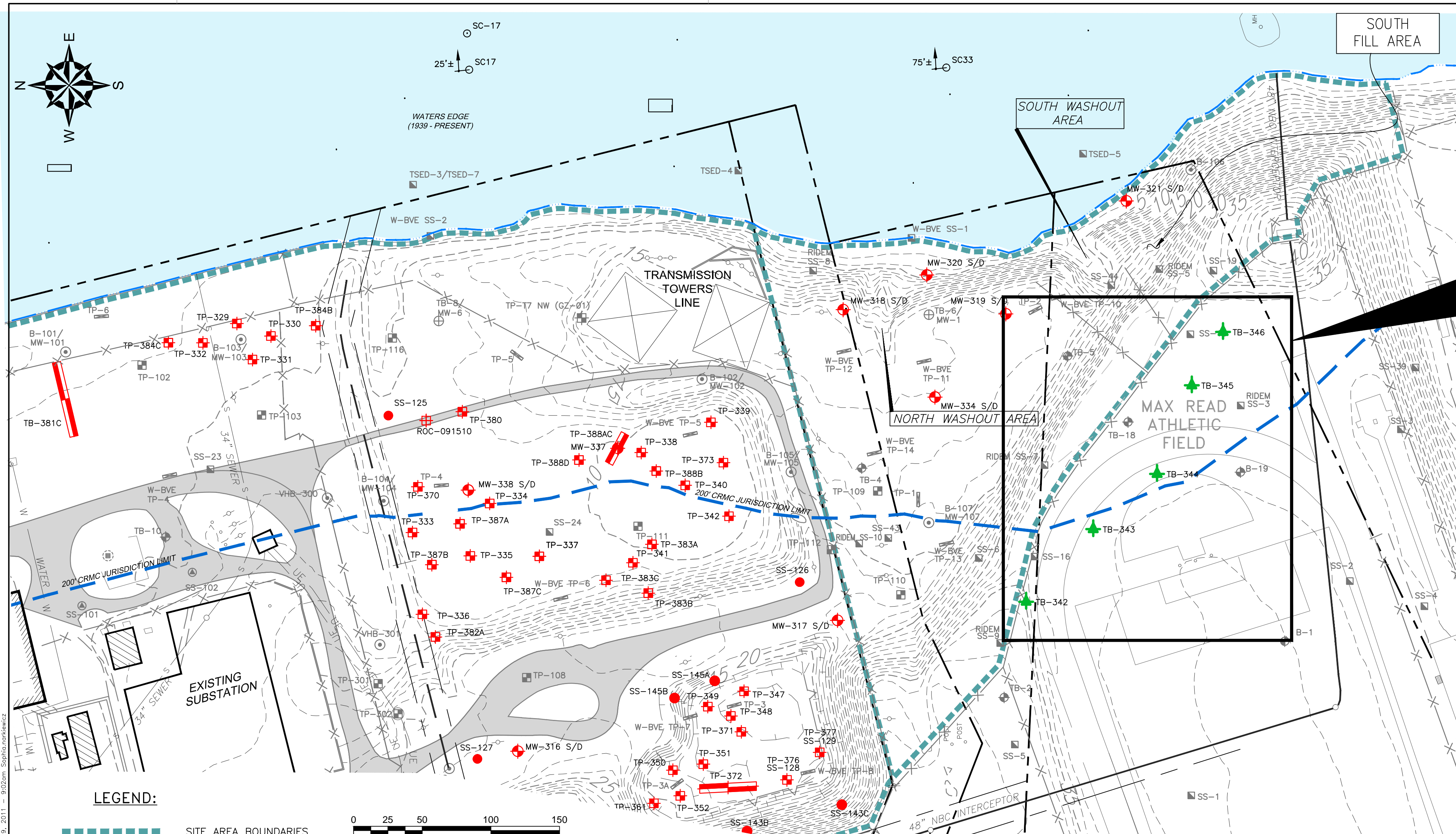

**LEGEND:**

	SITE AREA BOUNDARIES
	EXISTING BUILDINGS ON-SITE
	EXISTING FOUNDATION/PAD ON-SITE
	EXISTING BUILDINGS/STRUCTURES OFF-SITE
	EXISTING CONTOUR (MINOR 1 FOOT INTERVAL)
	EXISTING CONTOUR (MAJOR 5 FOOT INTERVAL)
	PROPERTY LINE
	APPROX. 200 FT. JURISDICTION LIMIT
	APPROX. WATERS EDGE
	EXISTING NBC INTERCEPTOR SANITARY SEWER
	EXISTING CITY OF PAWTUCKET STORM DRAIN
	EXISTING WATER LINE
	EXISTING STORM/COMBINED SAN. SEWER OVERFLOW
	EXISTING UNDERGROUND ELECTRIC CABLE IN CONDUIT
	EXISTING UNDERGROUND ELECTRIC MH/STRUCTURE
	EXISTING ACCESS ROAD
	EXISTING RETAINING WALLS
	EXISTING FENCE
	EXISTING CATCH BASIN LOCATIONS

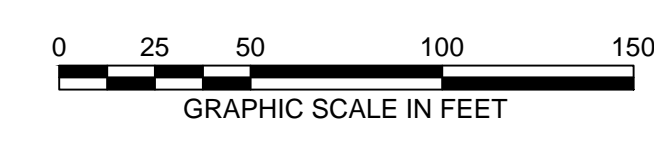

**SAMPLE LEGEND**

	SS-9 ATLANTIC SURFACE SOIL SAMPLE LOCATION
	TSED-6 ATLANTIC SEDIMENT SAMPLE LOCATION
	W-BVE SS-3 WESTON/BLACKSTONE VALLEY ELECTRIC SEDIMENT SAMPLE LOCATION
	RIDEM SS-3 RIDEM SURFACE SOIL SAMPLE LOCATION
	B-109/MW-109 MONITORING WELL/BORING (VHB) SURVEYED
	TP-3A ATLANTIC TEST PIT LOCATION
	W-BVE WESTON/BLACKSTONE VALLEY ELECTRIC TEST PIT LOCATION
	GZA TP-8 GZA/VALLEY GAS TEST PIT LOCATION
	TB-15 ATLANTIC SOIL BORING LOCATION
	MW-3 ATLANTIC MONITORING WELL LOCATION
	M&E MW-1 METCALF & EDDY MONITORING WELL LOCATION
	VHB-400 VHB SURFACE SOIL SAMPLE LOCATION NON-SURVEYED
	TP-204 VHB TEST PIT (2006)
	GZ-01 GZA TEST PIT (2009)
	TB-300 GZA TEST BORING LOCATION (2010)
	MW-320 S/D GZA MONITORING WELL LOCATION (2010)
	TP-306 GZA TEST PIT LOCATION (2010)
	SS-100 GZA SURFACE SOIL SAMPLE LOCATION (2010)
	SC31 ARCADIS SEDIMENT SAMPLE LOCATION (2008)
	PIPE-1-061610 GZA RESIDUAL MATERIAL SAMPLE (2010)
	TB-300 GZA PROPOSED TEST BORING LOCATION (2011)

- GENERAL NOTES:**
- EXISTING CONDITIONS BASE MAP DEVELOPED FROM THE FOLLOWING:
    - ELECTRONIC FILES FROM GEI CONSULTANTS, INC. (FORMERLY AES) ENTITLED "HISTORIC STRUCTURES AND SAMPLE LOCATIONS", ORIGINAL SCALE 1"=80", DATED JULY 1999
    - ELECTRONIC FILES FROM VANASSE HANGEN BRUSTLIN, INC. ENTITLED "SOIL BORING, TEST PIT AND MONITOR WELL LOCATIONS", SCALE: 1"=60", UNDATED
    - ELECTRONIC FILES FROM WELSH ASSOCIATES LAND SURVEYORS, INC. ENTITLED "TOPOGRAPHIC SURVEY (AS-BUILT), FORMER TIDEWATER FACILITY, DEMOLITION OF GAS HOLDERS NOS. 7 & 8", DATED DECEMBER 17, 2010
    - ON-SITE INVESTIGATIONS AND SURVEYS BY GZA PERSONNEL DURING VARIOUS SITE VISITS DURING 2009 AND 2010.
  - PROPERTY LINES AND LOT INFORMATION ESTABLISHED FROM INFORMATION PROVIDED ON A DRAWING ENTITLED "PERIMETER SURVEY OF LAND AT THE TIDEWATER FORMER MGP SITE IN PAWTUCKET, RHODE ISLAND FOR ATLANTIC ENVIRONMENTAL SERVICES INC." DEVELOPED BY LOUIS FEDERICI AND ASSOCIATES AND AN AUTO CAD FILE ENTITLED "MAX READ FIELD TRACK EXPANSION 2007" PROVIDED BY THE CITY OF PAWTUCKET.
  - HORIZONTAL DATUM IS BASED ON NAD 1983 FROM BASE MAPPING PROVIDED BY GEI CONSULTANTS, INC.
  - VERTICAL DATUM IS BASED ON NGVD 1929 (MSL) FROM BASE MAPPING PROVIDED BY GEI CONSULTANTS, INC.
  - REFERENCE SEWER DATA FROM SCANNED IMAGE PROVIDED BY THE CITY OF PAWTUCKET, RHODE ISLAND, ENTITLED "STUDY OF SEWERAGE FACILITIES" BY WATERMAN ENGINEERING CO. & ANDERSON NICHOLS CO. DATED NOV. 1975, ORIGINAL SCALE 1"=400' & SCANNED IMAGES OF HISTORIC PLAN & PROFILE DRAWINGS PROVIDED BY THE CITY OF PAWTUCKET, RHODE ISLAND.
  - SITE UTILITIES TAKEN FROM 1984 SANBORN MAP AND HISTORIC FIGURES PROVIDED BY NATIONAL GRID. ALL UTILITY LOCATIONS ARE APPROXIMATE AND SHOWN FOR REFERENCE ONLY.

THE INFORMATION SHOWN ON THE DRAWING IS SOLELY FOR USE BY NATIONAL GRID OR THE NATIONAL GRID'S DESIGNATED REPRESENTATIVE FOR THE SPECIFIC PROJECT AND LOCATION IDENTIFIED ON THE DRAWING. THE DRAWING SHALL NOT BE TRANSFERRED, REUSED, COPIED, OR ALTERED IN ANY MANNER FOR USE AT ANY OTHER LOCATION OR FOR ANY OTHER PURPOSE WITHOUT THE PRIOR WRITTEN CONSENT OF GZA AND NATIONAL GRID. ANY TRANSFER, REUSE, OR MODIFICATION TO THE DRAWING BY OTHERS, WITHOUT THE PRIOR WRITTEN EXPRESS CONSENT OF GZA AND NATIONAL GRID, WILL BE AT THE USER'S SOLE RISK AND WITHOUT ANY RISK OR LIABILITY TO GZA AND NATIONAL GRID.

<b>FORMER TIDEWATER FACILITY</b>			
<b>PAWTUCKET, RHODE ISLAND</b>			
<b>PROPOSED EXPLORATIONS LOCATION PLAN</b>			
PREPARED BY:	GZA GeoEnvironmental, Inc. Engineers and Scientists 530 BROADWAY PROVIDENCE, RHODE ISLAND 02909 (401) 421-4140		PREPARED FOR:
		<b>NATIONAL GRID</b>	
PROJ MGR:	MSK	REVIEWED BY:	MSK
DESIGNED BY:	SDN	DRAWN BY:	CRD
DATE:	JULY 2011	PROJECT NO.:	43654.00
		CHECKED BY:	MSK
		SCALE:	AS NOTED
		REVISION NO.:	0
			FIGURE
			<b>2</b>
			SHEET NO. 2 OF 2

## **ABUTTERS LIST**

Abutters List-Site Investigation  
Former Tidewater MGP Site  
Pawtucket, Rhode Island

<b>Plat</b>	<b>Lot</b>	<b>Owner(s)</b>	<b>Property Address</b>	<b>Mailing Address</b>
65B	646	N/F City of Pawtucket	486 Pleasant Street	137 Roosevelt Avenue Pawtucket, RI 02860
65B	649	N/F National Grid	Pleasant Street	c/o Properties Dept. 40 Sylvan Road Waltham, MA 02451
65B	594	N/F City of Pawtucket	486 Pleasant Street	137 Roosevelt Avenue Pawtucket, RI 02860
67B	11	N/F City of Pawtucket	Pleasant Street	137 Roosevelt Avenue Pawtucket, RI 02860

NF = Now or formerly of

Abutters' information (names and property addresses) obtained on July 11, 2011 from "Appraisal Vision Assessor's Online Database for Pawtucket, Rhode Island," last updated June 17, 2011.

**COPY OF CHECK NO. 223817**

GZA GEOENVIRONMENTAL, INC.

ONE EDGEWATER DR.  
NORWOOD, MA 02062



KeyBank National Association  
Salt Lake City, Utah 84115

1-800-KEY2YOU

31-300-1243

223817

August 2, 2011

CHECK DATE

One Hundred Fifty and 00/100 Dollars

PAY

CRMC

TO

AMOUNT 150.00

NOT VALID IN EXCESS OF \$10,000 UNLESS COUNTERSIGNED

*David Brew*

AUTHORIZED SIGNATURE - NOT VALID AFTER 90 DAYS

Details on back.



4365400

⑈ 223817⑈ ⑆ 124303007⑆ 440991900109⑈