



January 20, 2022  
File No. 05.00043654.60

Mr. Joseph Martella  
Rhode Island Department of Environmental Management  
Office of Land Revitalization and Sustainable Materials Management  
235 Promenade Street, 3<sup>rd</sup> Floor  
Providence, Rhode Island 02908

Re: Site Remediation File No. SR-26-0934A/Formerly RIDEM Case No. 95-022  
Former Tidewater Facility  
200 Taft Street  
Pawtucket, Rhode Island

Dear Mr. Martella:

As described in our memorandum dated December 3, 2021, coal tar impacted soil was encountered during regrading of the riverbank in the northern portion of the above referenced Site during construction of the revetment cap. The contractor performing the work had difficulties containing the released coal tar material within the immediate work area.

Given these observed coal tar impacts, as described in our January 11, 2022 letter, we requested approval from the United States Army Corps of Engineers (USACE) and the Coastal Resources Management Council (CRMC) to modify the revetment cap design in the northern portion of the Site between Stations 4+00 and 5+95 (approximately 195 feet along the shoreline) to minimize the disturbance of coal tar impacted soil and the risk of a potential breach in the controls (turbidity curtains and absorbent booms) installed within the Seekonk River. The modified revetment cap design involves the placement of stone, multiple layers of reactive core matting (RCM), woven and non-woven geotextiles, and riprap on top of the existing surface of impacted sediment, all below mean high water (MHW) and the high tide line (HTL) rather than disturbing this material during regrading. The slope of the revetment cap will also be adjusted below MHW and the revetment cap will extend several feet beyond what was originally anticipated. The existing riverbank above MHW will be regraded consistent with the original permitted design. The final result will be a decrease in the amount of dredged material and an increase in fill replacement compared to the original approved values. CRMC approved the revetment design modifications on January 14, 2022 and the USACE approved the revetment design modifications on January 19, 2022. Copies of these approvals are attached for reference.

The revetment design change primarily results in a reconfiguration of the layout of the revetment cap below MHW and does not substantively change the remedial strategy of capping the impacted Site materials to mitigate the potential migration of NAPL to the Seekonk River. Therefore, we do not anticipate the need for RIDEM to issue an amendment to the previously approved Remedial Action Work Plan. We plan to



Known for excellence.  
Built on trust.

GEOTECHNICAL  
ENVIRONMENTAL  
ECOLOGICAL  
WATER  
CONSTRUCTION  
MANAGEMENT

188 Valley Street  
Suite 300  
Providence, RI 02909  
T: 401.421.4140  
F: 401.751.8613  
www.gza.com



implement these revetment cap design modifications as necessary when coal tar impacted materials are observed in the approximately 195-foot long section of shoreline shown in the figures included in our January 11, 2022 letter.

Should you have any questions regarding the information herein, please do not hesitate to contact the undersigned or Kenneth Lento at (617) 791-2627.

Very truly yours,

GZA GEOENVIRONMENTAL, INC.

A handwritten signature in blue ink, appearing to read "David Rusczyk", written in a cursive style.

David J. Rusczyk, P.E.  
Associate Principal  
860-858-3110 – [david.rusczyk@gza.com](mailto:david.rusczyk@gza.com)  
860-250-8556 (cell)

A handwritten signature in blue ink, appearing to read "Igor Runge", written in a cursive style.

Igor Runge, Ph.D., P.H.  
Senior Consultant  
401-427-2710 - [igor.runge@gza.com](mailto:igor.runge@gza.com)

Attachments: CRMC Assent 2019-08-014 Modification Approval  
USACE Permit NAE-2019-02150 Modification Approval

Cc: Kenneth Lento (National Grid)

\\GZAPROVIDENCE\JOBS\ENV\43654.60\CORRESPONDENCE\REVTMENT DESIGN CHANGES\43654.60 - 2022-1-20 REVTMENT LETTER-RIDEM.DOCX



State of Rhode Island  
Coastal Resources Management Council  
Oliver H. Stedman Government Center  
4808 Tower Hill Road, Suite 3  
Wakefield, RI 02879-1900

(401) 783-3370  
Fax (401) 783-2069

### CRMC ASSENT MODIFICATION

January 14, 2022

The Narragansett Electric Company  
Attn: Elizabeth Greene  
40 Sylvan Road  
Waltham, MA 02451

**RE: CRMC File Number:** 2019-08-014 Modification of Assent, to include modifying revetment design in the Northern portion of the Site between Stations 4+00 and 5+95 (approximately 195 feet along the shoreline) to minimize the disturbance of coal tar impacted soil.

Dear Ms. Greene:

The Coastal Resources Management Council has reviewed your request for modification of CRMC Assent No. 2019-08-014 and approve the modification with the following additional stipulations:

#### **STIPULATIONS OF APPROVAL:**

1. The applicant shall record this modification in its entirety in the land evidence records of the City of Pawtucket within thirty (30) days of the date of assent issuance. Certification by the Town Clerk's office that this stipulation has been complied with shall be furnished to Coastal Resources Management Council by the applicant within fifteen (15) days thereafter. Failure to comply with provision will render this assent null and void.
2. The approved site plans shall be those titled "Former Tidewater Facility, Pawtucket, Rhode Island, Contract Document Phase 4 and 4, Alternative Revetment Layout Plan...", sheets 1 and 2 (Drawing S-62A and S-65A) dated January 2022, by GZA Inc.. Except as stipulated or modified herein, all details and specifications thereon shall be strictly adhered to. Any and all changes require written approval from this office.
3. U. S. Army Corps of Engineers permit is required.
4. All pertinent and required RIDEM permits shall be obtained prior to construction.
5. Except/unless as stipulated herein, all stipulations of the original assent for CRMC File No. 2019-08-014, originally dated March 24, 2020 shall remain in full force and effect.

The Narragansett Electric Co/ National Grid  
Modification of CRMC Assent 2019-08-014  
January 14, 2022  
Page Two

Unless modified by this document all work authorized by this CRMC Assent Modification Approval must be completed within the 3 year approval period established in the original CRMC Assent (as noted by page 1, paragraph 2 of the original assent). In cases where the approved work will not be completed within this time frame, an Assent Extension Request Form must be submitted 60 days prior to the expiration of the established time frame for work completion. **In addition, all stipulations of the original CRMC assent remain in full force and effect except as modified by the stipulations contained herein and/or by the plans approved by this assent modification approval.**

Sincerely,

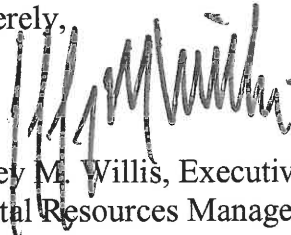

Jeffrey M. Willis, Executive Director  
Coastal Resources Management Council

GJF/lat



**DEPARTMENT OF THE ARMY**  
US ARMY CORPS OF ENGINEERS  
NEW ENGLAND DISTRICT  
696 VIRGINIA ROAD  
CONCORD MA 01742-2751

January 19, 2022

Regulatory Division  
File No. NAE-2019-02150

Elizabeth Greene  
Narragansett Electric Company  
40 Sylvan Road  
Waltham, Massachusetts 02451  
(via email: [elizabeth.greene@nationalgrid.com](mailto:elizabeth.greene@nationalgrid.com))

Dear Ms. Greene,

This is in response to a recent request dated January 11, 2022 to modify a project authorized by the Department of the Army permit number NAE-2019-02150. The authorization was for a remediation effort consisting of several elements including the dredging of approximately 18,400 square-feet (sf) of contaminated sediments from the Seekonk River, the installation of a remedial cap and the installation of an approximately 550 linear-foot long sheet pile wall, all seaward of mean high water (MHW). Additional permitted work consisted of the in-kind replacement of an approximately 12,900 sf rip rap revetment, the permanent discharge of approximately 5,500 sf of clean fill between the existing seawall and the new sheet pile wall and the permanent discharge of approximately 3,950 sf of rip rap for sheet pile wall armoring, all of which will be discharged seaward of the high tide line (HTL).

This work is located in the Seekonk River located at 200 Taft Street in Pawtucket, Rhode Island. The revised work is shown on the enclosed plans titled "FORMER TIDEWATER FACILITY PAWTUCKET RHODE ISLAND CONTRACT DOCUMENTS PHASE 4 & 5 ALTERNATIVE REVETMENT LAYOUT PLAN" on two sheets dated "JANUARY 2022".

Due to the finding of additional contaminated soils within the project footprint, the original permit is hereby modified to increase the amount of permanent rip rap fill discharge by an additional 1,800 square-feet(sf) from 12,900sf to 14,700sf seaward of the HTL. The discharge of additional rip rap fill will cover an expanded contamination cap for the newly identified area of contaminants. This will prevent the discharge/erosion of the contaminated soils into the Seekonk River. Furthermore, the area of originally permitted dredging will be reduced by 1,800sf from the originally permitted 18,400sf to 16,600sf.

All other terms and conditions of the original permit remain in full force and effect.

We continually strive to improve our customer service. In order to better serve you, please complete our Customer Service Survey located at [http://corpsmapu.usace.army.mil/cm\\_apex/f?p=regulatory\\_survey](http://corpsmapu.usace.army.mil/cm_apex/f?p=regulatory_survey).

Please contact Mike Wierbonics of my staff at [michael.s.wierbonics@usace.army.mil](mailto:michael.s.wierbonics@usace.army.mil) or at (978) 318-8723 if you have any questions.

Sincerely,

*Kevin R Kotelly*

Kevin R. Kotelly, P.E.  
Chief, Permits and Enforcement Branch  
Regulatory Division

Enclosure

cc:

Igor Runge, GZA Environmental, [igor.runge@gza.com](mailto:igor.runge@gza.com)  
Rich Lucia, CRMC, [rlucia@crmc.ri.gov](mailto:rlucia@crmc.ri.gov)

GZA--A-ENV\43654-40\CAD\01\_CURRENT\PLANS\2022-01-11-REVISED-REVEMENT-PLANS-SECTIONS\S-62A-REVEMENT\_LAYOUT\_PLAN.DWG, MODIFIED REVEMENT\_LAYOUT\_PLAN JANUARY 11, 2022 1:38PM SCOTT BUXTON

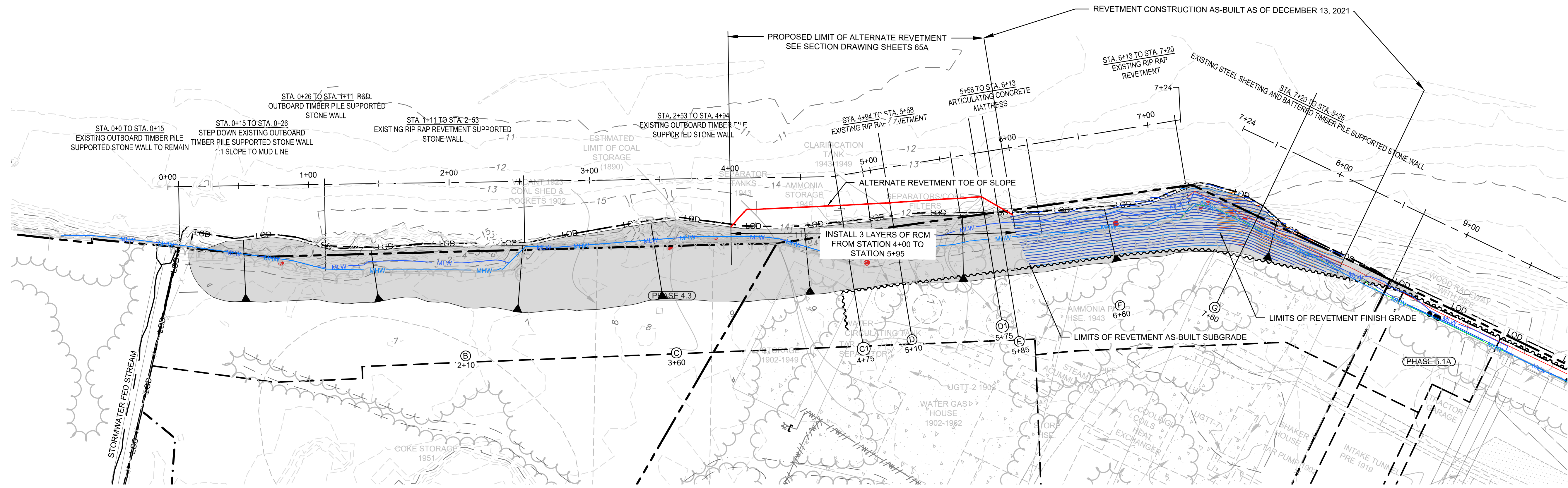
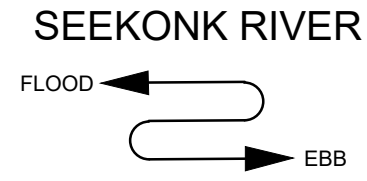

- NOTES:
- SEE SHEET S-65A FOR SECTIONS C1, D, D1 AND E.
  - UPDATED TOPOGRAPHY AND BATHYMETRIC SURVEY PROVIDED BY CHARTER CONSTRUCTION DIGITAL FILE RECEIVED OCTOBER 29, 2021 SURVEY PERFORMED BY A PLUS SURVEY.

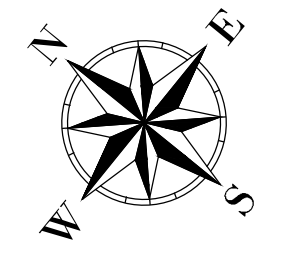

2	BID CLARIFICATION REVISIONS	TRG	10/27/21
1	CONSTRUCTION PHASES 5.1A AND 5.1B ADDED	TRG	6/25/21
NO.	ISSUE/DESCRIPTION	BY	DATE

THE INFORMATION SHOWN ON THE DRAWING IS SOLELY FOR USE BY NATIONAL GRID OR THE NATIONAL GRID'S DESIGNATED REPRESENTATIVE FOR THE SPECIFIC PROJECT AND LOCATION IDENTIFIED ON THE DRAWING. THE DRAWING SHALL NOT BE TRANSFERRED, REUSED, COPIED, OR ALTERED IN ANY MANNER FOR USE AT ANY OTHER LOCATION OR FOR ANY OTHER PURPOSE WITHOUT THE PRIOR WRITTEN CONSENT OF GZA AND NATIONAL GRID. ANY TRANSFER, REUSE, OR MODIFICATION TO THE DRAWING BY OTHERS, WITHOUT THE PRIOR WRITTEN EXPRESS CONSENT OF GZA AND NATIONAL GRID, WILL BE AT THE USER'S SOLE RISK AND WITHOUT ANY RISK OR LIABILITY TO GZA AND NATIONAL GRID.

FORMER TIDEWATER FACILITY  
 PAWTUCKET, RHODE ISLAND  
 CONTRACT DOCUMENTS PHASE 4 & 5

**ALTERNATIVE REVEMENT LAYOUT PLAN**

P.E. STAMP:

PREPARED BY:	GZA GeoEnvironmental, Inc. Engineers and Scientists www.gza.com	PREPARED FOR:	nationalgrid
PROJ MGR:	DJR	REVIEWED BY:	MJP
DESIGNED BY:	---	DRAWN BY:	SAB
DATE:	JANUARY 2022	PROJECT NO.:	43654.40
		CHECKED BY:	DJR
		SCALE:	AS SHOWN
		REVISION NO.:	
		DRAWING	S-62A
		SHEET NO.	1 OF 3

DRAFT COPY  
NOT FOR CONSTRUCTION

G:\A-ENR\43654-40\CAD\01\_CURRENT\PLANS\2022-01-11-REVISED-REVIEW-PLANS-SECTIONS\REVISED-REVIEW-SECTIONS.DWG 65A ALT-REV-XC JANUARY 11, 2022 1:09PM SCOTT BLIXTON

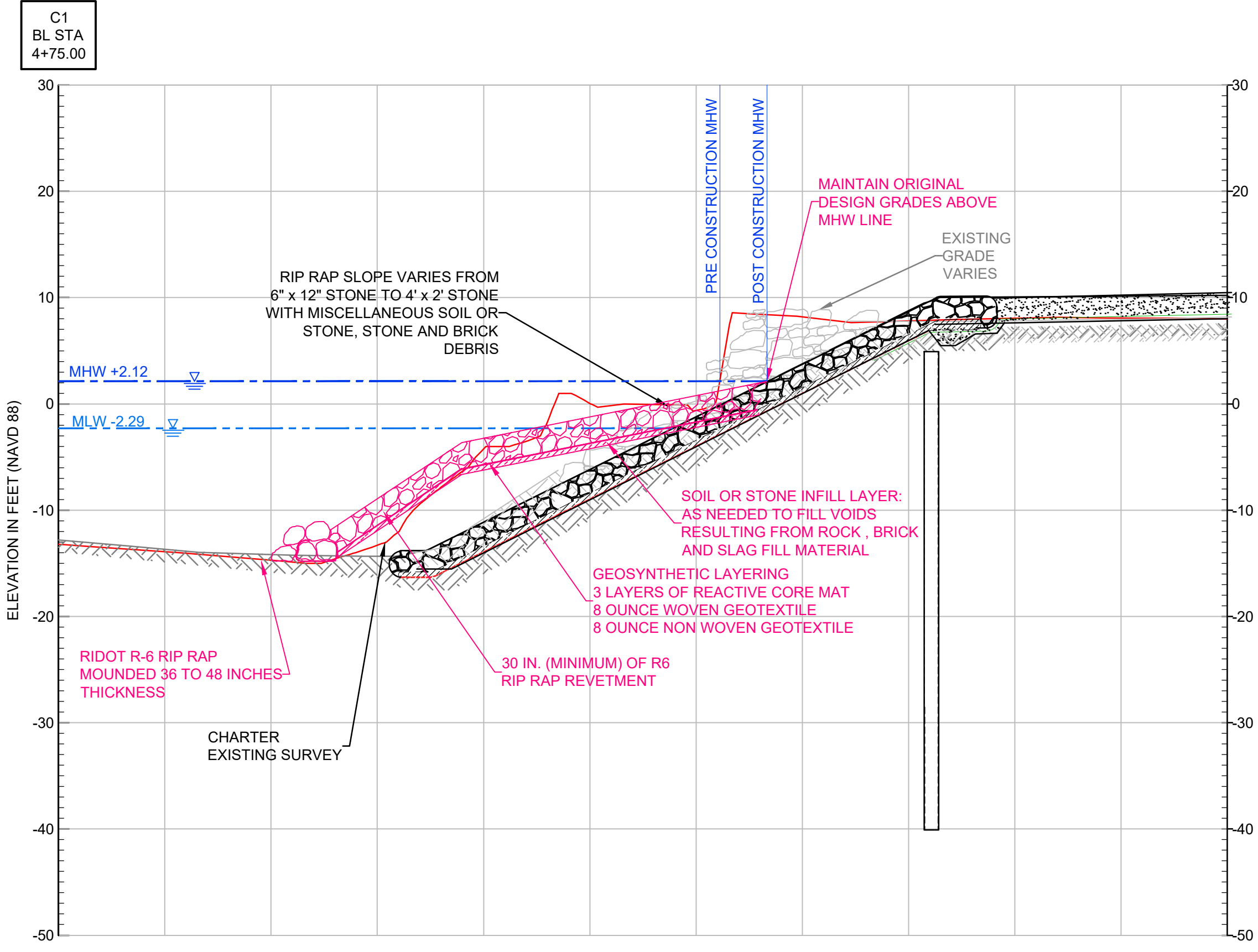

**C1** WALL SECTION (STA. 4+75)  
SCALE: 1" = 10'

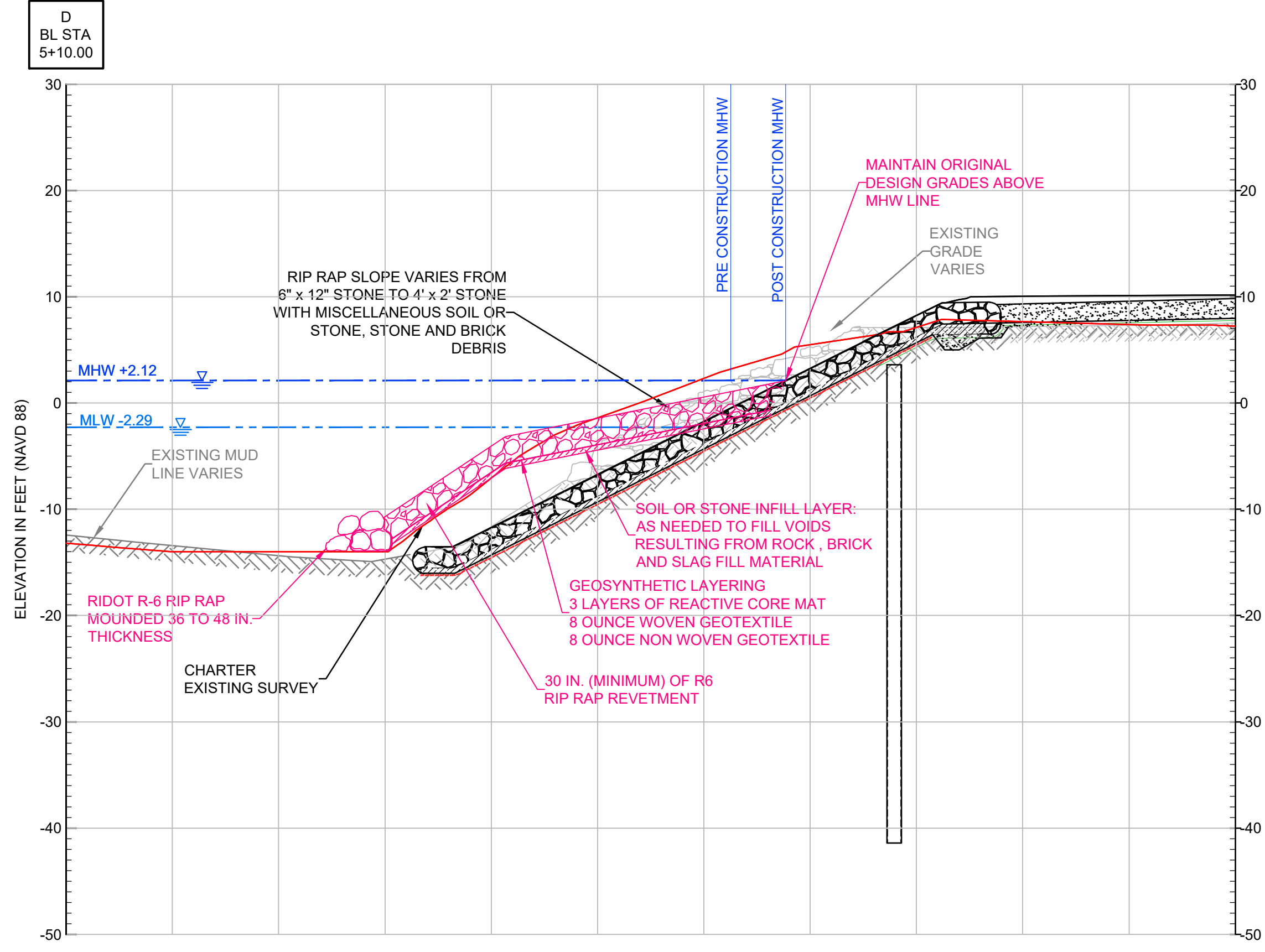

**D** WALL SECTION (STA. 5+10)  
SCALE: 1" = 10'

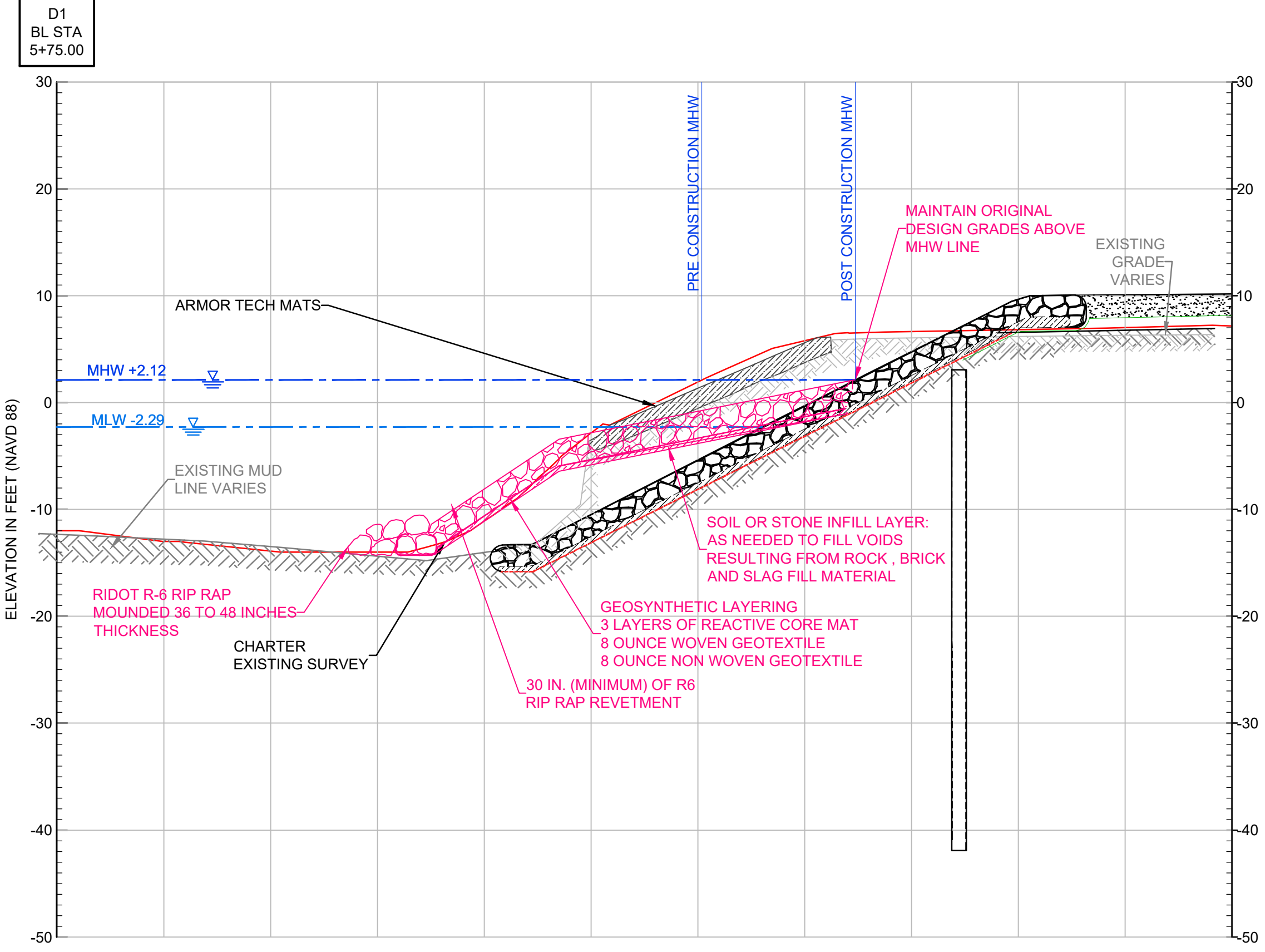

**D1** WALL SECTION (STA. 5+75)  
SCALE: 1" = 10'

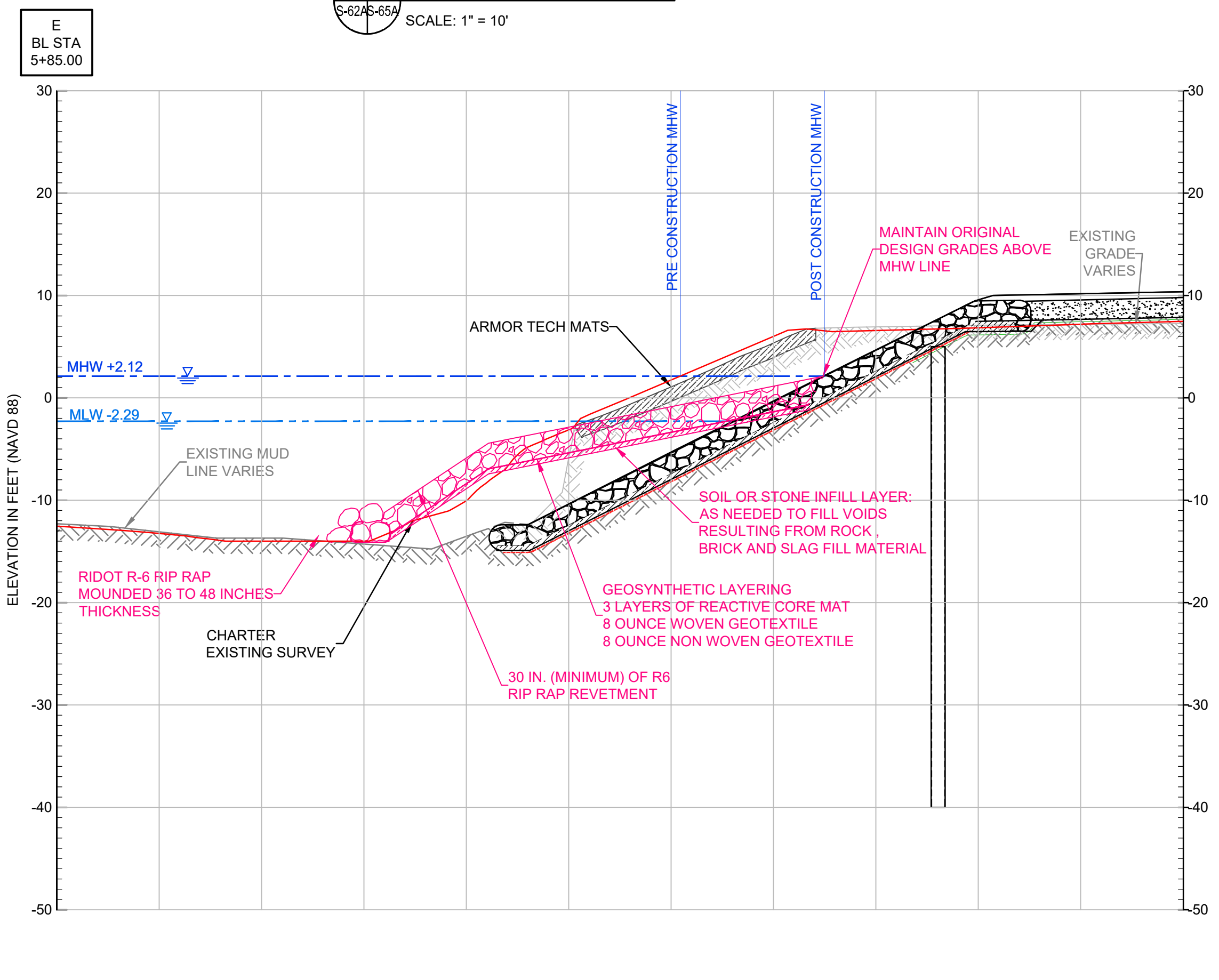

**E** WALL SECTION (STA. 5+85)  
SCALE: 1" = 10'

- LEGEND**
- EXISTING FEATURES
  - ORIGINAL REVETMENT DESIGN
  - UPDATED EXISTING TOPOGRAPHY AND BATHYMETRIC SURVEY
  - ALTERNATIVE REVETMENT DESIGN
  - MEAN HIGH WATER LINE
  - MEAN LOW WATER LINE

**NOTE:**  
UPDATED TOPOGRAPHY AND BATHYMETRIC SURVEY PROVIDED BY CHARTER CONSTRUCTION DIGITAL FILE RECEIVED OCTOBER 29, 2021 SURVEY PERFORMED BY A PLUS SURVEY.

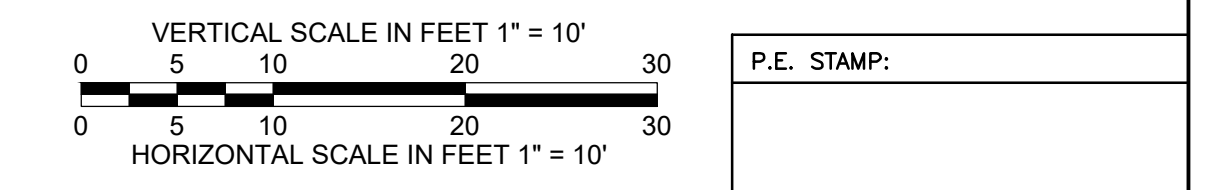

DRAFT COPY  
NOT FOR CONSTRUCTION

NO.	ISSUE/DESCRIPTION	BY	DATE
THE INFORMATION SHOWN ON THE DRAWING IS SOLELY FOR USE BY NATIONAL GRID OR THE NATIONAL GRID'S DESIGNATED REPRESENTATIVE FOR THE SPECIFIC PROJECT AND LOCATION IDENTIFIED ON THE DRAWING. THE DRAWING SHALL NOT BE TRANSFERRED, REUSED, COPIED, OR ALTERED IN ANY MANNER FOR USE AT ANY OTHER LOCATION OR FOR ANY OTHER PURPOSE WITHOUT THE PRIOR WRITTEN CONSENT OF GZA AND NATIONAL GRID. ANY TRANSFER, REUSE, OR MODIFICATION TO THE DRAWING BY OTHERS, WITHOUT THE PRIOR WRITTEN EXPRESS CONSENT OF GZA AND NATIONAL GRID, WILL BE AT THE USER'S SOLE RISK AND WITHOUT ANY RISK OR LIABILITY TO GZA AND NATIONAL GRID.			
<b>FORMER TIDEWATER FACILITY PAWTUCKET, RHODE ISLAND CONTRACT DOCUMENTS PHASE 4 &amp; 5</b>			
<b>ALTERNATIVE REVETMENT SECTIONS (1 OF 2)</b>			
PREPARED BY: <b>GZA</b> GeoEnvironmental, Inc. Engineers and Scientists www.gza.com		PREPARED FOR: <b>nationalgrid</b>	
PROJ MGR: DJR	DESIGNED BY: ---	REVIEWED BY: MJP	CHECKED BY: DJR
DATE: JANUARY 2022	PROJECT NO. 43654.40	DRAWN BY: SAB	SCALE: AS SHOWN
		REVISION NO.	DRAWING <b>S-65A</b> SHEET NO. 25 OF 74