



ARCADIS U.S., Inc.
300 Metro Center Boulevard
Suite 250
Warwick
Rhode Island 02886
Tel 401.738.3887
Fax 401.732.1686
www.arcadis-us.com

Mr. Jeffrey Crawford
Rhode Island Department of Environmental Management
Office of Waste Management
235 Promenade Street
Providence, RI 02908

SER-1

Subject:
Springfield Street School Complex Monitoring Wells

Date:
November 1, 2010

Dear Mr. Crawford:

Contact:
Donna H. Pallister, PE

As noted in our August quarterly report and as we discussed recently, monitoring wells ATC-2, ATC-3 and ATC-5 are no longer able to be sampled. Due to vandalism, settling, and insects, the casings of these wells are blocked with soil and stone or bent such that groundwater samples can no longer be collected. A Site Plan showing the well locations is attached.

Phone:
401.738.3887

The monitoring wells at the Site were installed in December, 2000, and have been sampled on a quarterly basis since then in accordance with the *Long-Term Operation and Maintenance Plan and Site Contingency Plan (O&M Plan)* contained in the *Remedial Action Work Plan* prepared by ATC dated April 2, 1999, revised May 3, 1999 and May 9, 1999. The *Remedial Action Work Plan (RAWP)* was approved by the Rhode Island Department of Environmental Management (RIDEM) in a letter dated June 4, 1999.

Our ref:
WK012152.0007

The Site Investigation Report (ATC, March 1999) and the Remedial Action Work Plan (ATC, March 1999) indicated that no contaminants were detected in groundwater at concentrations which exceeded the GB groundwater standards in the *Rules and Regulations for the Investigation and Remediation of Hazardous Materials Releases*. The groundwater at the Site is classified as GB. Groundwater remediation was not included as part of the remedy for the Site due to the lack of contamination in groundwater.

Groundwater monitoring has been conducted on a quarterly basis since the monitoring wells were installed in December 2000. None of the monitoring results for any of the Site groundwater samples have exceeded GB groundwater standards.

2010 NOV - 3 P 1:33
RECEIVED
D.E.M./O&M

Mr. Jeffrey Crawford
November 1, 2010

The only compound detected by monitoring of ATC-2 was chloroform, which was detected 4 times out of 22 sampling events, at low concentrations near the detection limit. The only compound detected in samples from monitoring well ATC-3 was toluene, which was detected 6 times in 25 sampling events. The maximum concentration detected was 13.1 ug/L, compared to the GB objective of 1,700 ug/L. Two compounds were detected in samples from ATC-5: chloroform and MTBE. Chloroform was detected once in 2004, and MTBE was detected once in 2001. Otherwise, all results for samples from this well have been non-detectable.

Based on the results of groundwater monitoring conducted at the Site since the wells were installed in December 2000, we believe that further groundwater monitoring is not warranted. There is no evidence that past activities and uses of the property have resulted in groundwater contamination at the Site, and the current Site use does not present a risk to groundwater quality. There is no benefit to continued monitoring or to replacement of monitoring wells ATC-2, ATC-3 and ATC-5.

Therefore, we are requesting a modification to the O&M Plan to discontinue groundwater monitoring at the Site.

Please contact me at 401-738-3887, extension 25, or donna.pallister@arcadis-us.com with any questions or comments.

Sincerely,

ARCADIS U.S., Inc.

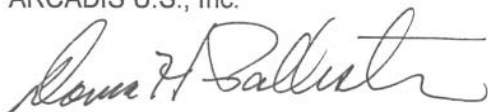

Donna H. Pallister, PE, LSP
Senior Engineer

Copies:

S. Tremblay, Providence Schools
A. Sepe, City of Providence

Attachments:

Site Plan
Groundwater Monitoring Results

RECEIVED
D.E.M./O&M
2010 NOV -3 P 1:33

NOTES:
 THE FOLLOWING MAP IS REFERENCED: ELEMENTARY & MIDDLE SCHOOLS, PROVIDENCE RHODE ISLAND, ISSUED FOR CITY OF PROVIDENCE GRADING AND SAMPLING LOCATION PLAN, PREPARED BY NORTHEAST ENGINEERS & CONSULTANTS, INC. DATED MAY 18, 1999. SCALE: 1"=50'.
 THIS MAP HAS BEEN DIGITIZED FROM THE ABOVE REFERENCED MAP AND SCALE IS APPROXIMATE. FOR USE WITH UFR REPORT ONLY.

- LEGEND:
- PROPERTY LINE
 - FENCELINE
 - STORM DRAIN LINE
 - SANITARY SEWER LINE
 - CONTOUR
 - EP/5 SOIL GAS MONITORING WELL
 - ATC/4 ATC GROUNDWATER MONITORING WELL
 - HVAC UNIT
 - TRANSFORMER
 - CB CATCH BASIN
 - SVE SHED LOCATION (APPROXIMATE)
 - AREAS OF SETTLING OR EROSION (APPROXIMATE)

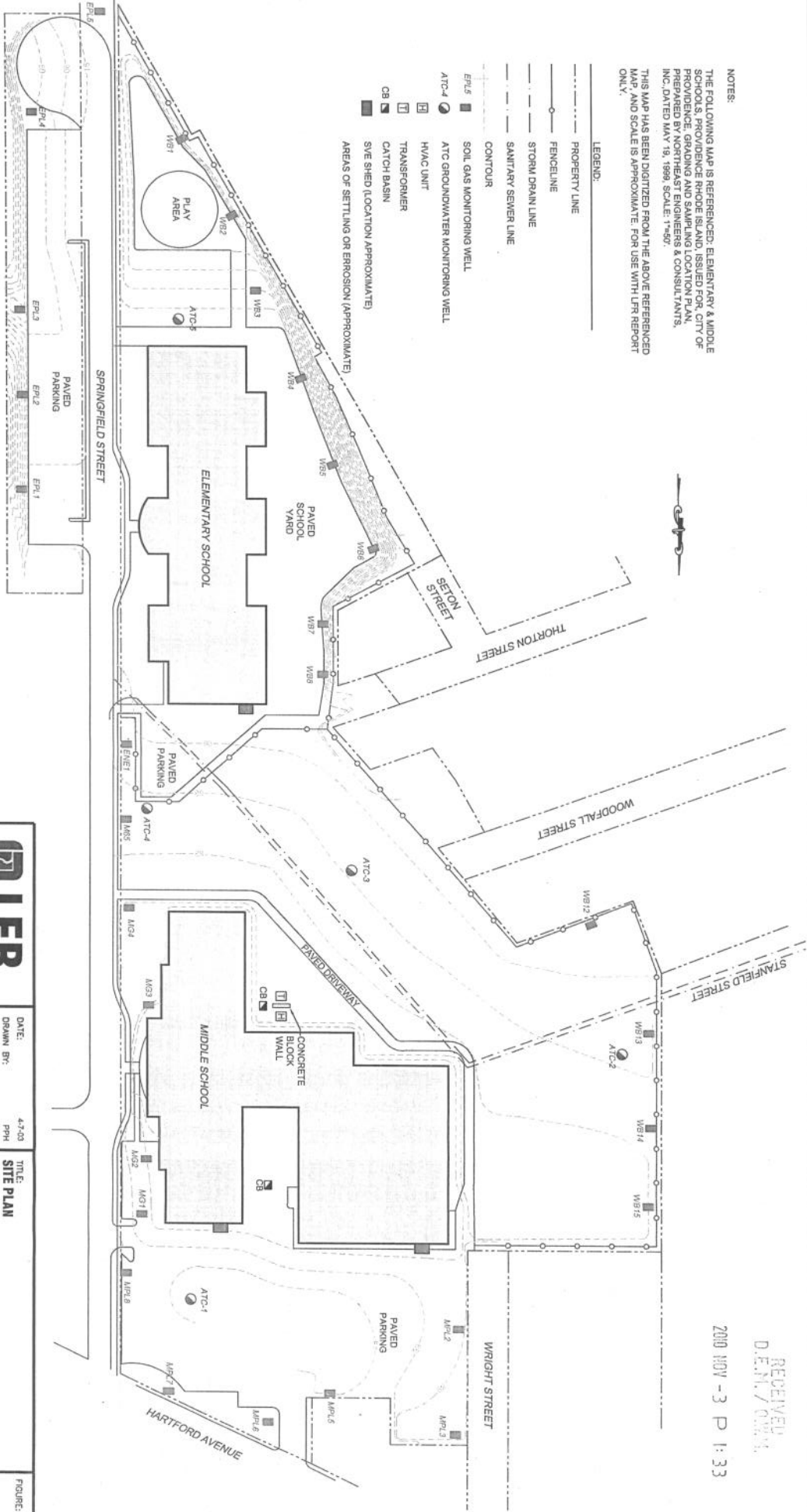

LFRR
 250 Centerville Road
 Building E, Suite 12
 Warwick, Rhode Island 02886
 Phone: (401) 739-9887
 Fax: (401) 732-1686

DATE: 4-1-03
 DRAWN BY: PPH
 REVIEWED BY: DP
 APPROVED BY: AS NOTED
 SCALE: 081-15227-00
 FILE NO: 081-15227-00
 JOB NO:

TITLE: **SITE PLAN**
 LOCATION: **SPRINGFIELD STREET SCHOOL COMPLEX**
SPRINGFIELD STREET
PROVIDENCE, RHODE ISLAND

FIGURE: **1**

RECEIVED
 D.F.M./O.W.M.
 2010 NOV -3 P 1:33

