

- LEGEND:**
- SITE AREA BOUNDARIES
 - ▨ EXISTING BUILDINGS ON-SITE
 - EXISTING FOUNDATION/PAD ON-SITE
 - ▨ EXISTING BUILDINGS/STRUCTURES OFF-SITE
 - EXISTING NBC INTERCEPTOR SANITARY SEWER
 - EXISTING CITY OF PAWTUCKET STORM DRAIN
 - W— EXISTING WATER LINE
 - S— EXISTING STORM/COMBINED SAN. SEWER OVERFLOW
 - UE— EXISTING UNDERGROUND ELECTRIC CABLE IN CONDUIT
 - EXISTING UNDERGROUND ELECTRIC MH/STRUCTURE
 - ▭ EXISTING ACCESS ROAD
 - EXISTING RETAINING WALLS
 - × EXISTING FENCE
 - EXISTING CATCH BASIN LOCATIONS
 - APPROX. 200 FT. JURISDICTION LIMIT
 - APPROXIMATE PROPERTY LINE

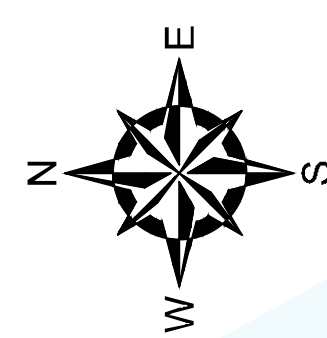

- SAMPLE LEGEND**
- VHB-400 SURFACE SOIL SAMPLE LOCATIONS
 - SS-100 TEST PIT LOCATIONS (2010)
 - TP-367 TEST PIT LOCATIONS
 - TP-34 TEST PIT LOCATIONS
 - TP-204 TEST PIT LOCATIONS
 - TB-255 TEST BORING LOCATIONS (2010-2011)
 - TB-15 SOIL BORING LOCATIONS (ATLANTIC ENVIRONMENTAL SERVICES, NOV.96)
 - MW-320 S/D MONITORING WELL LOCATIONS
 - MW-3 MONITORING WELL LOCATIONS
 - B-159/B MONITORING WELL LOCATIONS
 - TS2D-6 SEDIMENT SAMPLE LOCATION
 - SC21 ARCADIS SEDIMENT SAMPLE LOCATION (2008)
 - SC-15 SOIL GAS SAMPLE LOCATION (ATLANTIC ENVIRONMENTAL SERVICES, NOV.96)
 - SG-100 PERIMETER SOIL GAS SAMPLING LOCATION
 - SG-200 INTERIOR SOIL GAS SAMPLING LOCATION

GENERAL NOTES:

1. EXISTING CONDITIONS BASE MAP DEVELOPED FROM THE FOLLOWING: ELECTRONIC FILES FROM GEI CONSULTANTS, INC. (FORMERLY AES) ENTITLED "HISTORIC STRUCTURES AND SAMPLE LOCATIONS", ORIGINAL SCALE 1"=80', DATED JULY 1999. ELECTRONIC FILES FROM VANASSE HANGEN BRUSTLIN, INC. ENTITLED "SOIL BORING, TEST PIT AND MONITOR WELL LOCATIONS", SCALE: 1"=60', UNDATED. ELECTRONIC FILES FROM WELSH ASSOCIATES LAND SURVEYORS, INC. ENTITLED "TOPOGRAPHIC SURVEY (AS-BUILT), FORMER TIDEWATER FACILITY, DEMOLITION OF GAS HOLDERS NOS. 7 & 8", DATED DECEMBER 17, 2010. ON-SITE INVESTIGATIONS AND SURVEYS BY GZA PERSONNEL DURING VARIOUS SITE VISITS DURING 2009 AND 2010.
2. PROPERTY LINES AND LOT INFORMATION ESTABLISHED FROM INFORMATION PROVIDED ON A DRAWING ENTITLED "PERIMETER SURVEY OF LAND AT THE TIDEWATER FORMER MGP SITE IN PAWTUCKET, RHODE ISLAND FOR ATLANTIC ENVIRONMENTAL SERVICES INC." DEVELOPED BY LOUIS FEDERICI AND ASSOCIATES AND AN AUTO CAD FILE ENTITLED "MAX READ FIELD TRACK EXPANSION 2007" PROVIDED BY THE CITY OF PAWTUCKET.
3. HORIZONTAL DATUM IS BASED ON NAD 1983 FROM BASE MAPPING PROVIDED BY GEI CONSULTANTS, INC.
4. VERTICAL DATUM IS BASED ON NGVD 1929 (MSL) FROM BASE MAPPING PROVIDED BY GEI CONSULTANTS, INC.
5. REFERENCE SEWER DATA FROM SCANNED IMAGE PROVIDED BY THE CITY OF PAWTUCKET, RHODE ISLAND, ENTITLED "STUDY OF SEWERAGE FACILITIES" BY WATERMAN ENGINEERING CO. & ANDERSON NICHOLS CO. DATED NOV. 1975, ORIGINAL SCALE 1"=400' & SCANNED IMAGES OF HISTORIC PLAN & PROFILE DRAWINGS PROVIDED BY THE CITY OF PAWTUCKET, RHODE ISLAND.
6. SITE UTILITIES TAKEN FROM 1984 SANBORN MAP AND HISTORIC FIGURES PROVIDED BY NATIONAL GRID. ALL UTILITY LOCATIONS ARE APPROXIMATE AND SHOWN FOR REFERENCE ONLY.
7. SOIL BORING, SEDIMENT SAMPLE AND SOIL GAS DATA FROM ATLANTIC ENVIRONMENTAL SERVICES, INC. FROM DRAWING ENTITLED "SAMPLING LOCATIONS AND HISTORIC STRUCTURES", ORIGINAL SCALE 1"=80', DATED NOV.96, PLATE 2.
8. REVIEW OF UTILITIES IS LIMITED TO THOSE LOCATED WITHIN THE LIMITS OF THE TIDEWATER SITE AND IMMEDIATE VICINITY (I.E., TIDEWATER STREET AND MERRY STREET).

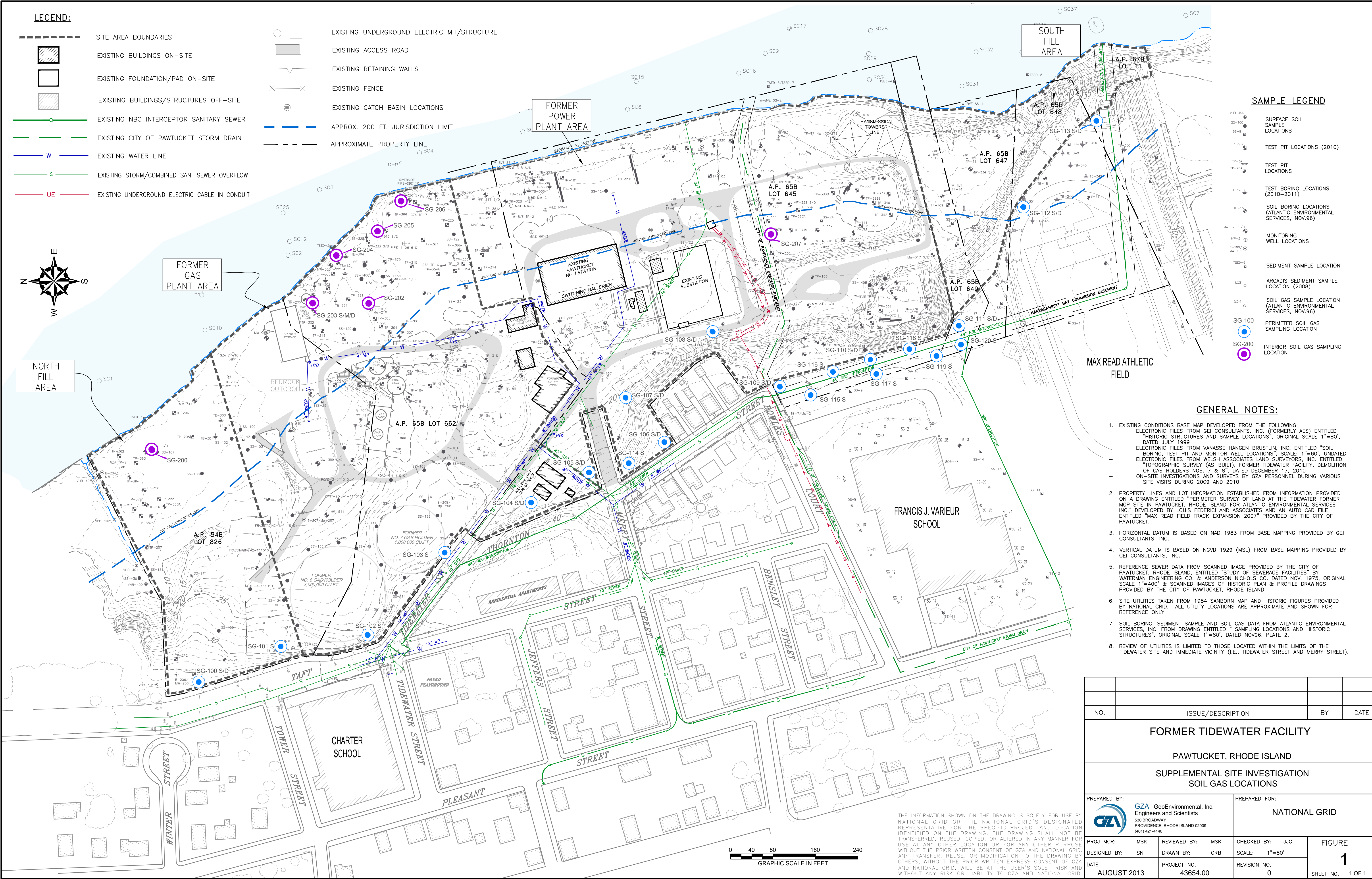

NO.	ISSUE/DESCRIPTION	BY	DATE
FORMER TIDEWATER FACILITY			
PAWTUCKET, RHODE ISLAND			
SUPPLEMENTAL SITE INVESTIGATION			
SOIL GAS LOCATIONS			
PREPARED BY:	GZA GeoEnvironmental, Inc. Engineers and Scientists 530 BROADWAY PROVIDENCE, RHODE ISLAND 02909 (401) 421-4140	PREPARED FOR:	NATIONAL GRID
PROJ MGR:	MSK	REVIEWED BY:	MSK
DESIGNED BY:	SN	DRAWN BY:	CRB
DATE:	AUGUST 2013	PROJECT NO.:	43654.00
		CHECKED BY:	JJC
		SCALE:	1"=80'
		REVISION NO.:	0
			FIGURE
			1
			SHEET NO. 1 OF 1

THE INFORMATION SHOWN ON THE DRAWING IS SOLELY FOR USE BY NATIONAL GRID OR THE NATIONAL GRID'S DESIGNATED REPRESENTATIVE FOR THE SPECIFIC PROJECT AND LOCATION IDENTIFIED ON THE DRAWING. THE DRAWING SHALL NOT BE TRANSFERRED, REUSED, COPIED, OR ALTERED IN ANY MANNER FOR USE AT ANY OTHER LOCATION OR FOR ANY OTHER PURPOSE WITHOUT THE PRIOR WRITTEN CONSENT OF GZA AND NATIONAL GRID. ANY TRANSFER, REUSE, OR MODIFICATION TO THE DRAWING BY OTHERS, WITHOUT THE PRIOR WRITTEN EXPRESS CONSENT OF GZA AND NATIONAL GRID, WILL BE AT THE USER'S SOLE RISK AND WITHOUT ANY RISK OR LIABILITY TO GZA AND NATIONAL GRID.



2013.8 - GZA GeoEnvironmental, Inc. - GZA\ENVA\43654.mxd\GSD\GZA_DWGSS\SitePlan\Elemental_Site_Investigation_Report.dwg - August 21, 2013 - 4:10pm - eocthorburn