



January 11, 2022
File No. 05.00043654.60

Mr. Michael Wierbonics
United States Army Corps of Engineers
New England District, Regulatory District
696 Virginia Road
Concord, MA 01742

Re: USACE File No. NAE-2019-02150
Remedial Activities Project
Former Tidewater Facility
200 Taft Street
Pawtucket, Rhode Island

Dear Mr. Wierbonics:

As we have discussed during the past few weeks, GZA GeoEnvironmental, Inc. (GZA), on behalf of The Narragansett Electric Company d/b/a National Grid (National Grid), is seeking approval of certain modifications to the approved, on-going Remedial Activities at the Former Tidewater Facility located in Pawtucket, Rhode Island (herein referred to as the Site).

The approved remedy includes installation of a steel sheetpile containment wall and revetment cap system along portions of the banks of the Seekonk River to mitigate the migration of non-aqueous phase liquids (NAPLs) from the upland portion of the Site to the river. Construction of the revetment system includes removal of existing shoreline structures including granite block walls, miscellaneous debris covered slopes, and timber and steel sheet pile supported wharfs and walls; regrading of the shoreline; installation of reactive core mats (RCM) on the surface of the regraded shoreline; and installation of a riprap armor layer. During regrading and demolition of the existing coastal bank features for the revetment cap, the riverbank will be cut back into the Site (landward, to the west) creating approximately 13,400 square feet of new aquatic resource area (as estimated using the preconstruction and post construction Mean High Water (MHW) lines as datums). The loss of water due to the installation of the containment wall is estimated at approximately 5,200 square feet. Overall, this remediation project will permanently create approximately 8,200 square feet of new aquatic resource area and associated marine habitat.

During regrading of the riverbank in the northern portion of the Site for the revetment cap, coal tar impacted soil was encountered and the contractor performing the work had difficulties containing the released coal tar material within the immediate work area. We temporarily stopped work in this impacted area and have moved to the northern property boundary in order to continue the revetment work per the approved design. We have been able to work in the northern area within our containment systems without the generation of substantial sheens and we will continue to work southward in accordance with the approved design until we again encounter significantly coal tar impacted soil.

Given the observed coal tar impacts in certain areas, we are seeking approval to modify the revetment cap design in the northern portion of the Site between Stations 4+00 and 5+95 (approximately 195 feet along the shoreline) to minimize the disturbance of coal tar impacted soil and the risk of a potential breach in the controls (turbidity curtains and absorbent booms) installed within the river. Instead of disturbing and excavating in these impacted areas, fill consisting of stone, RCM, woven and non-woven geotextiles, and riprap will be placed on top of the surface of the impacted sediment, all below MHW and the High Tide Line (HTL). The slope of the bottom sediment will also be adjusted accordingly – a bit shallower than the original design – and will



Known for excellence.
Built on trust.

GEOTECHNICAL
ENVIRONMENTAL
ECOLOGICAL
WATER
CONSTRUCTION
MANAGEMENT

188 Valley Street
Suite 300
Providence, RI 02909
T: 401.421.4140
F: 401.751.8613
www.gza.com



extend several feet beyond what was anticipated within the 2019 permit. The existing riverbank above MHW will be regraded consistent with the original permitted design. The final result for the overall project will be a decrease in the amount of dredged material and an increase in fill replacement compared to the approved permit values. Approximate areas and distances are as follows:

Attribute	NAE-2019-02150 Permit Value	Proposed Modified Value
Dredging seaward of MHW for revetment cap (square feet)	18,400	16,600
Sheet Pile Wall seaward of MHW (linear feet)	550	550 (no change)
Rip Rap Revetment seaward of HTL (square feet)	12,900	14,700
Clean fill between existing seawall and new sheet pile wall seaward of HTL (square feet)	5,500	5,500 (no change)
Permanent discharge of rip rap for sheet pile wall armoring seaward of HTL (square feet)	3,950	3,950 (no change)

The proposed design changes will not affect the permanent creation of new aquatic resource area and associated marine habitat; this remains at 8,200 square feet.

We are hopeful that the information provide above describes the need for a permit modification. Should you have any questions or require additional information, please do not hesitate to contact Igor Runge at (401) 374-3468 (cell). Thank you for your guidance in this unfortunate situation.

Very truly yours,

GZA GEOENVIRONMENTAL, INC.

David J. Rusczyk, P.E.
 Associate Principal
 860-858-3110 – david.rusczyk@gza.com

Igor Runge, Ph.D., P.H.
 Senior Consultant
 401-427-2710 - igor.runge@gza.com

Todd Greene, P.E.
 Associate Principal
 401-427-2714 - todd.greene@gza.com

Attachments: Drawing S-62A: Alternative Revetment Layout Plan
 Drawing S-65a: Alternative Revetment Sections

Cc: Kenneth Lento (National Grid)
 Joseph Martella (RIDEM)
 Richard Lucia (CRMC)

GZA--A-ENV\43654-40\CAD\01_CURRENT\PLANS\2022-01-11-REVISED-REVEMENT-PLANS-SECTIONS\S-62A_REVEMENT_LAYOUT_PLAN.DWG, MODIFIED REVEMENT_LAYOUT_PLAN JANUARY 11, 2022 1:38PM SCOTT BUXTON

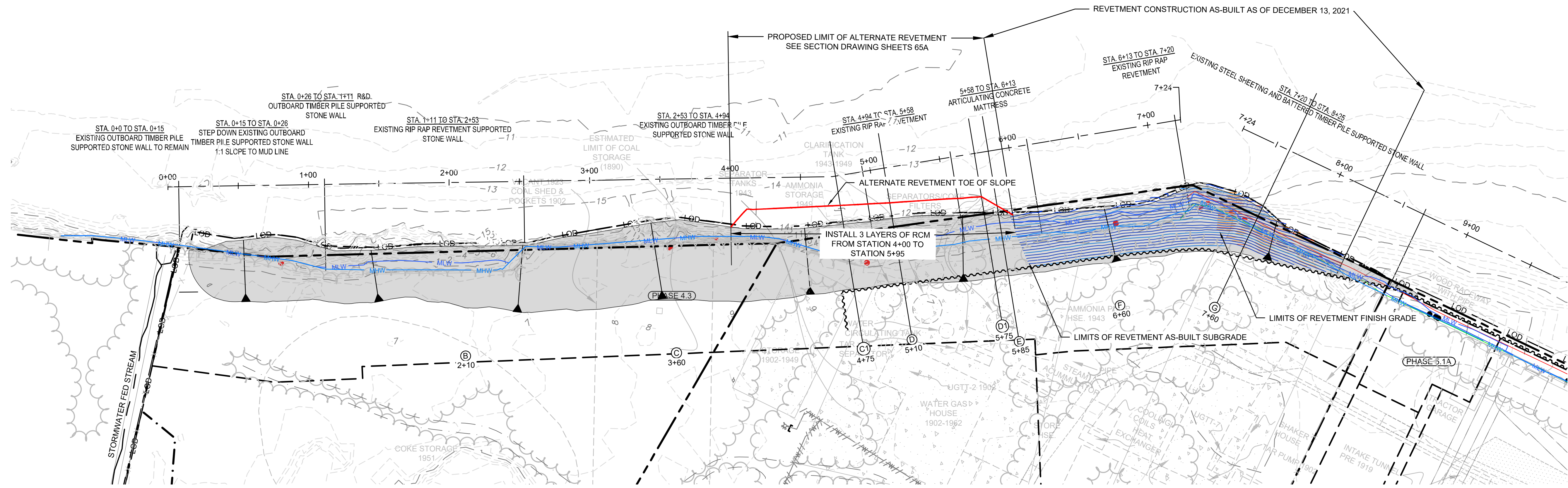
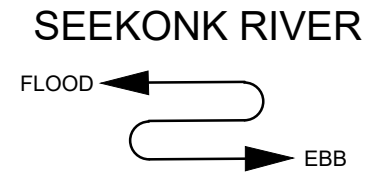

- NOTES:**
- SEE SHEET S-65A FOR SECTIONS C1, D, D1 AND E.
 - UPDATED TOPOGRAPHY AND BATHYMETRIC SURVEY PROVIDED BY CHARTER CONSTRUCTION DIGITAL FILE RECEIVED OCTOBER 29, 2021 SURVEY PERFORMED BY A PLUS SURVEY.

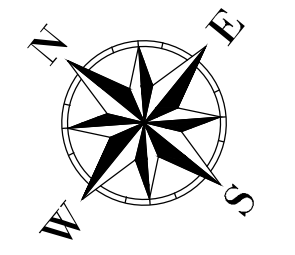

2	BID CLARIFICATION REVISIONS	TRG	10/27/21
1	CONSTRUCTION PHASES 5.1A AND 5.1B ADDED	TRG	6/25/21
NO.	ISSUE/DESCRIPTION	BY	DATE

THE INFORMATION SHOWN ON THE DRAWING IS SOLELY FOR USE BY NATIONAL GRID OR THE NATIONAL GRID'S DESIGNATED REPRESENTATIVE FOR THE SPECIFIC PROJECT AND LOCATION IDENTIFIED ON THE DRAWING. THE DRAWING SHALL NOT BE TRANSFERRED, REUSED, COPIED, OR ALTERED IN ANY MANNER FOR USE AT ANY OTHER LOCATION OR FOR ANY OTHER PURPOSE WITHOUT THE PRIOR WRITTEN CONSENT OF GZA AND NATIONAL GRID. ANY TRANSFER, REUSE, OR MODIFICATION TO THE DRAWING BY OTHERS, WITHOUT THE PRIOR WRITTEN EXPRESS CONSENT OF GZA AND NATIONAL GRID, WILL BE AT THE USER'S SOLE RISK AND WITHOUT ANY RISK OR LIABILITY TO GZA AND NATIONAL GRID.

FORMER TIDEWATER FACILITY
 PAWTUCKET, RHODE ISLAND
 CONTRACT DOCUMENTS PHASE 4 & 5

ALTERNATIVE REVEMENT LAYOUT PLAN

P.E. STAMP:

PREPARED BY:	GZA GeoEnvironmental, Inc. Engineers and Scientists www.gza.com	PREPARED FOR:	nationalgrid
PROJ MGR:	DJR	REVIEWED BY:	MJP
DESIGNED BY:	---	DRAWN BY:	SAB
DATE:	JANUARY 2022	PROJECT NO.:	43654.40
		CHECKED BY:	DJR
		SCALE:	AS SHOWN
		REVISION NO.:	
		DRAWING	S-62A
		SHEET NO.	1 OF 3

**DRAFT COPY
NOT FOR CONSTRUCTION**

G:\A-ENR\43654\01_CURRENT\PLANS\2022-01-11-REVISED-REVIEW-PLANS-SECTIONS\REVISED-REVIEW-SECTIONS.DWG 65A ALT-REV-XC JANUARY 11, 2022 1:09PM SCOTT BLIXTON

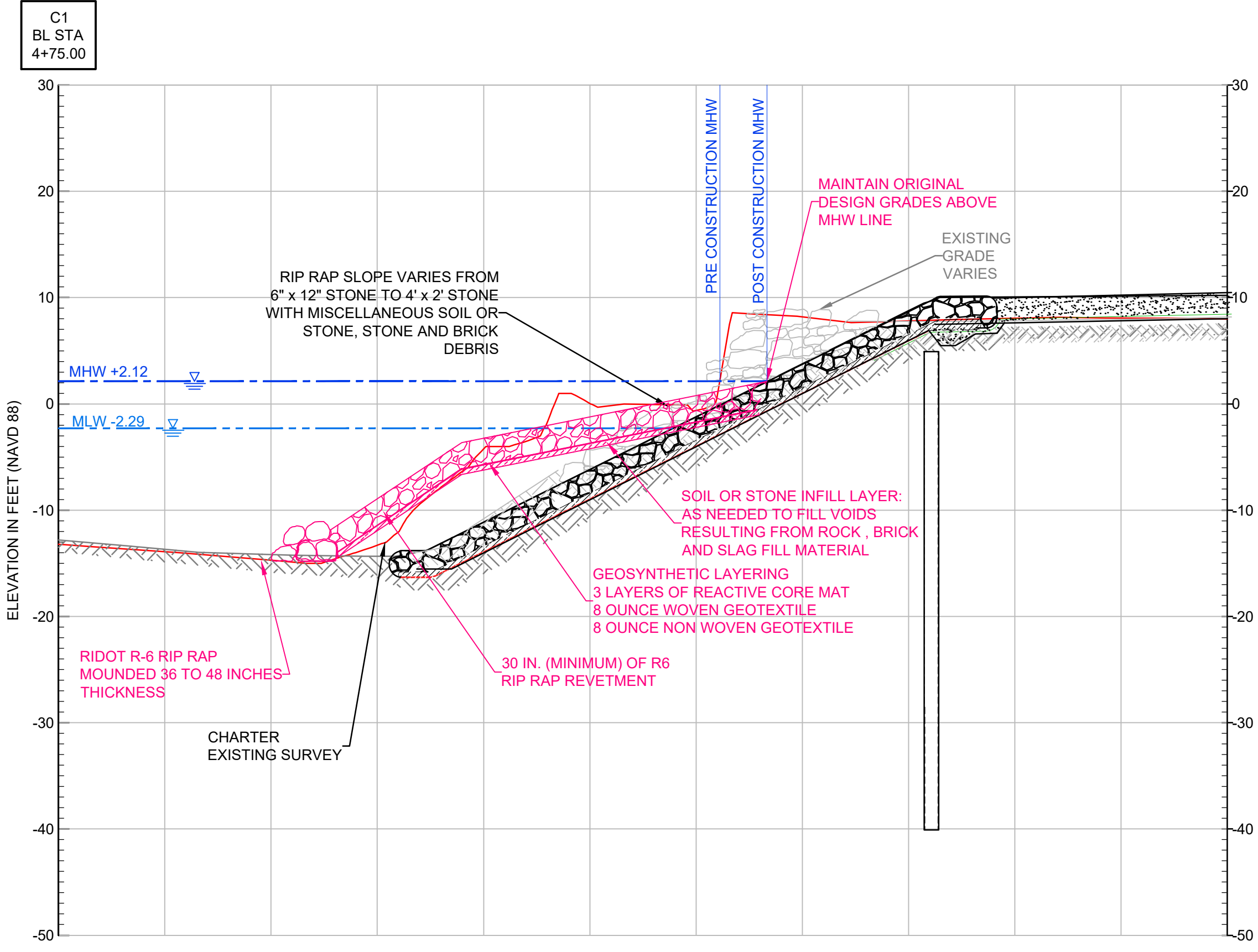

C1 WALL SECTION (STA. 4+75)
SCALE: 1" = 10'

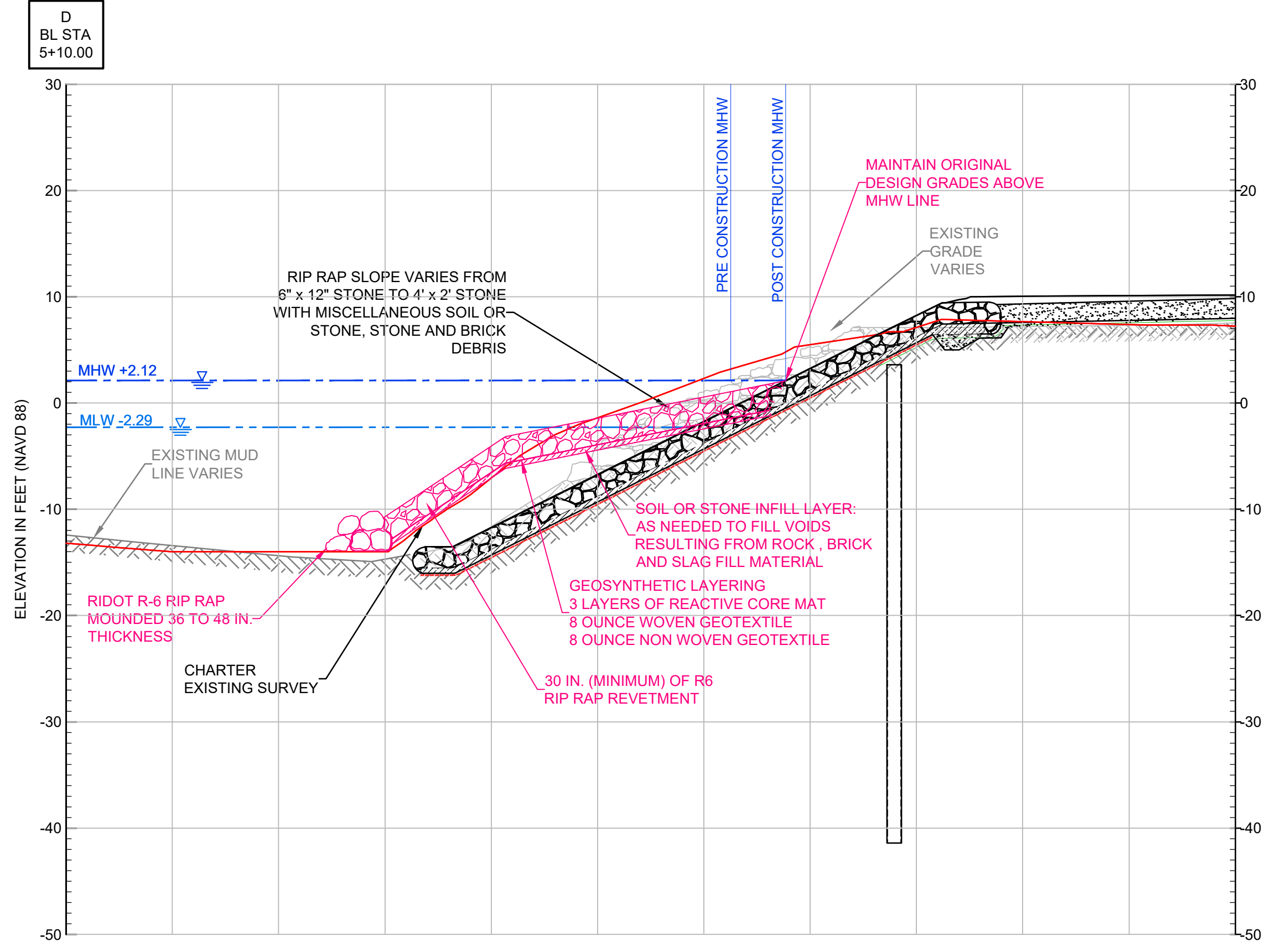

D WALL SECTION (STA. 5+10)
SCALE: 1" = 10'

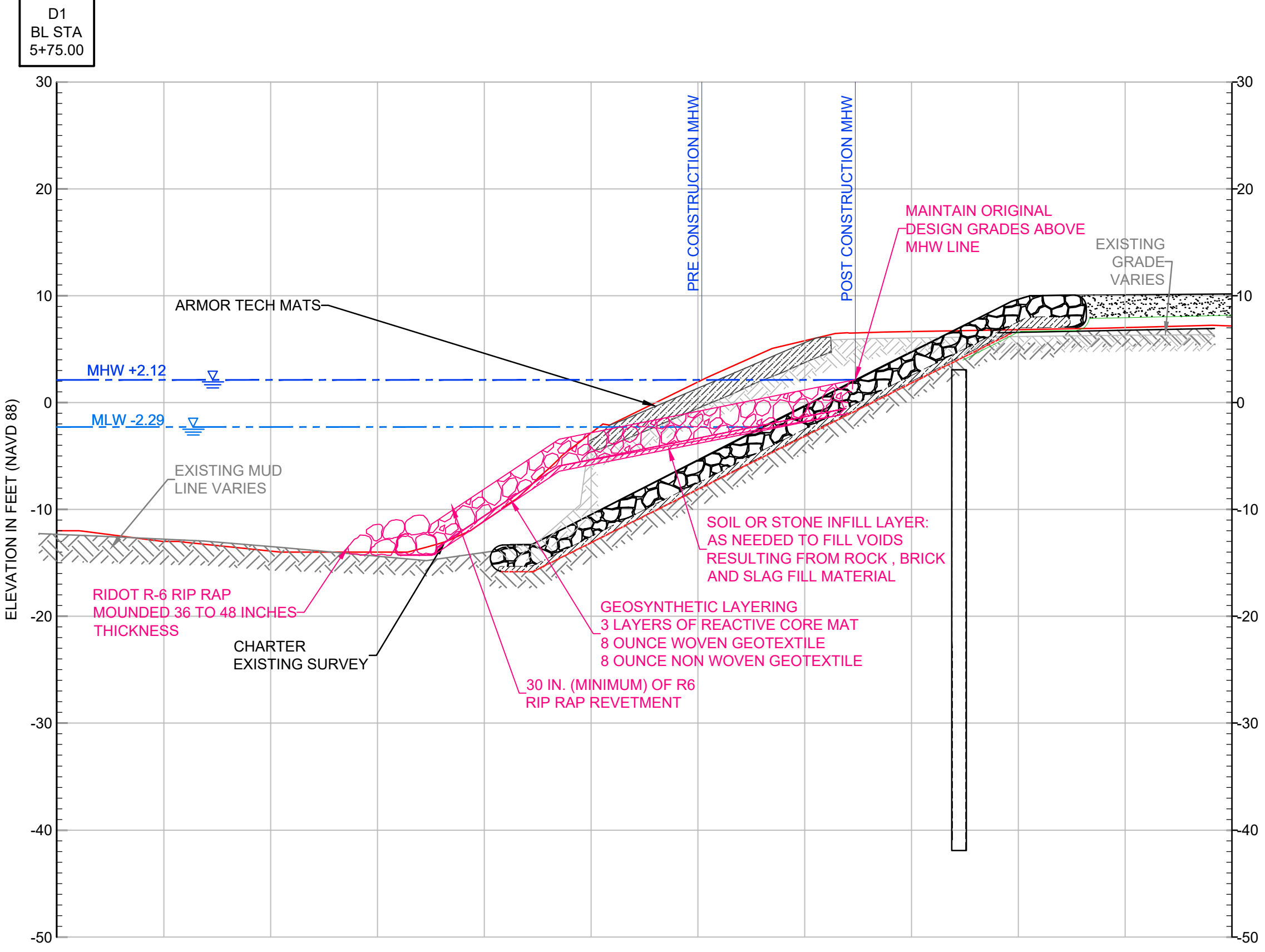

D1 WALL SECTION (STA. 5+75)
SCALE: 1" = 10'

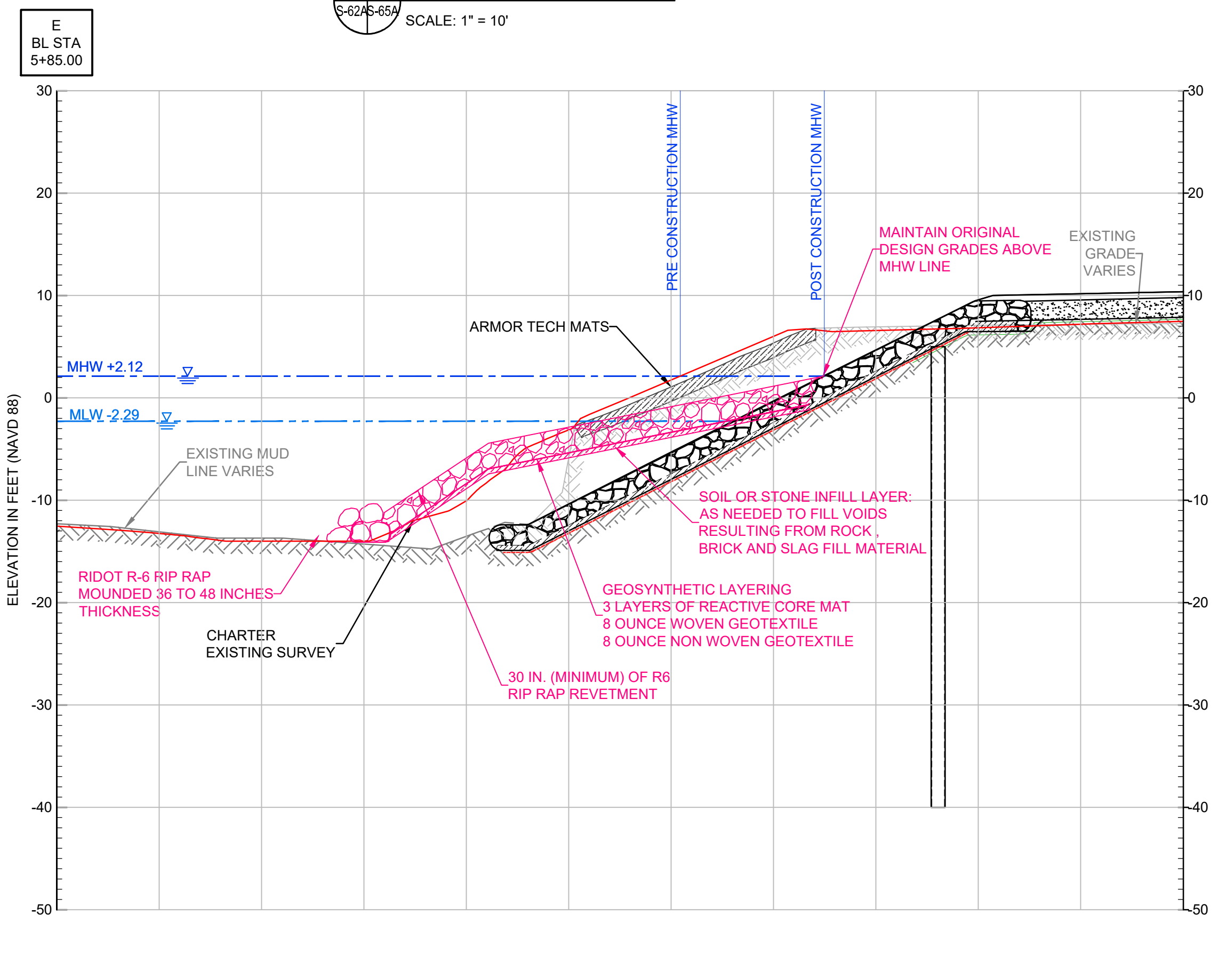

E WALL SECTION (STA. 5+85)
SCALE: 1" = 10'

- LEGEND**
- EXISTING FEATURES
 - ORIGINAL REVETMENT DESIGN
 - UPDATED EXISTING TOPOGRAPHY AND BATHYMETRIC SURVEY
 - ALTERNATIVE REVETMENT DESIGN
 - MEAN HIGH WATER LINE
 - MEAN LOW WATER LINE

NOTE:
UPDATED TOPOGRAPHY AND BATHYMETRIC SURVEY PROVIDED BY CHARTER CONSTRUCTION DIGITAL FILE RECEIVED OCTOBER 29, 2021 SURVEY PERFORMED BY A PLUS SURVEY.

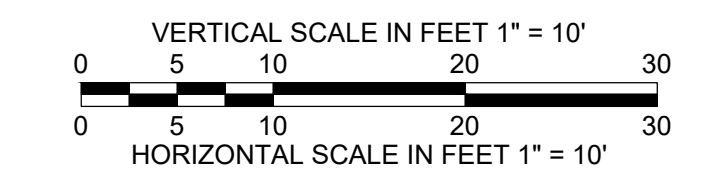

**DRAFT COPY
NOT FOR CONSTRUCTION**

NO.	ISSUE/DESCRIPTION	BY DATE
<p style="font-size: small;">THE INFORMATION SHOWN ON THE DRAWING IS SOLELY FOR USE BY NATIONAL GRID OR THE NATIONAL GRID'S DESIGNATED REPRESENTATIVE FOR THE SPECIFIC PROJECT AND LOCATION IDENTIFIED ON THE DRAWING. THE DRAWING SHALL NOT BE TRANSFERRED, REUSED, COPIED, OR ALTERED IN ANY MANNER FOR USE AT ANY OTHER LOCATION OR FOR ANY OTHER PURPOSE WITHOUT THE PRIOR WRITTEN CONSENT OF GZA AND NATIONAL GRID. ANY TRANSFER, REUSE, OR MODIFICATION TO THE DRAWING BY OTHERS, WITHOUT THE PRIOR WRITTEN EXPRESS CONSENT OF GZA AND NATIONAL GRID, WILL BE AT THE USER'S SOLE RISK AND WITHOUT ANY RISK OR LIABILITY TO GZA AND NATIONAL GRID.</p>		
<p>FORMER TIDEWATER FACILITY PAWTUCKET, RHODE ISLAND CONTRACT DOCUMENTS PHASE 4 & 5</p>		
<p>ALTERNATIVE REVETMENT SECTIONS (1 OF 2)</p>		
PREPARED BY:	PREPARED FOR:	
GZA GeoEnvironmental, Inc. Engineers and Scientists www.gza.com	nationalgrid	
PROJ MGR: DJR	REVIEWED BY: MJP	CHECKED BY: DJR
DESIGNED BY: ---	DRAWN BY: SAB	SCALE: AS SHOWN
DATE: JANUARY 2022	PROJECT NO. 43654.40	REVISION NO.
		DRAWING S-65A SHEET NO. 25 OF 74