

Attachment B

**Ambient Outdoor Air Sampling
Location and Laboratory Report – 26 April 2007**

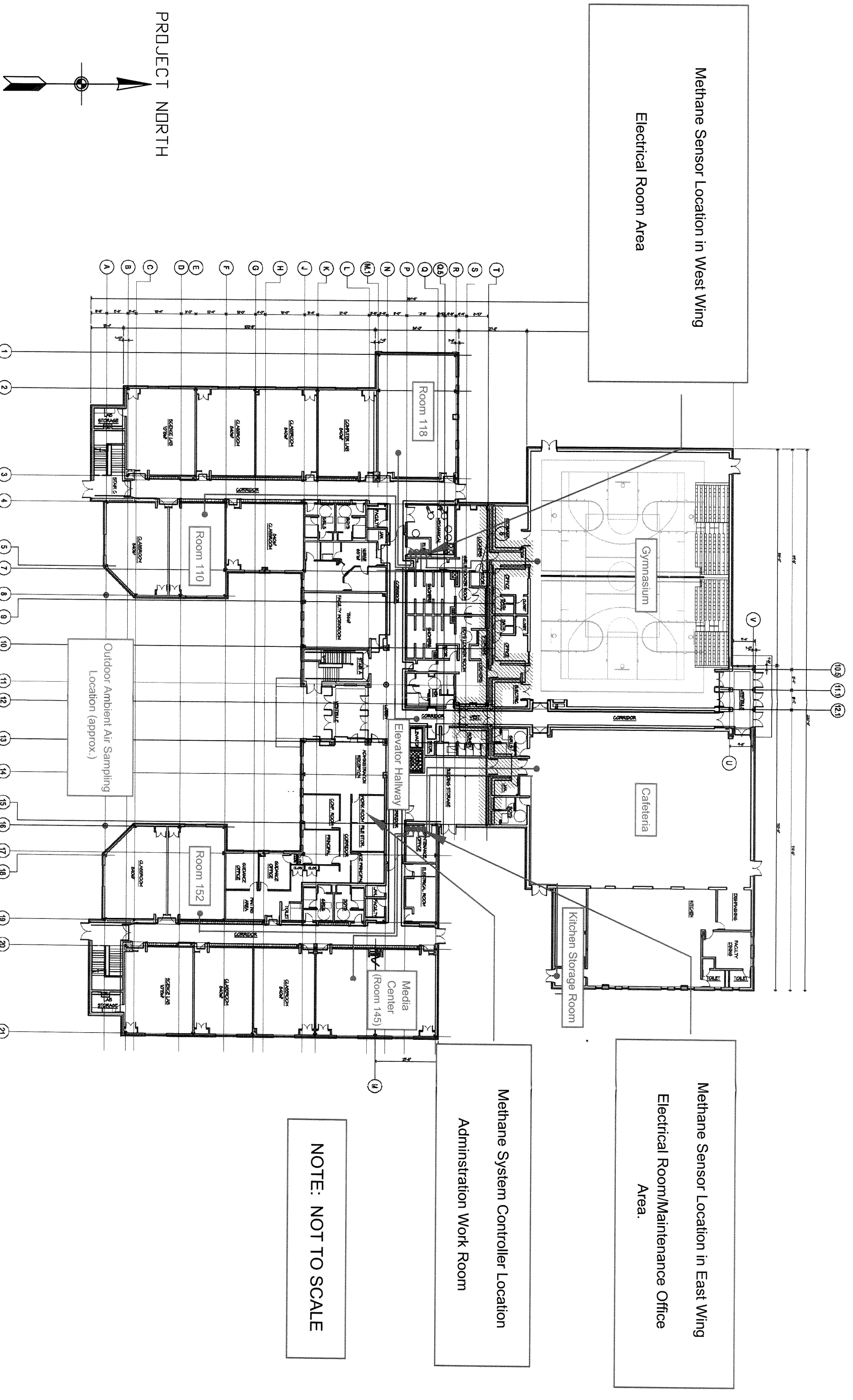

PROJECT NORTH

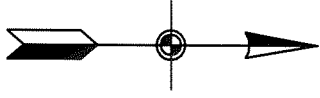

NOTE: NOT TO SCALE

DESIGNED BY PMG	DRAWN BY PMG	DATE 4-13-07	PROJECT NO. 61965.01	FILE NAME Gorham Layout
CHECKED BY PMG	PROJECT MGR. PMG	SCALE NTS	DRAWING NO. -	FIGURE N/A

AIR SAMPLING AND METHANE MONITORING
SYSTEM DIAGRAM - GORHAM HIGH SCHOOL
PROVIDENCE, RHODE ISLAND

LETTER ATTACHMENT
FIGURE



ANALYTICAL REPORT

Lab Number:	L0706029
Client:	EA Engineering, Science and Tech 2350 Post Road Warwick, RI 02886
ATTN:	Peter Grivers
Project Name:	ADELAIDE AVE-GORHAM
Project Number:	6196501
Report Date:	05/07/07

Certifications & Approvals: MA (M-MA086), NY NELAC (11148), CT (PH-0574), NH (200305), NJ (MA935), RI (LAO00065), ME (2006012), PA (Registration #68-03671), USDA (Permit #S-72578), US Army Corps of Engineers, Naval FESC.

Eight Walkup Drive, Westborough, MA 01581-1019

508-898-9220 (Fax) 508-898-9193 800-624-9220 - www.alphalab.com

Project Name: ADELAIDE AVE-GORHAM
Project Number: 6196501

Lab Number: L0706029
Report Date: 05/07/07

Alpha Sample ID	Client ID	Sample Location
L0706029-01	AMBIENT OUTDOOR	PROVIDENCE, RI

Project Name: ADELAIDE AVE-GORHAM
Project Number: 6196501

Lab Number: L0706029
Report Date: 05/07/07

Case Narrative

The samples were received in accordance with the chain of custody and no significant deviations were encountered during preparation or analysis unless otherwise noted below.

Report Submission

This is a final report to replace the previously issued preliminary report. This report includes data for all requested analytes.

TO15

L0706029-01 was re-analyzed due to an over dilution on the initial analysis. The results of the re-analysis is reported.

I, the undersigned, attest under the pains and penalties of perjury that, to the best of my knowledge and belief and based upon my personal inquiry of those responsible for providing the information contained in this analytical report, such information is accurate and complete. This certificate of analysis is not complete unless this page accompanies any and all pages of this report.

Authorized Signature:



Title: Technical Director

Date: 05/07/07

AIR

Project Name: ADELAIDE AVE-GORHAM
Project Number: 6196501

Lab Number: L0706029
Report Date: 05/07/07

SAMPLE RESULTS

Lab ID: L0706029-01
Client ID: AMBIENT OUTDOOR
Sample Location: PROVIDENCE, RI
Matrix: Air
Analytical Method: 48, TO-15-SIM
Analytical Date: 05/06/07 18:40
Analyst: HMI

Date Collected: 04/26/07 13:05
Date Received: 04/26/07
Field Prep: Not Specified

Parameter	ppbv		ug/m ³		Qualifier	Dilution Factor
	Results	RDL	Results	RDL		
Volatile Organic Compounds in Air by SIM						
1,1,1-Trichloroethane	0.020	0.020	0.110	0.109		1
1,1,1,2-Tetrachloroethane	ND	0.020	ND	0.137		1
1,1,2,2-Tetrachloroethane	ND	0.020	ND	0.137		1
1,1,2-Trichloroethane	ND	0.020	ND	0.109		1
1,1-Dichloroethane	ND	0.020	ND	0.081		1
1,1-Dichloroethene	ND	0.020	ND	0.079		1
1,2,4-Trimethylbenzene	ND	0.020	ND	0.098		1
1,2-Dibromoethane	ND	0.020	ND	0.154		1
1,2-Dichlorobenzene	ND	0.020	ND	0.120		1
1,2-Dichloroethane	ND	0.020	ND	0.081		1
1,2-Dichloropropane	ND	0.020	ND	0.092		1
1,3,5-Trimethylbenzene	ND	0.020	ND	0.098		1
1,3-Dichlorobenzene	ND	0.020	ND	0.120		1
1,4-Dichlorobenzene	ND	0.020	ND	0.120		1
Benzene	0.121	0.020	0.386	0.064		1
Bromodichloromethane	ND	0.020	ND	0.134		1
Bromoform	ND	0.020	ND	0.206		1
Carbon tetrachloride	0.112	0.020	0.705	0.126		1
Chlorobenzene	ND	0.020	ND	0.092		1
Chloroethane	ND	0.020	ND	0.053		1
Chloroform	0.023	0.020	0.113	0.098		1
cis-1,2-Dichloroethene	ND	0.020	ND	0.079		1
cis-1,3-Dichloropropene	ND	0.020	ND	0.091		1
Dibromochloromethane	ND	0.020	ND	0.096		1
Dichlorodifluoromethane	0.620	0.050	3.06	0.250		1

Project Name: ADELAIDE AVE-GORHAM
Project Number: 6196501

Lab Number: L0706029
Report Date: 05/07/07

SAMPLE RESULTS

Lab ID: L0706029-01
Client ID: AMBIENT OUTDOOR
Sample Location: PROVIDENCE, RI

Date Collected: 04/26/07 13:05
Date Received: 04/26/07
Field Prep: Not Specified

Parameter	ppbv		ug/m ³		Qualifier	Dilution Factor
	Results	RDL	Results	RDL		
Volatile Organic Compounds in Air by SIM						
Ethylbenzene	0.035	0.020	0.150	0.087		1
Methyl tert butyl ether	ND	0.020	ND	0.072		1
p/m-Xylene	0.092	0.040	0.398	0.174		1
o-Xylene	0.029	0.020	0.125	0.087		1
Styrene	ND	0.020	ND	0.085		1
Tetrachloroethene	0.028	0.020	0.188	0.136		1
Toluene	0.205	0.020	0.772	0.075		1
trans-1,2-Dichloroethene	ND	0.020	ND	0.079		1
trans-1,3-Dichloropropene	ND	0.020	ND	0.091		1
Trichloroethene	ND	0.020	ND	0.107		1
Trichlorofluoromethane	0.348	0.050	1.95	0.280		1
Vinyl chloride	ND	0.020	ND	0.051		1

Project Name: ADELAIDE AVE-GORHAM
Project Number: 6196501

Lab Number: L0706029
Report Date: 05/07/07

SAMPLE RESULTS

Lab ID: L0706029-01 R
Client ID: AMBIENT OUTDOOR
Sample Location: PROVIDENCE, RI
Matrix: Air
Analytical Method: 48, TO-15
Analytical Date: 04/30/07 15:22
Analyst: HM

Date Collected: 04/26/07 13:05
Date Received: 04/26/07
Field Prep: Not Specified

Parameter	ppbv		ug/m ³		Qualifier	Dilution Factor
	Results	RDL	Results	RDL		
1,1,1-Trichloroethane	ND	0.500	ND	2.72		1
1,1,2,2-Tetrachloroethane	ND	0.500	ND	3.43		1
1,1,2-Trichloroethane	ND	0.500	ND	2.72		1
1,1-Dichloroethane	ND	0.500	ND	2.02		1
1,1-Dichloroethane	ND	0.500	ND	1.98		1
1,2,4-Trimethylbenzene	ND	0.500	ND	2.46		1
1,2-Dibromoethane	ND	0.500	ND	3.84		1
1,2-Dichlorobenzene	ND	0.500	ND	3.00		1
1,2-Dichloroethane	ND	0.500	ND	2.02		1
1,2-Dichloropropane	ND	0.500	ND	2.31		1
1,3,5-Trimethylbenzene	ND	0.500	ND	2.46		1
1,3-Dichlorobenzene	ND	0.500	ND	3.00		1
1,4-Dichlorobenzene	ND	0.500	ND	3.00		1
2-Butanone	ND	0.500	ND	1.47		1
Acetone	5.05	2.00	12.0	4.75		1
Benzene	ND	0.500	ND	1.60		1
Bromodichloromethane	ND	0.500	ND	3.35		1
Bromoform	ND	0.500	ND	5.16		1
Carbon tetrachloride	ND	0.500	ND	3.14		1
Chlorobenzene	ND	0.500	ND	2.30		1
Chloroethane	ND	0.500	ND	1.32		1
Chloroform	ND	0.500	ND	2.44		1
Chloromethane	ND	0.500	ND	1.03		1
cis-1,2-Dichloroethene	ND	0.500	ND	1.98		1
cis-1,3-Dichloropropene	ND	0.500	ND	2.27		1

Project Name: ADELAIDE AVE-GORHAM
Project Number: 6196501

Lab Number: L0706029
Report Date: 05/07/07

SAMPLE RESULTS

Lab ID: L0706029-01 R
Client ID: AMBIENT OUTDOOR
Sample Location: PROVIDENCE, RI

Date Collected: 04/26/07 13:05
Date Received: 04/26/07
Field Prep: Not Specified

Parameter	ppbv		ug/m ³		Qualifier	Dilution Factor
	Results	RDL	Results	RDL		
Volatile Organic Compounds in Air						
Dibromochloromethane	ND	0.500	ND	4.26		1
Dichlorodifluoromethane	ND	1.00	ND	4.94		1
Ethylbenzene	ND	0.500	ND	2.17		1
Methylene chloride	1.47	1.00	5.10	3.47		1
4-Methyl-2-pentanone	ND	0.500	ND	2.05		1
Methyl tert butyl ether	ND	0.500	ND	1.80		1
p/m-Xylene	ND	1.00	ND	4.34		1
o-Xylene	ND	0.500	ND	2.17		1
Styrene	ND	0.500	ND	2.13		1
Tetrachloroethene	ND	0.500	ND	3.39		1
Toluene	ND	0.500	ND	1.88		1
trans-1,2-Dichloroethene	ND	0.500	ND	1.98		1
trans-1,3-Dichloropropene	ND	0.500	ND	2.27		1
Trichloroethene	ND	0.500	ND	2.68		1
Trichlorofluoromethane	ND	0.500	ND	2.81		1
Vinyl chloride	ND	0.500	ND	1.28		1
Acrylonitrile	ND	0.500	ND	1.08		1
1,1,1,2-Tetrachloroethane	ND	0.500	ND	3.43		1
Isopropylbenzene	ND	0.500	ND	2.46		1
n-Butylbenzene	ND	0.500	ND	2.74		1
sec-Butylbenzene	ND	0.500	ND	2.74		1
p-Isopropyltoluene	ND	0.500	ND	2.74		1

Project Name: ADELAIDE AVE-GORHAM

Lab Number: L0706029

Project Number: 6196501

Report Date: 05/07/07

Method Blank Analysis Batch Quality Control

Analytical Method: 48,TO-15

Analytical Date: 04/30/07 14:46

Parameter	ppbv		ug/m ³		Qualifier	Dilution Factor
	Results	RDL	Results	RDL		
Volatile Organic Compounds in Air for sample(s): 01 Batch: WG278667-5						
1,1,1-Trichloroethane	ND	0.500	ND	2.72		1
1,1,2,2-Tetrachloroethane	ND	0.500	ND	3.43		1
1,1,2-Trichloroethane	ND	0.500	ND	2.72		1
1,1-Dichloroethane	ND	0.500	ND	2.02		1
1,1-Dichloroethene	ND	0.500	ND	1.98		1
1,2,4-Trimethylbenzene	ND	0.500	ND	2.46		1
1,2-Dibromoethane	ND	0.500	ND	3.84		1
1,2-Dichlorobenzene	ND	0.500	ND	3.00		1
1,2-Dichloroethane	ND	0.500	ND	2.02		1
1,2-Dichloropropane	ND	0.500	ND	2.31		1
1,3,5-Trimethylbenzene	ND	0.500	ND	2.46		1
1,3-Dichlorobenzene	ND	0.500	ND	3.00		1
1,4-Dichlorobenzene	ND	0.500	ND	3.00		1
2-Butanone	ND	0.500	ND	1.47		1
Acetone	ND	2.00	ND	4.75		1
Benzene	ND	0.500	ND	1.60		1
Bromodichloromethane	ND	0.500	ND	3.35		1
Bromoform	ND	0.500	ND	5.16		1
Carbon tetrachloride	ND	0.500	ND	3.14		1
Chlorobenzene	ND	0.500	ND	2.30		1
Chloroethane	ND	0.500	ND	1.32		1
Chloroform	ND	0.500	ND	2.44		1
Chloromethane	ND	0.500	ND	1.03		1
cis-1,2-Dichloroethene	ND	0.500	ND	1.98		1
cis-1,3-Dichloropropene	ND	0.500	ND	2.27		1

Project Name: ADELAIDE AVE-GORHAM
Project Number: 6196501

Lab Number: L0706029
Report Date: 05/07/07

Method Blank Analysis Batch Quality Control

Analytical Method: 48,TO-15
Analytical Date: 04/30/07 14:46

Parameter	ppbv		ug/m ³		Qualifier	Dilution Factor
	Results	RDL	Results	RDL		
Volatle Organic Compounds in Air for sample(s): 01 Batch: WG278667-5						
Dibromochloromethane	ND	0.500	ND	4.26		1
Dichlorodifluoromethane	ND	1.00	ND	4.94		1
Ethylbenzene	ND	0.500	ND	2.17		1
Methylene chloride	ND	1.00	ND	3.47		1
4-Methyl-2-pentanone	ND	0.500	ND	2.05		1
Methyl tert butyl ether	ND	0.500	ND	1.80		1
p/m-Xylene	ND	1.00	ND	4.34		1
o-Xylene	ND	0.500	ND	2.17		1
Styrene	ND	0.500	ND	2.13		1
Tetrachloroethene	ND	0.500	ND	3.39		1
Toluene	ND	0.500	ND	1.88		1
trans-1,2-Dichloroethene	ND	0.500	ND	1.98		1
trans-1,3-Dichloropropene	ND	0.500	ND	2.27		1
Trichloroethene	ND	0.500	ND	2.68		1
Trichlorofluoromethane	ND	0.500	ND	2.81		1
Vinyl chloride	ND	0.500	ND	1.28		1
Acrylonitrile	ND	0.500	ND	1.08		1
1,1,1,2-Tetrachloroethane	ND	0.500	ND	3.43		1
Isopropylbenzene	ND	0.500	ND	2.46		1
n-Butylbenzene	ND	0.500	ND	2.74		1
sec-Butylbenzene	ND	0.500	ND	2.74		1
p-Isopropyltoluene	ND	0.500	ND	2.74		1

Project Name: ADELAIDE AVE-GORHAM
Project Number: 6196501

Lab Number: L0706029
Report Date: 05/07/07

Method Blank Analysis Batch Quality Control

Analytical Method: 48, TO-15-SIM
Analytical Date: 05/06/07 18:04

Parameter	ppbv		ug/m3		Qualifier	Dilution Factor
	Results	RDL	Results	RDL		
Volatile Organic Compounds in Air by SIM for sample(s): 01 Batch: WG279328-2						
1,1,1-Trichloroethane	ND	0.020	ND	0.109		1
1,1,1,2-Tetrachloroethane	ND	0.020	ND	0.137		1
1,1,2,2-Tetrachloroethane	ND	0.020	ND	0.137		1
1,1,2-Trichloroethane	ND	0.020	ND	0.109		1
1,1-Dichloroethane	ND	0.020	ND	0.081		1
1,1-Dichloroethene	ND	0.020	ND	0.079		1
1,2,4-Trimethylbenzene	ND	0.020	ND	0.098		1
1,2-Dibromoethane	ND	0.020	ND	0.154		1
1,2-Dichlorobenzene	ND	0.020	ND	0.120		1
1,2-Dichloroethane	ND	0.020	ND	0.081		1
1,2-Dichloropropane	ND	0.020	ND	0.092		1
1,3,5-Trimethylbenzene	ND	0.020	ND	0.098		1
1,3-Dichlorobenzene	ND	0.020	ND	0.120		1
1,4-Dichlorobenzene	ND	0.020	ND	0.120		1
Benzene	ND	0.020	ND	0.064		1
Bromodichloromethane	ND	0.020	ND	0.134		1
Bromoform	ND	0.020	ND	0.206		1
Carbon tetrachloride	ND	0.020	ND	0.126		1
Chlorobenzene	ND	0.020	ND	0.092		1
Chloroethane	ND	0.020	ND	0.053		1
Chloroform	ND	0.020	ND	0.098		1
cis-1,2-Dichloroethene	ND	0.020	ND	0.079		1
cis-1,3-Dichloropropene	ND	0.020	ND	0.091		1
Dibromochloromethane	ND	0.020	ND	0.096		1
Dichlorodifluoromethane	ND	0.050	ND	0.250		1

Project Name: ADELAIDE AVE-GORHAM

Lab Number: L0706029

Project Number: 6196501

Report Date: 05/07/07

Method Blank Analysis Batch Quality Control

Analytical Method: 48, TO-15-SIM

Analytical Date: 05/06/07 18:04

Parameter	ppbv		ug/m ³		Qualifier	Dilution Factor
	Results	RDL	Results	RDL		
Volatile Organic Compounds in Air by SIM for sample(s): 01 Batch: WG279328-2						
Ethylbenzene	ND	0.020	ND	0.087		1
Methyl tert butyl ether	ND	0.020	ND	0.072		1
p/m-Xylene	ND	0.040	ND	0.174		1
o-Xylene	ND	0.020	ND	0.087		1
Styrene	ND	0.020	ND	0.085		1
Tetrachloroethene	ND	0.020	ND	0.136		1
Toluene	ND	0.020	ND	0.075		1
trans-1,2-Dichloroethene	ND	0.020	ND	0.079		1
trans-1,3-Dichloropropene	ND	0.020	ND	0.091		1
Trichloroethene	ND	0.020	ND	0.107		1
Trichlorofluoromethane	ND	0.050	ND	0.280		1
Vinyl chloride	ND	0.020	ND	0.051		1

Lab Control Sample Analysis Batch Quality Control

Project Name: ADELAIDE AVE-GORHAM
Project Number: 6196501

Lab Number: L0706029
Report Date: 05/07/07

Parameter	LCS %Recovery	LCSD %Recovery	%Recovery Limits	RPD	RPD Limits
Volatile Organic Compounds in Air Associated sample(s): 01 Batch: W6278667-4					
1,1,1-Trichloroethane	110	-	70-130	-	-
1,1,2,2-Tetrachloroethane	91	-	70-130	-	-
1,1,2-Trichloroethane	101	-	70-130	-	-
1,1-Dichloroethane	100	-	70-130	-	-
1,1-Dichloroethene	101	-	70-130	-	-
1,2,4-Trichlorobenzene	129	-	70-130	-	-
1,2,4-Trimethylbenzene	124	-	70-130	-	-
1,2-Dibromoethane	96	-	70-130	-	-
1,2-Dichlorobenzene	98	-	70-130	-	-
1,2-Dichloroethane	112	-	70-130	-	-
1,2-Dichloropropane	96	-	70-130	-	-
1,3,5-Trimethylbenzene	108	-	70-130	-	-
1,3-Butadiene	101	-	70-130	-	-
1,3-Dichlorobenzene	97	-	70-130	-	-
1,4-Dichlorobenzene	99	-	70-130	-	-
1,4-Dioxane	86	-	70-130	-	-
2,2,4-Trimethylpentane	101	-	70-130	-	-
2-Butanone	88	-	70-130	-	-
2-Hexanone	55	-	70-130	-	-
3-Chloropropene	110	-	70-130	-	-
4-Ethyltoluene	96	-	70-130	-	-

Lab Control Sample Analysis Batch Quality Control

Project Name: ADELAIDE AVE-GORHAM
Project Number: 6196501

Lab Number: L0706029
Report Date: 05/07/07

Parameter	LCS %Recovery	LCSD %Recovery	%Recovery Limits	RPD	RPD Limits
Volatile Organic Compounds in Air Associated sample(s): 01 Batch: WG278667-4					
Acetone	92	-	70-130	-	-
Benzene	83	-	70-130	-	-
Benzyl chloride	71	-	70-130	-	-
Bromodichloromethane	108	-	70-130	-	-
Bromoform	117	-	70-130	-	-
Bromomethane	76	-	70-130	-	-
Carbon disulfide	92	-	70-130	-	-
Carbon tetrachloride	117	-	70-130	-	-
Chlorobenzene	92	-	70-130	-	-
Chloroethane	87	-	70-130	-	-
Chloroform	106	-	70-130	-	-
Chloromethane	86	-	70-130	-	-
cis-1,2-Dichloroethane	105	-	70-130	-	-
cis-1,3-Dichloropropene	92	-	70-130	-	-
Cyclohexane	94	-	70-130	-	-
Dibromochloromethane	105	-	70-130	-	-
Dichlorodifluoromethane	105	-	70-130	-	-
Ethyl Alcohol	86	-	70-130	-	-
Ethyl Acetate	72	-	70-130	-	-
Ethylbenzene	98	-	70-130	-	-
1,1,2-Trichloro-1,2,2-Trifluoroethane	99	-	70-130	-	-

Lab Control Sample Analysis Batch Quality Control

Project Name: ADELAIDE AVE-GORHAM
Project Number: 6196501

Lab Number: L0706029
Report Date: 05/07/07

Parameter	LCS %Recovery	LCSD %Recovery	%Recovery Limits	RPD	RPD Limits
Volatle Organic Compounds in Air Associated sample(s): 01 Batch: WG278667-4					
1,2-Dichloro-1,1,2,2-tetrafluoroethane	97	-	70-130	-	-
Hexachlorobutadiene	101	-	70-130	-	-
iso-Propyl Alcohol	80	-	70-130	-	-
Methylene chloride	100	-	70-130	-	-
4-Methyl-2-pentanone	80	-	70-130	-	-
Methyl tert butyl ether	105	-	70-130	-	-
p/m-Xylene	98	-	70-130	-	-
o-Xylene	104	-	70-130	-	-
n-Heptane	98	-	70-130	-	-
n-Hexane	98	-	70-130	-	-
Propylene	86	-	70-130	-	-
Styrene	79	-	70-130	-	-
Tetrachloroethene	95	-	70-130	-	-
Tetrahydrofuran	104	-	70-130	-	-
Toluene	90	-	70-130	-	-
trans-1,2-Dichloroethene	105	-	70-130	-	-
trans-1,3-Dichloropropene	84	-	70-130	-	-
Trichloroethene	102	-	70-130	-	-
Trichlorofluoromethane	102	-	70-130	-	-
Vinyl acetate	75	-	70-130	-	-
Vinyl bromide	100	-	70-130	-	-

Lab Control Sample Analysis

Batch Quality Control

Project Name: ADELAIDE AVE-GORHAM
Project Number: 6196501

Lab Number: L0706029
Report Date: 05/07/07

Parameter	LCS %Recovery	LCSD %Recovery	%Recovery Limits	RPD	RPD Limits
Volatile Organic Compounds in Air Associated sample(s): 01 Batch: WG278667-4					
Vinyl chloride	102	-	70-130	-	-
Naphthalene	116	-	70-130	-	-
Propane	91	-	70-130	-	-
Acrylonitrile	97	-	70-130	-	-
Acrolein	63	-	70-130	-	-
1,1,1,2-Tetrachloroethane	92	-	70-130	-	-
Isopropylbenzene	87	-	70-130	-	-
1,2,3-Trichloropropene	81	-	70-130	-	-
Acetonitrile	102	-	70-130	-	-
Bromobenzene	80	-	70-130	-	-
Chlorodifluoromethane	99	-	70-130	-	-
Dichlorofluoromethane	95	-	70-130	-	-
Dibromomethane	94	-	70-130	-	-
Pentane	89	-	70-130	-	-
Octane	79	-	70-130	-	-
Tertiary-Amyl Methyl Ether	69	-	70-130	-	-
o-Chlorotoluene	78	-	70-130	-	-
p-Chlorotoluene	76	-	70-130	-	-
2,2-Dichloropropene	114	-	70-130	-	-
1,1-Dichloropropene	93	-	70-130	-	-
Isopropyl Ether	95	-	70-130	-	-

Lab Control Sample Analysis

Batch Quality Control

Project Name: ADELAIDE AVE-GORHAM
Project Number: 6196501

Lab Number: L0706029
Report Date: 05/07/07

Parameter	LCS %Recovery	LCSD %Recovery	%Recovery Limits	RPD	RPD Limits
Volatile Organic Compounds in Air Associated sample(s): 01 Batch: WG278667-4					
Ethyl-Tert-Butyl-Ether	83	-	70-130	-	-
1,2,3-Trichlorobenzene	51	-	70-130	-	-
Ethyl ether	94	-	70-130	-	-
n-Butylbenzene	88	-	70-130	-	-
sec-Butylbenzene	77	-	70-130	-	-
tert-Butylbenzene	78	-	70-130	-	-
1,2-Dibromo-3-chloropropane	54	-	70-130	-	-
p-Isopropyltoluene	78	-	70-130	-	-
n-Propylbenzene	79	-	70-130	-	-
1,3-Dichloropropane	83	-	70-130	-	-
Methanol	85	-	70-130	-	-
Butane	86	-	70-130	-	-
Nonane (C9)	82	-	70-130	-	-
Decane (C10)	128	-	70-130	-	-
Undecane	126	-	70-130	-	-
Dodecane (C12)	73	-	70-130	-	-

Lab Control Sample Analysis

Batch Quality Control

Project Name: ADELAIDE AVE-GORHAM

Lab Number: L0706029

Project Number: 6196501

Report Date: 05/07/07

Parameter	LCS		LCSD		%Recovery Limits	RPD	RPD Limits
	%Recovery		%Recovery				
Volatile Organic Compounds in Air by SIM Associated sample(s): 01 Batch: WG279328-1							
1,1,1-Trichloroethane	91	-	-	-	70-130	-	-
1,1,1,2-Tetrachloroethane	81	-	-	-	70-130	-	-
1,1,2,2-Tetrachloroethane	81	-	-	-	70-130	-	-
1,1,2-Trichloroethane	91	-	-	-	70-130	-	-
1,1-Dichloroethane	98	-	-	-	70-130	-	-
1,1-Dichloroethene	103	-	-	-	70-130	-	-
1,2,4-Trimethylbenzene	80	-	-	-	70-130	-	-
1,2-Dibromoethane	80	-	-	-	70-130	-	-
1,2-Dichlorobenzene	77	-	-	-	70-130	-	-
1,2-Dichloroethane	110	-	-	-	70-130	-	-
1,2-Dichloropropane	92	-	-	-	70-130	-	-
1,3,5-Trimethylbenzene	78	-	-	-	70-130	-	-
1,3-Dichlorobenzene	77	-	-	-	70-130	-	-
1,4-Dichlorobenzene	77	-	-	-	70-130	-	-
Benzene	85	-	-	-	70-130	-	-
Bromodichloromethane	96	-	-	-	70-130	-	-
Bromoform	84	-	-	-	70-130	-	-
Carbon tetrachloride	81	-	-	-	70-130	-	-
Chlorobenzene	82	-	-	-	70-130	-	-
Chloroethane	107	-	-	-	70-130	-	-
Chloroform	97	-	-	-	70-130	-	-

Lab Control Sample Analysis

Batch Quality Control

Project Name: ADELAIDE AVE-GORHAM
 Project Number: 6196501

Lab Number: L0706029
 Report Date: 05/07/07

Parameter	LCS %Recovery	LCSD %Recovery	%Recovery Limits	RPD	RPD Limits
Volatile Organic Compounds in Air by SIM Associated sample(s): 01 Batch: WG279328-1					
cis-1,2-Dichloroethane	92	-	70-130	-	-
cis-1,3-Dichloropropene	90	-	70-130	-	-
Dibromochloromethane	87	-	70-130	-	-
Dichlorodifluoromethane	105	-	70-130	-	-
Ethylbenzene	77	-	70-130	-	-
Methyl tert butyl ether	95	-	70-130	-	-
p/m-Xylene	81	-	70-130	-	-
o-Xylene	77	-	70-130	-	-
Styrene	72	-	70-130	-	-
Tetrachloroethene	80	-	70-130	-	-
Toluene	74	-	70-130	-	-
trans-1,2-Dichloroethane	88	-	70-130	-	-
trans-1,3-Dichloropropane	88	-	70-130	-	-
Trichloroethane	84	-	70-130	-	-
Trichlorofluoromethane	104	-	70-130	-	-
Vinyl chloride	114	-	70-130	-	-

Lab Duplicate Analysis

Batch Quality Control

Project Name: ADELAIDE AVE-GORHAM
Project Number: 6196501

Lab Number: L0706029
Report Date: 05/07/07

Parameter	Native Sample	Duplicate Sample	Units	RPD	RPD Limits
1,1,1-Trichloroethane	ND	ND	ppbv	NC	25
1,1,2,2-Tetrachloroethane	ND	ND	ppbv	NC	25
1,1,2-Trichloroethane	ND	ND	ppbv	NC	25
1,1-Dichloroethane	ND	ND	ppbv	NC	25
1,1-Dichloroethene	ND	ND	ppbv	NC	25
1,2,4-Trimethylbenzene	ND	ND	ppbv	NC	25
1,2-Dibromoethane	ND	ND	ppbv	NC	25
1,2-Dichlorobenzene	ND	ND	ppbv	NC	25
1,2-Dichloroethane	ND	ND	ppbv	NC	25
1,2-Dichloropropane	ND	ND	ppbv	NC	25
1,3,5-Trimethylbenzene	ND	ND	ppbv	NC	25
1,3-Dichlorobenzene	ND	ND	ppbv	NC	25
1,4-Dichlorobenzene	ND	ND	ppbv	NC	25
2-Bifluorene	888	904	ppbv	2	25
Acetone	79.1	80.6	ppbv	2	25
Benzene	ND	ND	ppbv	NC	25
Bromodichloromethane	ND	ND	ppbv	NC	25
Bromoform	ND	ND	ppbv	NC	25
Carbon tetrachloride	ND	ND	ppbv	NC	25

Lab Duplicate Analysis

Batch Quality Control

Project Name: ADELAIDE AVE-GORHAM
Project Number: 6196501

Lab Number: L0706029
Report Date: 05/07/07

Parameter	Native Sample	Duplicate Sample	Units	RPD	RPD Limits
Volatile Organic Compounds in Air Associated sample(s): 01 QC Batch ID: WG278667-6 QC Sample: L0706019-07 Client ID: DUP Sample					
Chlorobenzene	ND	ND	ppbv	NC	25
Chloroethane	ND	ND	ppbv	NC	25
Chloroform	ND	ND	ppbv	NC	25
Chloromethane	ND	ND	ppbv	NC	25
cis-1,2-Dichloroethene	ND	ND	ppbv	NC	25
cis-1,3-Dichloropropene	ND	ND	ppbv	NC	25
Dibromochloromethane	ND	ND	ppbv	NC	25
Dichlorodifluoromethane	ND	ND	ppbv	NC	25
Ethylbenzene	ND	ND	ppbv	NC	25
Methylene chloride	ND	ND	ppbv	NC	25
4-Methyl-2-pentanone	ND	ND	ppbv	NC	25
Methyl tert butyl ether	ND	ND	ppbv	NC	25
p/m-Xylene	ND	ND	ppbv	NC	25
o-Xylene	ND	ND	ppbv	NC	25
Styrene	ND	ND	ppbv	NC	25
Tetrachloroethene	ND	ND	ppbv	NC	25
Toluene	ND	ND	ppbv	NC	25
trans-1,2-Dichloroethene	ND	ND	ppbv	NC	25
trans-1,3-Dichloropropene	ND	ND	ppbv	NC	25

Lab Duplicate Analysis

Batch Quality Control

Project Name: ADELAIDE AVE-GORHAM
Project Number: 6196501

Lab Number: L0706029
Report Date: 05/07/07

Parameter	Native Sample	Duplicate Sample	Units	RPD	RPD Limits
Volatile Organic Compounds in Air Associated sample(s): 01 QC Batch ID: WG278667-6 QC Sample: L0706019-07 Client ID: DUP Sample					
Trichloroethene	ND	ND	ppbV	NC	25
Trichlorofluoromethane	ND	ND	ppbV	NC	25
Vinyl chloride	ND	ND	ppbV	NC	25
Acrylonitrile	ND	ND	ppbV	NC	25
1,1,1,2-Tetrachloroethane	ND	ND	ppbV	NC	25
Isopropylbenzene	ND	ND	ppbV	NC	25
n-Butylbenzene	ND	ND	ppbV	NC	25
sec-Butylbenzene	ND	ND	ppbV	NC	25
p-Isopropyltoluene	ND	ND	ppbV	NC	25

Lab Duplicate Analysis

Batch Quality Control

Project Name: ADELAIDE AVE-GORHAM
 Project Number: 6196501

Lab Number: L0706029
 Report Date: 05/07/07

Parameter	Native Sample	Duplicate Sample	Units	RPD	RPD Limits
Volatile Organic Compounds in Air by SIM Associated sample(s): 01 QC Batch ID: W6279328-3 QC Sample: L0706026-05 Client ID: DUP Sample					
1,1,1-Trichloroethane	0.026	0.031	ppbv	18	25
1,1,1,2-Tetrachloroethane	ND	ND	ppbv	NC	25
1,1,2,2-Tetrachloroethane	ND	ND	ppbv	NC	25
1,1,2-Trichloroethane	ND	ND	ppbv	NC	25
1,1-Dichloroethane	ND	ND	ppbv	NC	25
1,1-Dichloroethene	ND	ND	ppbv	NC	25
1,2,4-Trimethylbenzene	3.12	3.26	ppbv	4	25
1,2-Dibromoethane	ND	ND	ppbv	NC	25
1,2-Dichlorobenzene	ND	ND	ppbv	NC	25
1,2-Dichloroethane	0.025	0.026	ppbv	7	25
1,2-Dichloropropane	ND	ND	ppbv	NC	25
1,3,5-Trimethylbenzene	1.88	1.78	ppbv	6	25
1,3-Dichlorobenzene	ND	ND	ppbv	NC	25
1,4-Dichlorobenzene	ND	ND	ppbv	NC	25
Benzene	0.257	0.302	ppbv	16	25
Bromodichloromethane	ND	ND	ppbv	NC	25
Bromoform	ND	ND	ppbv	NC	25
Carbon tetrachloride	0.117	0.138	ppbv	16	25
Chlorobenzene	ND	ND	ppbv	NC	25

Lab Duplicate Analysis
Batch Quality Control

Project Name: ADELAIDE AVE-GORHAM
Project Number: 6196501

Lab Number: L0706029
Report Date: 05/07/07

Parameter	Native Sample	Duplicate Sample	Units	RPD	RPD Limits
Volatile Organic Compounds in Air by SIM Associated sample(s): 01 QC Batch ID: W6279328-3 QC Sample: L0706026-05 Client ID: DUP Sample					
Chloroethane	ND	ND	ppbv	NC	25
Chloroform	0.032	0.034	ppbv	6	25
cis-1,2-Dichloroethene	ND	ND	ppbv	NC	25
cis-1,3-Dichloropropene	ND	ND	ppbv	NC	25
Dibromochloromethane	ND	ND	ppbv	NC	25
Dichlorodifluoromethane	0.612	0.663	ppbv	8	25
Ethylbenzene	0.888	0.951	ppbv	7	25
Methyl tert butyl ether	0.034	0.041	ppbv	19	25
p/m-Xylene	3.24	3.44	ppbv	6	25
o-Xylene	0.828	0.883	ppbv	6	25
Styrene	0.089	0.095	ppbv	7	25
Tetrachloroethene	0.049	0.052	ppbv	6	25
Toluene	4.28	4.52	ppbv	5	25
trans-1,2-Dichloroethane	ND	ND	ppbv	NC	25
trans-1,3-Dichloropropene	ND	ND	ppbv	NC	25
Trichloroethene	0.039	0.042	ppbv	9	25
Trichlorofluoromethane	0.340	0.364	ppbv	7	25
Vinyl chloride	ND	ND	ppbv	NC	25

Project Name: ADELAIDE AVE-GORHAM

Lab Number: L0706029

Project Number: 6196501

Report Date: 05/07/07

Sample Receipt and Container Information

Were project specific reporting limits specified? YES

Cooler Information

Cooler **Custody Seal**

NA Absent

Container Information

Container ID **Container Type** **Cooler pH** **Temp** **Pres** **Seal** **Analysis**

L0706029-01A Canister - 2.7 Liter NA NA NA NA Absent TO-15,TO15-SIM

Project Name: ADELAIDE AVE-GORHAM
Project Number: 6196501

Lab Number: L0706029
Report Date: 05/07/07

GLOSSARY

Acronyms

- EPA - Environmental Protection Agency.
LCS - Laboratory Control Sample: A sample matrix, free from the analytes of interest, spiked with verified known amounts of analytes or a material containing known and verified amounts of analytes.
LCSD - Laboratory Control Sample Duplicate: Refer to LCS.
MS - Matrix Spike Sample: A sample prepared by adding a known mass of target analyte to a specified amount of matrix sample for which an independent estimate of target analyte concentration is available.
MSD - Matrix Spike Sample Duplicate: Refer to MS.
NA - Not Applicable.
NC - Not Calculated: Term is utilized when one or more of the results utilized in the calculation are non-detect at the parameter's reporting unit.
ND - Not detected at the reported detection limit for the sample.
RDL - Reported Detection Limit: The value at which an instrument can accurately measure an analyte at a specific concentration. The RDL includes any adjustments from dilutions, concentrations or moisture content, where applicable.
RPD - Relative Percent Difference: The results from matrix and/or matrix spike duplicates are primarily designed to assess the precision of analytical results in a given matrix and are expressed as relative percent difference (RPD). Values which are less than five times the reporting limit for any individual parameter are evaluated by utilizing the absolute difference between the values; although the RPD value will be provided in the report.

Terms

Analytical Method: Both the document from which the method originates and the analytical reference method. (Example: EPA 8260B is shown as 1.8260B.) The codes for the reference method documents are provided in the References section of the Addendum.

Data Qualifiers

The following data qualifiers have been identified for use under the CT DEP Reasonable Confidence Protocols.

- A - Spectra identified as "Aldol Condensation Product".
- B - The analyte was detected above the reporting limit in the associated method blank. Flag only applies to associated field samples that have detectable concentrations of the analyte.
- E - Concentration of analyte exceeds the range of the calibration curve and/or linear range of the instrument.
- J - Estimated value. The analyte was tentatively identified; the quantitation is an estimation. (Tentatively identified compounds only.)

Project Name: ADELAIDE AVE-GORHAM
Project Number: 6196501

Lab Number: L0706029
Report Date: 05/07/07

REFERENCES

48 Compendium of Methods for the Determination of Toxic Organic Compounds in Ambient Air:
Second Edition. EPA/625/R-96/010b, January 1999.

LIMITATION OF LIABILITIES

Alpha Woods Hole Labs performs services with reasonable care and diligence normal to the analytical testing laboratory industry. In the event of an error, the sole and exclusive responsibility of Alpha Woods Hole Labs shall be to re-perform the work at its own expense. In no event shall Alpha Woods Hole Labs be held liable for any incidental, consequential or special damages, including but not limited to, damages in any way connected with the use of, interpretation of, information or analysis provided by Alpha Woods Hole Labs.

We strongly urge our clients to comply with EPA protocol regarding sample volume, preservation, cooling, containers, sampling procedures, holding time and splitting of samples in the field.

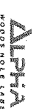

ALPHA ANALYSIS CHAIN OF CUSTODY ALPHA LABORATORY Eight Walkup Drive Westborough, MA 01581 TEL: 508-898-9220 FAX: 508-898-9193		Client Information Client: EA Engineering, Sci + Tech Address: 2350 Post Rd Wauville, RI 02886 Phone: 401-736-3440 Fax: 401-736-3423 Email: pgrivers@east.com * These samples have been previously analyzed by Alpha		Project Information Project Name: Abolade Ave - Gotham Project Location: Providence, RI Project #: 6196501 Project Manager: Peter Griviers ALPHA Quote #: Wauville, RI 02886 Turn-Around Time:		Report Information - Data Deliverables Report to: (if different than Project Manager) Other Formats: <input type="checkbox"/> EMAIL (standard pdf report) <input type="checkbox"/> Additional Deliverables: Criteria Checker: Customized <input checked="" type="checkbox"/> FAX <input checked="" type="checkbox"/> ADEx		Billing Information ALPHA Job #: L0706029 Same as Client Info <input checked="" type="checkbox"/> PO #		Regulatory Requirements/Report Limits State/Fed Program Criteria Report to: (if different than Project Manager)		ANALYSIS TO-15 SULFURHEXAFUORIDES TO-15A SULFURHEXAFUORIDES TO-15 SULFUR DIOXIDE TO-15A SULFUR DIOXIDE TO-15 SIM APH DISSOLVED GASES FIXED GASES TO-13A TO-15 SULFURHEXAFUORIDES TO-15A SULFURHEXAFUORIDES TO-15 SULFUR DIOXIDE TO-15A SULFUR DIOXIDE		Other Project Specific Requirements/Comments: * RUSH (only confirmed if pre-approved) Date Due: 5/2 Wed Time:		Sample ID ALPHA Lab ID (Lab Use Only) Sample ID Date Start Time End Time Collection Sample Matrix Intials Can ID ID-Flow Controller TO-14A TO-15 TO-15 SIM APH DISSOLVED GASES FIXED GASES TO-13A TO-15 SULFURHEXAFUORIDES TO-15A SULFURHEXAFUORIDES TO-15 SULFUR DIOXIDE TO-15A SULFUR DIOXIDE		Ambient Outdoor 4/26/07 12:35 13:25 A MPG 373 0161 X PID = 0.087 ppm		Shaded Gray Areas For Lab Use Only Container Type		Relinquished By: [Signature] Date/Time Received By: [Signature] Date/Time 4/26 16:10		Please print clearly, legibly and completely. Samples can not be logged in and turnaround time clock will not start until any ambiguities are resolved. All samples submitted are subject to Alpha's Payment Terms. See reverse side.	
---	--	--	--	---	--	---	--	---	--	--	--	---	--	---	--	--	--	--	--	--	--	--	--	---	--